

INSTALLATION INSTRUCTIONS

PRO-SERIES REAR BUMPER



APPLICATION:
2024-2026 TACOMA
PART NUMBER:
58-422785

CONTENT			
ITEM	QUANTITY	DESCRIPTION	TOOLS NEEDED
1	1	BUMPER ASSEMBLY	10MM SOCKET
2	1	DRIVER BRACKET	10MM WRENCH
3	1	PASSENGER BRACKET	12MM SOCKET
4	4	HOLE PLUG	12MM WRENCH
5	4	SENSOR L-TAB	18MM SOCKET
6	1	DRIVER SENSOR BRACKET	18MM WRENCH
7	1	PASSENGER SENSOR BRACKET	19MM SOCKET
8	2	SENSOR COVER	19MM WRENCH
9	2	SENSOR PLATE	4MM HEX DRIVER
10	6	M12 SERRATED FLANGE HEX HEAD BOLT (YELLOW ZINC)	GRINDER
11	6	M12 SERRATED FLANGE HEX NUT (YELLOW ZINC)	RATCHET
12	6	M6 HEX HEAD BOLT (YELLOW ZINC)	PRY TOOL
13	12	M6 FLAT WASHER (YELLOW ZINC)	TORQUE WRENCH
14	6	M6 SPLIT LOCK WASHER (YELLOW ZINC)	
15	6	M6 HEX NUT (YELLOW ZINC)	
16	4	M12 HEX HEAD BOLT (BLACK ZINC)	
17	4	M12 FLAT WASHER (BLACK ZINC)	
18	4	M12 SPLIT LOCK WASHER (BLACK ZINC)	
19	4	M12 SERRATED FLANGE HEX NUT (BLACK ZINC)	
20	4	M6 ROUND HEAD SQUARE NECK BOLT (BLACK ZINC)	
21	12	M6 FLAT WASHER (BLACK ZINC)	
22	4	M6 SPLIT LOCK WASHER (BLACK ZINC)	
23	4	M6 HEX NUT (BLACK ZINC)	
24	6	SHORT M6 BUTTON HEAD BOLT (BLACK ZINC)	
25	2	LONG M6 BUTTON HEAD BOLT (BLACK ZINC)	
26	8	M6 SERRATED FLANGE HEX NUT (BLACK ZINC)	
27	4	DOUBLE SIDED FOAM TAPE	
ANTI-SEIZE LUBRICANT MUST BE USED ON ALL STAINLESS STEEL FASTENERS TO PREVENT THREAD DAMAGE AND GALLING			



Westin Automotive Products, Inc.
320 W. Covina Blvd
San Dimas, Ca. 91773

Thank you for choosing Westin products
for additional installation assistance please call
Customer Service (800) 793-7846
www.westinautomotive.com

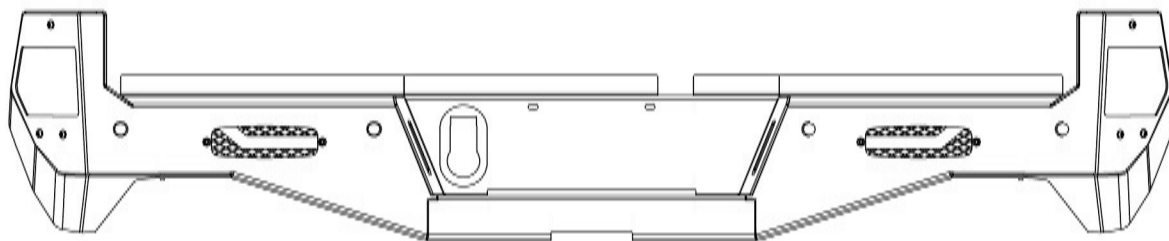

ITEM 1

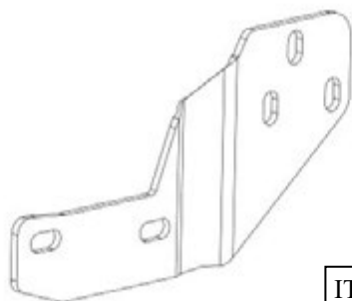

ITEM 2



ITEM 4



ITEM 5



ITEM 6



ITEM 7



ITEM 8



ITEM 9

PROCEDURE

1. Remove contents from box, verify if all parts listed are present and free from damage.
Carefully read and understand all instructions before attempting installation.
Failure to identify damage before installation could lead to a rejection of any claim.



Westin Automotive Products, Inc.
320 W. Covina Blvd
San Dimas, Ca. 91773

Thank you for choosing Westin products
for additional installation assistance please call
Customer Service (800) 793-7846
www.westinautomotive.com

2. Detach the main rear bumper wiring harness located on the driver side. Pull the grey lever to release the wiring harness plug. Pull the plug to disconnect it from the truck. See **Figure 1**.
3. Disconnect the trailer plug from the rear bumper. Press the small black release tab before pulling it away from the bumper. See **Figure 2**
4. Remove the bumper bolts located on the side of the frame. See **Figure 3**.

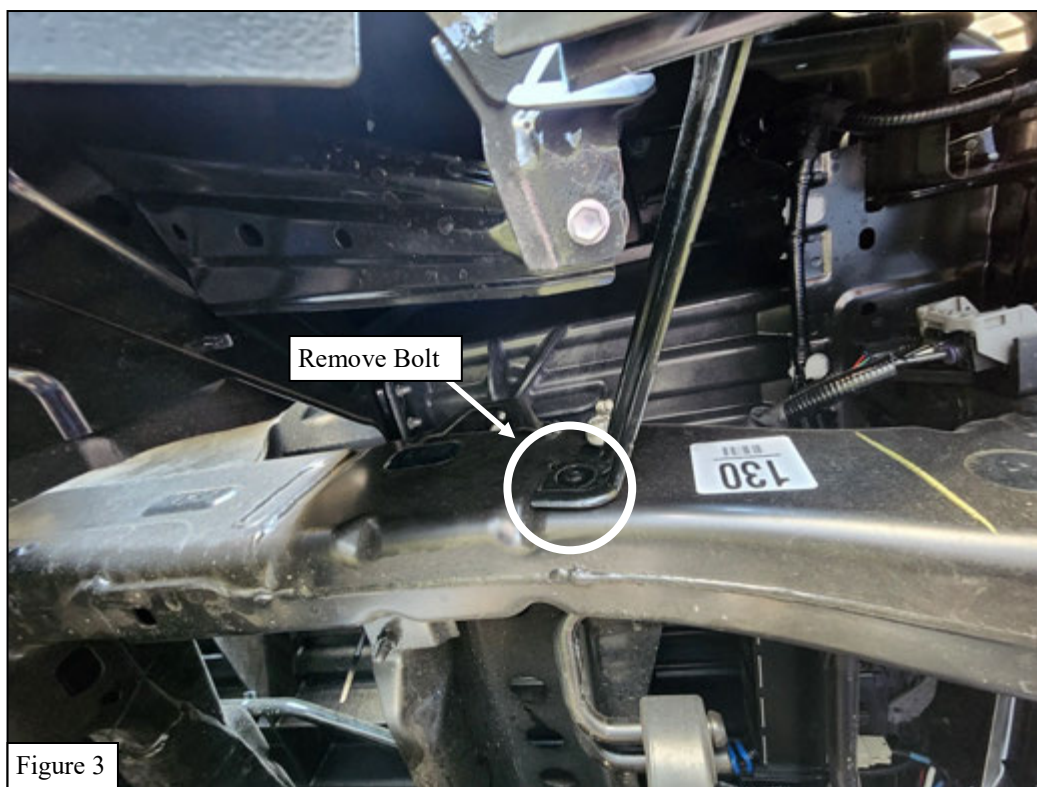
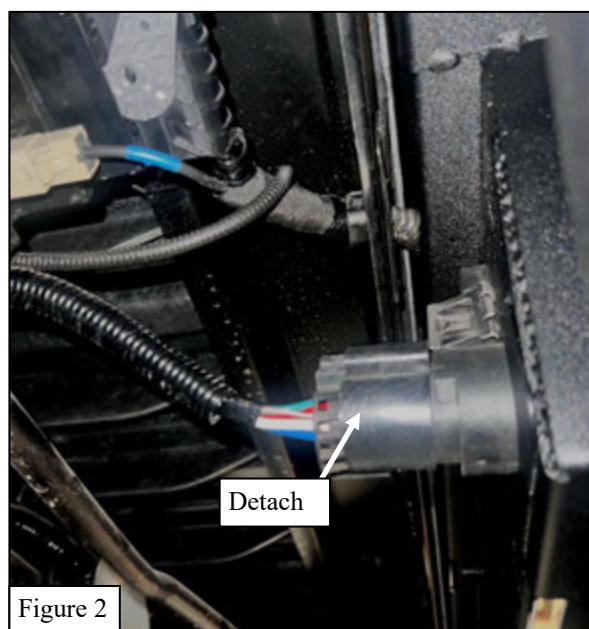
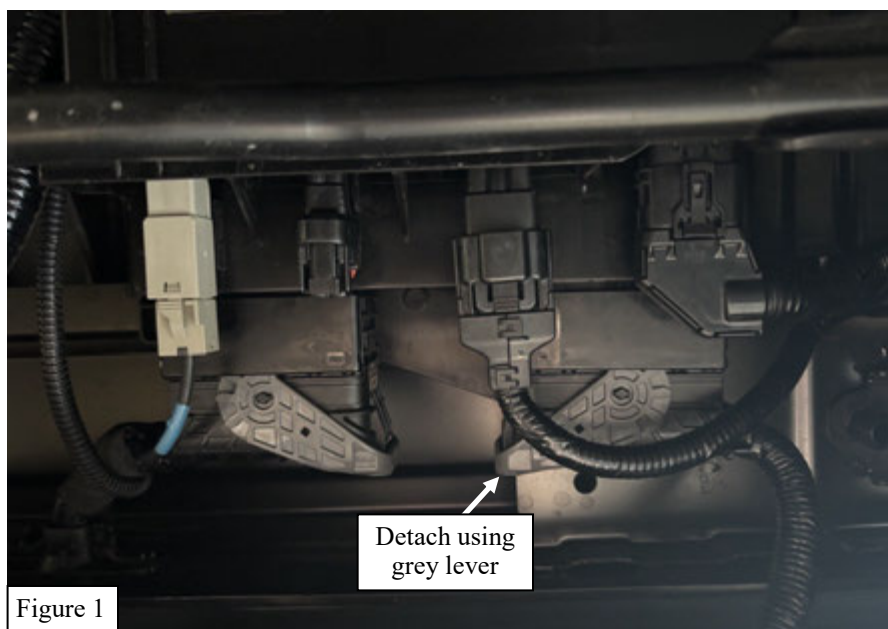

5. Remove the (4) panels on the top of the bumper and remove the nuts located inside. Use a plastic pry tool to remove the bumper panels. See **Figures 4 and 5**.

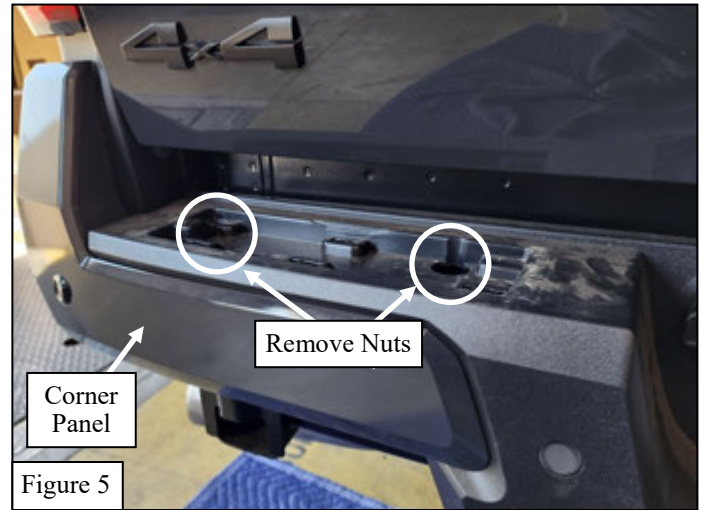

6. Remove the rear bumper from the vehicle.
7. Remove the corner panels from the rear bumper. Remove all push pin clips retaining the corner panels by pressing the center of the push pin and pulling it out. See **Figure 5**.
8. Gently pry and pull the (4) parking sensors from the bezels. For each sensor, pull each side of the bezel clip away from the sensor and pull the sensor out. Be sure to keep the rubber gaskets on the parking sensors. Disconnect the sensors from the bumper wiring harness. Release each sensor from the wiring harness by pulling the locking tab and then pressing it down.
9. Disconnect the keyless entry antenna located at the center of the bumper by removing the nut holding it in place.
10. Disconnect and remove the trailer plug located on the inside of the bumper.

11. Remove the blind spot sensors from each side of the bumper. For each sensor, remove the nuts holding it in place. Disconnect the sensor from the wiring harness by pressing the release tab and pulling the plug. See **Figure 6**.
12. Grind the studs located near the hitch off of the frame. See **Figure 7**.

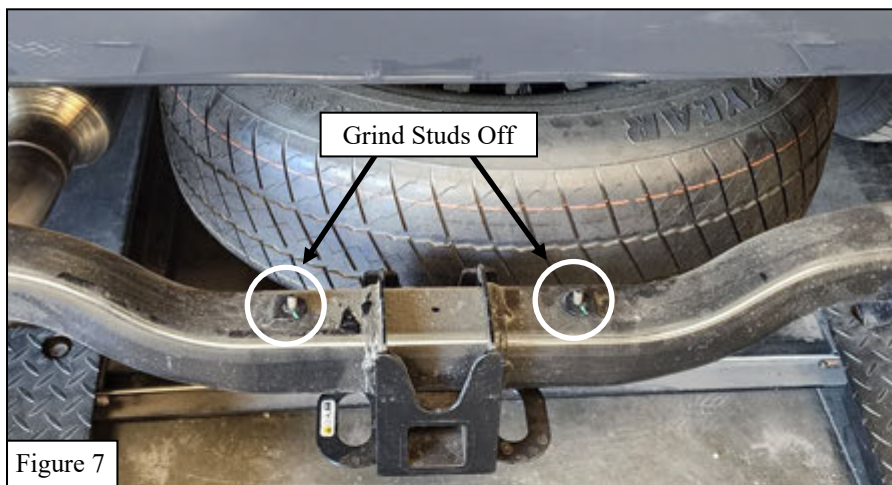
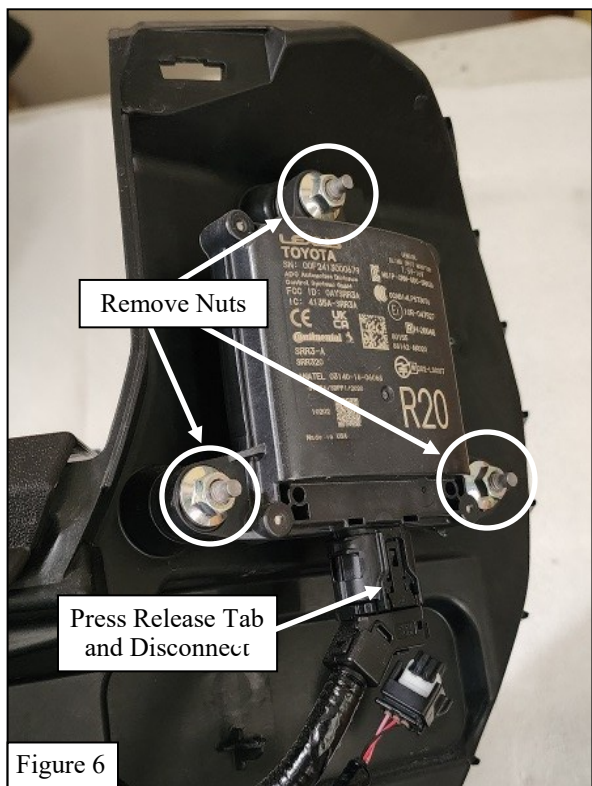

13. Remove the clips on the side of the frame on the driver and passenger side. See **Figure 8**.
14. Loosely install the mounting brackets (items 2 and 3) using the M12 hardware (items 16-19). Figures 8 and 9.

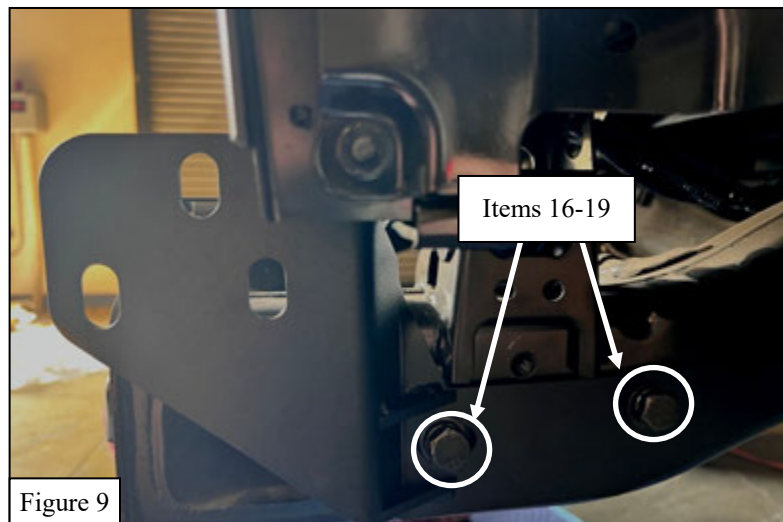
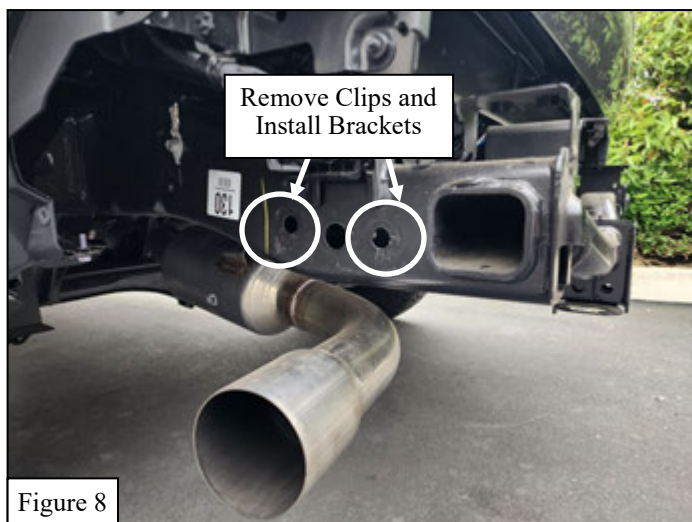

15. Attach the blind spot sensors onto the sensor brackets (**items 6 and 7**) using the M6 Hex head hardware (**items 12-15**). Tighten the M6 hardware to 7-8 lb-ft. See **Figures 10-12**.



Figure 10



Figure 11

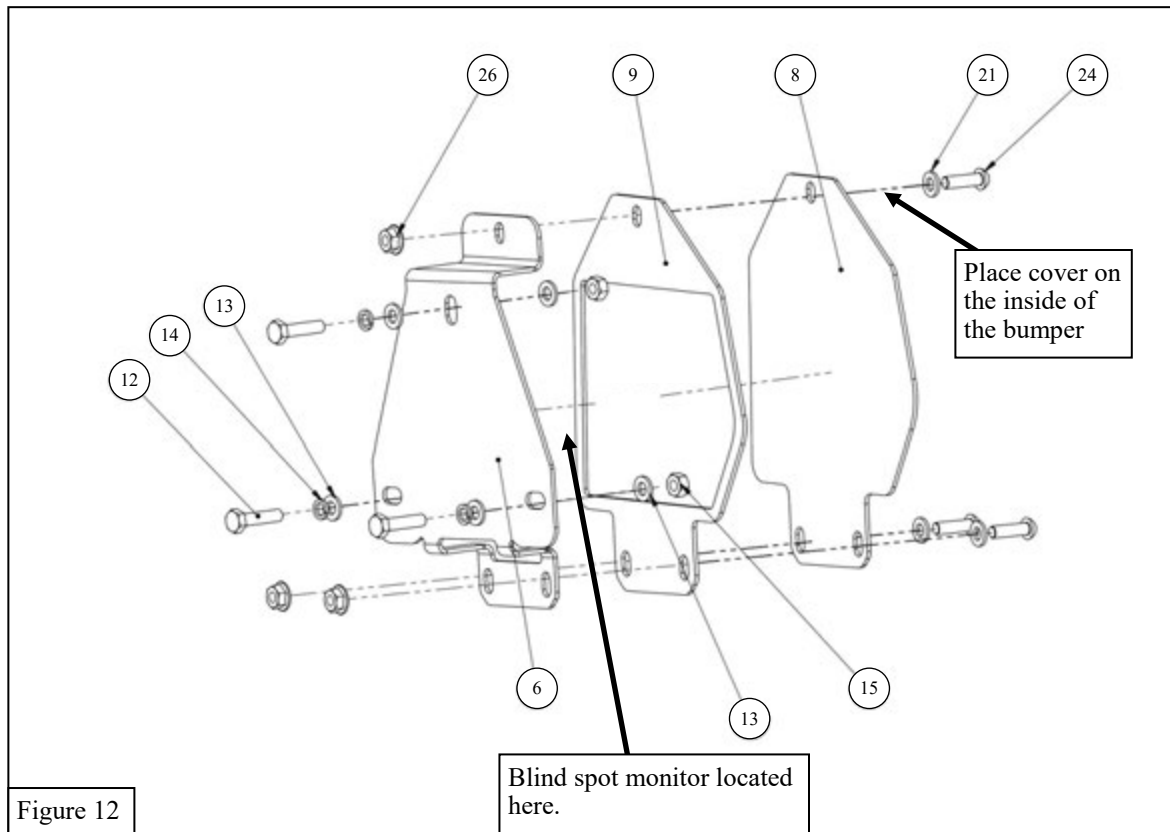
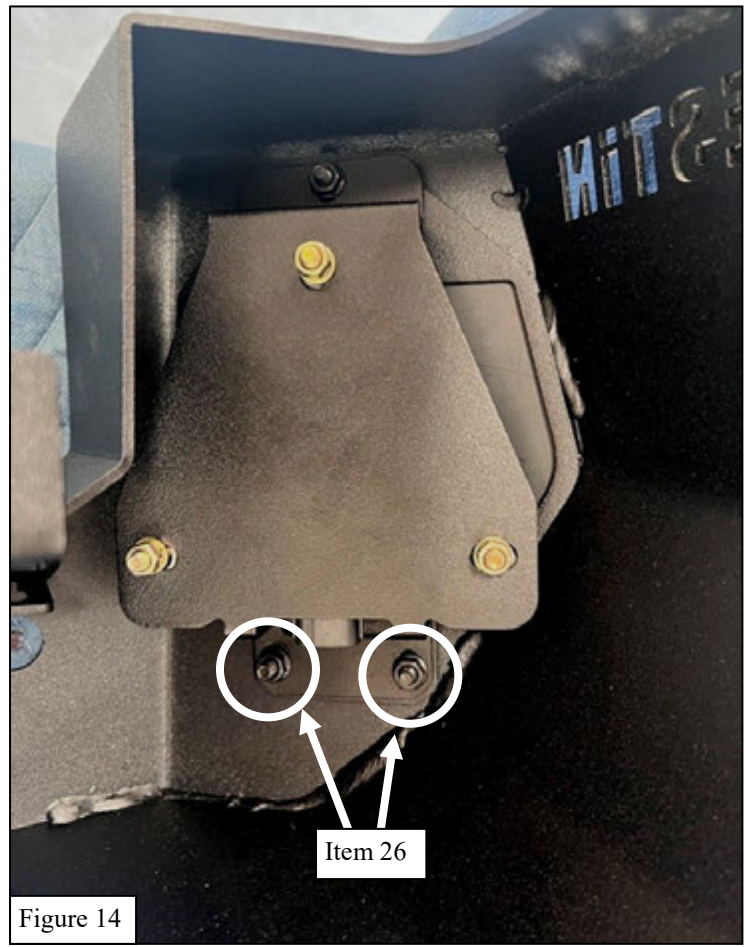
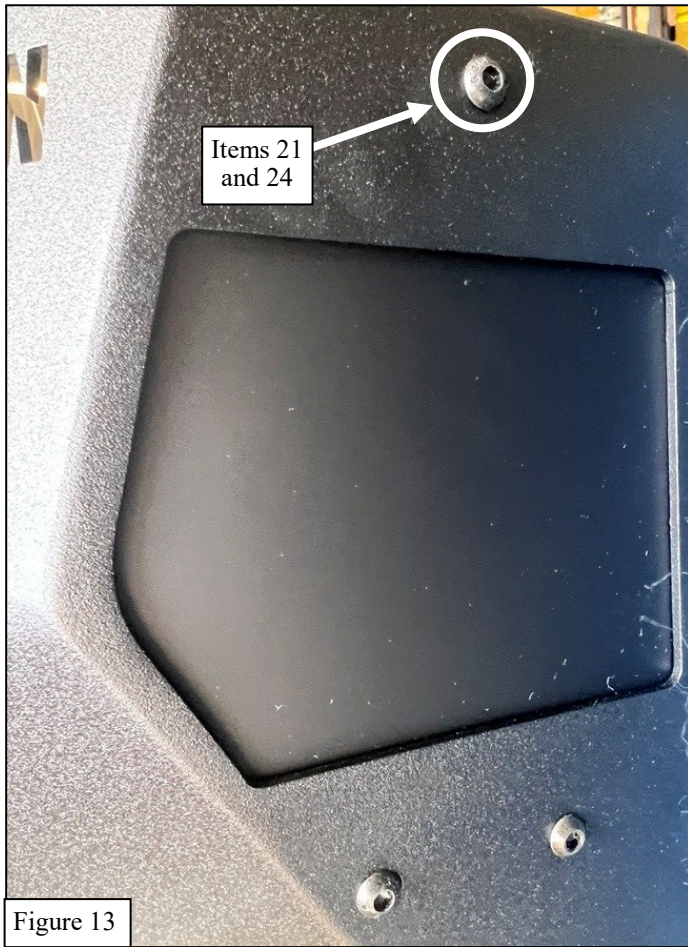

Figure 12

16. Install the sensor cover (**item 8**), sensor plate (**item 9**), and sensor brackets (**items 6 and 7**) onto the bumper using the M6 hardware (**items 21, 24, and 26**). Tighten the M6 hardware to 7-8 lb-ft. See **Figures 12-14**.



17. If parking sensors are equipped, install the sensors in the pro-series bumper. Loosely install the Sensor L-Tabs (**item 5**) using the M6 hardware (**items 20-23**). Remove the plugs from the parking sensor holes. Place a piece of double sided tape on the back of each parking sensor. Make sure the OEM rubber grommets are still in place on the parking sensors. Place the sensors in the parking sensor holes. Center the parking sensors in the holes and keep them in place by pressing the Sensor L-tabs against the back of the parking sensors. Tighten the M6 hardware 7-8 lb-ft. See **Figures 15 and 16**.
18. If lights (**PN 09-1918FM6**) are being installed, remove the mesh covers and install them in the slots. Secure them with the hardware provided with the lights.
19. Install the wiring harness to the blind spot monitor and parking sensors.
20. Install the trail plug onto the bumper.

Note: Lights are sold separately.

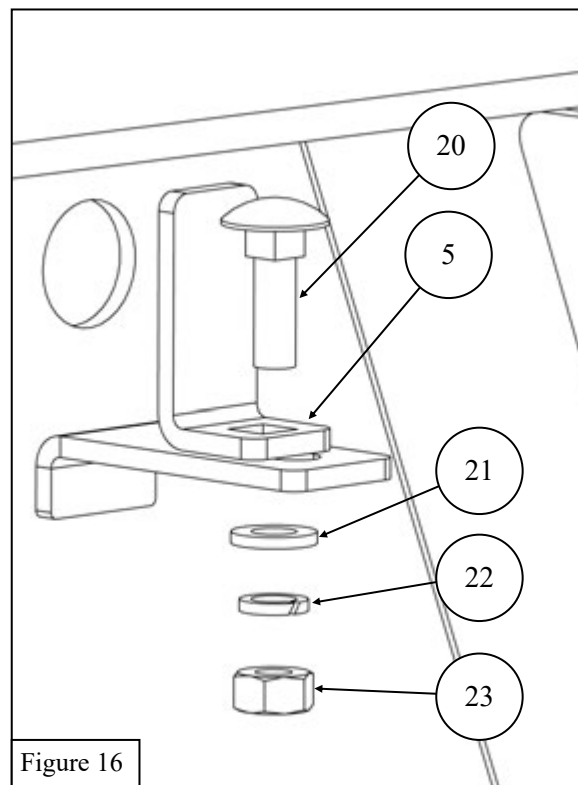
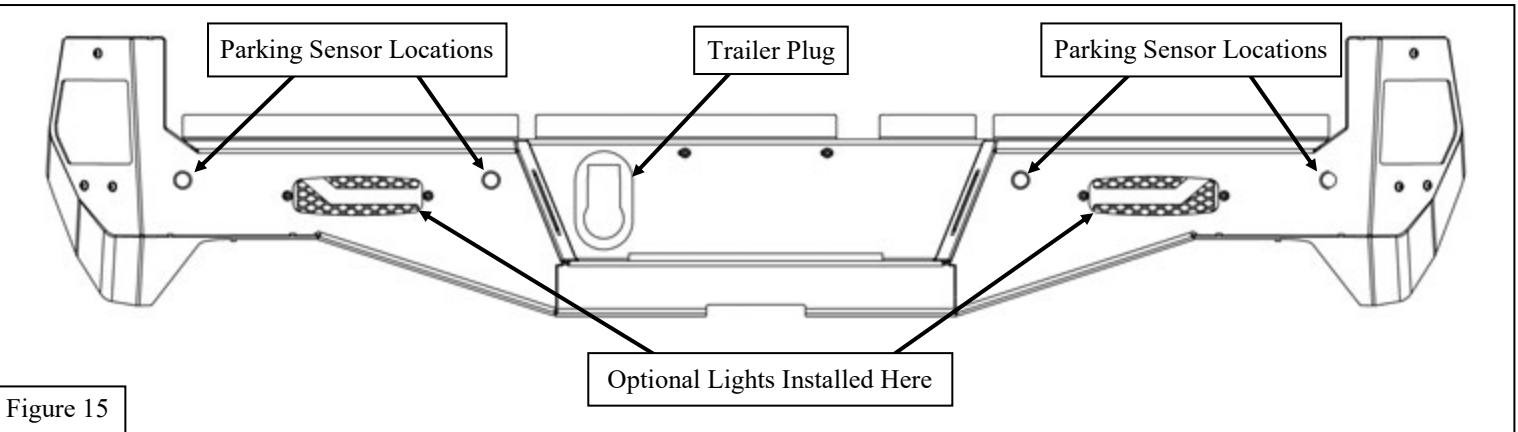
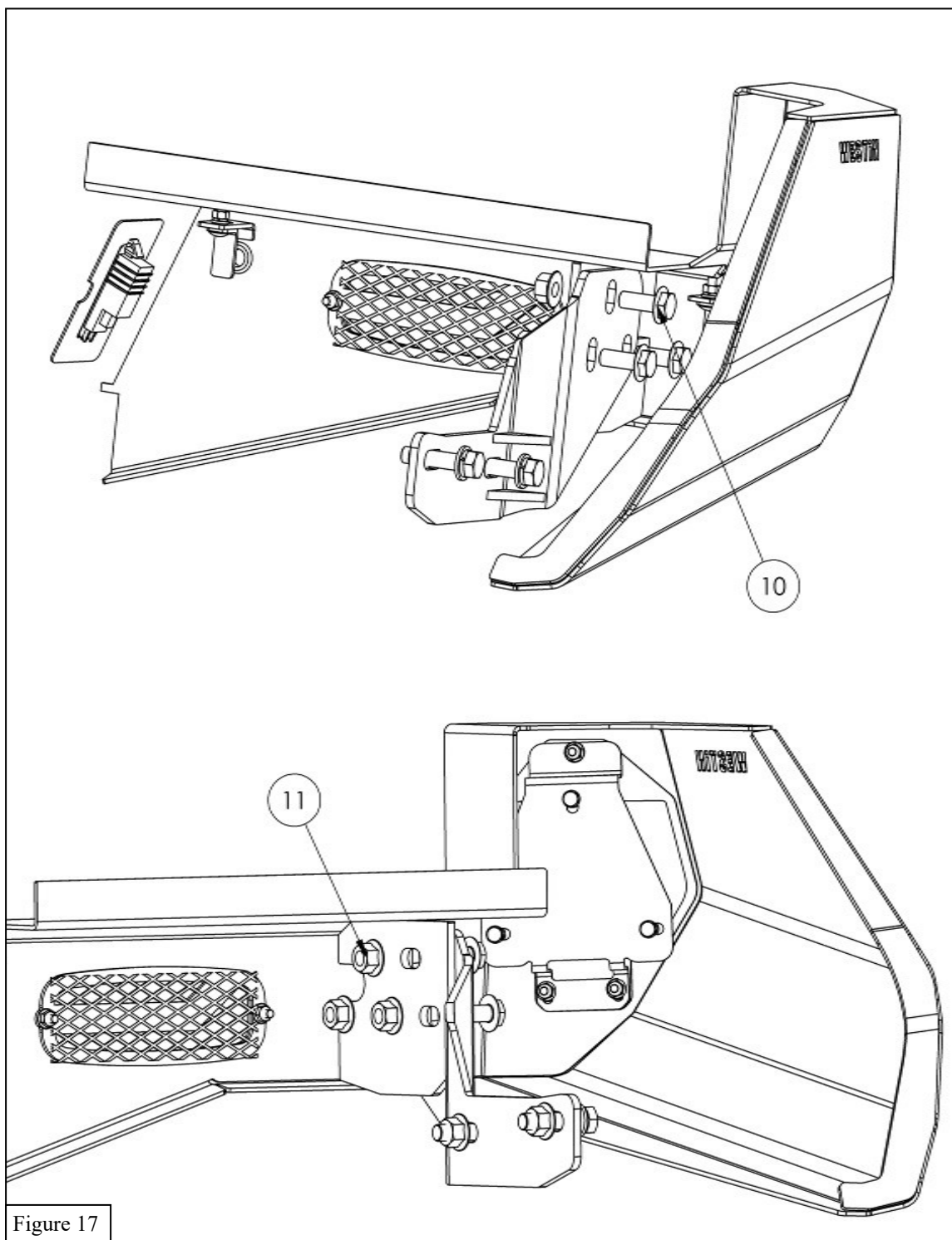

Figure 16

21. Mount the bumper onto the mounting brackets using M12 hardware (items 10 and 11) See Figure 17.
22. Connect the rear bumper wiring harness and trailer plug.
23. Adjust the bumper and tighten the M12 Hardware to **70 lb-ft.**
24. Install the rear license plate using the M6 hardware (items 21, 22, 26, and 25). Tighten the M6 hardware to 7-8 lb-ft.



Westin Automotive Products, Inc.
320 W. Covina Blvd
San Dimas, Ca. 91773

Thank you for choosing Westin products
for additional installation assistance please call
Customer Service (800) 793-7846
www.westinautomotive.com

INSTALLATION COMPLETE



CARE INSTRUCTIONS

- REGULAR WAXING IS RECOMMENDED. DO NOT USE ANY TYPE OF POLISH OR WAX THAT MAY CONTAIN ABRASIVES.
- GLOSS BLACK FINISHES SHOULD BE CLEANED WITH MILD SOAP AND WATER.

WESTIN

Westin Automotive Products, Inc.
320 W. Covina Blvd
San Dimas, Ca. 91773

Thank you for choosing Westin products
for additional installation assistance please call
Customer Service (800) 793-7846
www.westinautomotive.com



WARNING



Failure to follow these instructions could lead to death, personal injury, and / or property damage.

Failure to follow these instructions could lead to death, personal injury, and / or property damage.

FASTENERS:

All Westin supplied fasteners must be utilized and installed in accordance with the installation instructions and apply torque to the specifications as defined. **DOUBLE CHECK ALL FASTENERS BEFORE INITIAL USE, AND PERIODICALLY IN THE FUTURE TO ENSURE PROPER FUNCTION AND SAFETY.**

DRILLING:

Most Westin products do not require drilling for installation. If drilling is defined as required, use caution when drilling a vehicle. **FAILURE TO REVIEW AN AREA TO BE DRILLED MAY RESULT IN PERSONAL INJURY AND/OR INJURY TO OTHERS AS WELL AS VEHICLE DAMAGE.**

EYE PROTECTION:

ALWAYS WEAR SAFETY GLASSES OR GOGGLES DURING THE INSTALLATION PROCESS TO AVOID PERSONAL INJURY.

MAXIMUM TOWING/CARRYING CAPACITY: (if applicable)

The Westin Receiver Hitches will have a visible tow rating label affixed directly on the product. User should never exceed the vehicle manufacturers maximum tow and weight rating regardless of the capacity of the hitch. **FAILURE TO FOLLOW THESE GUIDELINES WILL VOID THE WESTIN WARRANTY AND MAY RESULT IN PERSONAL INJURY AND/OR INJURY TO OTHERS AS WELL AS VEHICLE DAMAGE.**

FOR CALIFORNIA RESIDENTS ONLY-PROP 65 WARNING:

Some products may contain chemicals such as DEHP, which can cause cancer, birth defects or other reproductive harm. For more info go to www.p65warnings.ca.gov



Westin Automotive Products, Inc.
320 W. Covina Blvd
San Dimas, Ca. 91773