

INSTALLATION INSTRUCTIONS

PRO SERIES REAR BUMPER



APPLICATION:
2021 Ford Bronco
PART NUMBER:
58-421255

CONTENT			
ITEM	QUANTITY	DESCRIPTION	TOOLS NEEDED
1	1	REAR BUMPER ASSEMBLY	10MM SOCKET
2	4	SENSOR L-TAB	10MM WRENCH
3	4	SENSOR HOLE PLUG	19MM SOCKET
4	2	M12 BOLT PLATE	19MM WRENCH
5	4	M6 ROUND HEAD SQUARE NECK BOLT	TRIMMING TOOL
6	4	M6 SPLIT LOCK WASHER	RATCHET
7	4	M6 FLAT WASHER	TORQUE WRENCH
8	4	M6 HEX NUT	
9	2	M12 HEX NUT	
10	2	M12 SPLIT LOCK WASHER	
11	2	M12 FLAT WASHER	
12	2	SENSOR HARNESS EXTENSION	
13	1	LIGHT CUTOUT COVER ,PASSENGER	
14	1	LIGHT CUTOUT COVER ,DRIVER	
15	4	M6 BUTTON HEAD BOLT	
16	4	M6 SERRATED FLANGE NUT	

ANTI-SEIZE LUBRICANT MUST BE USED ON ALL STAINLESS STEEL FASTENERS TO PREVENT THREAD DAMAGE AND GALLING

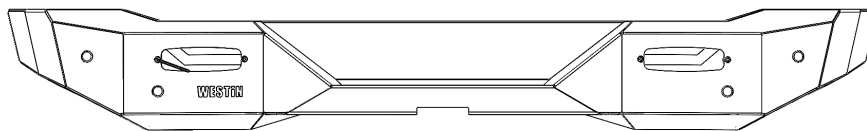

ITEM 1

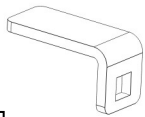

ITEM 2

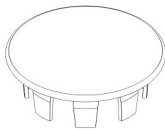

ITEM 3

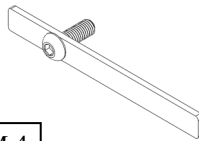

ITEM 4



ITEM 13

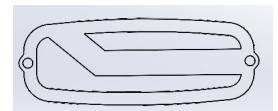

ITEM 14

PROCEDURE

1. Remove contents from box, verify if all parts listed are present and free from damage.
Carefully read and understand all instructions before attempting installation.
Failure to identify damage before installation could lead to a rejection of any claim.



Westin Automotive Products, Inc.
320 W. Covina Blvd
San Dimas, Ca. 91773

2. Disconnect the electrical plugs from the rear bumper located on each side along the frame rail.
3. Remove the 3 OEM bolts on each side of the rear bumper. See **Figure 1** for reference.
4. Carefully remove the rear bumper. **Note:** Assistance may be needed removing the bumper.

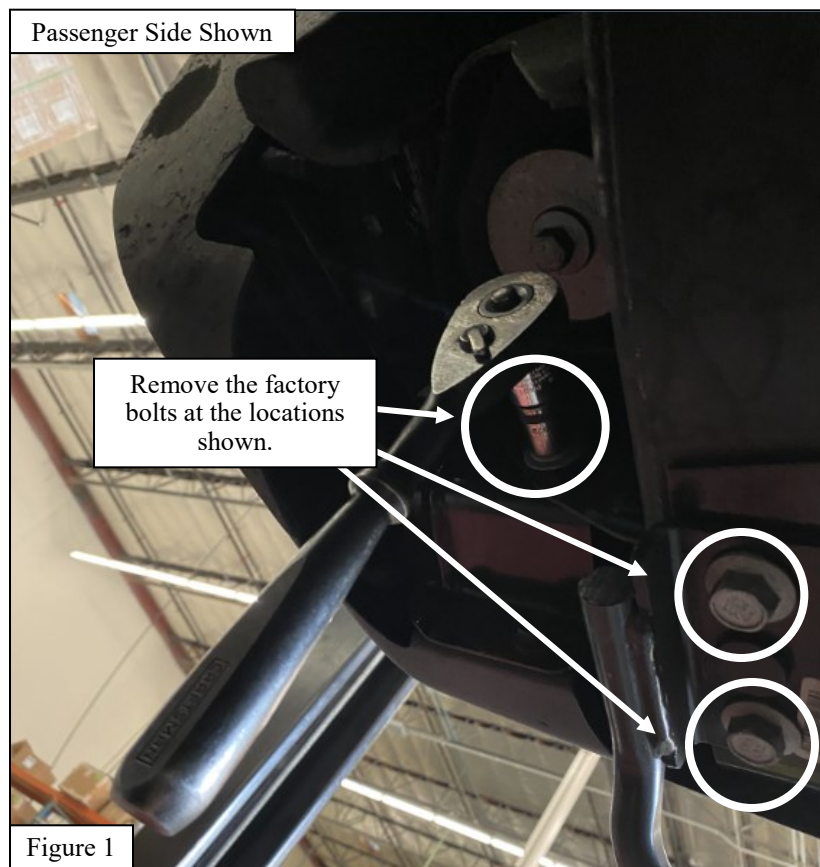

5. Once the OEM bumper is removed from the vehicle, remove the OEM parking sensors and the OEM wiring harness. Remove the sensors carefully by using a flat head screwdriver or pry tool to remove the sensors as shown. See **Figures 2 through 4** for reference.

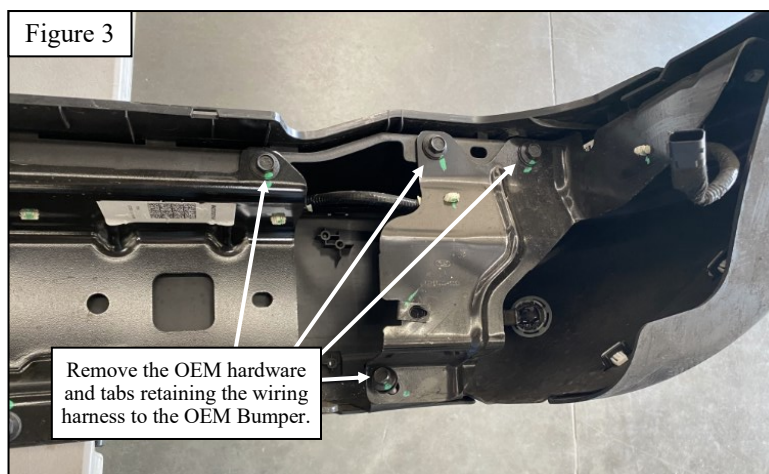
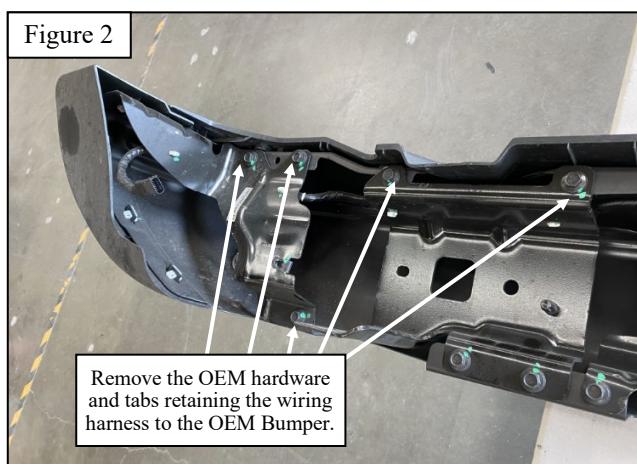
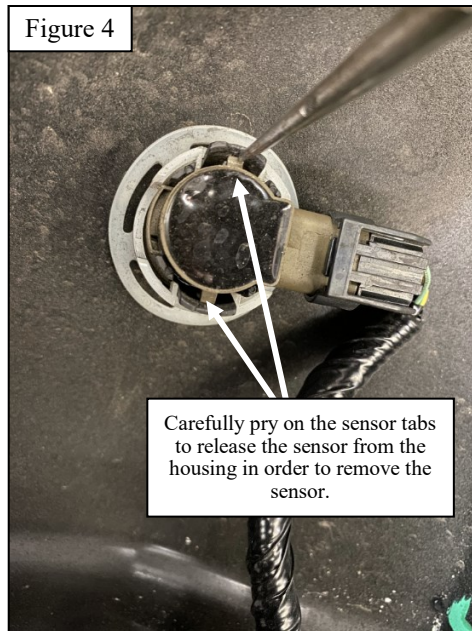

Figure 4



PARKING SENSOR INSTALLATION

If not installing the parking sensors, install Hole Plugs into the holes on the bumper and proceed.

6. Make sure to reuse the factory rubber grommet to isolate the sensor from the metal.
7. Use the Sensor Tab (Item 4) along with the supplied M6 Hardware (items 5-8) to install the sensors as shown in **Figures 5 through 8.**
8. Carefully route the harness around the bumper. **Note:** Zip ties or double sided tape can be used to route the wiring harness and to hold the sensors in position. The wiring harness extensions (Item 12) may also be used as necessary.

Figure 5

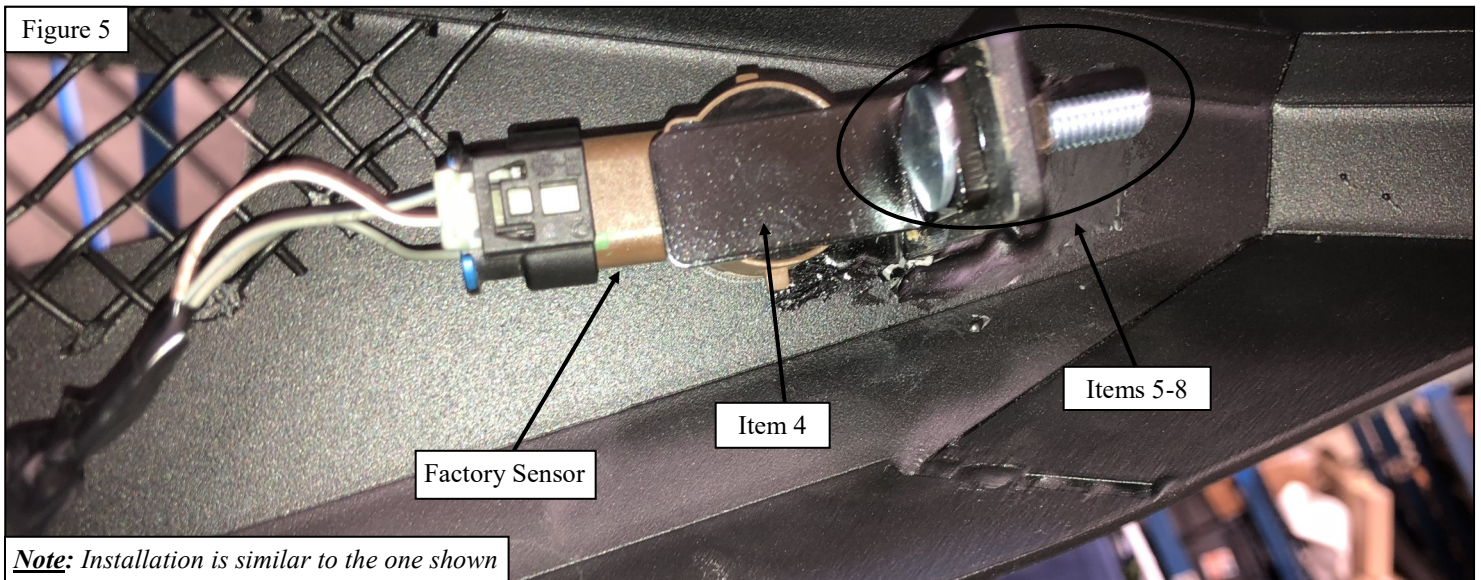

Figure 6

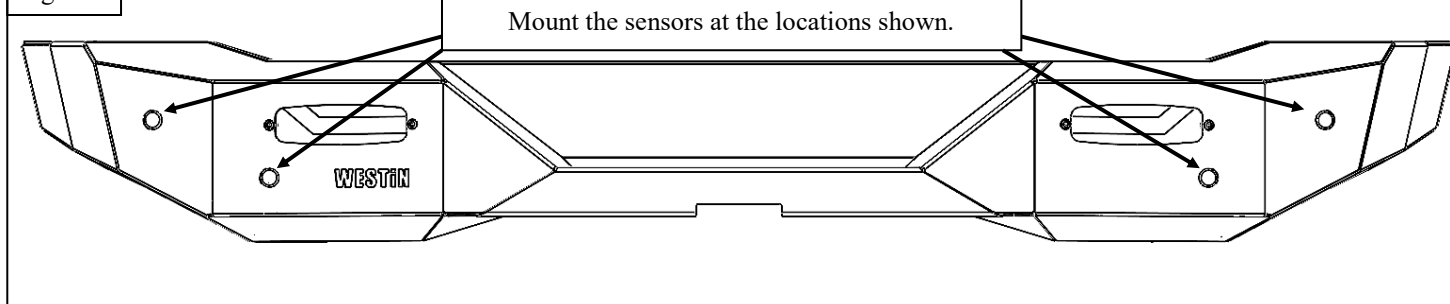
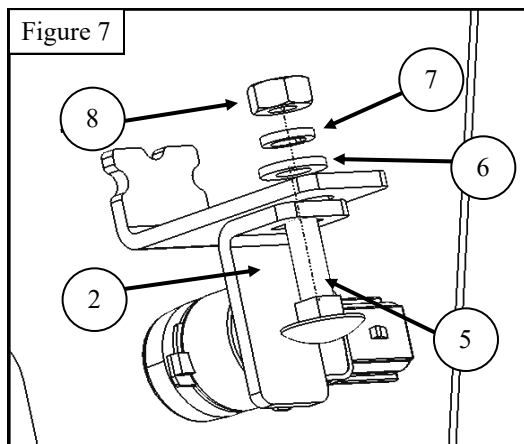

Figure 7



9. Install any bumper accessories prior to installing the bumper onto the vehicle.
 10. Using the OEM hardware, loosely secure the Pro-Series bumper assembly to the OEM mounting locations. See **Figure 8** for reference.
- Note:** Assistance may be needed to lift the bumper onto the vehicle.
11. Using the supplied M12 bolt plate and M12 hardware (Items 5, 9-11), loosely secure the Pro-Series bumper assembly to the OEM upper mounting locations on both sides of the bumper. See **Figure 9** for reference.

Figure 8

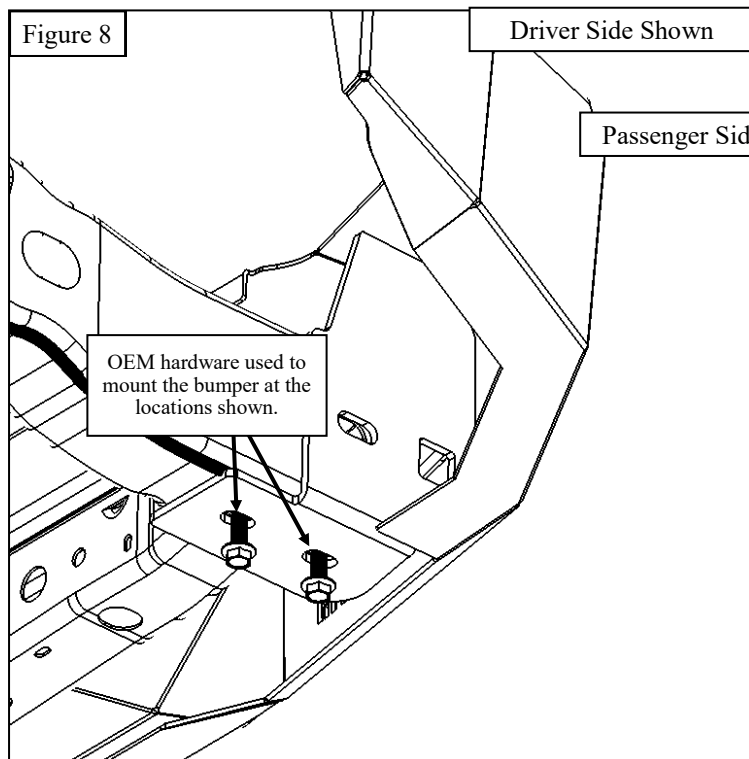
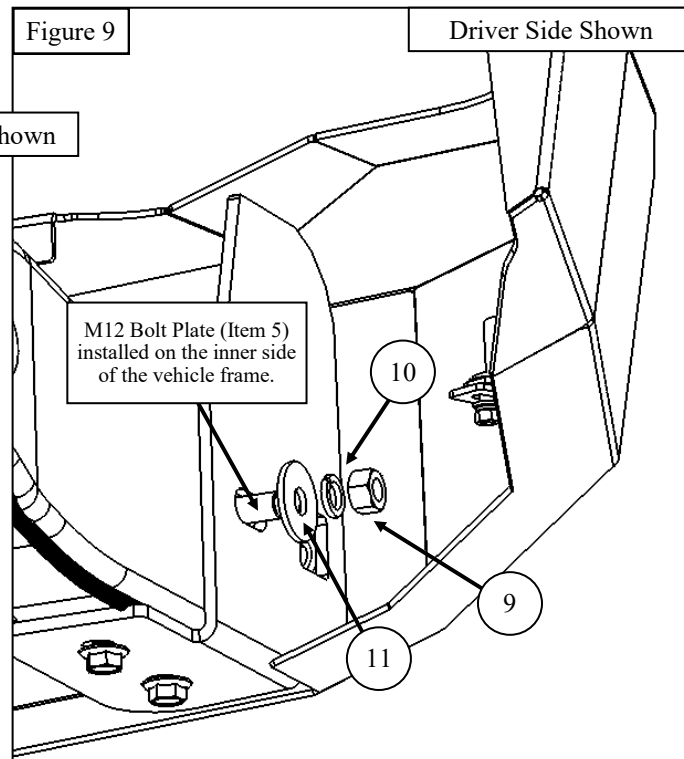

Figure 9



12. After you have mounted bumper on the vehicle, CAREFULLY open the tailgate. While tailgate is open, align and adjust the height of the bumper so that it has about 3/8" of clearance with respect to the tailgate. Tighten and torque M12 to 50-55 ft-lbs.

INSTALLATION COMPLETE



CARE INSTRUCTIONS

- REGULAR WAXING IS RECOMMENDED. DO NOT USE ANY TYPE OF POLISH OR WAX THAT MAY CONTAIN ABRASIVES.
- STAINLESS STEEL PRODUCTS CAN BE CLEANED WITH MILD SOAP AND WATER. STAINLESS STEEL POLISH SHOULD BE USED TO POLISH SMALL SCRATCHES.
- GLOSS BLACK FINISHES SHOULD BE CLEANED WITH MILD SOAP AND WATER.

WESTIN

Westin Automotive Products, Inc.
320 W. Covina Blvd
San Dimas, Ca. 91773

P.N.: 75-58421255-RevA

ECO #: W21-0064

Thank you for choosing Westin products
for additional installation assistance please call
Customer Service (800) 793-7846
www.westinautomotive.com

DATE: 04/07/2022



WARNING



Failure to follow these instructions could lead to death, personal injury, and / or property damage.

Failure to follow these instructions could lead to death, personal injury, and / or property damage.

FASTENERS:

All Westin supplied fasteners must be utilized and installed in accordance with the installation instructions and apply torque to the specifications as defined. **DOUBLE CHECK ALL FASTENERS BEFORE INITIAL USE, AND PERIODICALLY IN THE FUTURE TO ENSURE PROPER FUNCTION AND SAFETY.**

DRILLING:

Most Westin products do not require drilling for installation. If drilling is defined as required, use caution when drilling a vehicle. **FAILURE TO REVIEW AN AREA TO BE DRILLED MAY RESULT IN PERSONAL INJURY AND/OR INJURY TO OTHERS AS WELL AS VEHICLE DAMAGE.**

EYE PROTECTION:

ALWAYS WEAR SAFETY GLASSES OR GOGGLES DURING THE INSTALLATION PROCESS TO AVOID PERSONAL INJURY.

MAXIMUM TOWING/CARRYING CAPACITY: (if applicable)

The Westin Receiver Hitches will have a visible tow rating label affixed directly on the product. User should never exceed the vehicle manufacturers maximum tow and weight rating regardless of the capacity of the hitch. **FAILURE TO FOLLOW THESE GUIDELINES WILL VOID THE WESTIN WARRANTY AND MAY RESULT IN PERSONAL INJURY AND/OR INJURY TO OTHERS AS WELL AS VEHICLE DAMAGE.**

FOR CALIFORNIA RESIDENTS ONLY-PROP 65 WARNING:

Some products may contain chemicals such as DEHP, which can cause cancer, birth defects or other reproductive harm. For more info go to www.p65warnings.ca.gov



Westin Automotive Products, Inc.
320 W. Covina Blvd
San Dimas, Ca. 91773