



# INSTALLATION INSTRUCTIONS

## HDX WINCH MOUNT MODULAR GRILLE GUARD

### APPLICATION:

2019-2021 Ford Ranger

### PART NUMBER:

Grille Guard Kit: 57-33985A

Kit Number: 57-33985  
Winch Tray Kit: 46-23985

CONTENT			
ITEM	QUANTITY	DESCRIPTION	TOOLS NEEDED
1	1	WINCH TRAY	13MM SOCKET
2	1	LOWER DRIVER SIDE MOUNTING BRACKET	15MM SOCKET
3	1	LOWER PASSENGER SIDE MOUNTING BRACKET	18MM SOCKET
4	1	DRIVER SIDE LOWER SUPPORT BRACKET	19MM SOCKET
5	1	PASSENGER SIDE LOWER SUPPORT BRACKET	21MM SOCKET
6	4	M12 HEX HEAD BOLT ( <i>YELLOW ZINC</i> )	13MM WRENCH
7	8	M12 SPLIT LOCK WASHER ( <i>YELLOW ZINC</i> )	15MM WRENCH
8	8	M12 FLAT WASHER ( <i>YELLOW ZINC</i> )	18MM WRENCH
9	4	M12 HEX NUT ( <i>YELLOW ZINC</i> )	19MM WRENCH
10	6	M12 HEX HEAD BOLT ( <i>BLACK ZINC</i> )	21MM WRENCH
11	6	M12 SPLIT LOCK WASHER ( <i>BLACK ZINC</i> )	TORQUE WRENCH
12	12	M12 FLAT WASHER ( <i>BLACK ZINC</i> )	PRY TOOL
13	6	M12 HEX NUT ( <i>BLACK ZINC</i> )	ALLEN KEY SET
14	4	M12 RETAINER	RATCHET
15	4	M12 FISH WIRE	
16	4	M12 BOLT PLATE	
17	2	M12 NUT PLATE	
18	1	HDX GRILLE GUARD BASE	
HARDWARE ITEMS BELOW ARE INCLUDED WITH THE GRILLE GUARD KIT			
19	1	HDX DRIVER WING	
20	1	HDX PASSENGER WING	
21	1	DRIVER SIDE UPPER SUPPORT STRAP	
22	1	PASSENGER SIDE UPPER SUPPORT STRAP	
23	2	M10 BUTTON HEAD BOLT ( <i>BLACK ZINC</i> )	
24	2	M10 CUP WASHER ( <i>BLACK ZINC</i> )	
25	2	M10 SERRATED FLANGE NUT ( <i>BLACK ZINC</i> )	
26	6	M12 HEX HEAD BOLT ( <i>BLACK ZINC</i> )	
27	6	M12 CUP WASHER ( <i>BLACK ZINC</i> )	
28	6	M12 SERRATED FLANGE NUT ( <i>BLACK ZINC</i> )	

29	10	M8 HEX SOCKET BUTTON HEAD BOLT ( <i>BLACK ZINC</i> )	
30	10	M8 BELLVILLE WASHER ( <i>BLACK ZINC</i> )	
31	10	M8 SERRATED FLANGE NUT ( <i>BLACK ZINC</i> )	
<b>ANTI-SEIZE LUBRICANT MUST BE USED ON ALL STAINLESS STEEL FASTENERS TO PREVENT THREAD DAMAGE AND GALLING</b>			

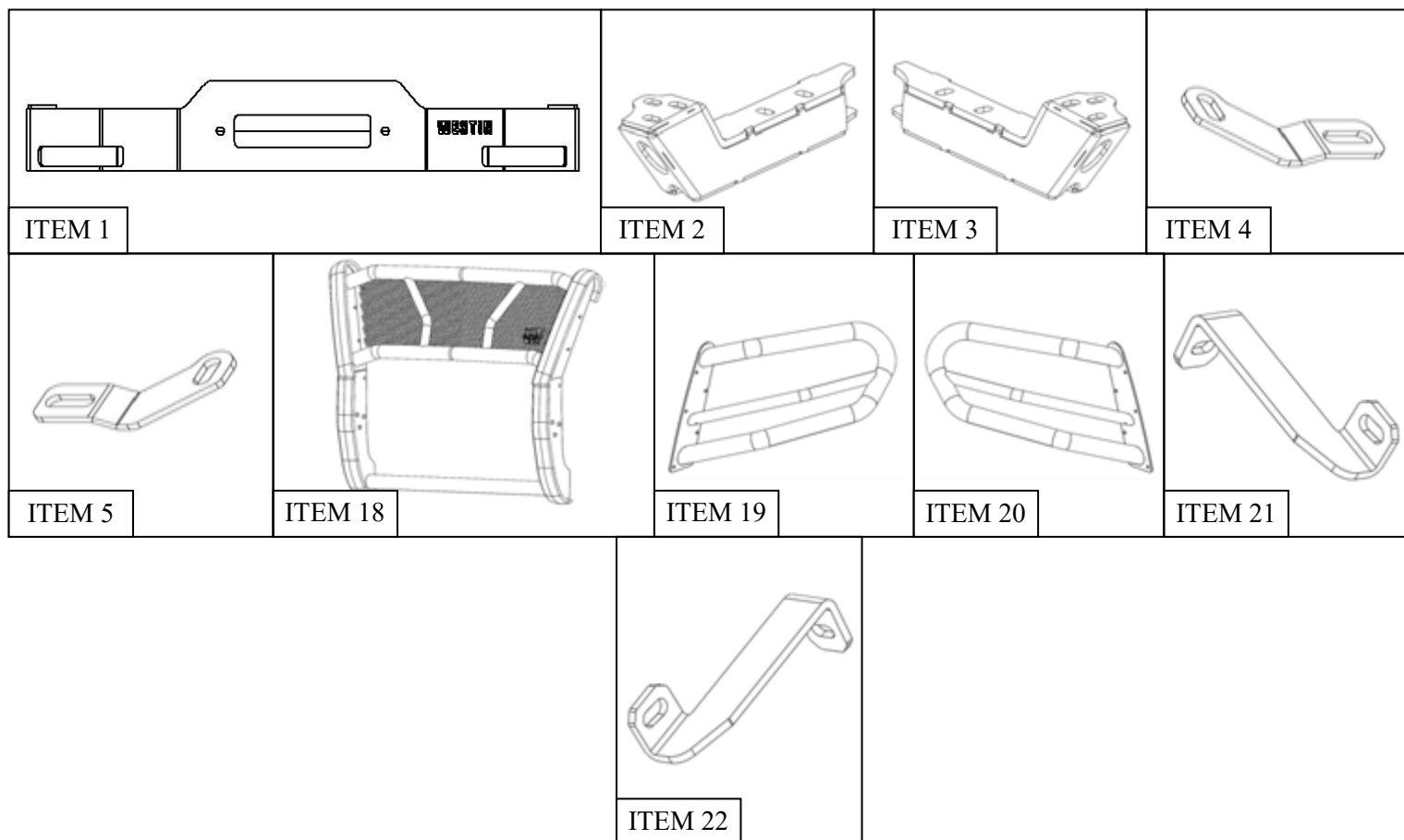

### PROCEDURE

1. Remove contents from box, verify if all parts listed are present and free from damage.  
Carefully read and understand all instructions before attempting installation.  
**Failure to identify damage before installation could lead to a rejection of any claim.**

**IF INSTALLING WINCH TRAY ONLY SKIP TO PAGE 5**

**IF INSTALLING WINCH MOUNT GRILLE GUARD WITH THE WINCH TRAY CONTINUE HERE ON PAGE 2**

2. Remove the five lower clips located underneath the front end of the bumper. See **Figure 1** for reference.
3. Carefully remove the front bumper cover by pulling from the bottom up. See **Figure 2** for reference.



Westin Automotive Products, Inc.  
320 W. Covina Blvd  
San Dimas, Ca. 91773

Thank you for choosing Westin products  
for additional installation assistance please call  
Customer Service (800) 793-7846  
www.westinautomotive.com

DATE: 07/07/2022

Figure 1

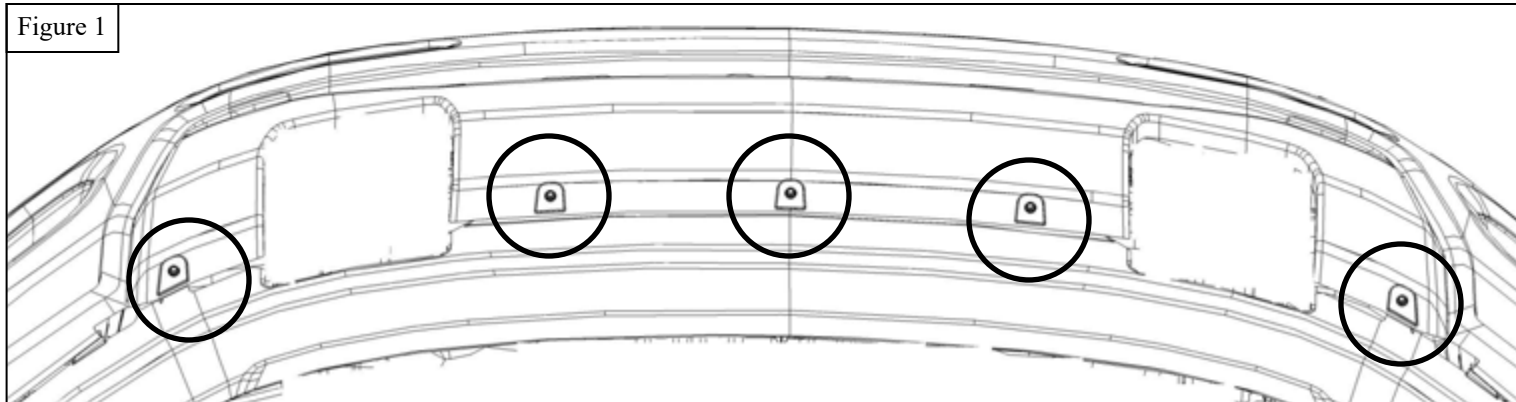

Figure 2



4. With the now exposed bumper plate, unbolt the bumper. See **Figure 3** for reference.
5. Unplug any wiring connections from the factory bumper. See **Figure 4** for reference.
6. Remove the bumper.

Figure 3



**WESTIN**

Westin Automotive Products, Inc.  
320 W. Covina Blvd  
San Dimas, Ca. 91773

Figure 4



7. Remove the factory bolt and install the upper support strap (Items 21-22) with previously removed factory bolt. See **Figure 5** for reference.
- A. Measure the distance between the upper brackets. Make sure it is 33 1/4 inches. See **Figure 6** for reference.
  - B. Torque the factory bolts to 16 ft-lbs.
  - C. **Re-install the factory bumper and the bumper cover in the order previously removed.**

Figure 5

Driver Side Shown

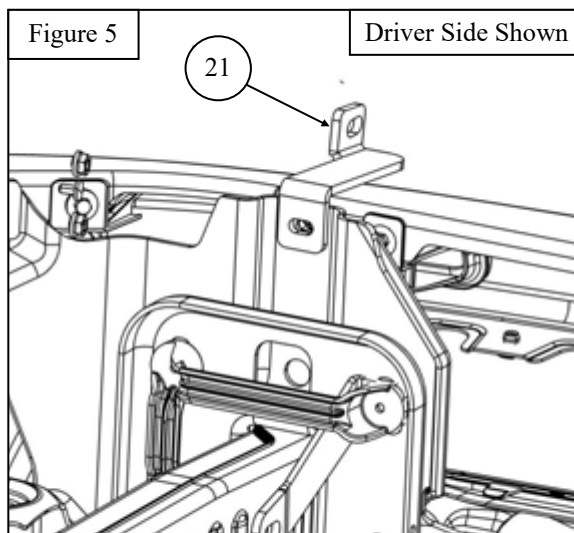

**WESTIN**

Westin Automotive Products, Inc.  
320 W. Covina Blvd  
San Dimas, Ca. 91773



Figure 6

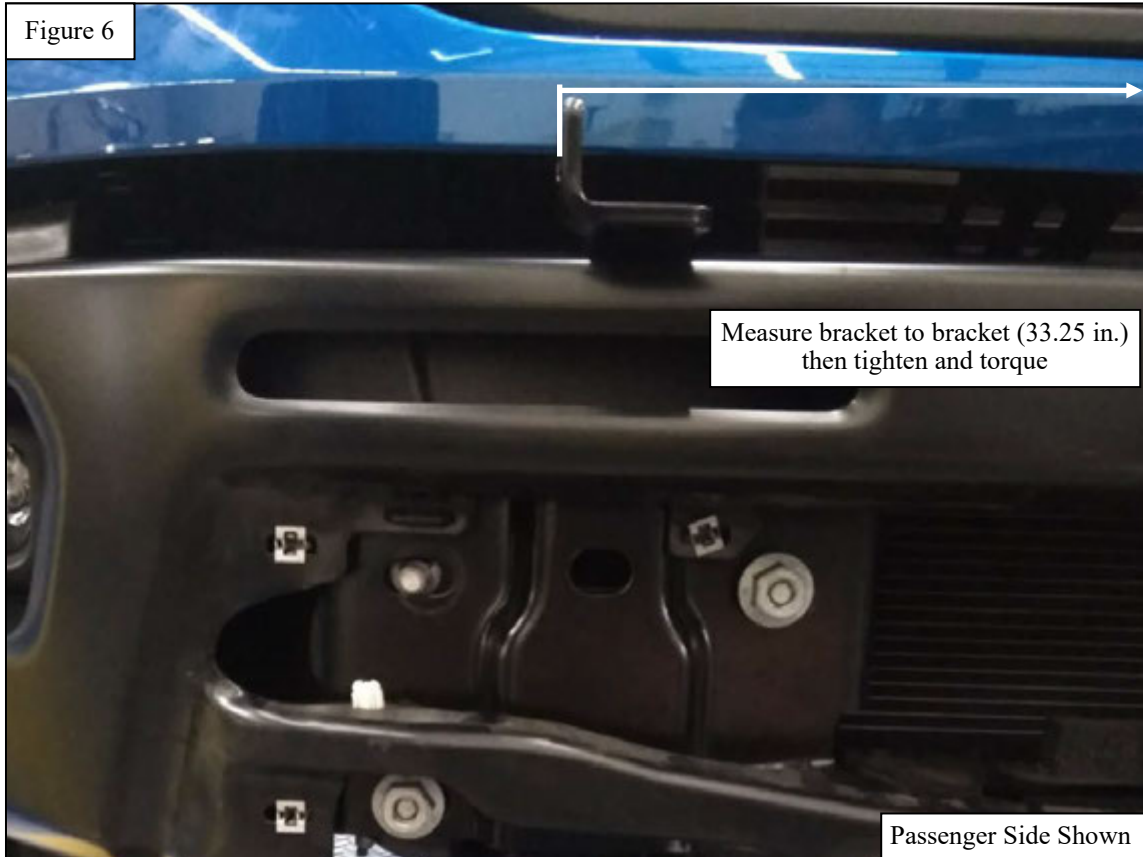

**WINCH TRAY INSTALLATION BEGINS HERE ON PAGE 5 AND ENDS ON PAGE 7**

8. If tow hooks are equipped, remove the tow hooks. See **Figure 7** for reference. ***Note:** Factory tow hooks will not be reused. If tow hooks are not equipped use a cutting tool to cut out the plastic where the tow hook opening would be.*

Figure 7



9. Once tow hooks are removed, cut the lower valence so that the lower mounting bracket have enough clearance to slide through. **Note:** For vehicles without tow hooks, the tow hook pocket area and the valence will have to be trimmed. See **Figure 8** for reference.

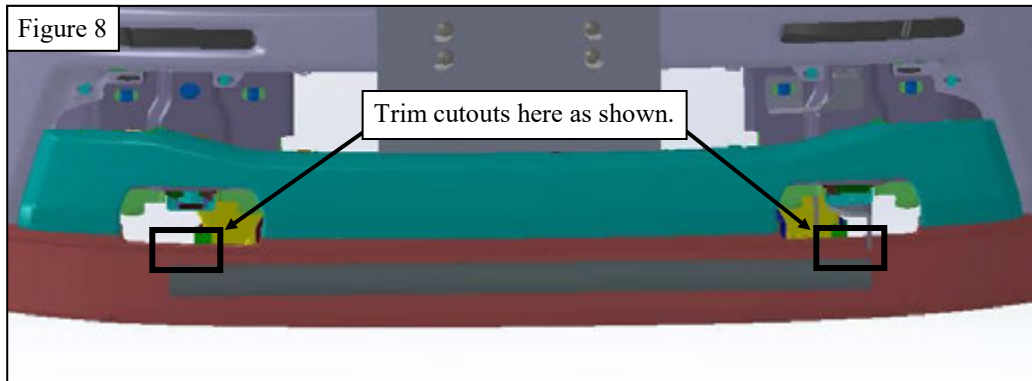

10. Slide the double nut plate (Item 17) through frame and align with the two holes on the bottom of the frame. See **Figure 9** for reference.
11. Once the double nut plate is aligned with the holes, loosely mount the lower mounting bracket with the supplied M12 hardware. See **Figure 10** for reference.

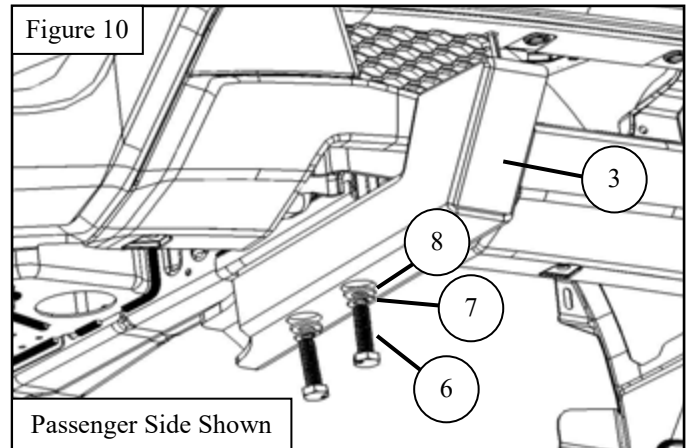
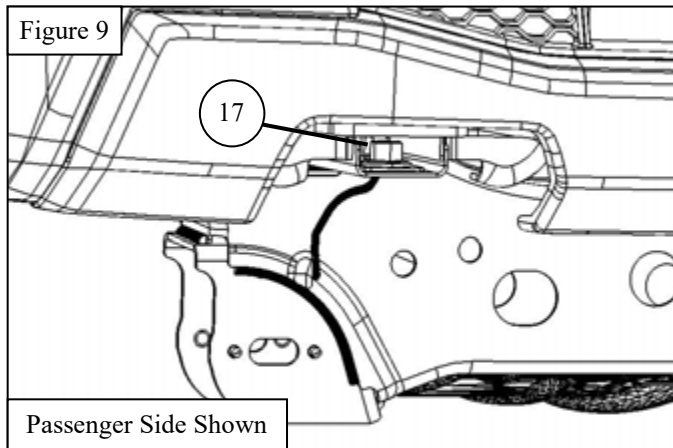

12. Once the lower mounting bracket is loosely mounted, locate a M12 bolt plate and a M12 fish wire. Feed the fish wire through the hole in the frame with the threaded wire going in first. Once the fish wire is out on the open end of the frame, thread the M12 bolt plate to the M12 fish wire. Once sufficiently threaded pull the bolt plate through the hole in the frame. See **Figure 11** for reference.
13. Once the bolt plate is through the hole, thread a retainer clip on the bolt plate so it doesn't fall into the frame. See **Figure 12** for reference.
14. Repeat **steps 12 and 13** for the bolt plate that goes through the lower mounting bracket. See **Figure 12** for reference.

Figure 11

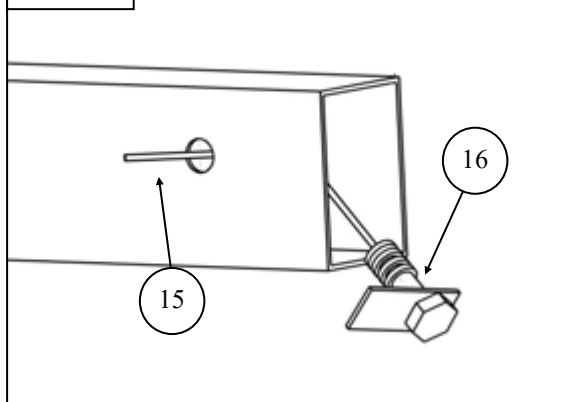
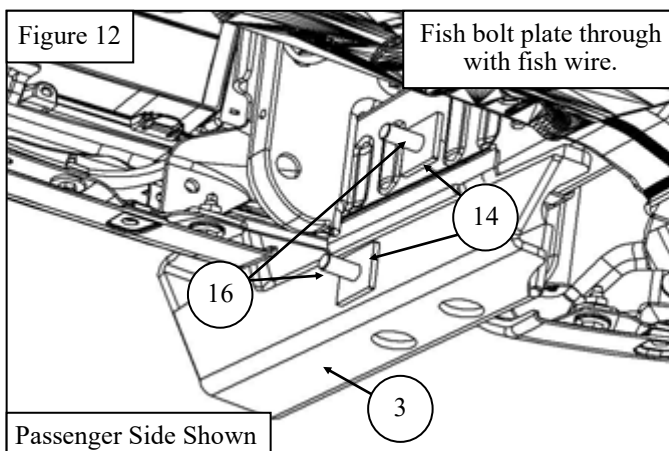

Figure 12



15. Grab the lower support bracket and loosely mount it to the lower mounting bracket using the supplied M12 hardware. See **Figure 13** for reference.
16. Set the Winch Tray (1) on top of the lower mounting brackets.
17. Loosely install the Winch Tray using the supplied black M12 Hardware. See **Figure 14** for reference.
18. Adjust the Winch Tray and mounting brackets as necessary and torque down all hardware as specified: M12 to 60 ft-lbs.  
**Note:** Leave hardware loose if installing grille guard.
19. If installation a winch, do so at this time per manufacturers instructions.

Figure 13

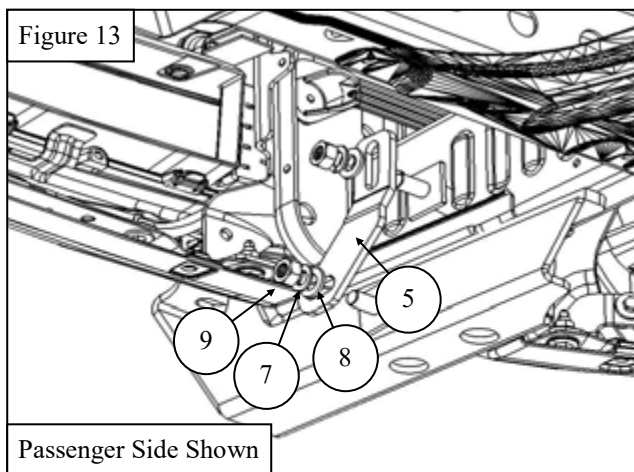
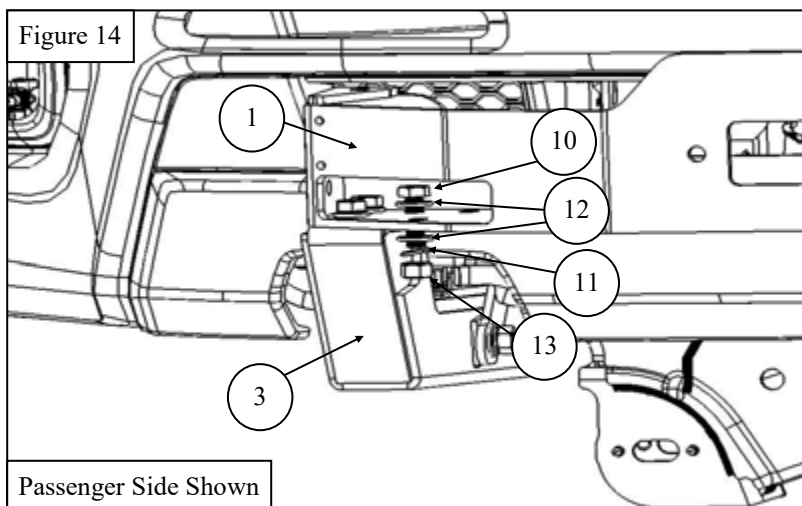
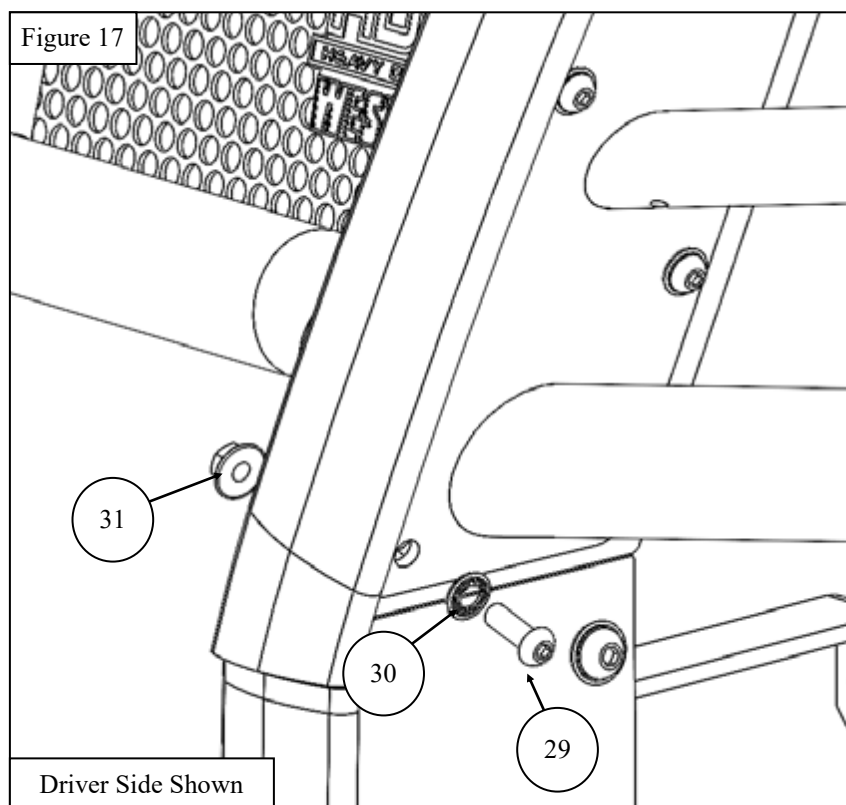
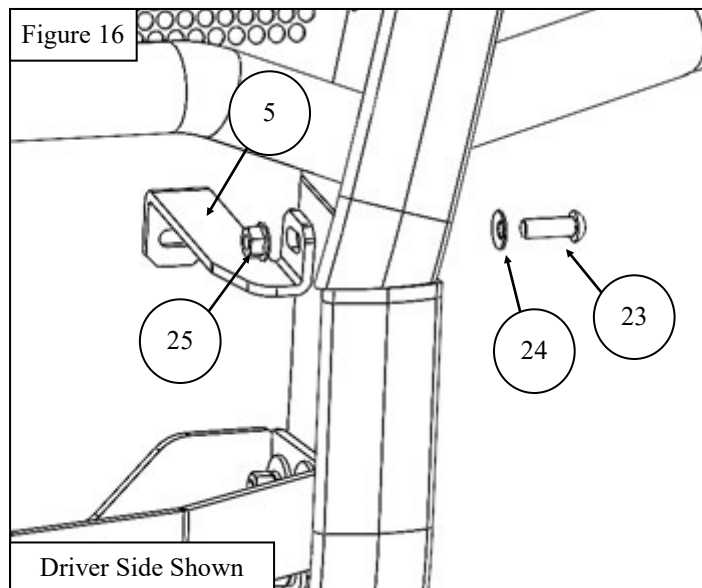
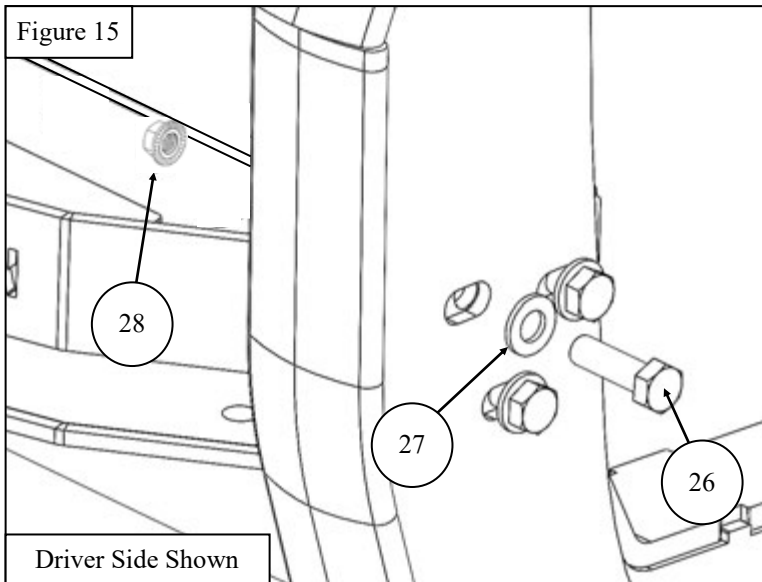

Figure 14



#### END OF WINCH TRAY INSTALLATION; WINCH MOUNT MODULAR GRILLE GUARD INSTALLATION CONTINUES

20. With assistance hold the Grille Guard Base (Item 18) up to the previously installed mounting brackets. Loosely attach the Grille Guard Base to the brackets using the supplied M10 & M12 hardware. See **Figures 15 & 16** for reference.
21. Locate and mount the HDX Driver Wing (Item 19) to the Grille Guard Base using the supplied M8 Hardware (Items 29-31). See **Figure 17** for reference.
22. Repeat for the HDX Passenger Wing (Item 20).
23. Align and adjust the Grille Guard Base, Wings, Winch Tray, and mounting brackets as necessary. Tighten and torque the M8 hardware to 16-18 ft-lbs, M10 hardware to 30-35 ft-lbs, and the M12 hardware to 50-55 ft-lbs.





## INSTALLATION COMPLETE



Winch and tow hooks sold separately.

### CARE INSTRUCTIONS

- REGULAR WAXING IS RECOMMENDED. DO NOT USE ANY TYPE OF POLISH OR WAX THAT MAY CONTAIN ABRASIVES.
- STAINLESS STEEL PRODUCTS CAN BE CLEANED WITH MILD SOAP AND WATER. STAINLESS STEEL POLISH SHOULD BE USED TO POLISH SMALL SCRATCHES.
- GLOSS BLACK FINISHES SHOULD BE CLEANED WITH MILD SOAP AND WATER.

**WESTIN**

Westin Automotive Products, Inc.  
320 W. Covina Blvd  
San Dimas, Ca. 91773

Thank you for choosing Westin products  
for additional installation assistance please call  
Customer Service (800) 793-7846  
[www.westinautomotive.com](http://www.westinautomotive.com)



## WARNING



Failure to follow these instructions could lead to death, personal injury, and / or property damage.

Failure to follow these instructions could lead to death, personal injury, and / or property damage.

### FASTENERS:

All Westin supplied fasteners must be utilized and installed in accordance with the installation instructions and apply torque to the specifications as defined. **DOUBLE CHECK ALL FASTENERS BEFORE INITIAL USE, AND PERIODICALLY IN THE FUTURE TO ENSURE PROPER FUNCTION AND SAFETY.**

### DRILLING:

Most Westin products do not require drilling for installation. If drilling is defined as required, use caution when drilling a vehicle. **FAILURE TO REVIEW AN AREA TO BE DRILLED MAY RESULT IN PERSONAL INJURY AND/OR INJURY TO OTHERS AS WELL AS VEHICLE DAMAGE.**

### EYE PROTECTION:

**ALWAYS WEAR SAFETY GLASSES OR GOGGLES DURING THE INSTALLATION PROCESS TO AVOID PERSONAL INJURY.**

### MAXIMUM TOWING/CARRYING CAPACITY: (if applicable)

The Westin Receiver Hitches will have a visible tow rating label affixed directly on the product. User should never exceed the vehicle manufacturers maximum tow and weight rating regardless of the capacity of the hitch. **FAILURE TO FOLLOW THESE GUIDELINES WILL VOID THE WESTIN WARRANTY AND MAY RESULT IN PERSONAL INJURY AND/OR INJURY TO OTHERS AS WELL AS VEHICLE DAMAGE.**

### FOR CALIFORNIA RESIDENTS ONLY-PROP 65 WARNING:

Some products may contain chemicals such as DEHP, which can cause cancer, birth defects or other reproductive harm. For more info go to [www.p65warnings.ca.gov](http://www.p65warnings.ca.gov)



Westin Automotive Products, Inc.  
320 W. Covina Blvd  
San Dimas, Ca. 91773