

INSTALLATION INSTRUCTIONS

HDX Drop Side Bed Step and Grate Side Bed Step



APPLICATION:
2023 and Up Ford F-250/350/450/550

PART NUMBERS:
56-00335, 27-74005

CONTENT			
ITEM	QUANTITY	DESCRIPTION	TOOLS NEEDED
1	1	DRIVER SIDE BED STEP	13MM SOCKET
2	1	PASSENGER SIDE BED STEP	13MM WRENCH
3	1	DRIVER FRONT BRACKET	15MM WRENCH
4	1	PASSENGER FRONT BRACKET	RATCHET
5	1	DRIVER SUPPORT BRACKET	5MM HEX TOOL
6	1	PASSENGER SUPPORT BRACKET	6MM HEX TOOL
7	1	DRIVER REAR BRACKET	TORQUE WRENCH
8	1	PASSENGER REAR BRACKET	
9	16	M8 HEX HEAD BOLT (YELLOW ZINC)	
10	16	M8 SPLIT LOCK WASHER (YELLOW ZINC)	
11	32	M8 FLAT WASHER (YELLOW ZINC)	
12	16	M8 HEX NUT (YELLOW ZINC)	
13	6	M10 BUTTON HEAD BOLT (BLACK ZINC)	
14	6	M10 SPLIT LOCK WASHER (BLACK ZINC)	
15	6	M10 FLAT WASHER (BLACK ZINC)	
16	6	M10 SERRATED FLANGE HEX NUT (BLACK ZINC)	
17	8	M8 BUTTON HEAD BOLT (BLACK ZINC)	
18	8	M8 SPLIT LOCK WASHER (BLACK ZINC)	
19	8	M8 FLAT WASHER (BLACK ZINC)	
20	8	M8 SERRATED FLANGE HEX NUT (BLACK ZINC)	

ANTI-SEIZE LUBRICANT MUST BE USED ON ALL STAINLESS STEEL FASTENERS TO PREVENT THREAD DAMAGE AND GALLING

ITEM 1 - Passenger Side Opposite

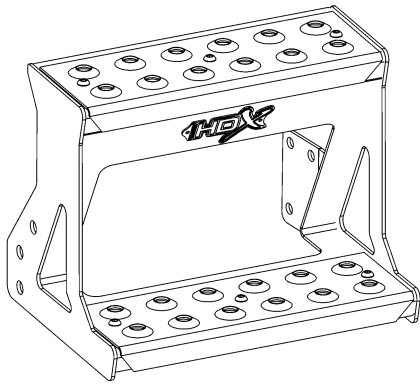

HDX Drop Side Bed Step

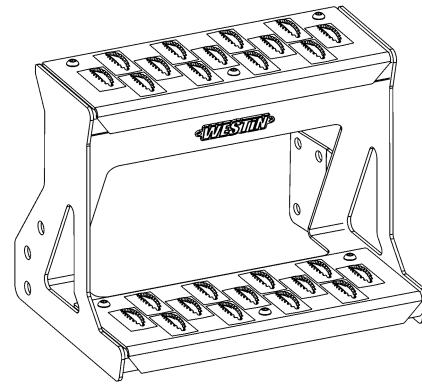

Grate Side Bed Step

ITEM 3
Passenger Side Opposite

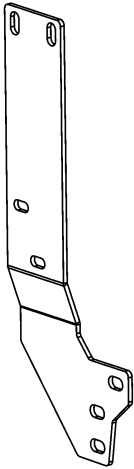

ITEM 5
Passenger Side Opposite

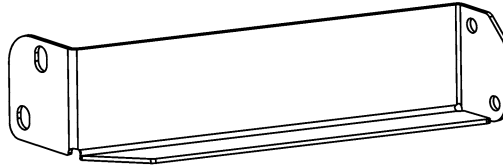

ITEM 7
Passenger Side Opposite

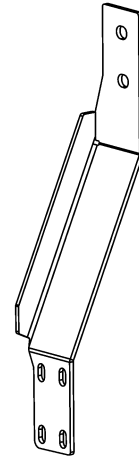

PROCEDURE

1. Remove contents from box, verify if all parts listed are present and free from damage.
Carefully read and understand all instructions before attempting installation.
Failure to identify damage before installation could lead to a rejection of any claim.

OEM Side Bed Step Removal

2. Starting on the driver side, remove the OEM side bed step. See **Figure 1**.



3. Remove the two factory bolts on the side closer to the rear tires. See **Figures 2 and 3**.

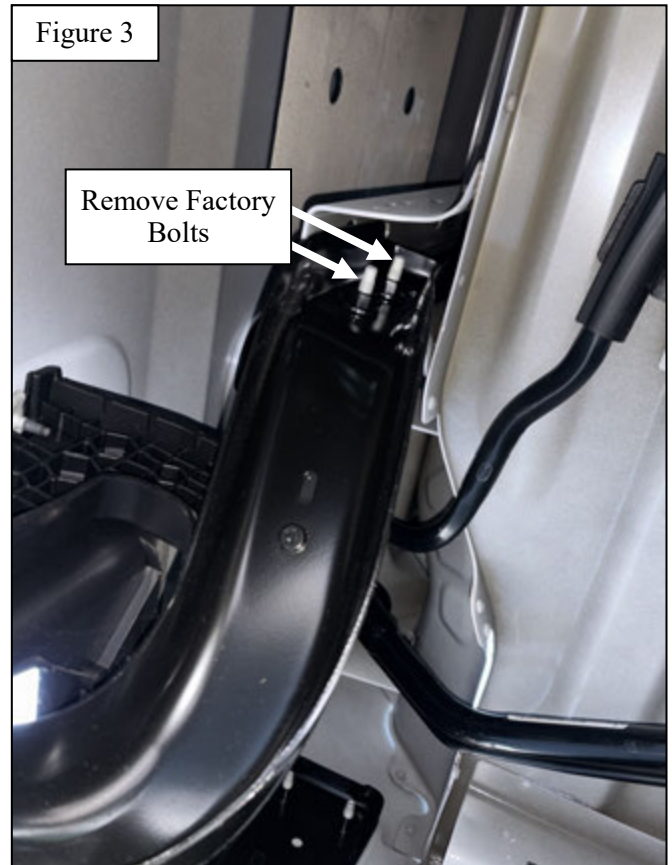

4. Remove the two factory bolts on the side closer to the cab. See **Figures 4 and 5**.

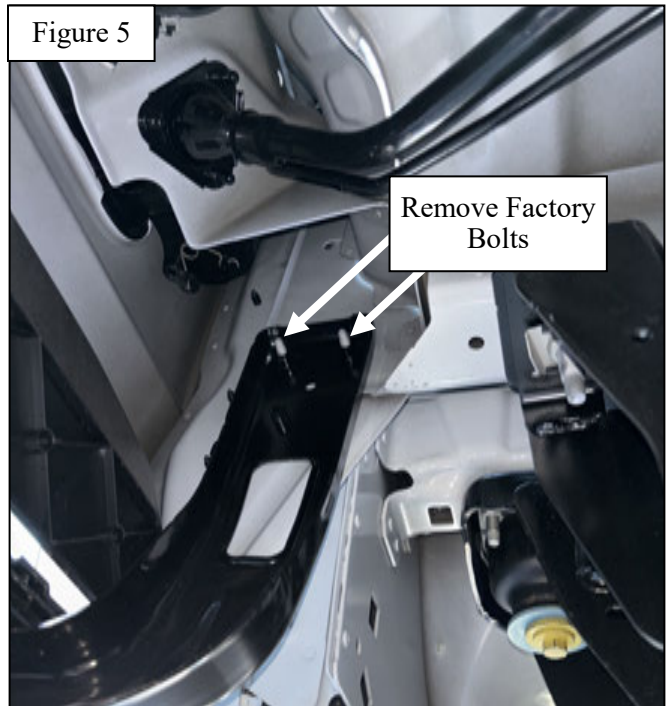
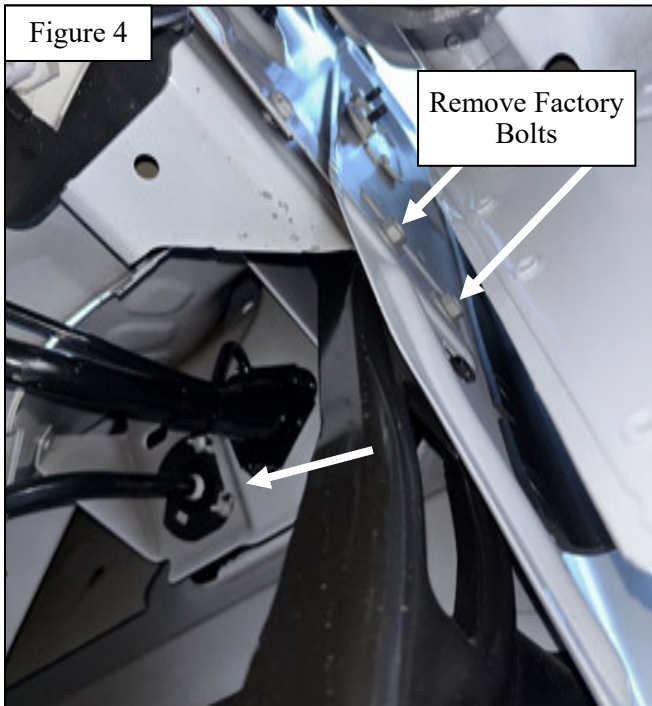

Assembly Overview

Figure 6

Driver Side Shown. Passenger Opposite.
HDX Drop Side Bed Step Shown. Grate Side Bed Step Similar.

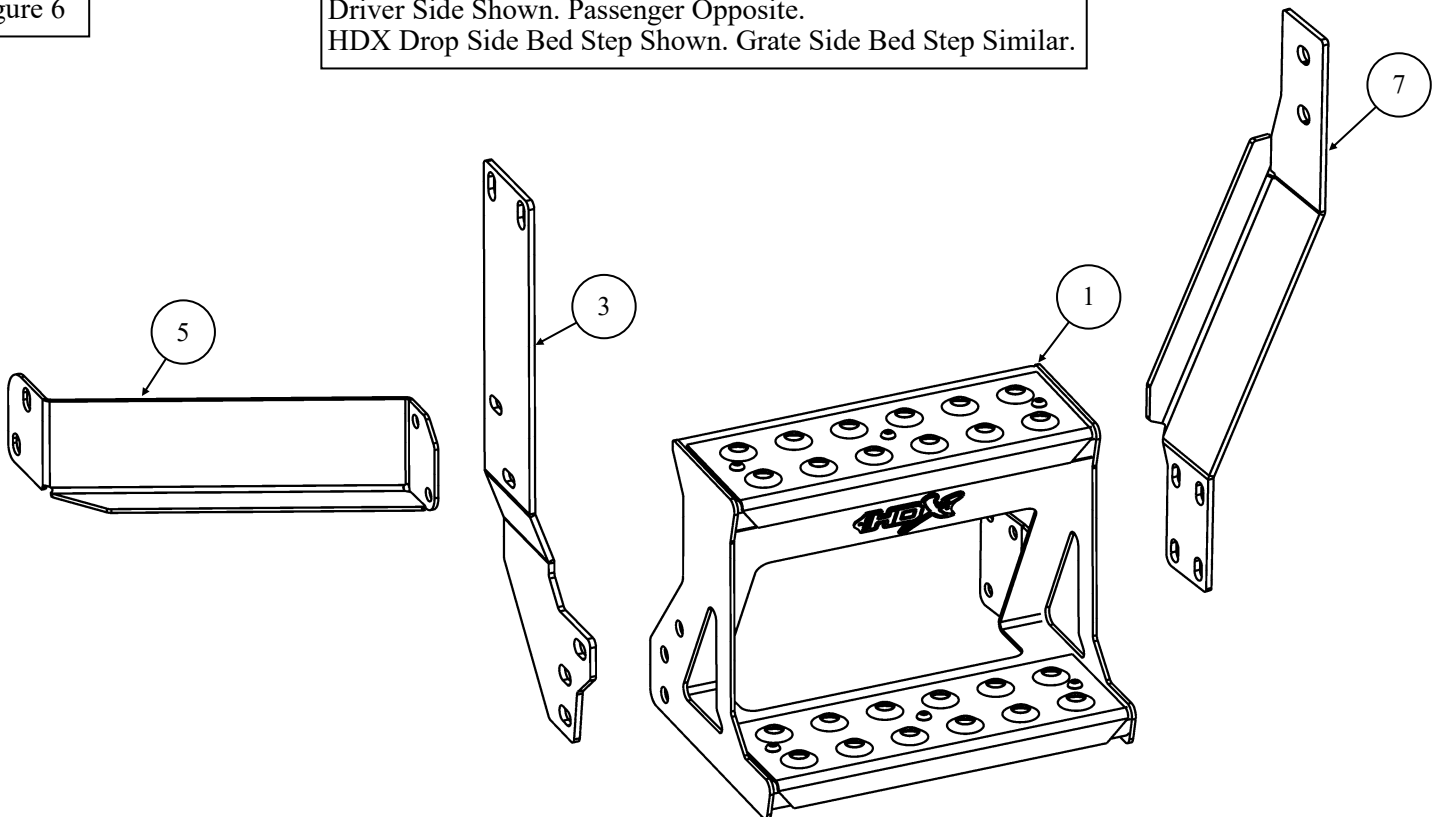

Bracket Installation

5. Loosely install the Driver Front Bracket (item 3) using the yellow M8 hardware (items 9-12). See Figures 7 and 8.

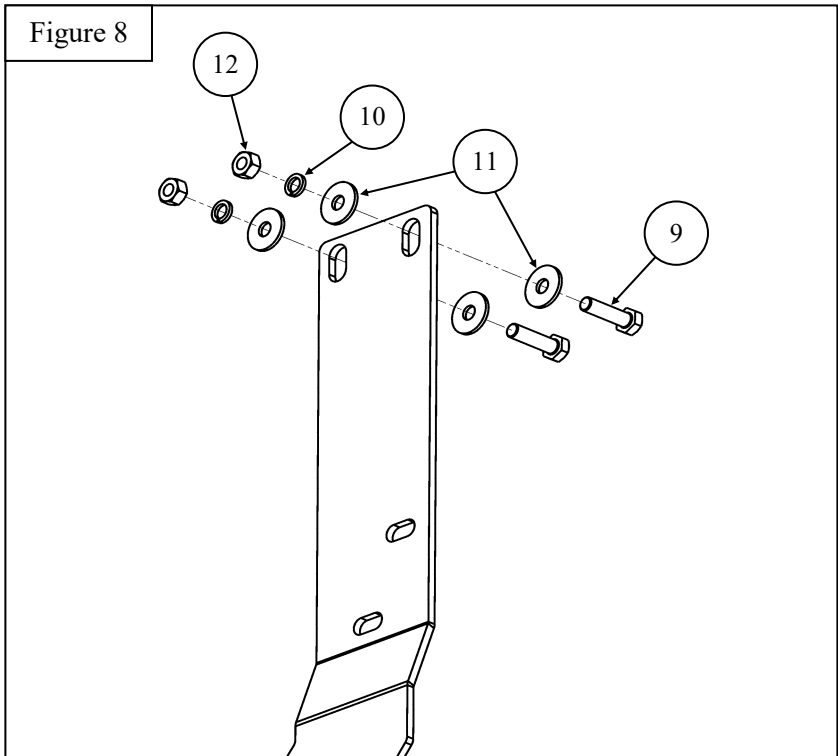

6. Loosely install the Driver Support Bracket (item 5) using the yellow M8 hardware (items 9-12). See Figures 9 and 10.

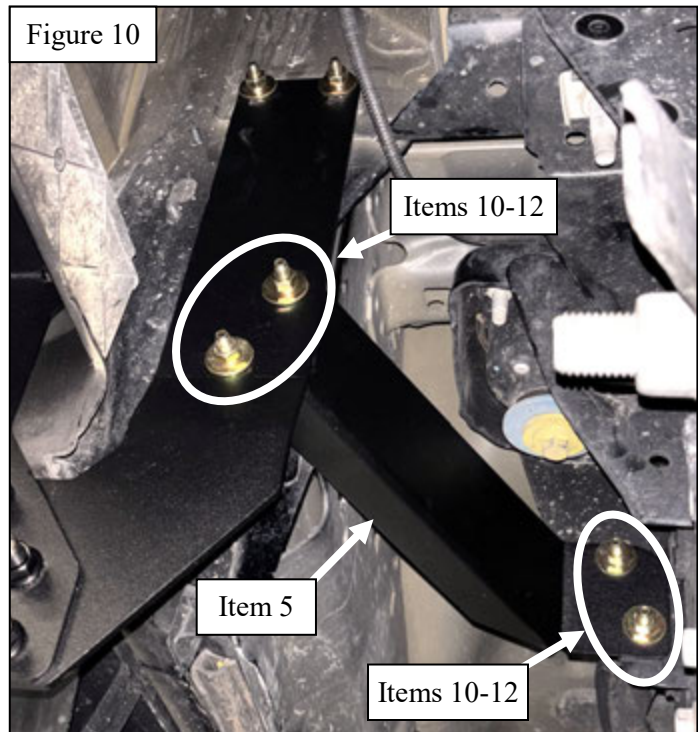
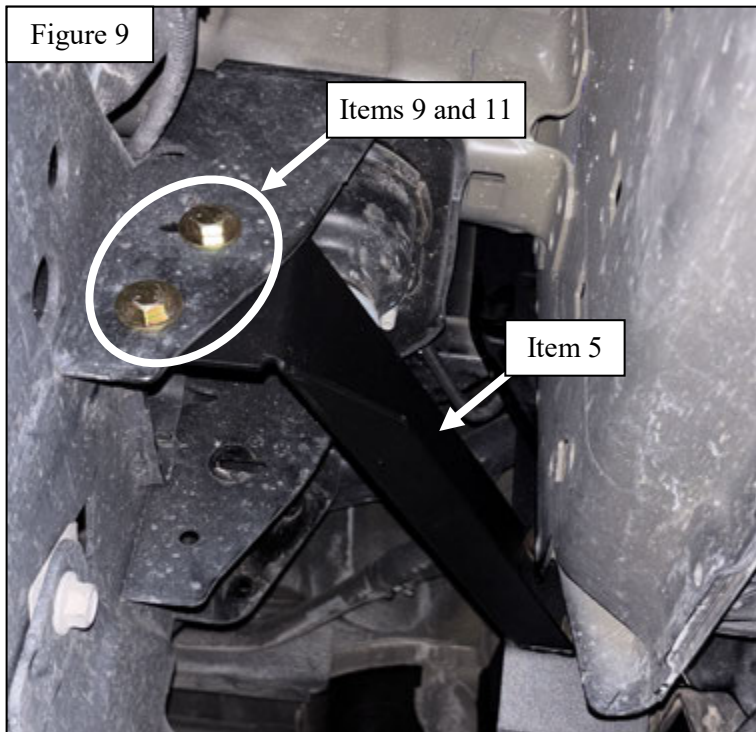

7. Loosely install the Driver Rear Bracket (item 7) using the yellow M8 hardware (items 9-12). See Figures 11-13.

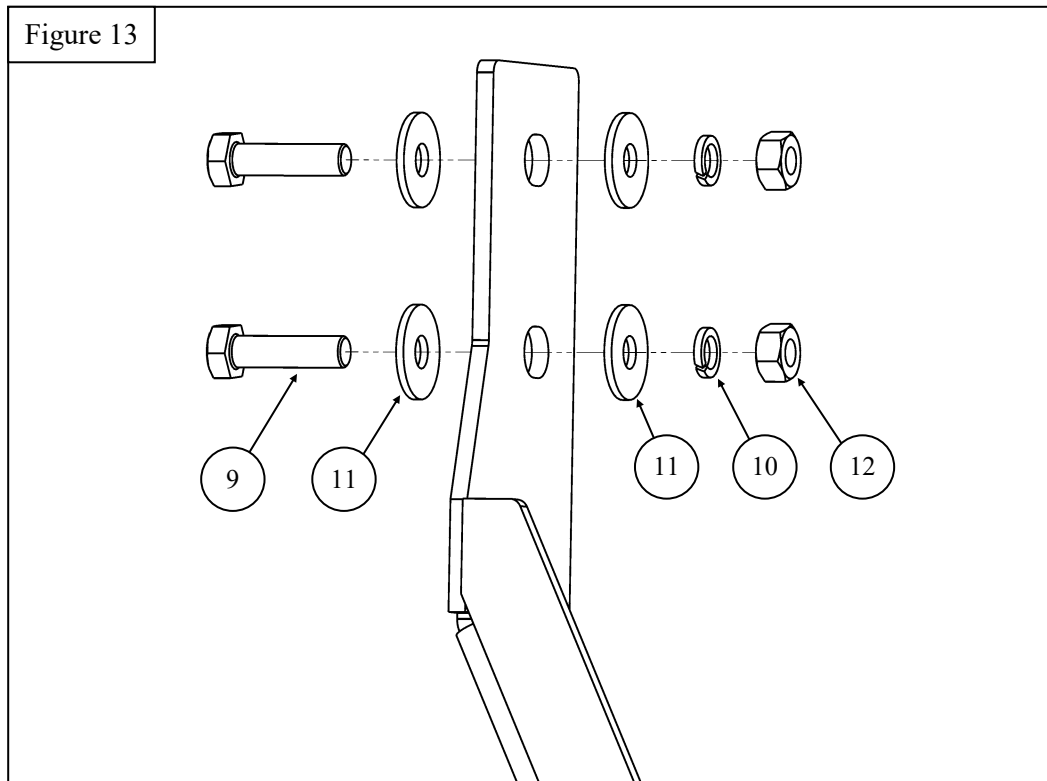
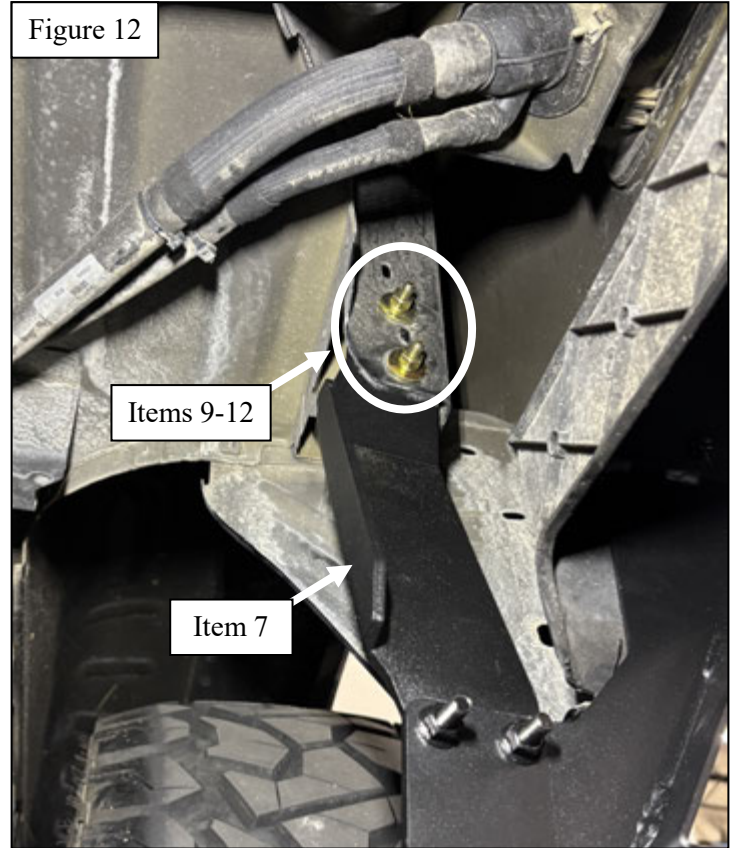

Side Bed Step Installation

8. Loosely install the Driver Side Bed Step (**item 1**) using the black M10 hardware (**items 13-16**) and black M8 hardware (**items 17-20**). See **Figure 14**.
9. Align and adjust the side bed step as needed. Tighten the hardware as specified: M8 to 15-18 ft-lbs. and M10 to 25-30 ft-lbs.
10. Repeat **Steps 2-9** on the passenger side brackets and side bed step.

Figure 14

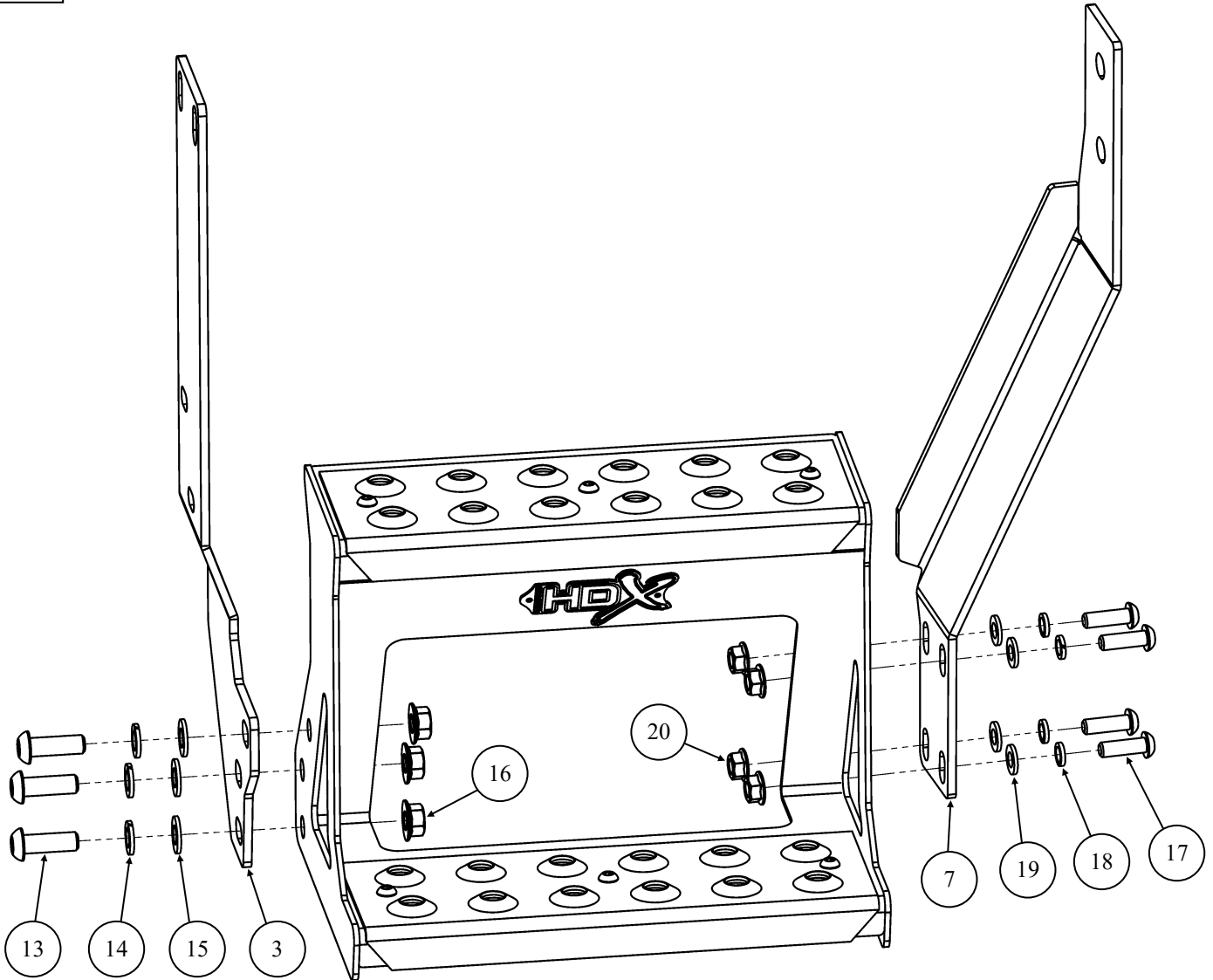

HDX Drop Side Bed Step Shown
Grate Side Bed Step Similar

INSTALLATION COMPLETE



Grate Side Bed Step Shown
HDX Drop Side Bed Step Similar

CARE INSTRUCTIONS

- TEXTURE BLACK FINISHES SHOULD BE CLEANED WITH MILD SOAP AND WATER ONLY (DO NOT WAX).
- GLOSS BLACK FINISHES SHOULD BE CLEAN WITH MILD SOAP AND WATER.
- POLISHED STAINLESS PRODUCTS SHOULD BE CLEANED WITH MILD SOAP AND WATER. STAINLESS STEEL POLISH MAY BE USED TO REMOVE SMALL SCRATCHES.
- REGULAR WAXING IS RECOMMENDED FOR GLOSS BLACK AND STAINLESS STEEL PRODUCTS. DO NOT USE WAX THAT MAY CONTAIN ABRASIVES.



Westin Automotive Products, Inc.
320 W. Covina Blvd
San Dimas, Ca. 91773

Thank you for choosing Westin products
for additional installation assistance please call
Customer Service (800) 793-7846
www.westinautomotive.com



WARNING



Failure to follow these instructions could lead to death, personal injury, and / or property damage.

Failure to follow these instructions could lead to death, personal injury, and / or property damage.

FASTENERS:

All Westin supplied fasteners must be utilized and installed in accordance with the installation instructions and apply torque to the specifications as defined. **DOUBLE CHECK ALL FASTENERS BEFORE INITIAL USE, AND PERIODICALLY IN THE FUTURE TO ENSURE PROPER FUNCTION AND SAFETY.**

DRILLING:

Most Westin products do not require drilling for installation. If drilling is defined as required, use caution when drilling a vehicle. **FAILURE TO REVIEW AN AREA TO BE DRILLED MAY RESULT IN PERSONAL INJURY AND/OR INJURY TO OTHERS AS WELL AS VEHICLE DAMAGE.**

EYE PROTECTION:

ALWAYS WEAR SAFETY GLASSES OR GOGGLES DURING THE INSTALLATION PROCESS TO AVOID PERSONAL INJURY.

MAXIMUM TOWING/CARRYING CAPACITY: (if applicable)

The Westin Receiver Hitches will have a visible tow rating label affixed directly on the product. User should never exceed the vehicle manufacturers maximum tow and weight rating regardless of the capacity of the hitch. **FAILURE TO FOLLOW THESE GUIDELINES WILL VOID THE WESTIN WARRANTY AND MAY RESULT IN PERSONAL INJURY AND/OR INJURY TO OTHERS AS WELL AS VEHICLE DAMAGE.**

FOR CALIFORNIA RESIDENTS ONLY-PROP 65 WARNING:

Some products may contain chemicals such as DEHP, which can cause cancer, birth defects or other reproductive harm. For more info go to www.p65warnings.ca.gov



Westin Automotive Products, Inc.
320 W. Covina Blvd
San Dimas, Ca. 91773