



INSTALLATION INSTRUCTIONS

DEFENDER FRONT PARTITION

APPLICATION:

2020 Police Interceptor Utility

PART NUMBER:

35-20045

ITEM	QUANTITY	DESCRIPTION	TOOLS NEEDED
1	1	PARTITION ASSEMBLY	14MM SOCKET
2, 3	2	FOOT POCKET, DRIVER (2) AND PASSENGER (3)	15MM SOCKET
4	2	INNER MOUNT BRACKET, DRIVER AND PASSENGER	18MM SOCKET
5, 6	2	OUTER MOUNT BRACKET, DRIVER (5) AND PASSENGER (6)	UTILITY KNIFE
7, 8	2	UPPER MOUNT BRACKET, DRIVER (7) AND PASSENGER (8)	PRY TOOL
9	1	FLAT OR RECESSED PANEL W/ ACCESSORIES	ALLEN WRENCH
10	4	M6 LONG BUTTON HEAD BOLT (BLACK ZINC)	SOCKET EXT.
11	2	M6 SPLIT LOCK WASHER (BLACK ZINC)	RATCHET
12	4	M6 FLAT WASHER LARGE (BLACK ZINC)	TORQUE WRENCH
13	4	M6 FLAT WASHER SMALL (BLACK ZINC)	
14	2	M6 SHORT BUTTON HEAD BOLT (BLACK ZINC)	
15	6	M8 BUTTON HEAD BOLT (BLACK ZINC)	
16	6	M8 SPLIT LOCK WASHER (BLACK ZINC)	
17	6	M8 FLAT WASHER (BLACK ZINC)	
18	2	M10 SERRATED FLANGE BOLT (YELLOW ZINC)	
19	2	M10 SERRATED FLANGE NUT (YELLOW ZINC)	
20	26	M6 FLANGE HEX NUTS (BLACK ZINC)	
21	26	M6 FLAT WASHER (BLACK ZINC)	

ANTI-SEIZE LUBRICANT MUST BE USED ON ALL STAINLESS STEEL FASTENERS TO PREVENT THREAD DAMAGE AND GALLING

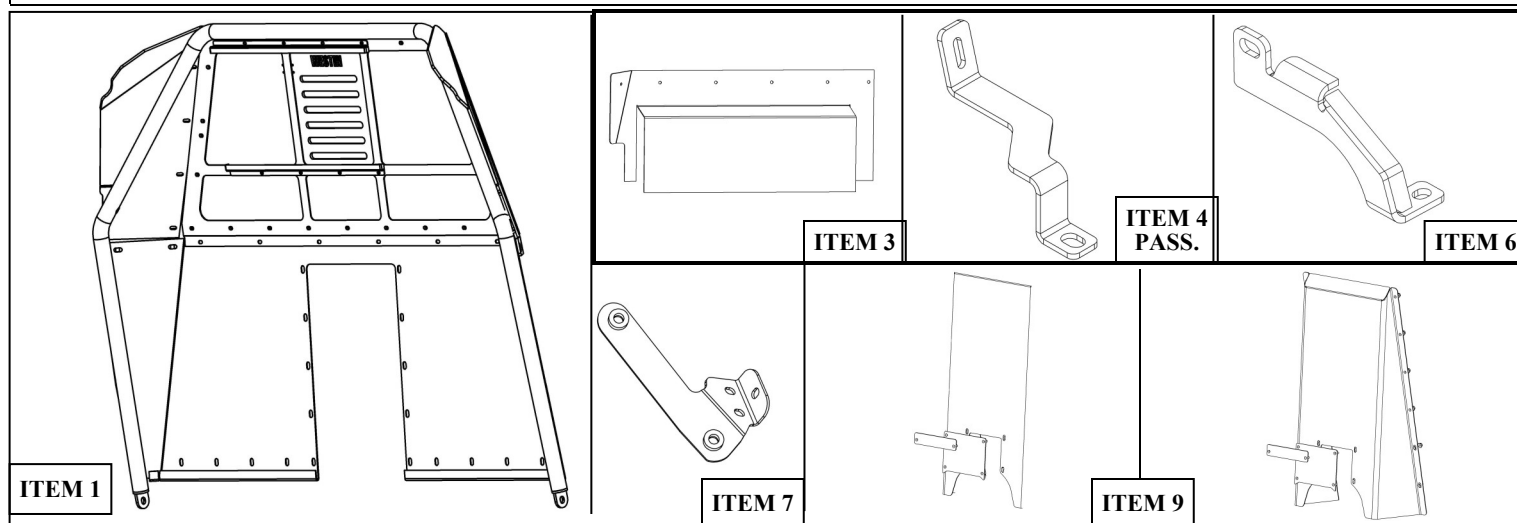

INSTALLATION TIME: 15 - 20 MINUTES



Westin Automotive Products, Inc.
320 W. Covina Blvd
San Dimas, Ca. 91773

Thank you for choosing Westin products
for additional installation assistance please call
Customer Service (800) 793-7846
www.westinautomotive.com

DATE: 3/25/2020

PROCEDURE

1. Remove contents from box, verify if all parts listed are present and free from damage. Carefully read and understand all instructions before attempting installation.
Failure to identify damage before installation could lead to a rejection of any claim.
2. Start installation by moving both front seats to their furthest front location to expose rear seat bolts. See **Figure 1**.
3. Remove both rear passenger handles by removing the (2) bolts. See **Figure 2**.

Figure 1

Move seat to max forward location.

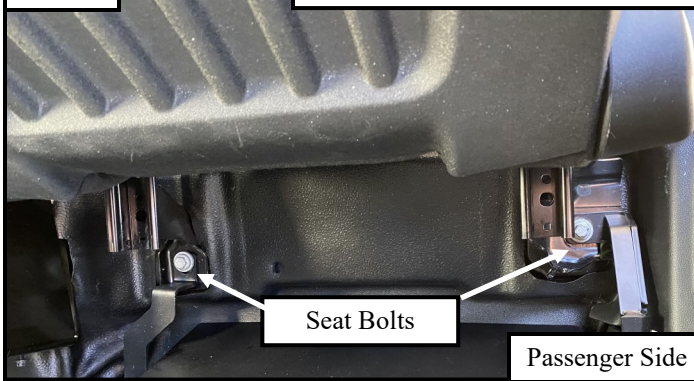
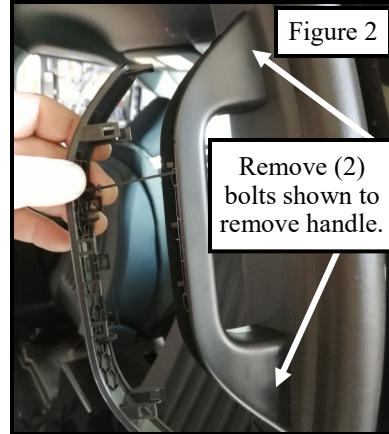

Figure 2

Remove (2) bolts shown to remove handle.



4. Starting on either side, locate (1) inner mounting bracket (Item 4) and (1) outer mount bracket (Item 5/6). Loosely secure onto the seat mount underneath the seat re-using the factory seat bolt. See **Figures 3 and 4**. Repeat for other side.
5. Locate partition assembly (Item 1) and with assistance carefully insert into vehicle. Loosely secure onto the previously installed mount brackets (Items 4-6) using the provided M10 hex head serrated flange bolt (Item 19). See **Figure 4**

Inner Passenger Side Shown

Figure 3

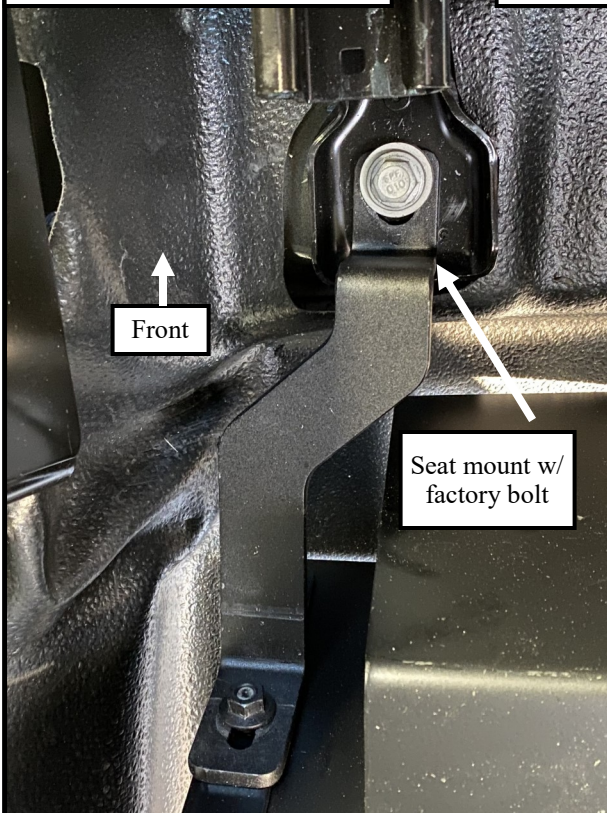
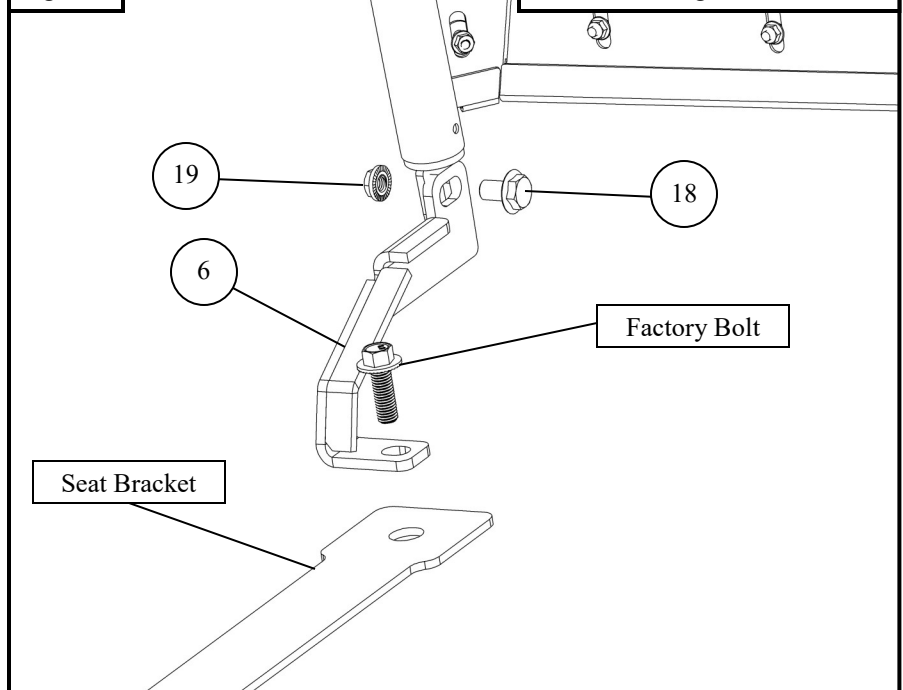

Figure 4

Outer Passenger Side Shown



WESTIN

Westin Automotive Products, Inc.
320 W. Covina Blvd
San Dimas, Ca. 91773

Thank you for choosing Westin products
for additional installation assistance please call
Customer Service (800) 793-7846

www.westinautomotive.com

DATE: 3/25/2020

6. Loosen air bag side relief plastics and attach upper mount brackets (items 7 and 8) using hardware 15-17. Between frame and air bag side relief plastics. See figure 7 and 8. Leave them loose at this time.
7. Loosely secure the upper mount brackets (Items 7 and 8) onto the vehicle where the handles were removed using the provided M6 hardware (Items 10 - 12). See **Figure 5**.
8. Tighten the hardware near the upper mount bracket (Item 7/8) on the partition assembly (Item 1). Tighten the hardware near the upper mount bracket, air bag relief plastic, and air bag relief bracket onto the partition assembly. See **Figure 6**.

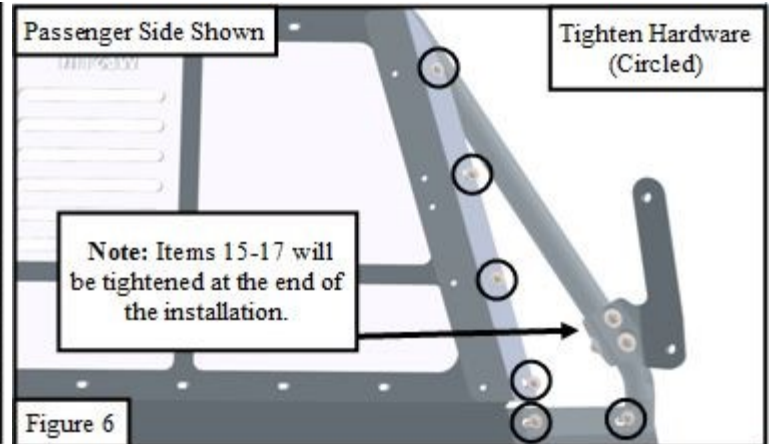
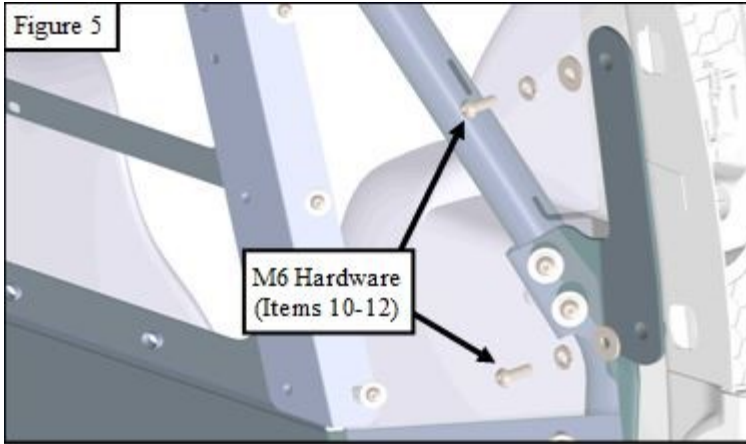

Locate the flat or recessed panel (Item 9) (see note below) and loosely secure onto the partition assembly using the supplied hardware: (10ea) M6 flange hex nuts and M6 flat washers (Items 20 & 21). Then locate the driver/passenger side foot pockets (Items 2 and 3) and loosely secure onto the partition and middle cover plate or recessed panel using the supplied hardware: (2) M6 short button head bolt (Item 14), (2) M6 flange hex nuts, and (2) M6 flat washer (Item 12). See **Figure 7**. **Note:** Use M6 flange nuts and M6 flat washers (Items 20 & 21) to finish to install the foot pockets **Figures 7 & 8** and accessories plates on Recessed Panel or flat panel. **Figure 8**. Use small plate if electrical channel is installed.

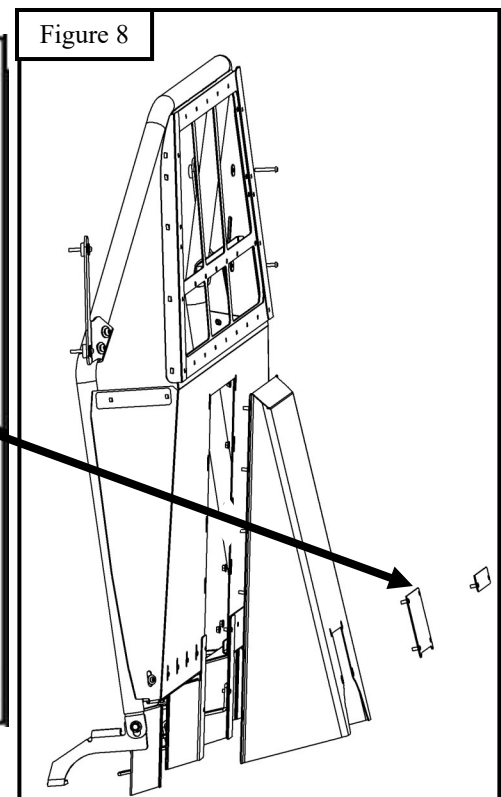
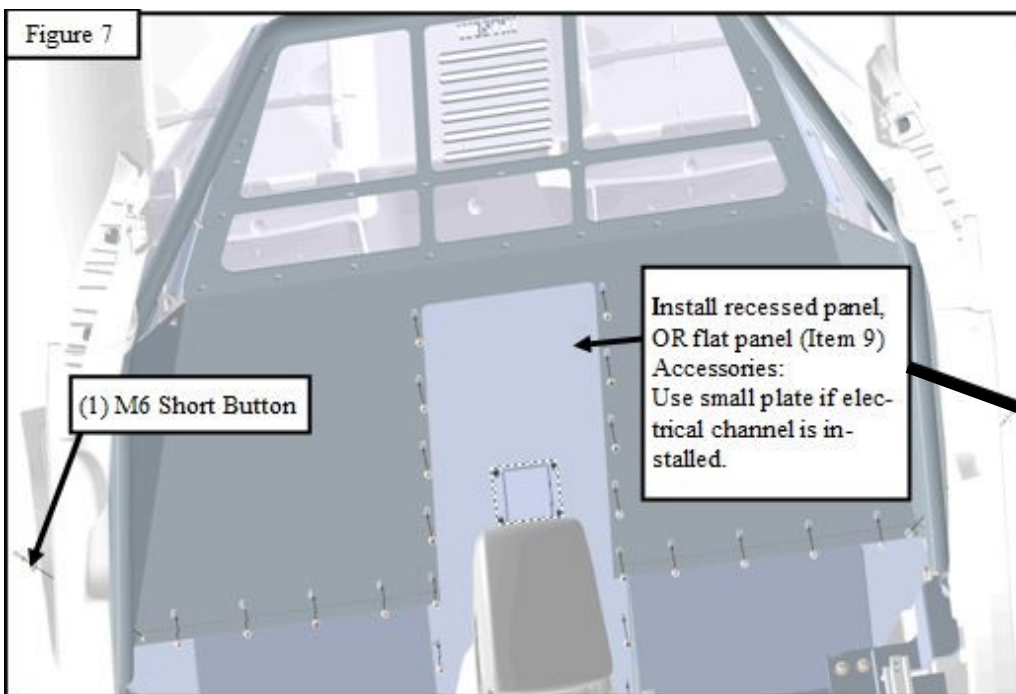

9. Align and adjust the partition assembly and then tighten hardware to: M8 hardware to 15-18 ft-lbs, M6 hardware to 5-7 ft-lbs, and M10 hardware to 30-35 ft-lbs.

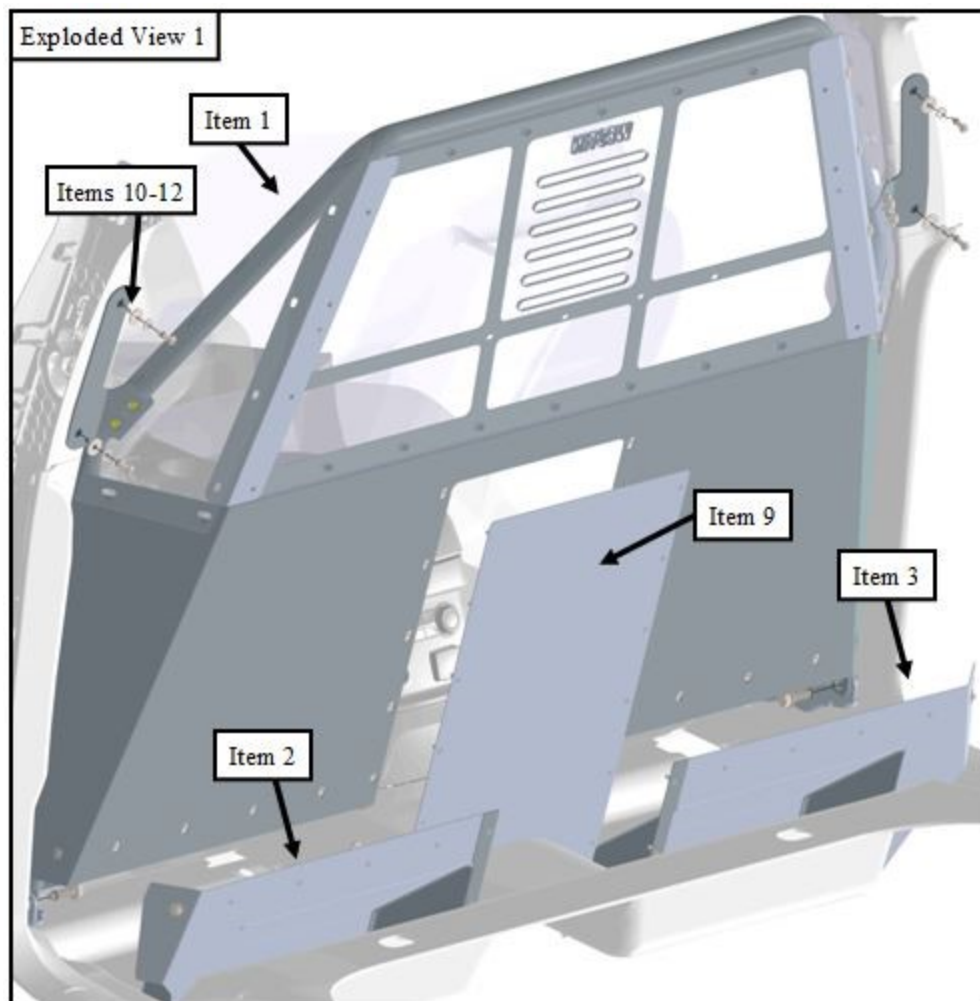

Westin Automotive Products, Inc.
320 W. Covina Blvd
San Dimas, Ca. 91773

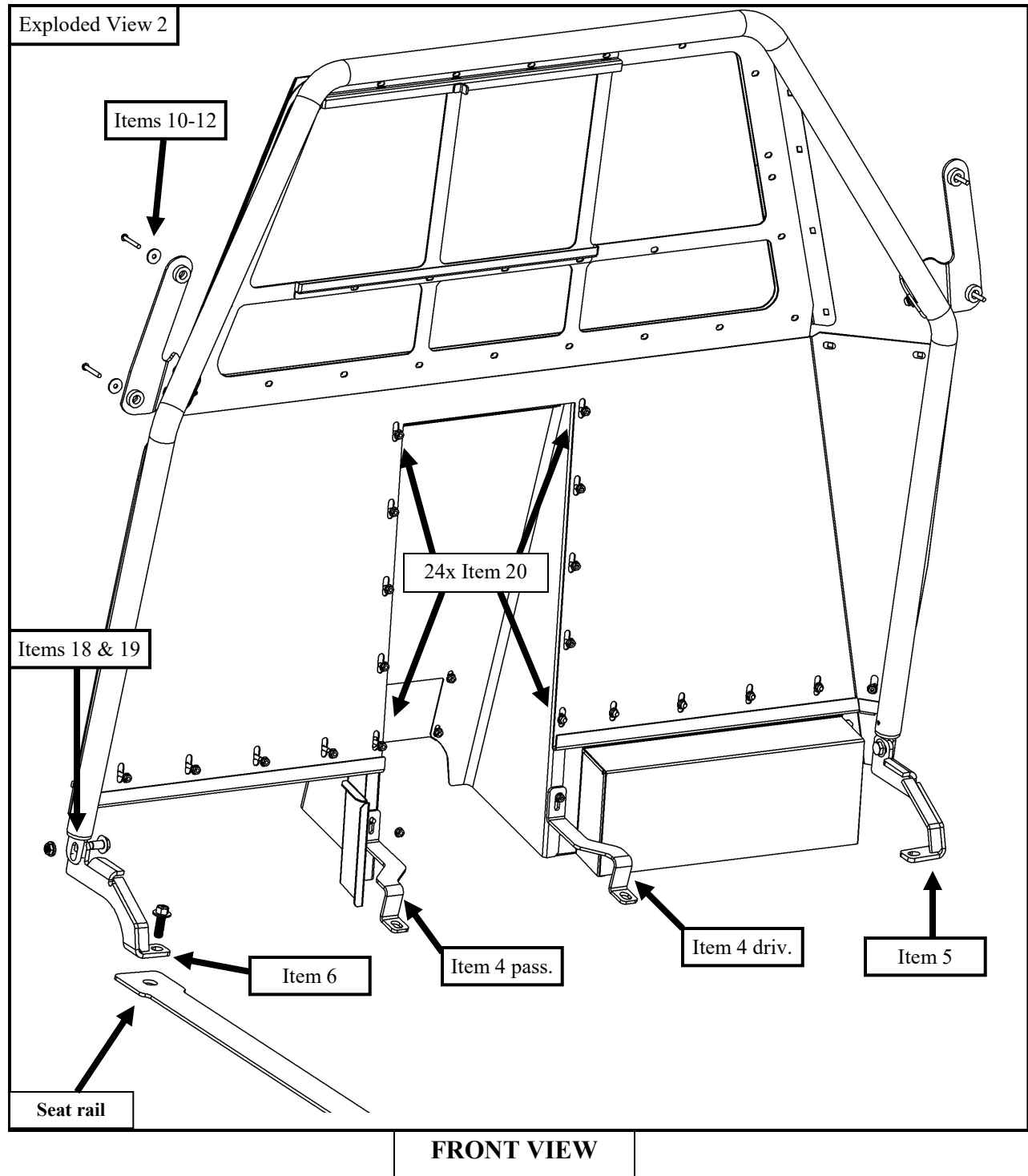



CARE INSTRUCTIONS

- REGULAR WAXING IS RECOMMENDED. DO NOT USE ANY TYPE OF POLISH OR WAX THAT MAY CONTAIN ABRASIVES.
- STAINLESS STEEL PRODUCTS CAN BE CLEANED WITH MILD SOAP AND WATER. STAINLESS STEEL POLISH SHOULD BE USED TO POLISH SMALL SCRATCHES.
- GLOSS BLACK FINISHES SHOULD BE CLEANED WITH MILD SOAP AND WATER.

WESTIN Westin Automotive Products, Inc.
320 W. Covina Blvd
San Dimas, Ca. 91773

Thank you for choosing Westin products
for additional installation assistance please call
Customer Service (800) 793-7846
www.westinautomotive.com
DATE: 3/25/2020



WARNING



Failure to follow these instructions could lead to death, personal injury, and / or property damage.

Failure to follow these instructions could lead to death, personal injury, and / or property damage.

FASTENERS:

All Westin supplied fasteners must be utilized and installed in accordance with the installation instructions and apply torque to the specifications as defined. **DOUBLE CHECK ALL FASTENERS BEFORE INITIAL USE, AND PERIODICALLY IN THE FUTURE TO ENSURE PROPER FUNCTION AND SAFETY.**

DRILLING:

Most Westin products do not require drilling for installation. If drilling is defined as required, use caution when drilling a vehicle. **FAILURE TO REVIEW AN AREA TO BE DRILLED MAY RESULT IN PERSONAL INJURY AND/OR INJURY TO OTHERS AS WELL AS VEHICLE DAMAGE.**

EYE PROTECTION:

ALWAYS WEAR SAFETY GLASSES OR GOGGLES DURING THE INSTALLATION PROCESS TO AVOID PERSONAL INJURY.

MAXIMUM TOWING/CARRYING CAPACITY: (if applicable)

The Westin Receiver Hitches will have a visible tow rating label affixed directly on the product. User should never exceed the vehicle manufacturers maximum tow and weight rating regardless of the capacity of the hitch. **FAILURE TO FOLLOW THESE GUIDELINES WILL VOID THE WESTIN WARRANTY AND MAY RESULT IN PERSONAL INJURY AND/OR INJURY TO OTHERS AS WELL AS VEHICLE DAMAGE.**

FOR CALIFORNIA RESIDENTS ONLY-PROP 65 WARNING:

Some products may contain chemicals such as DEHP, which can cause cancer, birth defects or other reproductive harm. For more info go to www.p65warnings.ca.gov



Westin Automotive Products, Inc.
320 W. Covina Blvd
San Dimas, Ca. 91773