

# INSTALLATION INSTRUCTIONS

## SAFARI BULL BAR



APPLICATION: 2024-2026 Ford Maverick

PART NUMBER: 30-0035

CONTENT			
ITEM	QUANTITY	DESCRIPTION	TOOLS NEEDED
1	1	BULL BAR ASSEMBLY	7MM SOCKET
2	1	LOWER DRIVER BRACKET	13MM SOCKET
3	1	LOWER PASSENGER BRACKET	17MM SOCKET
4	1	DRIVER SIDE TRIM TEMPLATE	RATCHET
5	2	M8 STEEL HEX HEAD BOLT, SHORT	TORQUE WRENCH
6	2	M8 STEEL HEX HEAD BOLT, LONG	6 INCH SOCKET EXTENSIONS
7	2	M8 SPLIT LOCK WASHER	RECIPROCATING SAW
8	2	M8 FLAT WASHER OD 24MM, 2MM THICK	
9	2	M10 X 1.5 STEEL HEX NUT	
10	2	M10 STEEL FLAT WASHER 20MM OD, 2 MM THICK	
11	2	M12 STEEL HEX HEAD BOLT	
12	2	M12 STEEL FLAT WASHER 22MM OD, 2MM THICK	
13	2	BOLT PLATE, M10 HHB, 1.5 X 40MM, 80 X 16 X 18	

**ANTI-SEIZE LUBRICANT MUST BE USED ON ALL STAINLESS STEEL FASTENERS TO PREVENT THREAD DAMAGE AND GALLING**

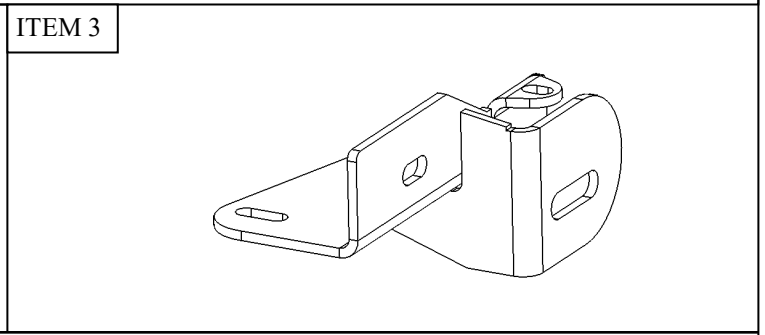
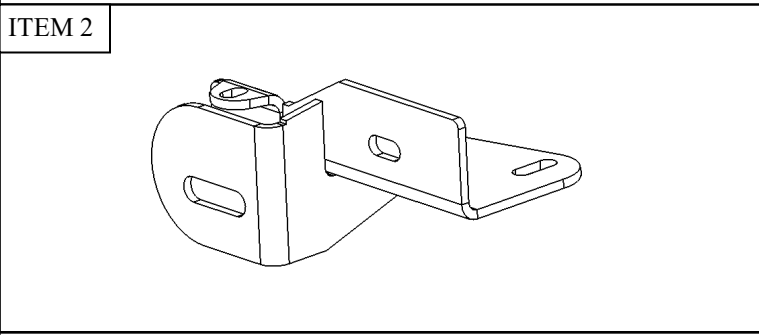
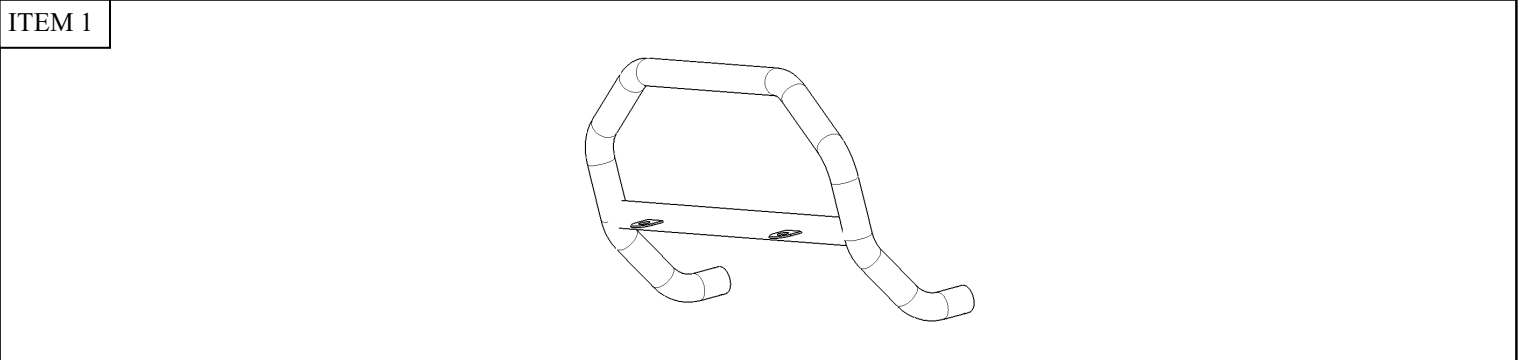

## PROCEDURE

1. Remove contents from box, verify if all parts listed are present and free from damage. Carefully read and understand all instructions before attempting installation.  
**Failure to identify damage before installation could lead to a rejection of any claim.**
2. Underneath the vehicle, there is hardware that is located towards the front of the vehicle. Remove hardware to release the bumper from the bottom engine cover. See **Figure 1**.

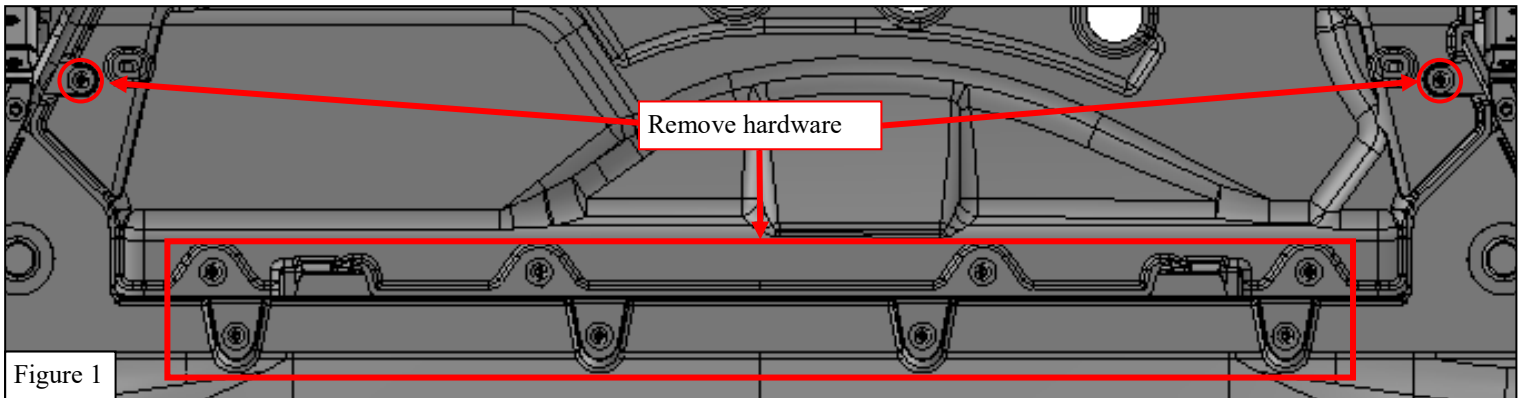

3. Starting on driver's side remove push clips in the wheel well. Required only to remove the clips that are placed towards the front of the wheel well. Remove 3 bolts in addition to push clips. See **Figure 2, 3 and 4**.

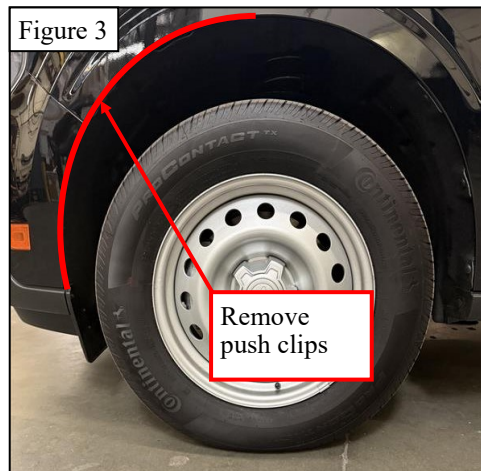

- Once push clips are removed pull fender liner towards the wheel. Some edges of the fender liner are folded into the inner fender lip, fold over to completely free fender liner to gain further access to proceed with install. (**Fig 5**).



- After fender lining is pulled towards the wheel, there are 3 bolts that hold front bumper in place. See **Figure 5** for location of bolts, they are located on the inside of the seem. **Figure 6** shows the bolts that are to be removed. (**Fig 7**).
- Repeat steps 2-4 for passenger side.

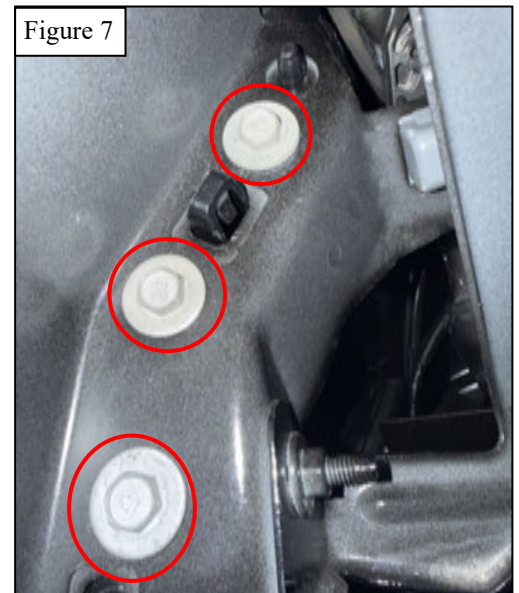

6. Open the hood of the vehicle to gain access to the bolts needed to be taken off. Once these bolts are removed all of the bolts needed to free the hood are off the vehicle. Bumper will not move due to clips holding it in place. See **Figure 8**.
7. After all of the bolts are removed the bumper can now be freed from the vehicle. See **Figure 9** to see the direction that the front bumper must be pulled to be freed from the vehicle. Note: some force is required to disengage the clips from their seated position, proceed with caution to not break any plastic pieces from trim.

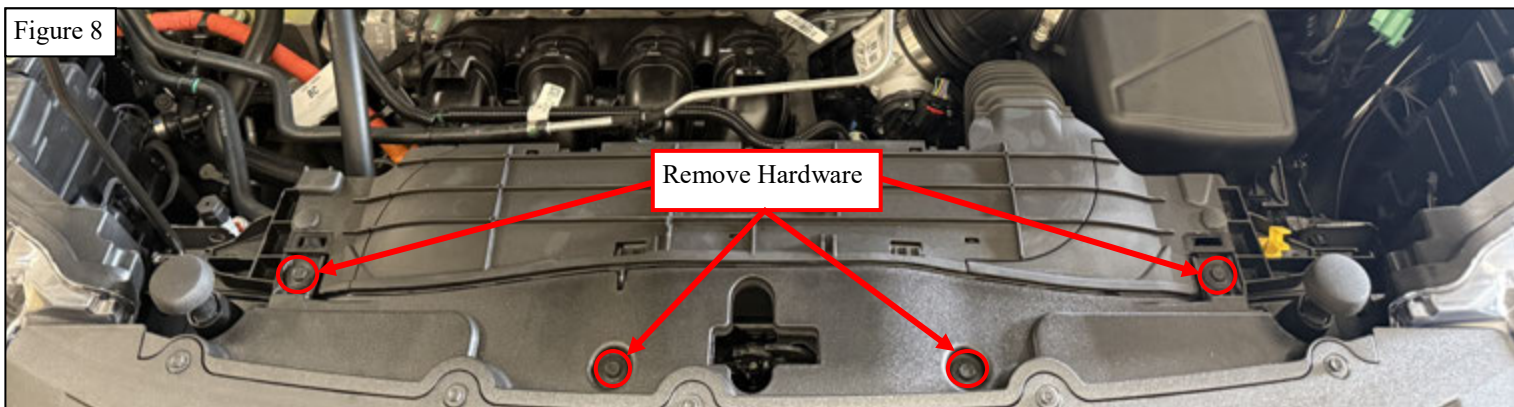

8. Now that the bumper is off the vehicle it is ideal to trim the bumper at this time. Place the bumper on a flat surface, fix the bumper in place so that when trimming the bumper does not move.
9. Cut out template that is provided for both the driver and passenger side. See **Figure 10**. The template itself has instructions on it on how it is to be used. Refer to **Figure 11** to see edges that template is to be aligned to.

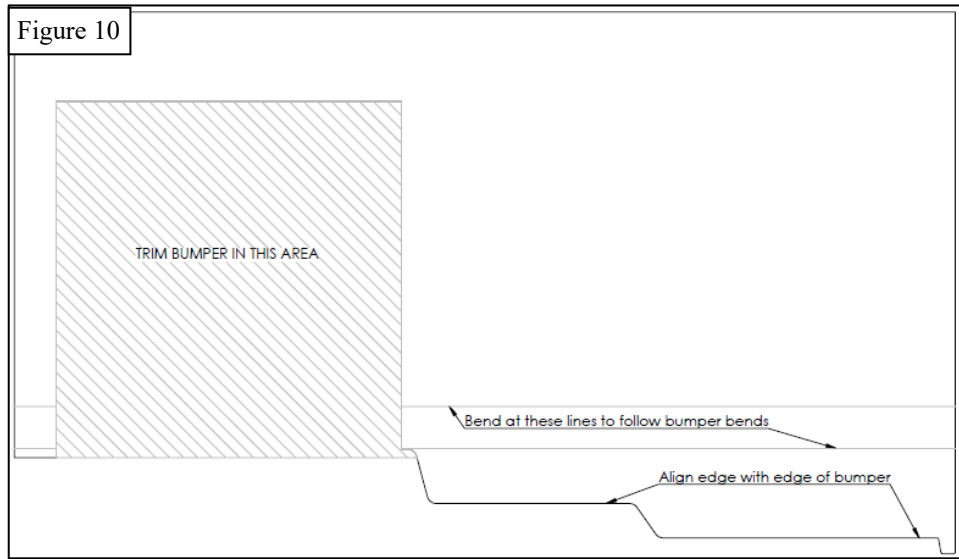

10. To secure template in place it is suggested to use painters tape. Once the template is secured in place the area that is to be trimmed can now be trimmed at this time. To do this step it is suggested to use a Sawzall or a tool that is meant to trim plastic. To smooth out the edges sand paper can be used for finishing touches. Refer to **Figure 12** to see how bumper should look when template is used correctly.

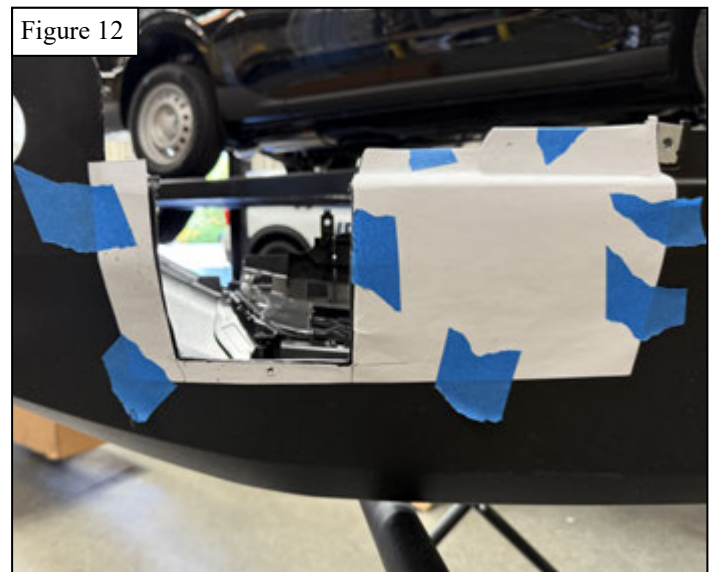
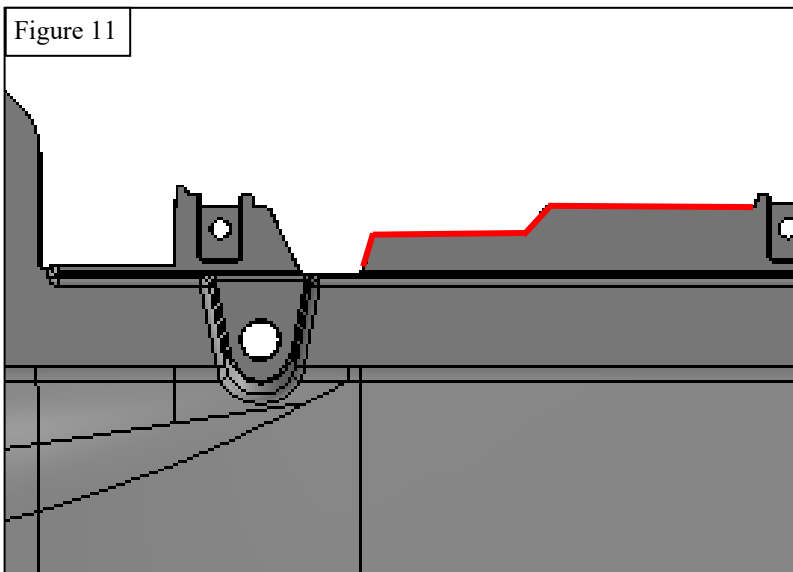

11. On the lower frame locate lower cross member that has two bolts through the member. See **Figure 13** for location on vehicle. Underneath the bracket there is a hole that the bolt plate is to be inserted. See **Figure 14** to see how the bolt plate is to be installed. Hook in long end into the hole first then seat in short end so that the bolt remains in place and perpendicular to the bottom surface.

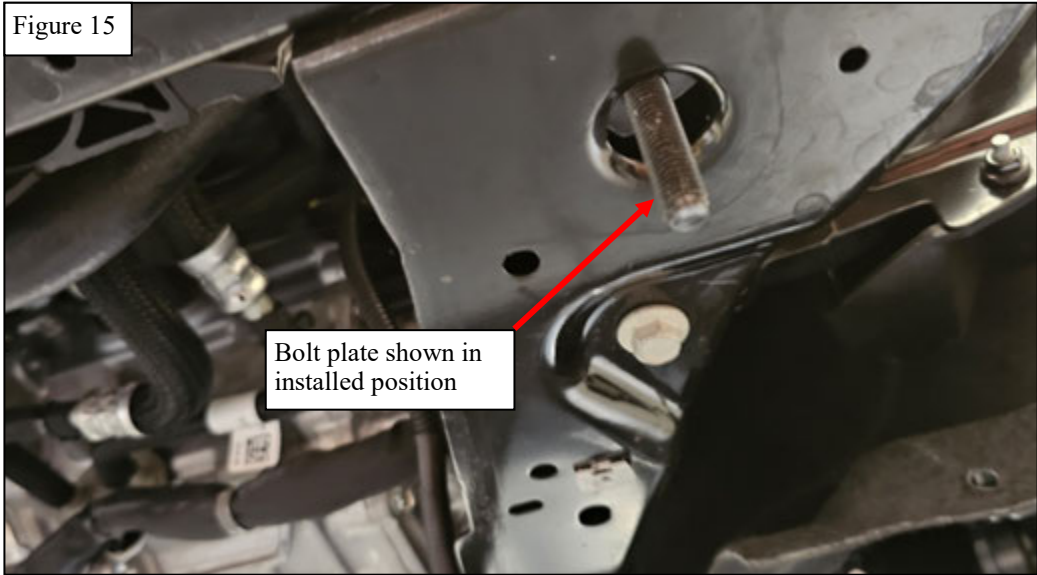
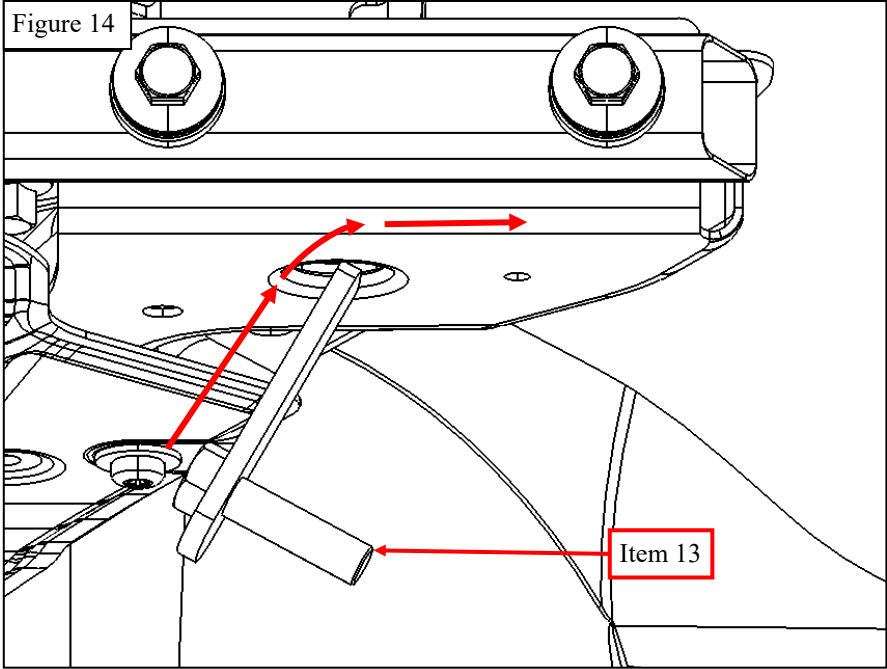

12. Once bolt plate is installed, remove the bolt OEM that is on the inner part of the frame, see **Figure 16**. Also, remove bolt that is in front of cross bar. See **Figure 17** for the location.
13. After those two bolts are removed from step 6 the lower driver bracket can now be installed. Refer to Figure 17 and 18 to see the orientation of how the bracket should be installed.
14. After installation repeat steps 11-13 for the other side of the vehicle. Torque all bolts to 60ft-lbs

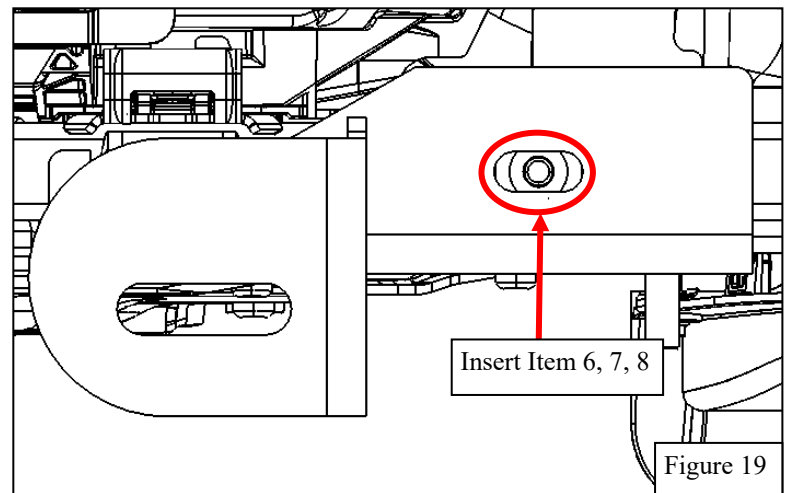
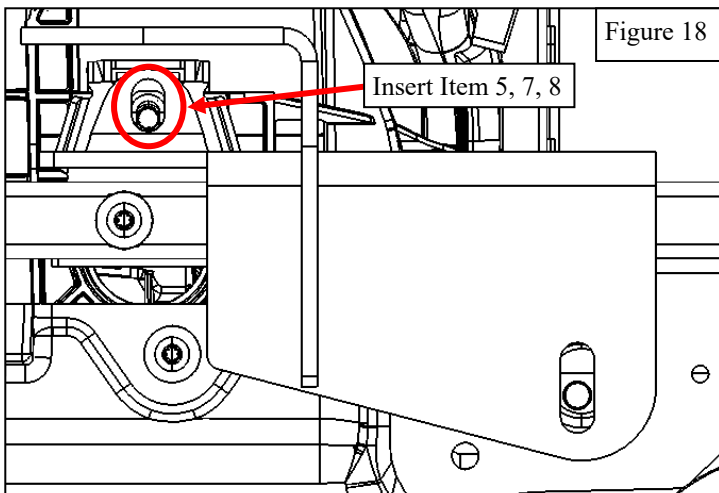
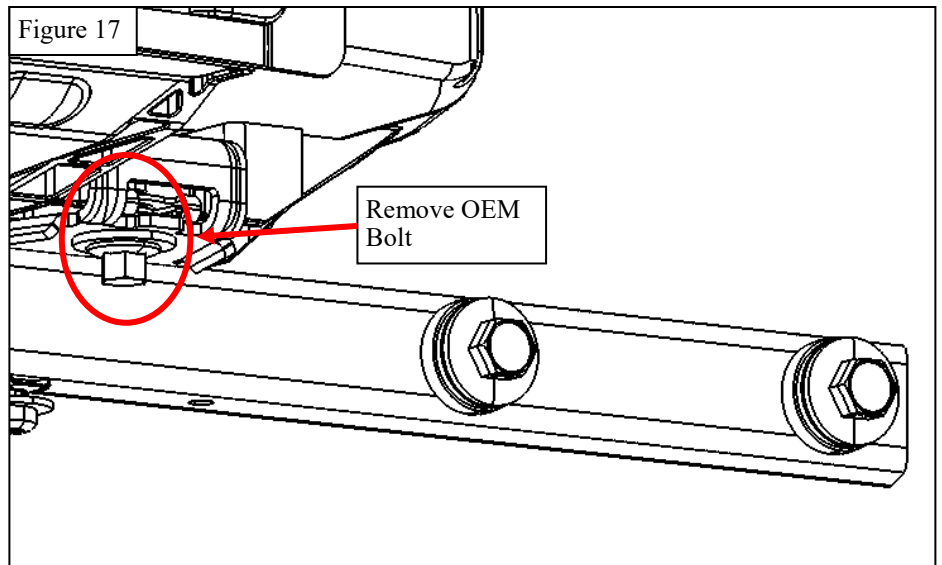
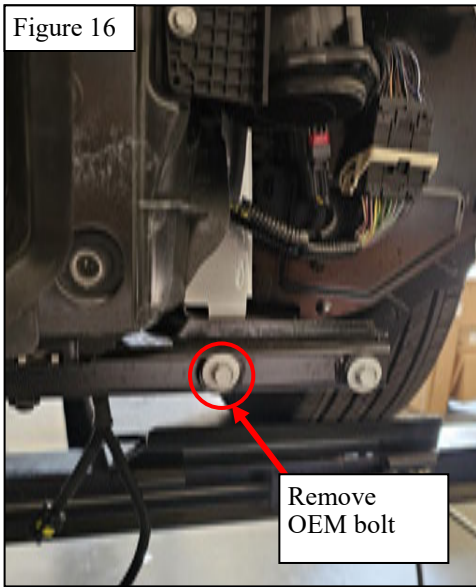

15. At this point in the installation, see Figure 19. This is how the two lower brackets on the vehicle should look. Now that the brackets are in place reinstall the trimmed bumper follow steps 2-7 in reverse order to reinstall mounts.
16. After the bumper is reinstalled, install bull bar. See **Figures 21 and 22** to see how the bull bar is installed. This step requires at least two people, one for holding bull bar in place and the other to thread in the bolts. Once bolts are threaded in, move bull bar to desired position from side to side of vehicle. Then torque them down bolts to 60ft-lbs.

Figure 20

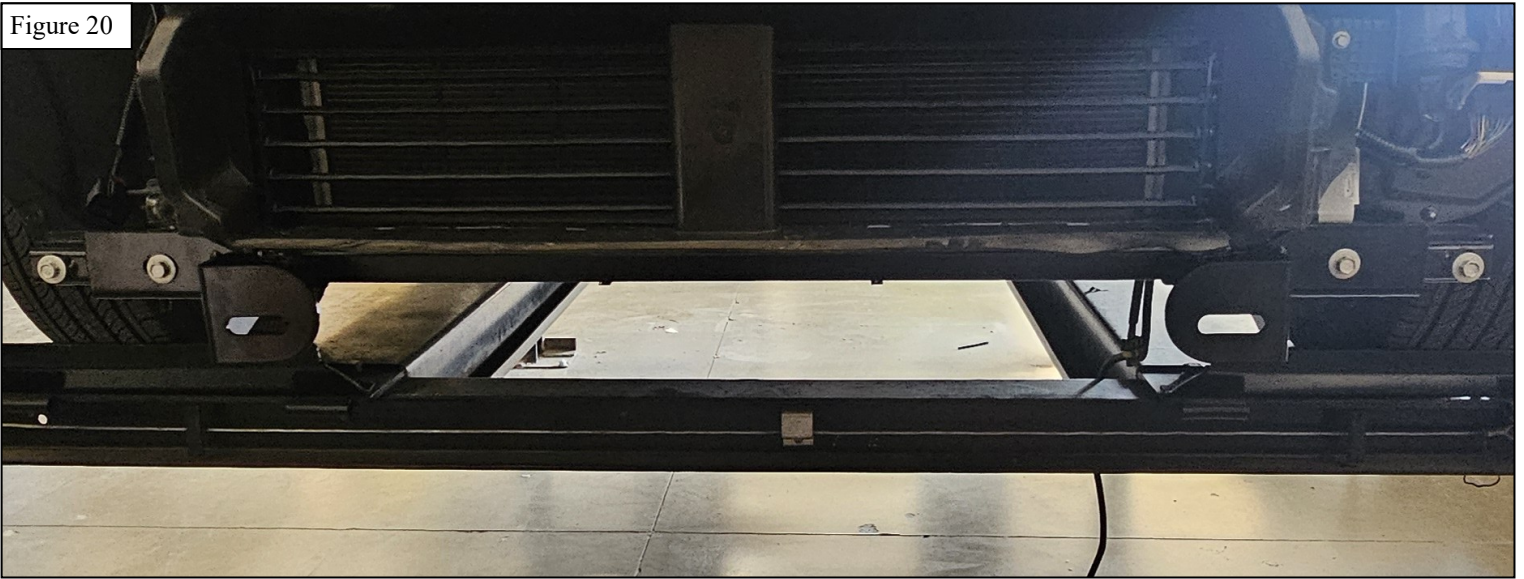

Figure 21

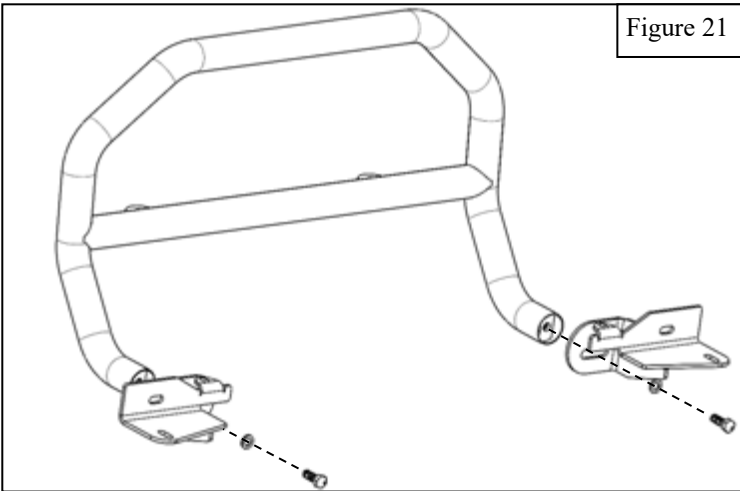
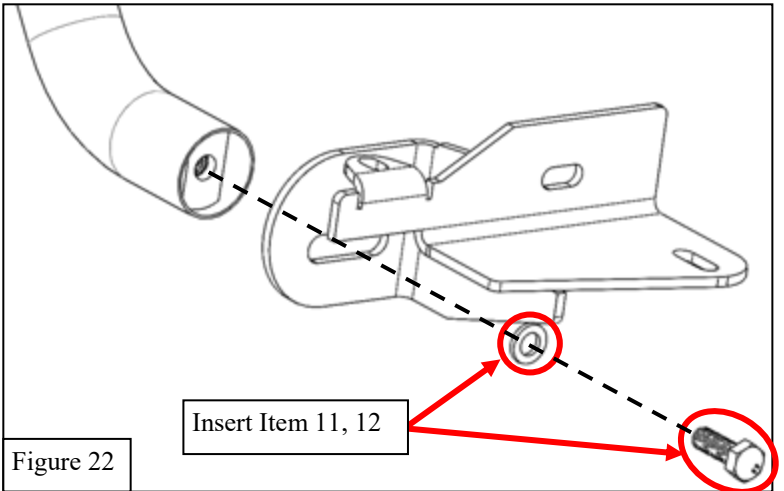

Figure 22



**INSTALLATION COMPLETE**



**CARE INSTRUCTIONS**

- REGULAR WAXING IS RECOMMENDED. DO NOT USE ANY TYPE OF POLISH OR WAX THAT MAY CONTAIN ABRASIVES.
- STAINLESS STEEL PRODUCTS CAN BE CLEANED WITH MILD SOAP AND WATER. STAINLESS STEEL POLISH SHOULD BE USED TO POLISH SMALL SCRATCHES.
- GLOSS BLACK FINISHES SHOULD BE CLEANED WITH MILD SOAP AND WATER.

**WESTIN**

Westin Automotive Products, Inc.  
320 W. Covina Blvd  
San Dimas, Ca. 91773

Thank you for choosing Westin products  
for additional installation assistance please call  
Customer Service (800) 793-7846  
[www.westinautomotive.com](http://www.westinautomotive.com)



## WARNING



Failure to follow these instructions could lead to death, personal injury, and / or property damage.

Failure to follow these instructions could lead to death, personal injury, and / or property damage.

### FASTENERS:

All Westin supplied fasteners must be utilized and installed in accordance with the installation instructions and apply torque to the specifications as defined. **DOUBLE CHECK ALL FASTENERS BEFORE INITIAL USE, AND PERIODICALLY IN THE FUTURE TO ENSURE PROPER FUNCTION AND SAFETY.**

### DRILLING:

Most Westin products do not require drilling for installation. If drilling is defined as required, use caution when drilling a vehicle. **FAILURE TO REVIEW AN AREA TO BE DRILLED MAY RESULT IN PERSONAL INJURY AND/OR INJURY TO OTHERS AS WELL AS VEHICLE DAMAGE.**

### EYE PROTECTION:

**ALWAYS WEAR SAFETY GLASSES OR GOGGLES DURING THE INSTALLATION PROCESS TO AVOID PERSONAL INJURY.**

### MAXIMUM TOWING/CARRYING CAPACITY: (if applicable)

The Westin Receiver Hitches will have a visible tow rating label affixed directly on the product. User should never exceed the vehicle manufacturers maximum tow and weight rating regardless of the capacity of the hitch. **FAILURE TO FOLLOW THESE GUIDELINES WILL VOID THE WESTIN WARRANTY AND MAY RESULT IN PERSONAL INJURY AND/OR INJURY TO OTHERS AS WELL AS VEHICLE DAMAGE.**

### FOR CALIFORNIA RESIDENTS ONLY-PROP 65 WARNING:

Some products may contain chemicals such as DEHP, which can cause cancer, birth defects or other reproductive harm. For more info go to [www.p65warnings.ca.gov](http://www.p65warnings.ca.gov)



Westin Automotive Products, Inc.  
320 W. Covina Blvd  
San Dimas, Ca. 91773