

INSTALLATION INSTRUCTIONS



Hidden Winch Mount
APPLICATION:
2022-2023 Toyota Tundra
PART NUMBER:
 2404095

CONTENT			
ITEM	QUANTITY	DESCRIPTION	TOOLS NEEDED
1	1	WINCH TRAY	FLAT HEAD SCREWDRIVER
2	1	FAIRLEAD MOUNT	
3	1	DRIVER BRACKET	UTILITY KNIFE
4	1	PASSENGER BRACKET	RATCHET
5	1	FRAME SUPPORT DRIVER BRACKET	TORQUE WRENCH
6	1	FRAME SUPPORT PASSENGER BRACKET	PRYBAR
7	1	SUPPPORT DRIVER BRACKET	ALLEN WRENCH
8	1	SUPPORT PASSENGER BRACKET	10MM SOCKET
9	2	M12 BOLT PLATE	10MM WRENCH
10	2	SPACER	18MM SOCKET
11	4	M6 FLAT WASHERS	18MM WRENCH
12	2	M6 HEX NYLOCK NUT	
13	2	M6 SPLIT LOCK WASHERS	
14	2	M6 HEX BOLT	
15	26	M12 SHORT HEX BOLT	
16	30	M12 SERRATED FLANGE HEX NUT	
17	2	M12 LONG HEX BOLT	
18	2	M12 SPLIT LOCK WASHER	
19	58	M12 FLAT WASHER	
20	2	M10 BUTTON HEAD HEX DRIVE SCREW	

ANTI-SEIZE LUBRICANT MUST BE USED ON ALL STAINLESS STEEL FASTENERS TO PREVENT THREAD DAMAGE AND GALLING

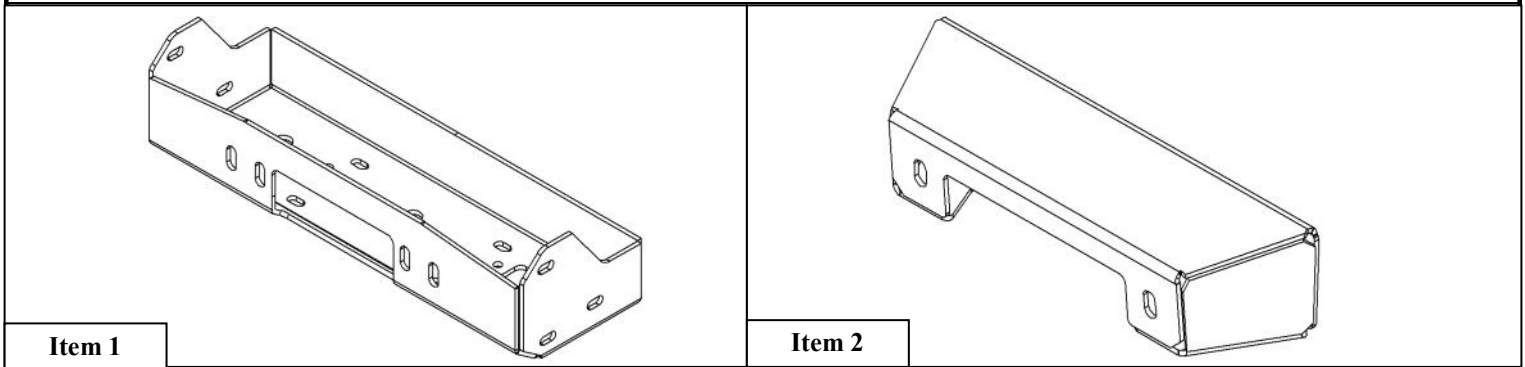

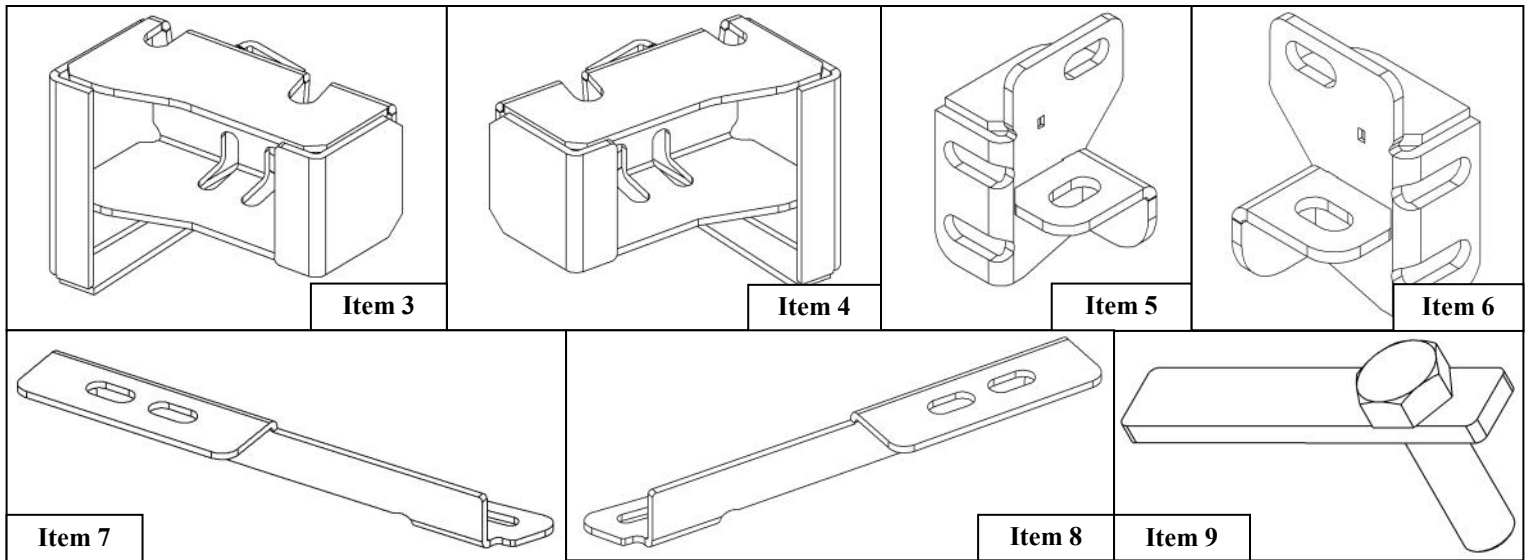

PROCEDURE

1. Remove contents from box, verify if all parts listed are present and free from damage. Carefully read and understand all instructions before attempting installation.
Failure to identify damage before installation could lead to a rejection of any claim.
2. Remove the bolts that are located on the top of the Front Bumper. See **Figure 1** for reference.
3. Remove the plastic clips and the electrical connectors that are located on the left and right side of the front bumper. See **Figure 2 & 3** for reference.
4. Remove the bolt and plastic clips that are located by the fenders and on the bottom of the front bumper.
5. Remove the fender flares and using a flat head screwdriver pop out the side of the front bumper. Repeat on the driver side. See **Figure 4 & 5** for reference.
6. Continue by pulling the front bumper off. Some force will be needed.

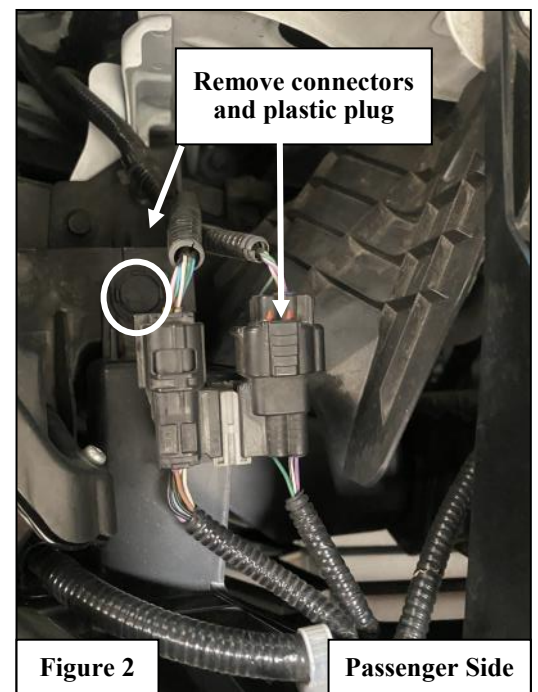
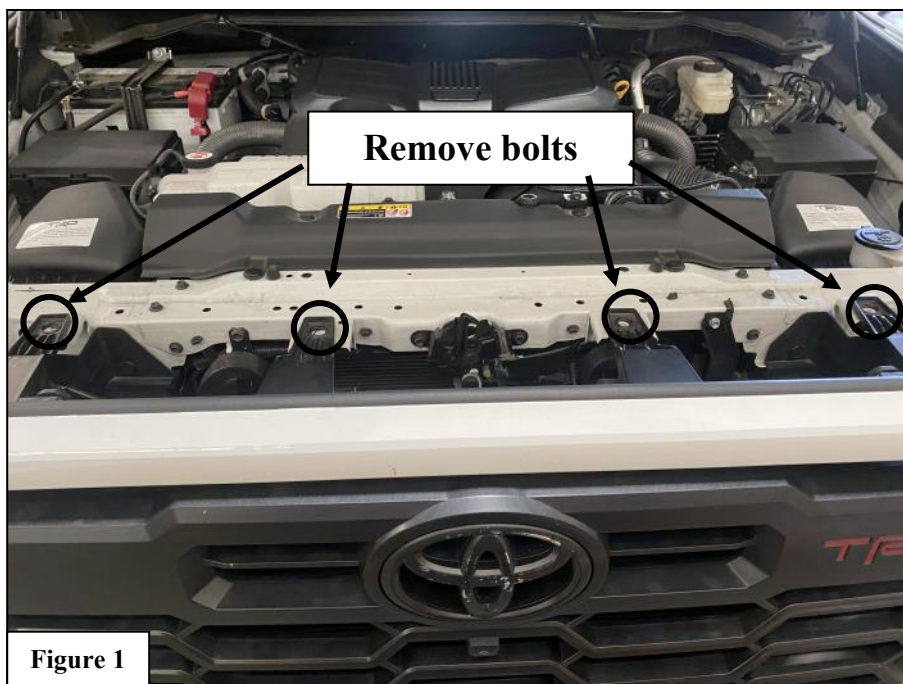

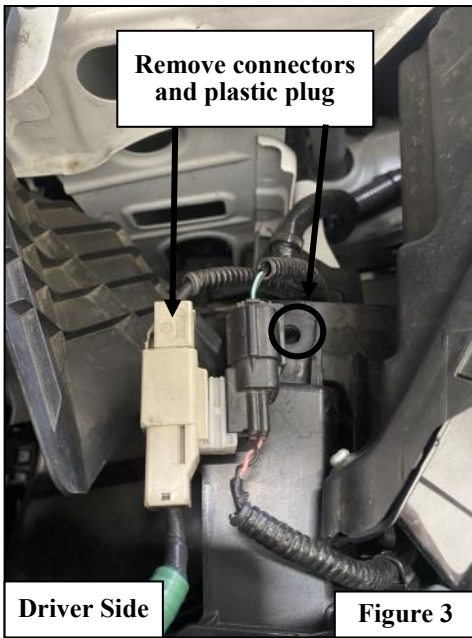

6. Cautiously disconnect all four front parking sensors attached on the front bumper. See **Figure 6,7 & 8** for reference. **NOTE:** Make sure to cautiously disconnect the sensors and remember the location and orientation to prevent any malfunctions.
7. To begin and disassemble the front bumper, start by removing the left and right side of the front bumper which are held on by 6 screws. See **Figure 6 and 7** for reference. **NOTE:** The removal of the wire harness will be removed as the front bumper is disassembled along the way.
8. Remove the bolts and wire connector on the top right that hold the active air dams. See **Figure 8** for reference.

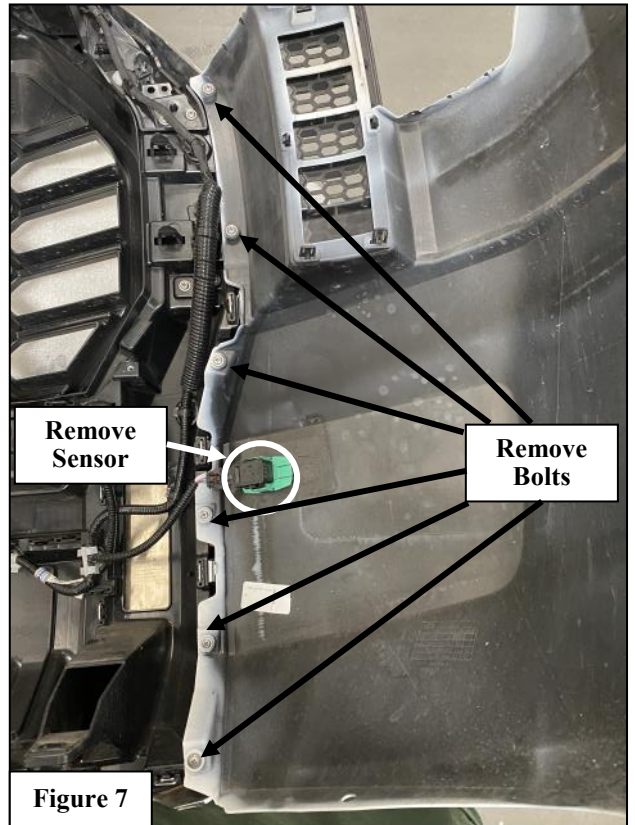
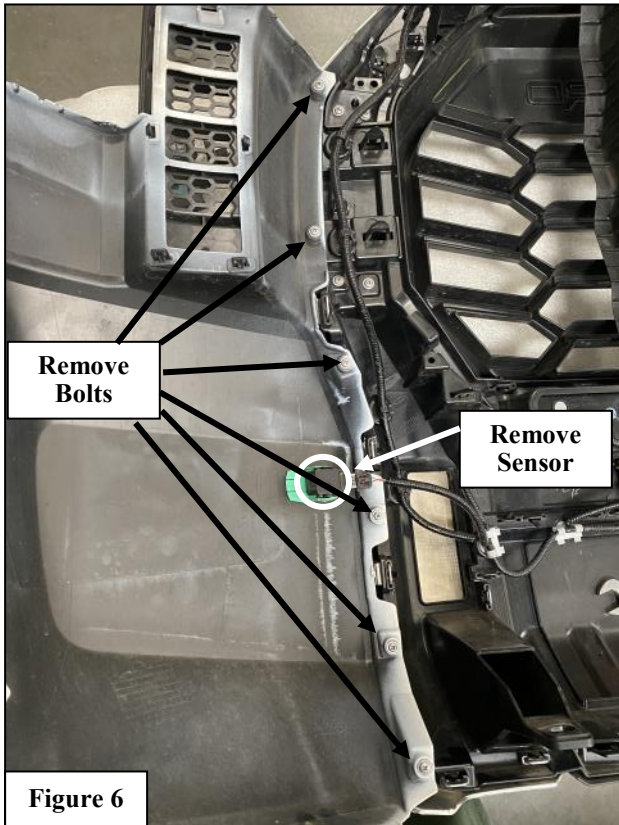

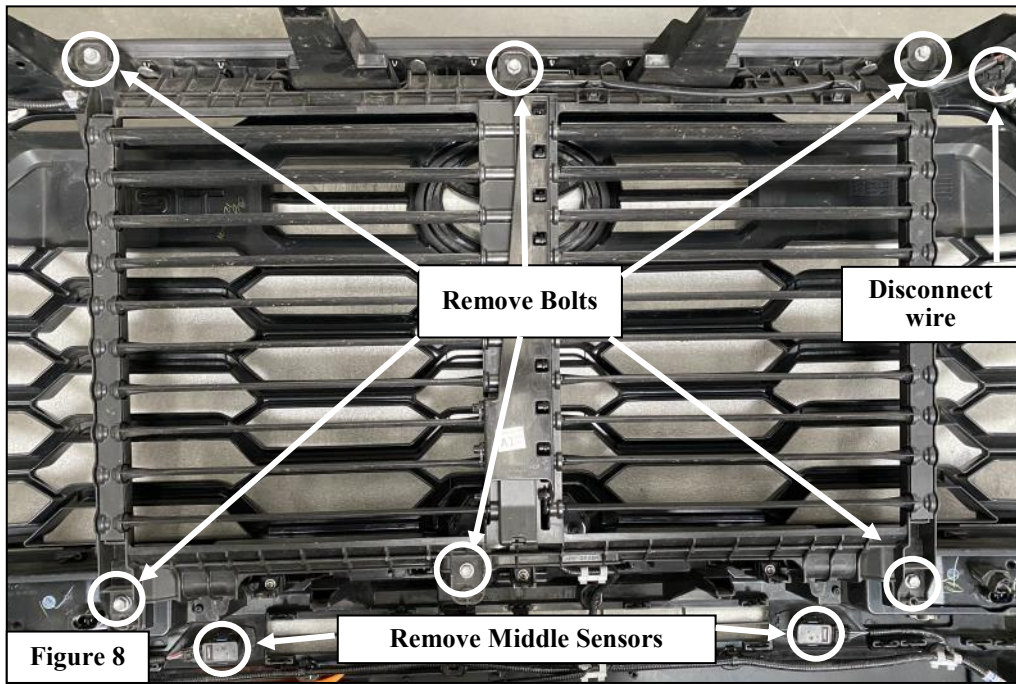

9. Proceed by removing the screws located all around the border of the front bumper. See **Figure 9, 10, & 11** for reference.
10. Begin removing the plastic clips all along the edge of the front bumper. This will remove the top trim piece of the assembly. See **Figure 9, 10, & 11** for reference.
11. To remove the front gloss piece of the grille, remove the plastic clips. See **Figure 9, 10, & 11** for reference.
12. Begin removing the plastic clips that holds the wire harness to disassemble the front bumper assembly.





Figure 10



Figure 11

13. Carefully disconnect and remove the bolts that hold the cruise control sensor. See **Figure 12** for reference. **NOTE:** *When handling the sensor make sure to place the sensor in a safe space to prevent any malfunction.*
14. Disconnect the two wires that are connected to the fog lights. Continue to take out any plastic clips that are holding the wire harness together. See **Figure 13** for reference.
15. Continue to remove the last two pieces of the assembly by removing the plastic clips. See **Figure 13** for reference.

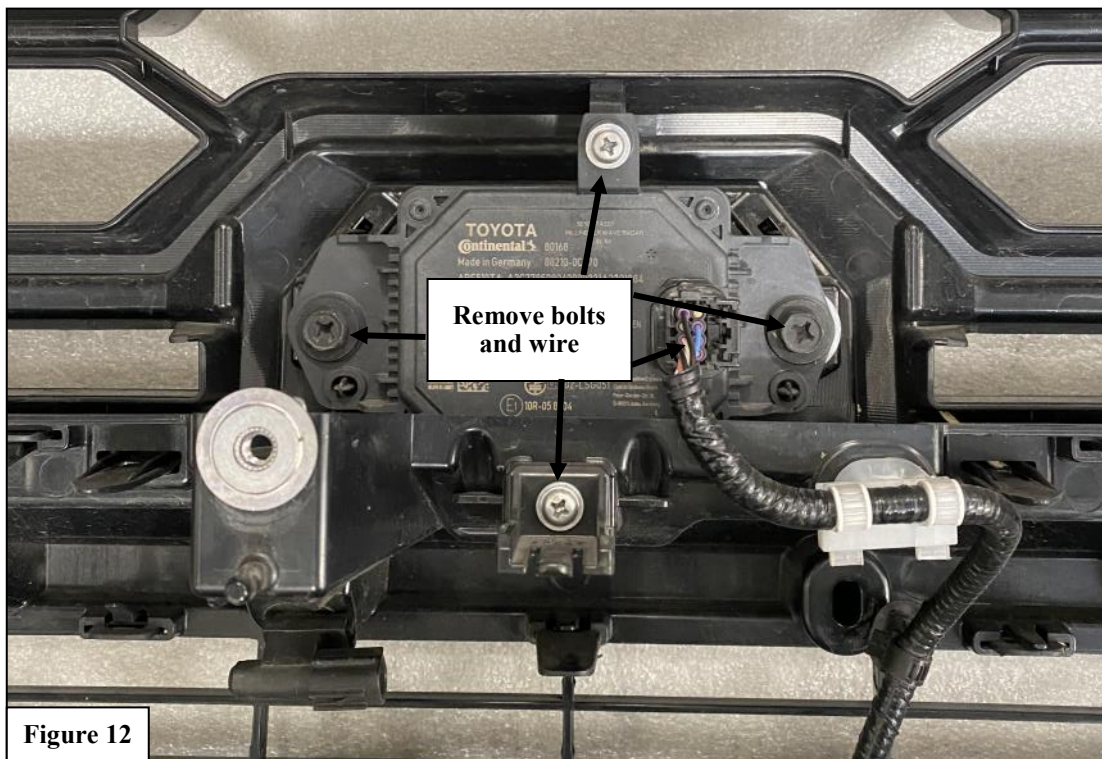
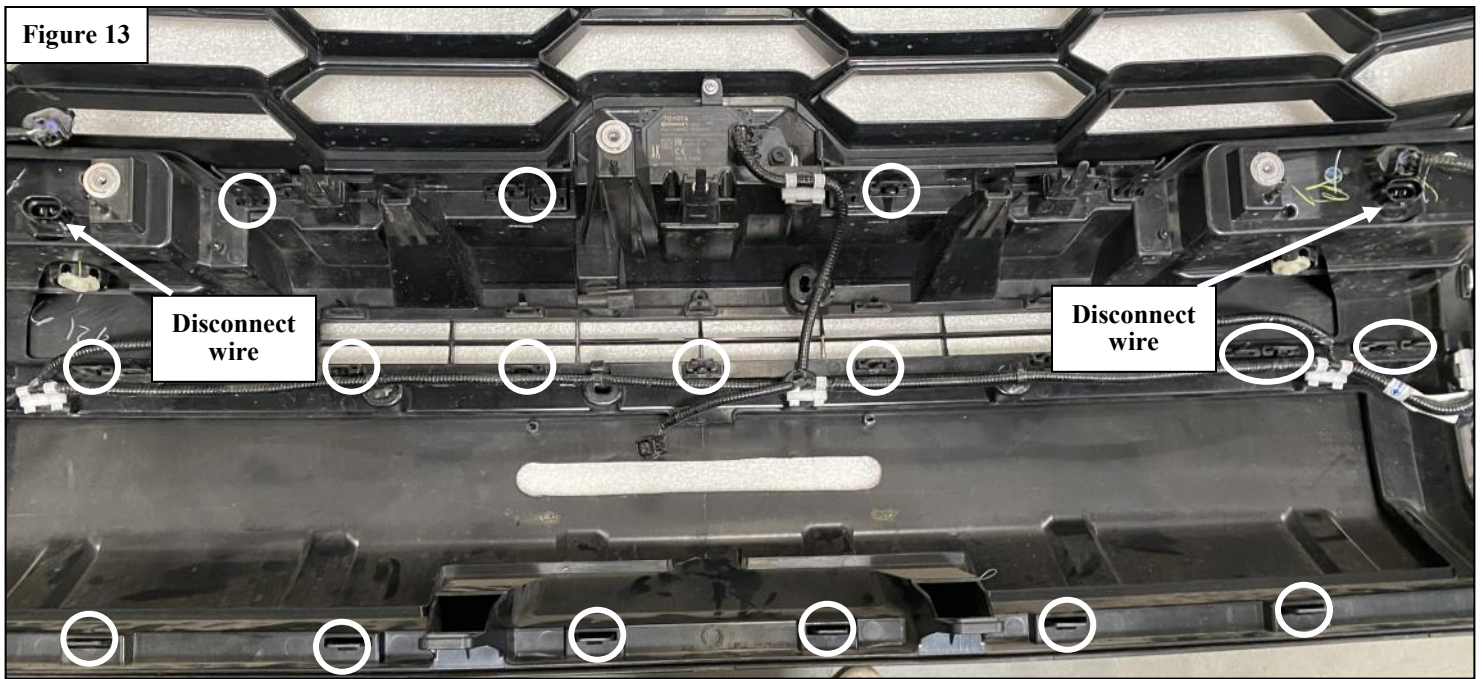

Figure 12



16. Once the front bumper has been fully disassembled, locate the bottom plastic piece of the bumper to begin trimming using the cut template provided. See **Figure 14 & 15** for reference. **Note:** Use the indent of the bottom plastic piece as a guide.
17. Once finished reassemble the front bumper. **Note:** Cautiously install the front parking sensor as they were at the beginning of the disassembly. Cautiously install the cruise control to prevent any accidents.



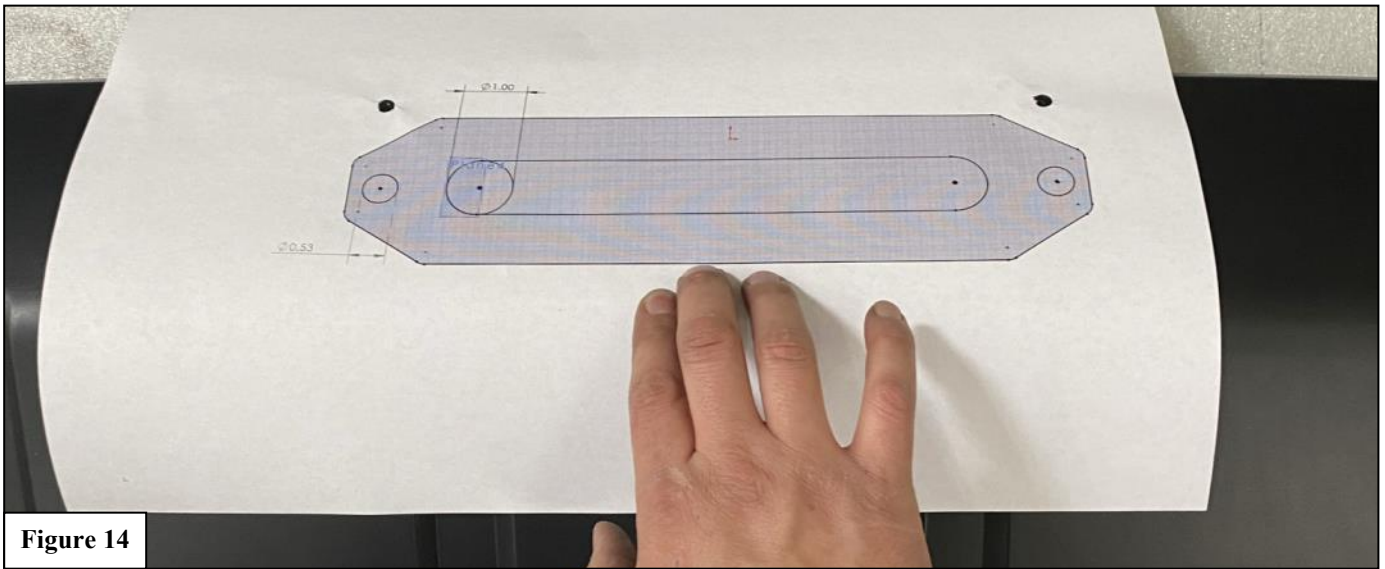

Figure 14

18. Remove the aluminum crash bar from the frame of the vehicle.
19. Slide the M12 Bolt plate (**Item 9**) through the frame. See **Figure 15 and 16** for reference.



Figure 15

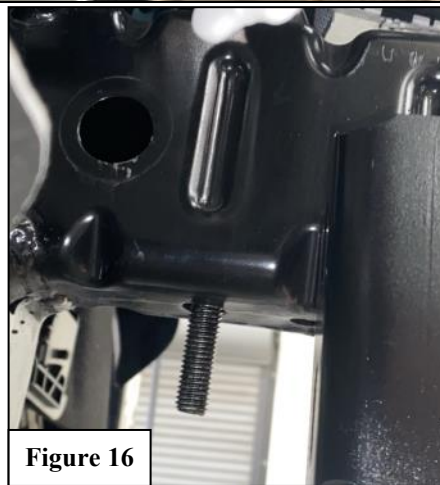
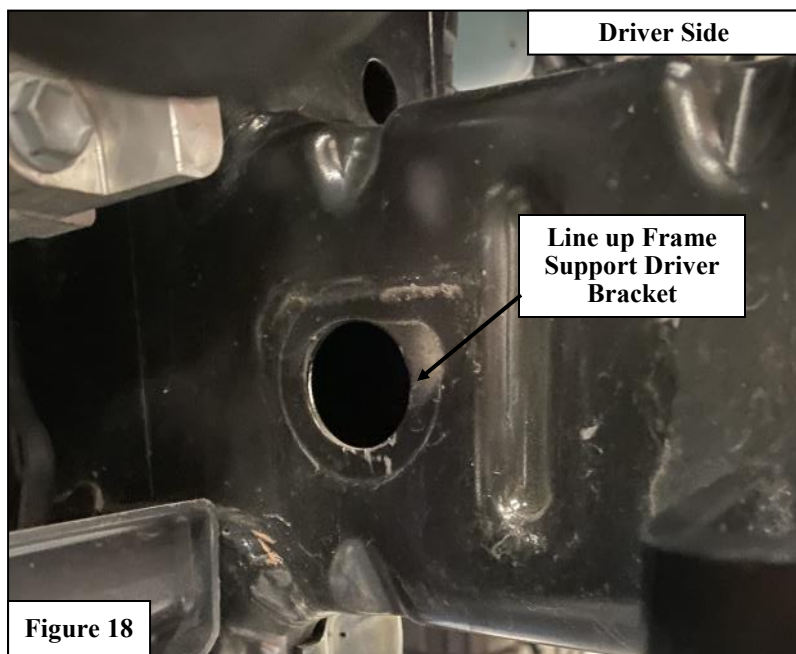
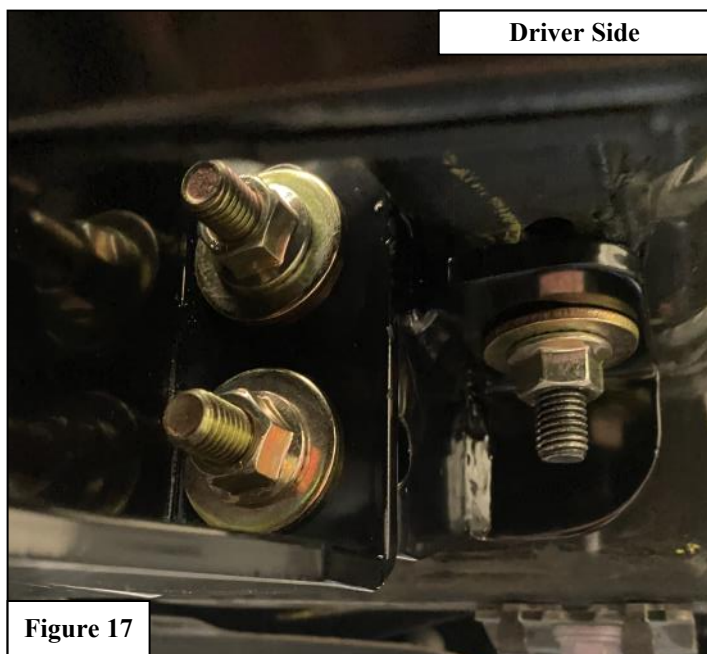
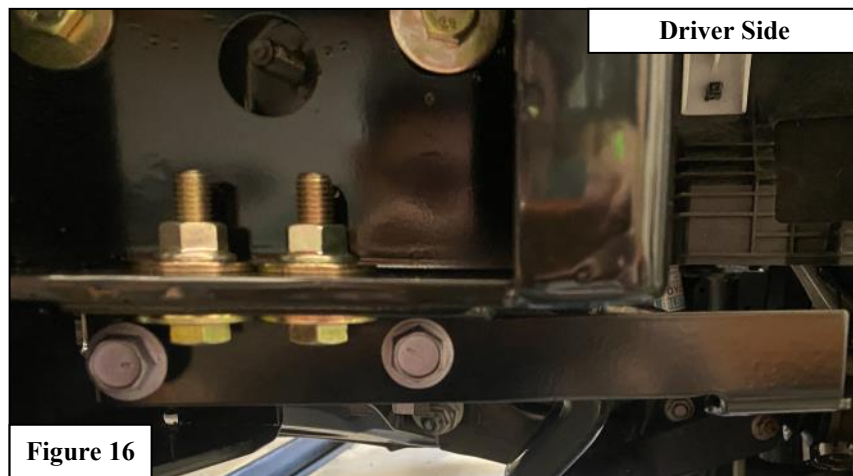
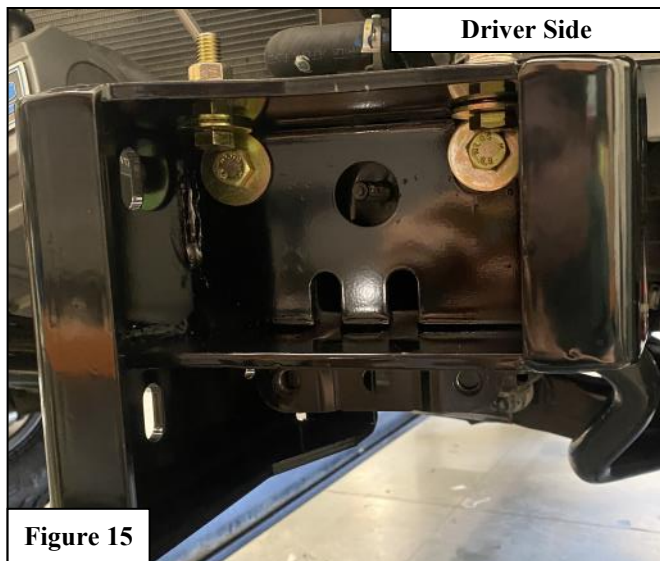
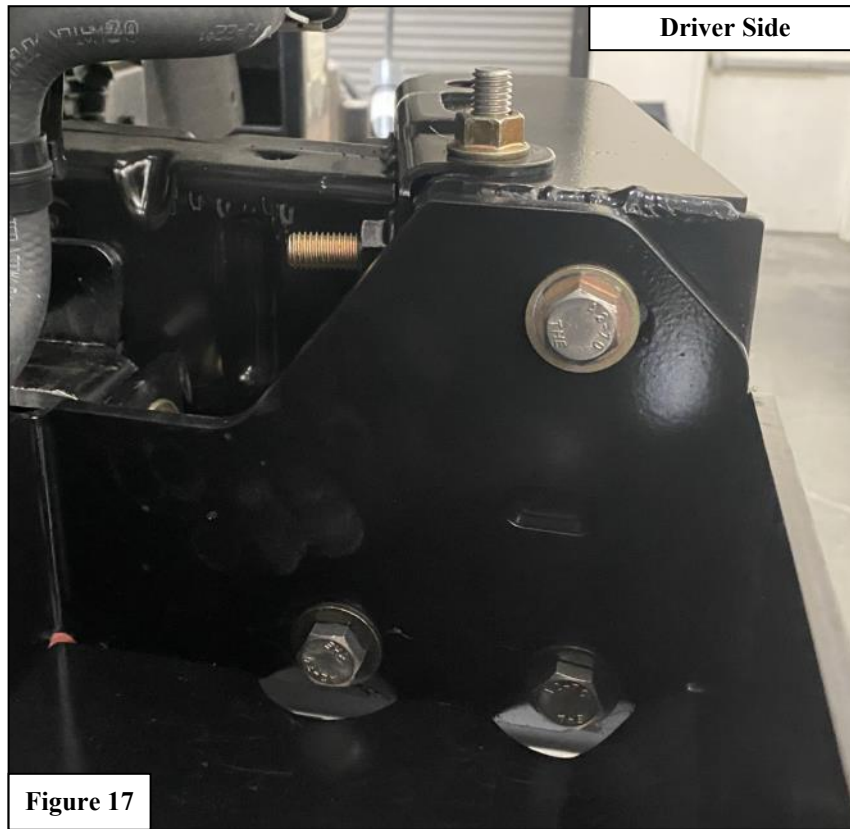

Figure 16

20. Locate the Driver Bracket (**Item 1**) and using the M12 hardware (**Items 15, 16, & 19**) provided loosely attach it to the frame of the vehicle. See **Figure 16** for reference.
21. Locate the Support Driver Bracket (**Item 7**) and using the M12 hardware (**Items 15, 16, & 19**) provided loosely attach it to the frame of the vehicle and to the Driver Bracket (**Item 1**). See **Figure 16** for reference.
22. Locate the Frame Support Driver Bracket (**Item 5**) and using the M12 hardware (**Items 15-19**) provided loosely attach it to the frame of the vehicle and to the Driver Bracket (**Item 1**). Line up the Frame Support Driver Bracket with the hole and the bolt plate (**Item 9**) that was placed previously. See **Figure 17 & 18** for reference.
23. Repeat **steps 20 - 22** on the passenger side of the vehicle.



24. Insert the Winch Tray (**Item 1**) and using the M12 hardware (**Items 15, 16, & 19**) provided loosely attach it to the Driver Bracket (**Item 3**) and Passenger Bracket (**Item 4**). See **Figure 19** for reference.



25. Using the M12 hardware (**Items 15, 16, & 19**) loosely install the Fairlead Mount (**Item 2**) to the Winch Tray (**Item 1**). See **Figure 18** for reference.

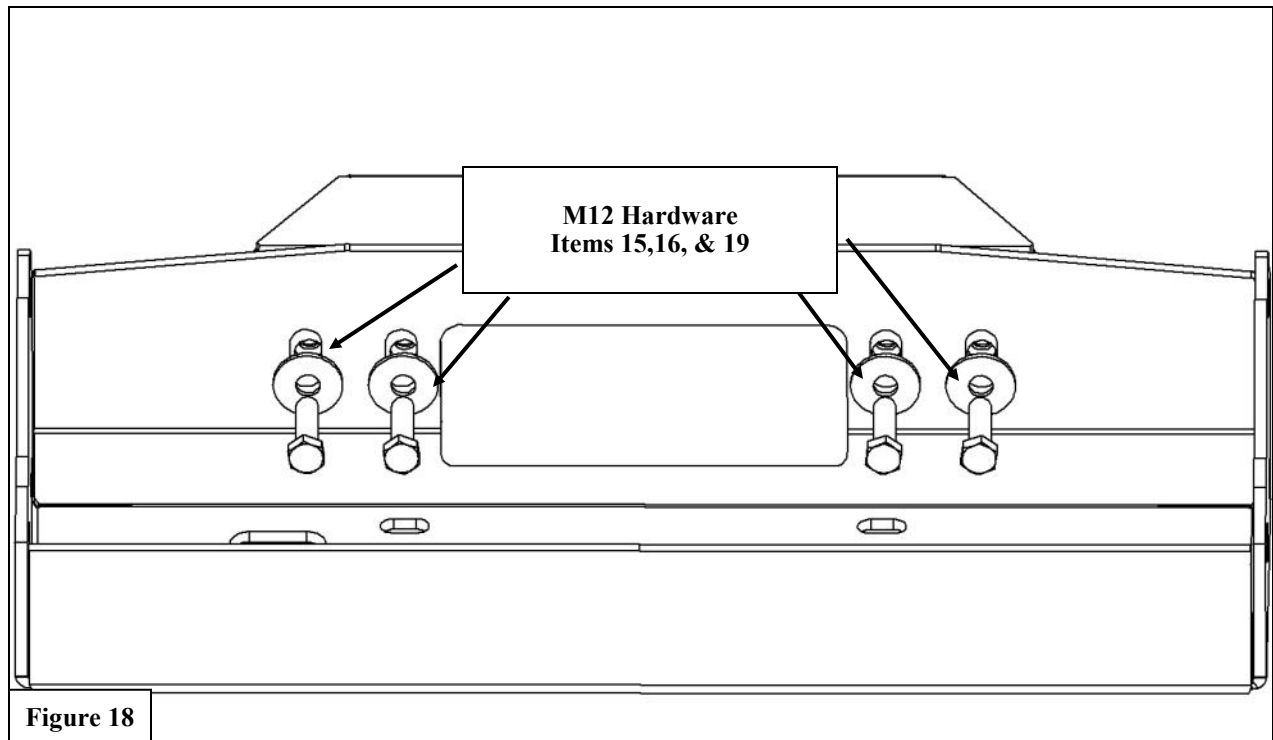

26. Locate and place the Spacer (**Item 10**) at the front opening of the Fairlead Mount (**Item 2**). See **Figure 19** for reference.
27. Use the M10 Button Head Hex (**Item 20**) Screw to secure the fairlead of the winch. See **Figure 19** for reference.
28. Align and adjust the Hidden Winch Mount and Mounting Brackets as necessary. Fully tighten and torque all hardware as specified: M6 hardware to 5-7 ft-lbs., M10 hardware to 35 ft-lbs., M12 hardware to 55-60 ft-lbs.
29. Reinstall the front bumper of the vehicle. **NOTE:** Make sure to add all plastic clips and connect any wires to be able to prevent any errors from happening.

Figure 17

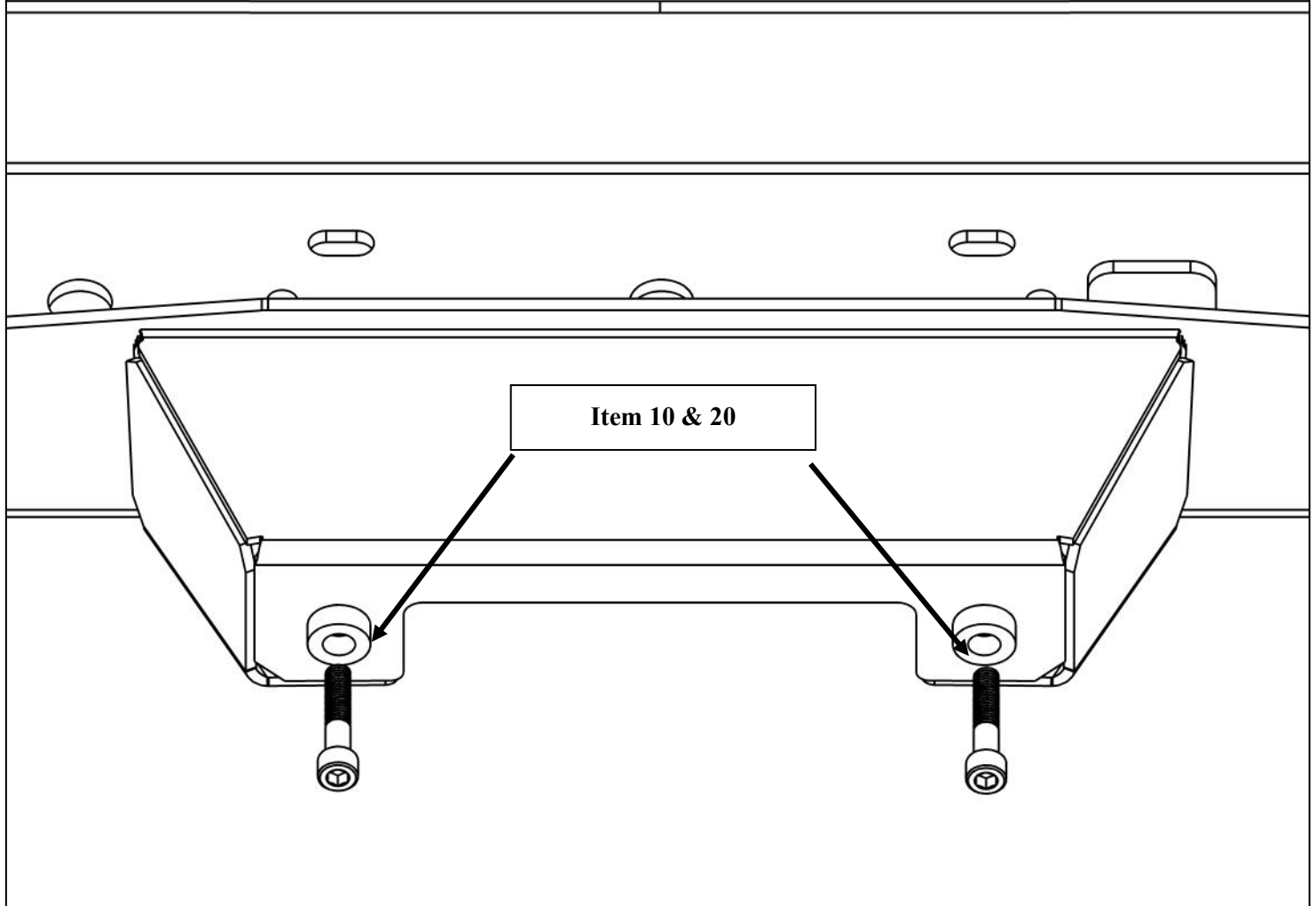

Additional Views of Assembly

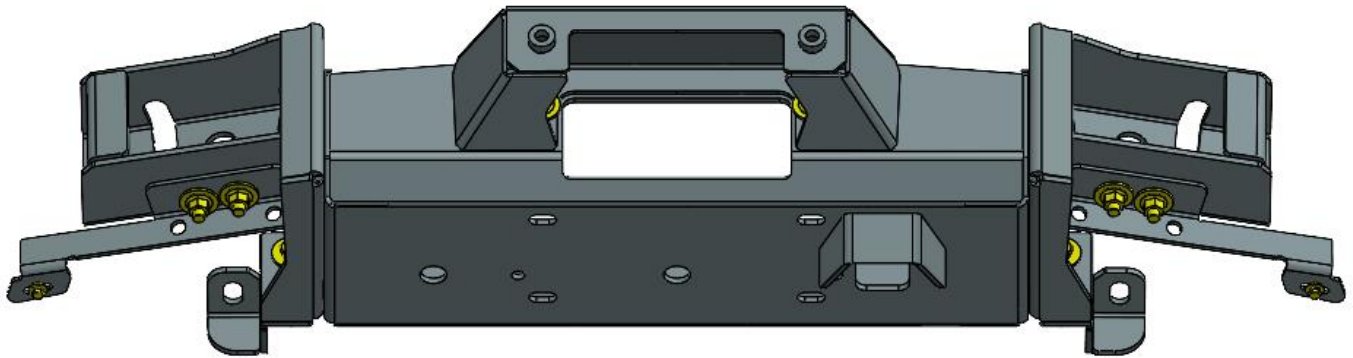
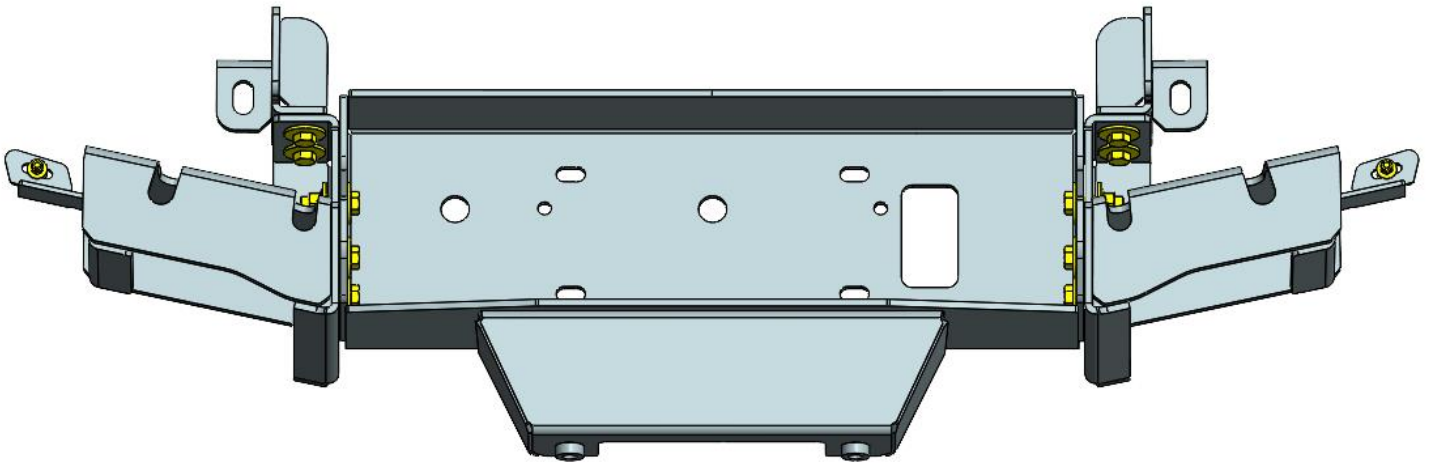

INSTALLATION COMPLETE



CARE INSTRUCTIONS

- REGULAR WAXING IS RECOMMENDED. DO NOT USE ANY TYPE OF POLISH OR WAX THAT MAY CONTAIN ABRASIVES.
- STAINLESS STEEL PRODUCTS CAN BE CLEANED WITH MILD SOAP AND WATER. STAINLESS STEEL POLISH SHOULD BE USED TO POLISH SMALL SCRATCHES.
- GLOSS BLACK FINISHES SHOULD BE CLEANED WITH MILD SOAP AND WATER.

WESTIN

Westin Automotive Products, Inc.
320 W. Covina Blvd
San Dimas, Ca. 91773

Thank you for choosing Westin products
for additional installation assistance please call
Customer Service (800) 793-7846

www.westinautomotive.com



WARNING



Failure to follow these instructions could lead to death, personal injury, and / or property damage.

Failure to follow these instructions could lead to death, personal injury, and / or property damage.

FASTENERS:

All Westin supplied fasteners must be utilized and installed in accordance with the installation instructions and apply torque to the specifications as defined. **DOUBLE CHECK ALL FASTENERS BEFORE INITIAL USE, AND PERIODICALLY IN THE FUTURE TO ENSURE PROPER FUNCTION AND SAFETY.**

DRILLING:

Most Westin products do not require drilling for installation. If drilling is defined as required, use caution when drilling a vehicle. **FAILURE TO REVIEW AN AREA TO BE DRILLED MAY RESULT IN PERSONAL INJURY AND/OR INJURY TO OTHERS AS WELL AS VEHICLE DAMAGE.**

EYE PROTECTION:

ALWAYS WEAR SAFETY GLASSES OR GOGGLES DURING THE INSTALLATION PROCESS TO AVOID PERSONAL INJURY.

MAXIMUM TOWING/CARRYING CAPACITY: (if applicable)

The Westin Receiver Hitches will have a visible tow rating label affixed directly on the product. User should never exceed the vehicle manufacturers maximum tow and weight rating regardless of the capacity of the hitch. **FAILURE TO FOLLOW THESE GUIDELINES WILL VOID THE WESTIN WARRANTY AND MAY RESULT IN PERSONAL INJURY AND/OR INJURY TO OTHERS AS WELL AS VEHICLE DAMAGE.**

FOR CALIFORNIA RESIDENTS ONLY-PROP 65 WARNING:

Some products may contain chemicals such as DEHP, which can cause cancer, birth defects or other reproductive harm. For more info go to www.p65warnings.ca.gov



Westin Automotive Products, Inc.
320 W. Covina Blvd
San Dimas, Ca. 91773