

INSTALLATION INSTRUCTIONS

OUTLAW DROP NERF STEP BARS



APPLICATION:
TOYOTA 4RUNNER 2025

PART NUMBER:
20-13785

CONTENT			
ITEM	QUANTITY	DESCRIPTION	TOOLS NEEDED
1	1	DRIVER STEP BAR ASSEMBLY	13MM SOCKET
2	1	PASSENGER STEP BAR ASSEMBLY	13MM WRENCH
3	1	DRIVER MOUNTING BRACKET "A"	15MM SOCKET
4	1	PASSENGER MOUNTING BRACKET "A"	15MM WRENCH
5	2	DRIVER MOUNTING BRACKET "B"	RATCHET
6	2	PASSENGER MOUNTING BRACKET "B"	TORQUE WRENCH
7	12	M8 HEX HEAD BOLT	
8	12	M8 FLAT WASHER	
9	12	M8 SPLIT LOCK WASHER	
10	12	M10 SERRATED FLANGE HEX HEAD BOLT	
11	12	M10 SERRATED FLANGE NUT	
ANTI-SEIZE LUBRICANT MUST BE USED ON ALL STAINLESS STEEL FASTENERS TO PREVENT THREAD DAMAGE AND GALLING			

ITEM 1 - Passenger Side Opposite

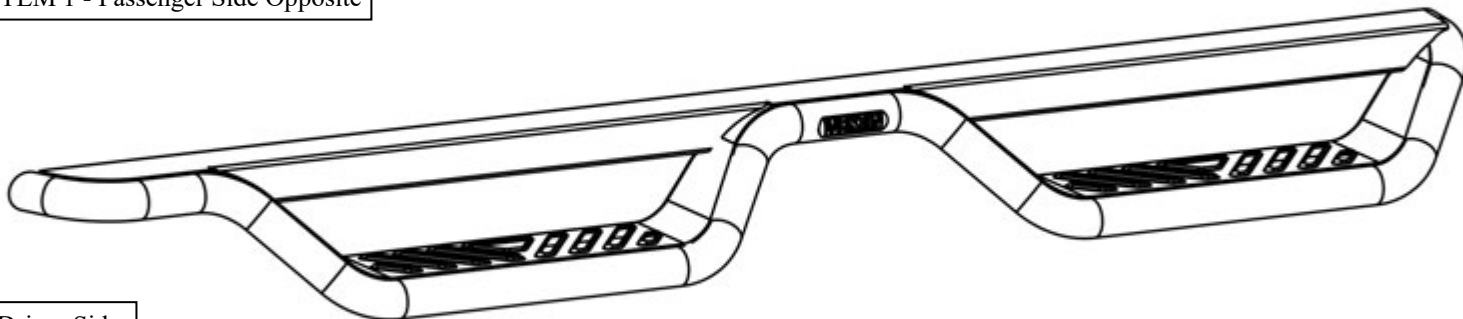

Driver Side

ITEM 3- Passenger Side Opposite

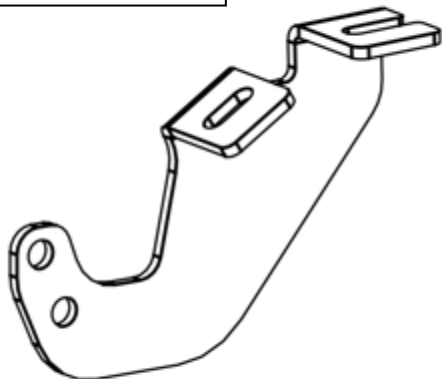

Driver Side

ITEM 5- Passenger Side Opposite

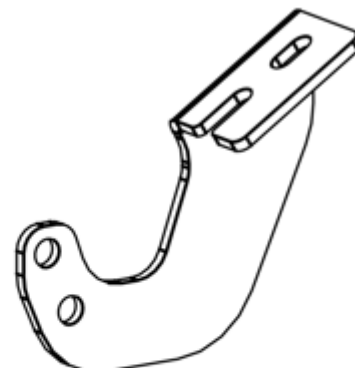

Driver Side



Westin Automotive Products, Inc.
320 W. Covina Blvd
San Dimas, Ca. 91773

Thank you for choosing Westin products
for additional installation assistance please call
Customer Service (800) 793-7846
www.westinautomotive.com

PROCEDURE

1. Remove contents from box, verify if all parts listed are present and free from damage.
Carefully read and understand all instructions before attempting installation.
Failure to identify damage before installation could lead to a rejection of any claim.
2. Find the Passenger Mounting Bracket "A" location and remove the OEM bolts. See **Figure 1**.
3. Loosely install Passenger Mounting Bracket "A" (**item 4**) using the M8 hardware (**items 7-9**). See **Figures 2 and 3**.

Driver Mounting Bracket "A" Location Shown
Passenger Similar

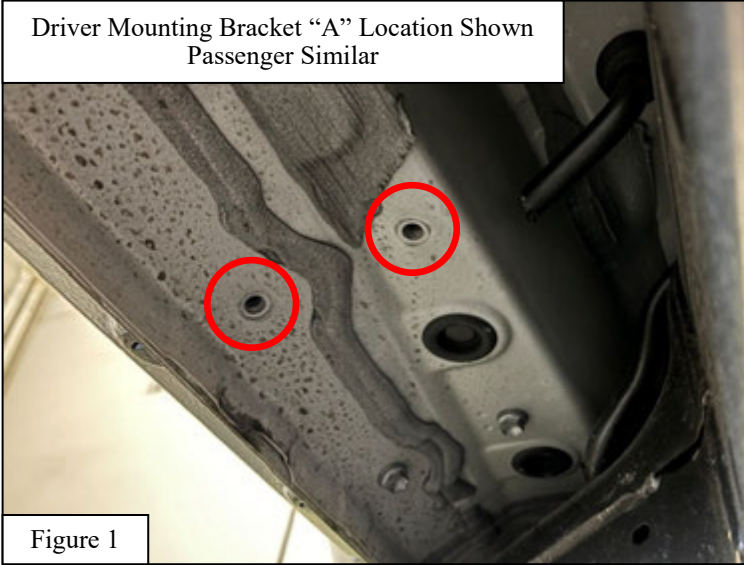

Passenger
Side Shown

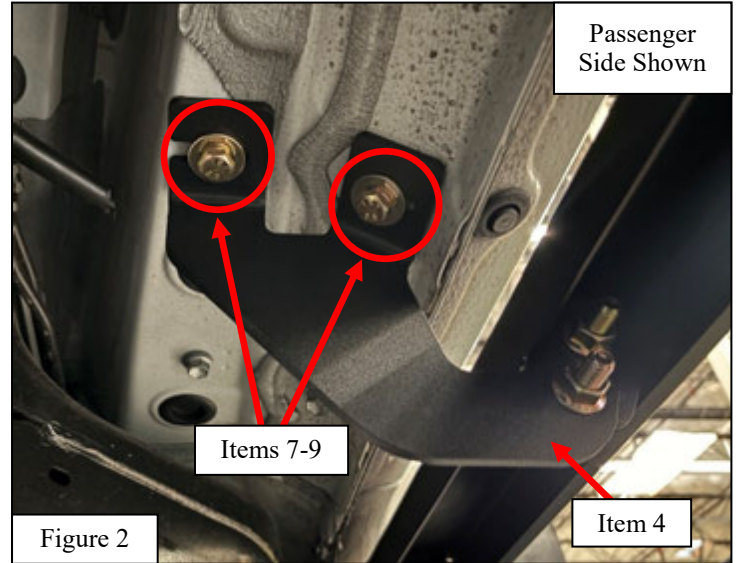

For Hardware
Usage Only

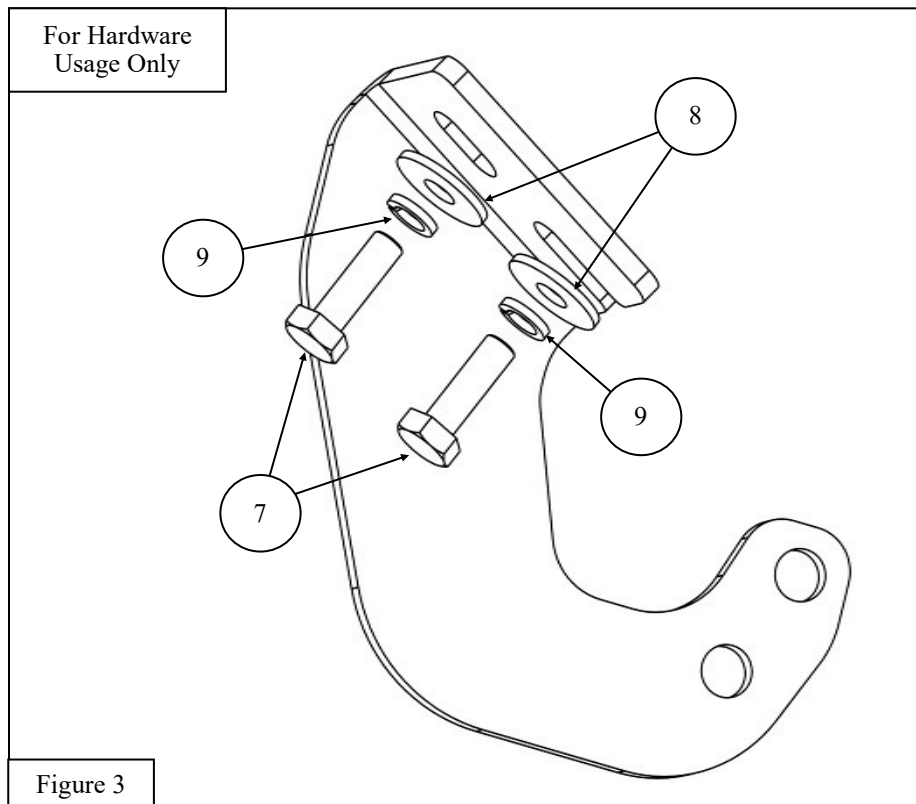

WESTIN

Westin Automotive Products, Inc.
320 W. Covina Blvd
San Dimas, Ca. 91773

4. Locate the two Passenger Mounting Bracket “B” locations and remove the OEM bolts. See **Figures 4 and 5**.
5. Loosely install the two Passenger Mounting Brackets “B” (item 6) using the M8 hardware (items 7-9). See **Figures 3 and 6**.

Front Driver Mounting Bracket “B” Location
Passenger Similar



Rear Driver Mounting Bracket “B” Location
Passenger Similar

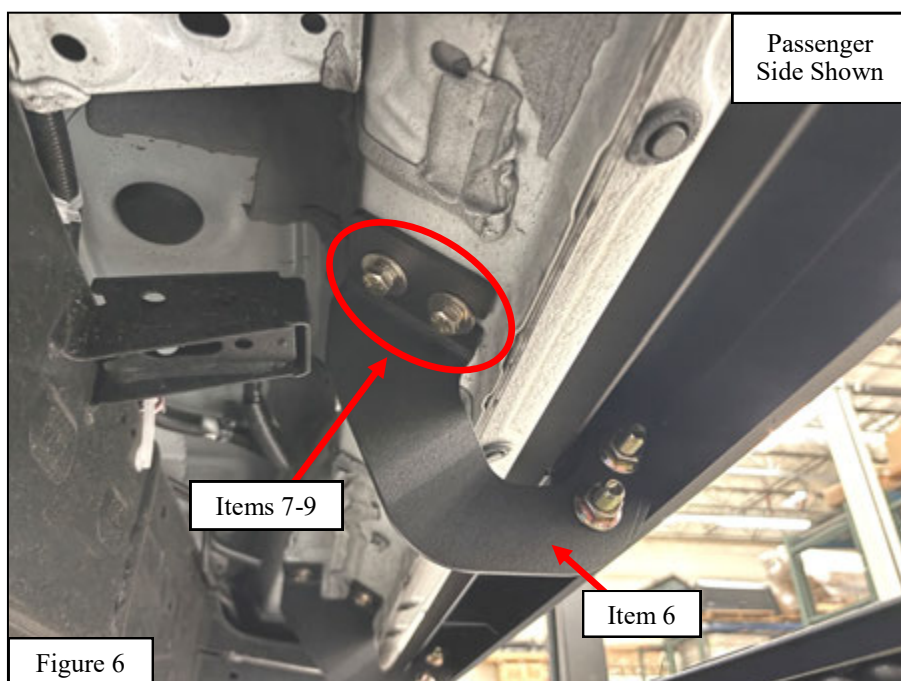

6. Repeat steps 2-5 on the driver side of the vehicle with the driver side brackets (**items 3 and 5**).
7. Loosely install the Outlaw Drop Running Boards (**items 1 and 2**) to the mounting brackets using the supplied M10 hardware (**items 10 and 11**). See **Figures 7-10**.

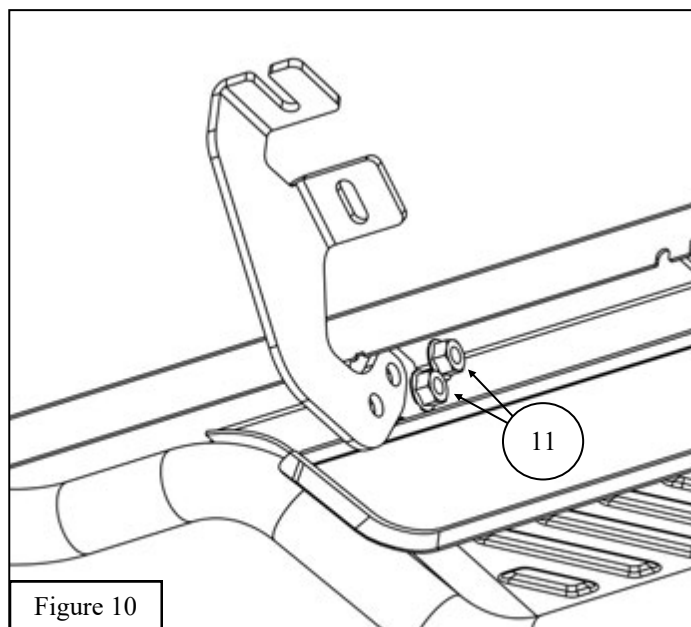
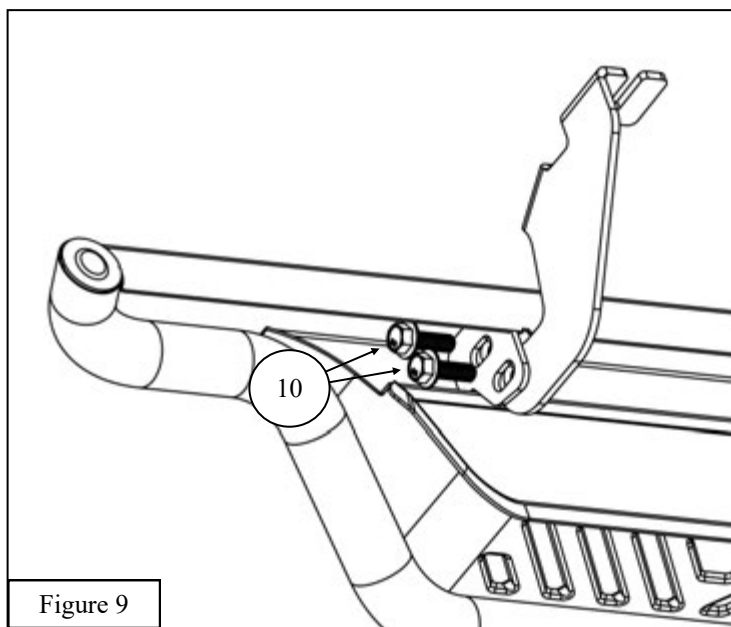
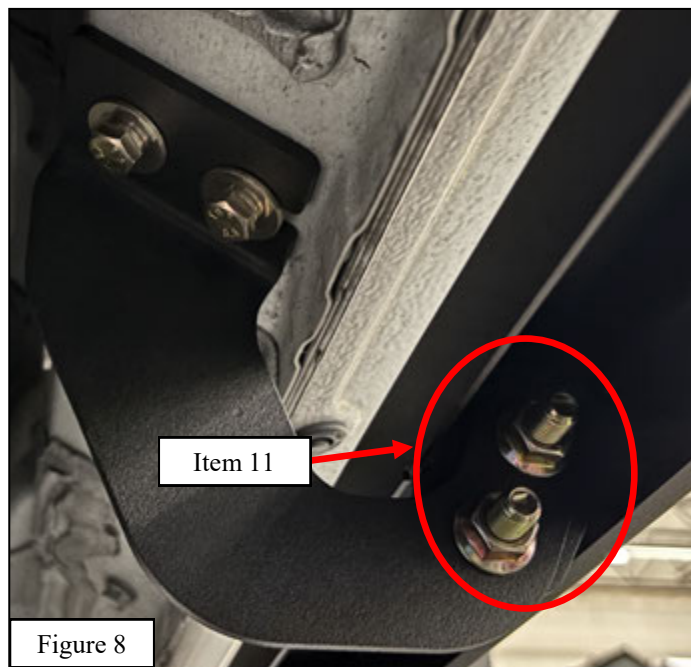
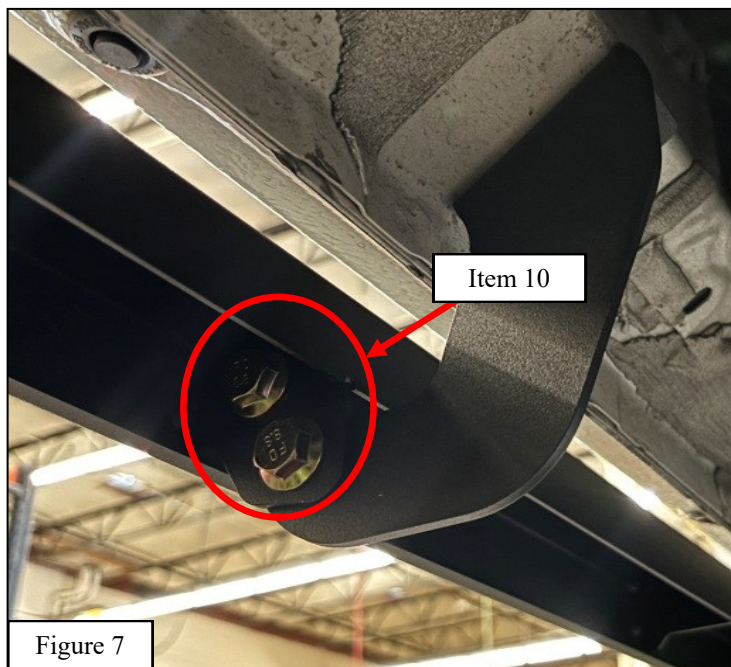

8. Align and adjust the running boards as needed. Tighten and torque all M10 hardware to 35-38 ft-lbs and all M8 hardware to 15-18 ft-lbs.

Figure 11

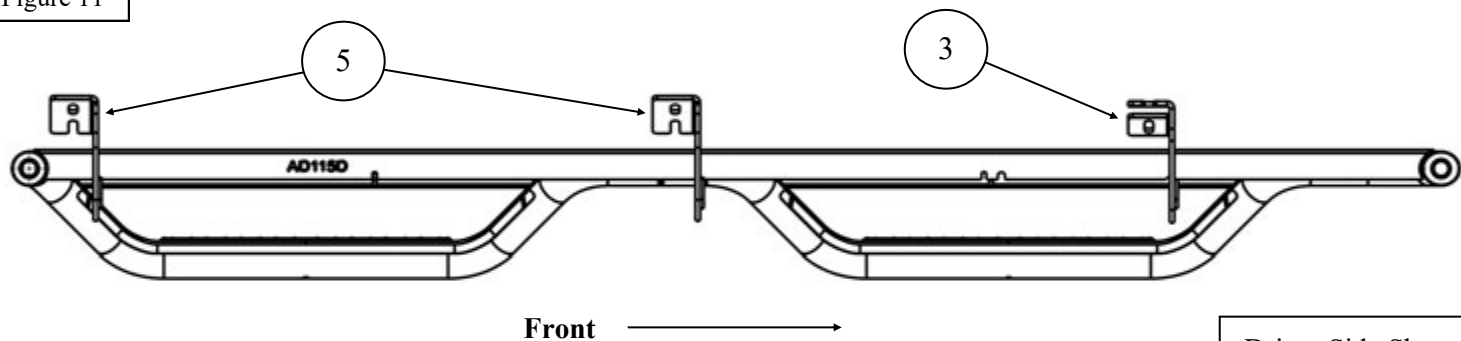
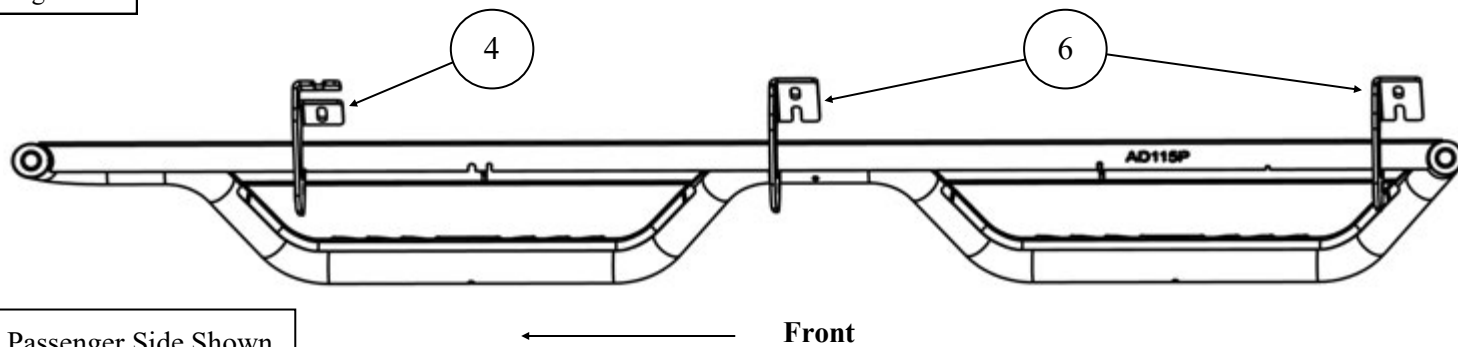

Figure 12



Westin Automotive Products, Inc.
320 W. Covina Blvd
San Dimas, Ca. 91773

INSTALLATION COMPLETE



CARE INSTRUCTIONS

- REGULAR WAXING IS RECOMMENDED. DO NOT USE ANY TYPE OF POLISH OR WAX THAT MAY CONTAIN ABRASIVES.
- STAINLESS STEEL PRODUCTS CAN BE CLEANED WITH MILD SOAP AND WATER. STAINLESS STEEL POLISH SHOULD BE USED TO POLISH SMALL SCRATCHES.
- GLOSS BLACK FINISHES SHOULD BE CLEANED WITH MILD SOAP AND WATER.

WESTIN Westin Automotive Products, Inc.
320 W. Covina Blvd
San Dimas, Ca. 91773

P.N.: 75-2013785-RevA

ECO #: W25-0086

Thank you for choosing Westin products
for additional installation assistance please call
Customer Service (800) 793-7846
www.westinautomotive.com

DATE: 08/19/2025



WARNING



Failure to follow these instructions could lead to death, personal injury, and / or property damage.

Failure to follow these instructions could lead to death, personal injury, and / or property damage.

FASTENERS:

All Westin supplied fasteners must be utilized and installed in accordance with the installation instructions and apply torque to the specifications as defined. **DOUBLE CHECK ALL FASTENERS BEFORE INITIAL USE, AND PERIODICALLY IN THE FUTURE TO ENSURE PROPER FUNCTION AND SAFETY.**

DRILLING:

Most Westin products do not require drilling for installation. If drilling is defined as required, use caution when drilling a vehicle. **FAILURE TO REVIEW AN AREA TO BE DRILLED MAY RESULT IN PERSONAL INJURY AND/OR INJURY TO OTHERS AS WELL AS VEHICLE DAMAGE.**

EYE PROTECTION:

ALWAYS WEAR SAFETY GLASSES OR GOGGLES DURING THE INSTALLATION PROCESS TO AVOID PERSONAL INJURY.

MAXIMUM TOWING/CARRYING CAPACITY: (if applicable)

The Westin Receiver Hitches will have a visible tow rating label affixed directly on the product. User should never exceed the vehicle manufacturers maximum tow and weight rating regardless of the capacity of the hitch. **FAILURE TO FOLLOW THESE GUIDELINES WILL VOID THE WESTIN WARRANTY AND MAY RESULT IN PERSONAL INJURY AND/OR INJURY TO OTHERS AS WELL AS VEHICLE DAMAGE.**

FOR CALIFORNIA RESIDENTS ONLY-PROP 65 WARNING:

Some products may contain chemicals such as DEHP, which can cause cancer, birth defects or other reproductive harm. For more info go to www.p65warnings.ca.gov



Westin Automotive Products, Inc.
320 W. Covina Blvd
San Dimas, Ca. 91773