



INSTALLATION INSTRUCTIONS

ULTIMATE BULL BAR

APPLICATION:

2016-2018 Chevrolet Silverado 1500

2016-2018 GMC Sierra 1500

PART NUMBER:

32-3870, 32-3875, 32-3870L, 32-3875L, 32-3920, 32-3925.

ITEM	QUANTITY	DESCRIPTION	TOOLS NEEDED
1	1	ULTIMATE BULL BAR ASSEMBLY	18MM WRENCH
2,3	2	MOUNT BRACKET, DRIVER (2) AND PASSENGER (3)	18MM SOCKET
4	4	M12 HEX HEAD CAP SCREW (YELLOW ZINC)	9/16 WRENCH
5	8	M12 FLAT WASHER (YELLOW ZINC)	RATCHET
6	4	M12 SPLIT LOCK WASHER (YELLOW ZINC)	TORQUE WRENCH
7	4	M12 HEX NUT (YELLOW ZINC)	ALLEN WRENCH
8	4	3/8-16 HEX SOCKET BUTTON HEAD SCREW (BLACK ZINC OR RAW) S/S	
9	8	3/8 SAE FLAT WASHER (BLACK ZINC OR RAW) S/S	13MM WRENCH
10	4	3/8 SPLIT LOCK WASHER (BLACK ZINC OR RAW) S/S	
11	4	3/8-16 HEX NUT (BLACK ZINC OR RAW) S/S	
12	1	LED WIRING HARNESS (09-12000-1)	

ANTI-SEIZE LUBRICANT MUST BE USED ON ALL STAINLESS STEEL FASTENERS TO PREVENT THREAD DAMAGE AND GALLING

32-3870 / 32-3875 / 32-3920 / 32-3925	ITEM 1	32-3870L / 32-3875L	ITEM 2	DRIVER SIDE SHOWN
				<p>BRACKETS FOR 32-3870 & 32-3875 32-3870L & 32-3875L</p>
				<p>BRACKETS FOR 32-3920 & 32-3925</p>

PROCEDURE

1. Remove contents from box, verify if all parts listed are present and free from damage. Carefully read and understand all instructions before attempting installation.
Failure to identify damage before installation could lead to a rejection of any claim.
2. *For models with factory tow hooks:* The driver side tow hook bolt must either be cut or the bumper must be removed to complete the Bull Bar installation.
3. *For models with factory tow hooks:* If removing bumper see **Figures 1 and 2**.
4. *For models with factory tow hooks:* Remove the tow hook bolts and the foam tow hook covers. Tow hooks cannot be reinstalled with application. See **Figures 3 and 4**.
5. *For models without factory tow hooks:* Trim the tow hook pockets in the front valance.

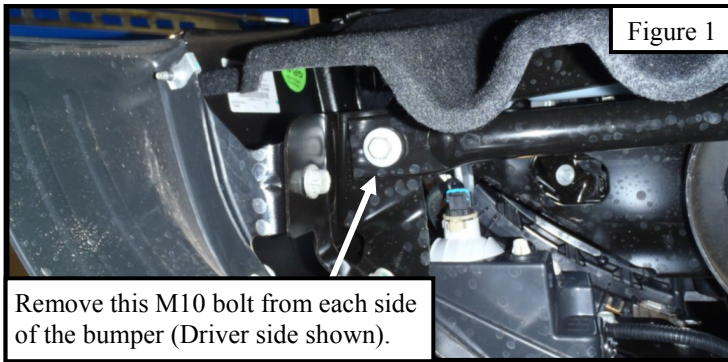

Remove this M10 bolt from each side of the bumper (Driver side shown).

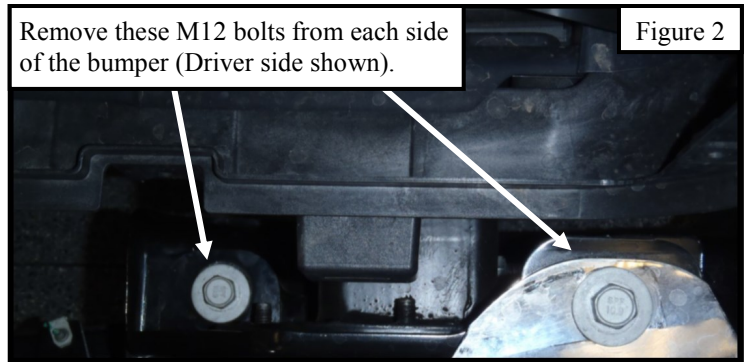

Remove these M12 bolts from each side of the bumper (Driver side shown).

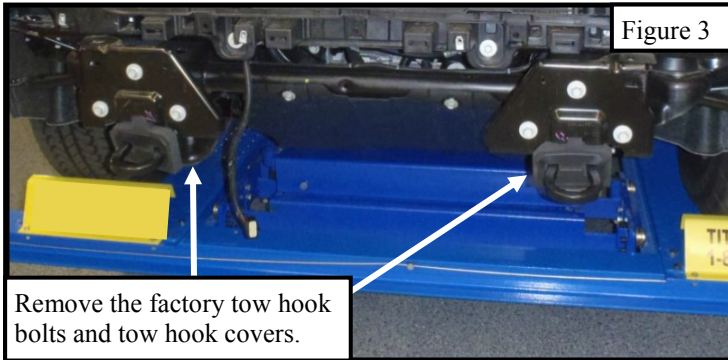

Remove the factory tow hook bolts and tow hook covers.

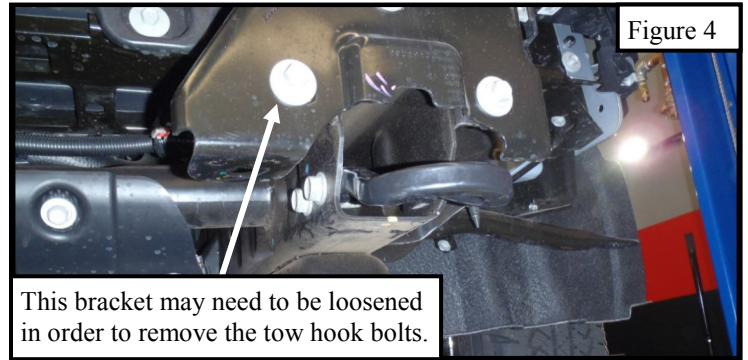

This bracket may need to be loosened in order to remove the tow hook bolts.

6. Locate (1) mount bracket (Item 2/3). Loosely install brackets using the provided M12 hardware. Repeat for other side. See **Figure 5**. See page 3 for bracket locations.
Note: Refer to Item 2 on page 1 for the different mount bracket for Silverado and Sierra.
7. Reinstall bumper (if removed). Trim tow hook pockets as necessary.
8. With assistance loosely install the Ultimate Bull Bar Assembly (Item 1) onto the previously installed brackets. Loosely bolt bull bar to brackets using the provided 3/8" hardware. See **Figure 6**.
9. Align and adjust the bull bar and brackets as necessary then tighten and torque all fasteners as follows: M12 to 50-55 ft-lbs, 3/8" to 25-30 ft-lbs.
10. **For part numbers 32-3870L & 32-3875L:** Refer to **Page 4** for wiring instructions. Loosen M8 hardware to adjust the LED light in bull bar or to remove it in order to replace it. See **Figure 7** for location of M8 hardware.

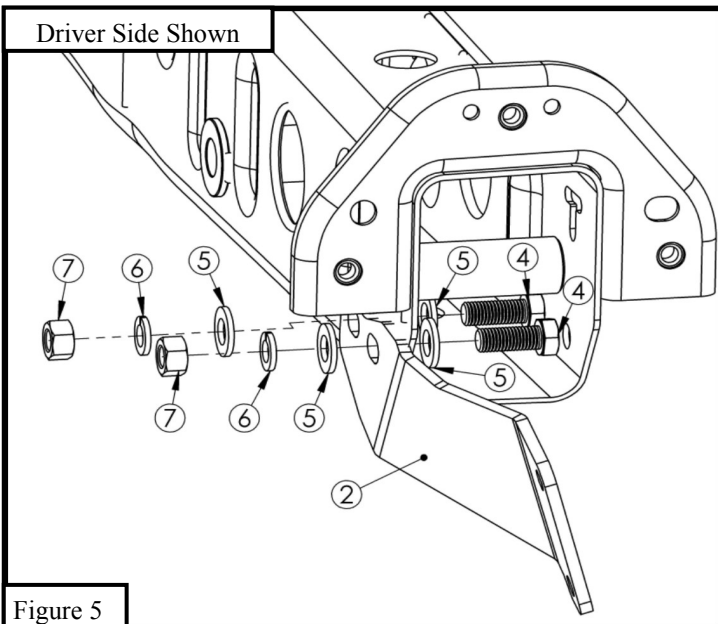

Figure 5

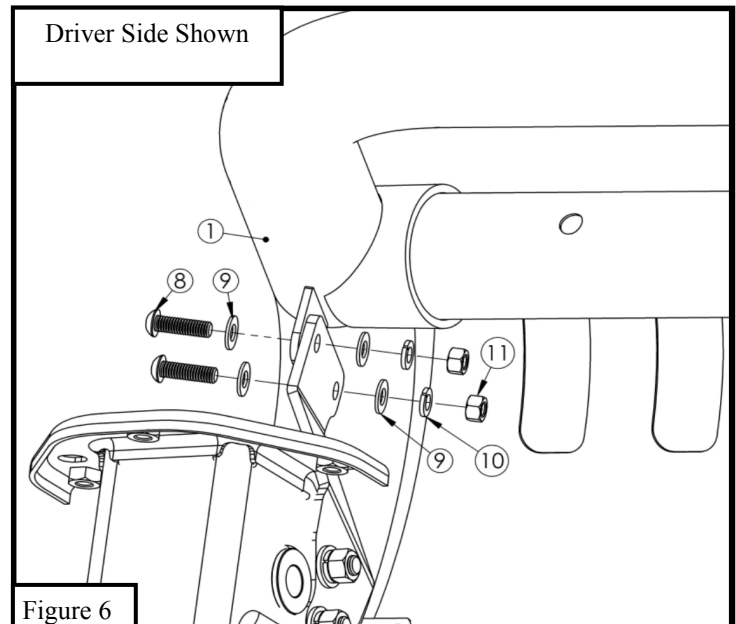
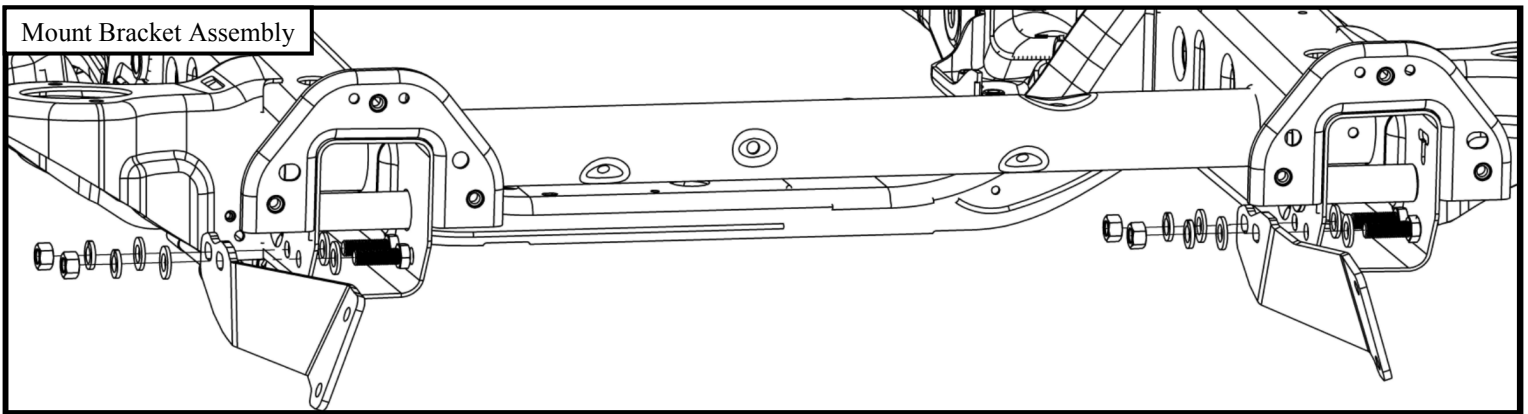

Figure 6



CARE INSTRUCTIONS

- REGULAR WAXING IS RECOMMENDED. DO NOT USE ANY TYPE OF POLISH OR WAX THAT MAY CONTAIN ABRASIVES.
- STAINLESS STEEL PRODUCTS CAN BE CLEANED WITH MILD SOAP AND WATER. STAINLESS STEEL POLISH SHOULD BE USED TO POLISH SMALL SCRATCHES.
- GLOSS BLACK FINISHES SHOULD BE CLEANED WITH MILD SOAP AND WATER.

WESTIN Westin Automotive Products, Inc.
320 W. Covina Blvd
San Dimas, Ca. 91773

Thank you for choosing Westin products
for additional installation assistance please call
Customer Service (800) 793-7846
www.westinautomotive.com

WIRING INSTRUCTIONS FOR 32-3870L & 32-3875L:

WESTIN recommends using a professional for this installation.

CAUTION:

1. Disconnect ground connection from battery (-) to avoid accidental short circuits before attempting to connect electrical wires.
2. When running wires, avoid areas of excessive heat, vibration, pinch or rotation when securing harness to vehicle.
3. Always use a fused (+) positive supply source.
4. This light becomes hot under continuous use. Do not remove or touch the casting for at least 30 minutes after the lamp has been turned off.

Refer to Figure 8.

1. Locate wiring harness and mount the switch in a convenient location where it is easily accessible from the drivers seat.
Note: *The switch will need to be removed from the wiring harness so that the rest of the harness can be routed from the engine bay to the cabin.*
2. Route the wiring harness wire, specifically the fuse and relay, from the positive battery terminal along the firewalls existing wire routes. **Note:** *Tape as necessary to correct slack.*
3. Secure the relay by either drilling or using a pre-existing bolt along the chassis that is not connected to any other wire.
4. Run the switch harness through the firewall preferably through the pre-existing rubber plug that is used to run the OEM wiring harness from the engine bay to fuse box. **Note:** *Reconnect the switch to the wiring harness.*
5. Place the LED plug wire along the fender chassis where it will not get pinched and away from any moving parts (fan, pulleys etc.).
6. Run the attached wire from the LED Light Bar as previously mentioned away from any moving parts.
7. Connect both ends of wiring connectors from LED light bar and wiring harness.
8. Re-connect battery terminals, attach the Red (+) wire to battery positive, and the black (-) wire to ground. **Note:** *Add dielectric grease (not supplied).*
9. Turn on the switch to make sure if the lamp works. If not, please check carefully if the wiring installation is correct.

M8 hardware attaches LED light onto bull bar.

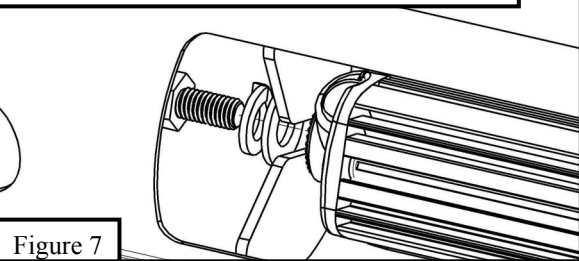

Figure 7

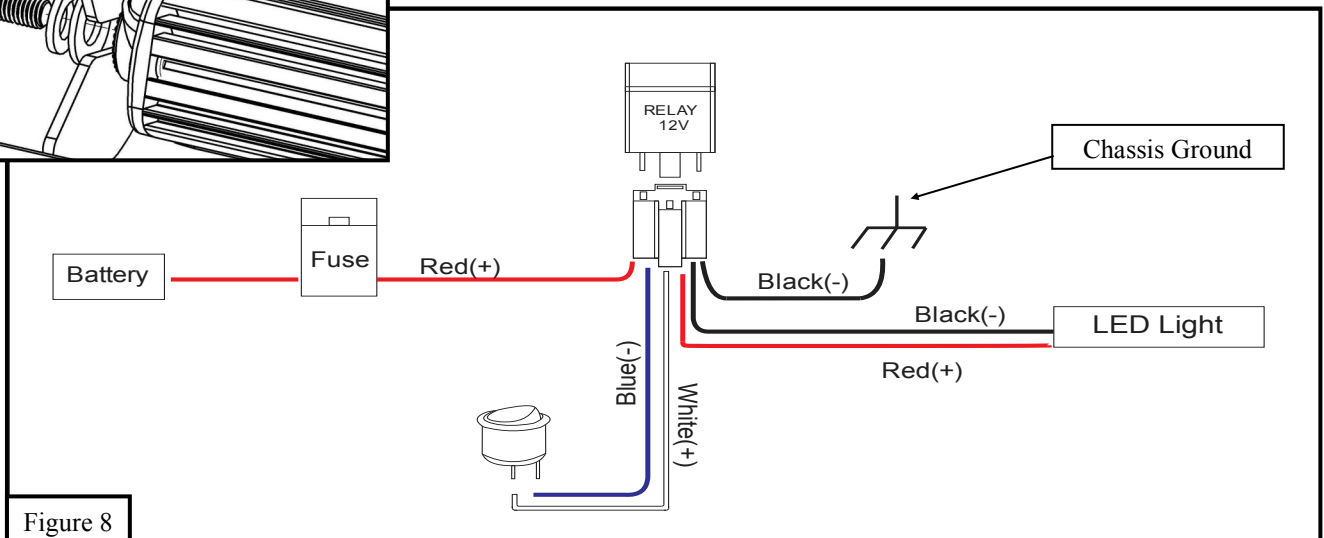

Figure 8

WESTIN

Westin Automotive Products, Inc.
320 W. Covina Blvd
San Dimas, Ca. 91773

Thank you for choosing Westin products
for additional installation assistance please call
Customer Service (800) 793-7846

www.westinautomotive.com

DATE: 8/17/17



WARNING



Failure to follow these instructions could lead to death, personal injury, and / or property damage.

FASTENERS:

All Westin supplied fasteners must be utilized and installed in accordance with the installation instructions and apply torque to the specifications as defined. **DOUBLE CHECK ALL FASTENERS BEFORE INITIAL USE, AND PERIODICALLY IN THE FUTURE TO ENSURE PROPER FUNCTION AND SAFETY.**

DRILLING:

Most Westin products do not require drilling for installation. If drilling is defined as required, use caution when drilling a vehicle. **FAILURE TO REVIEW AN AREA TO BE DRILLED MAY RESULT IN PERSONAL INJURY AND/OR INJURY TO OTHERS AS WELL AS VEHICLE DAMAGE.**

EYE PROTECTION:

ALWAYS WEAR SAFETY GLASSES OR GOGGLES DURING THE INSTALLATION PROCESS TO AVOID PERSONAL INJURY.

MAXIMUM TOWING/CARRYING CAPACITY:

The Westin Receiver Hitches will have a visible tow rating label affixed directly on the product. User should never exceed the vehicle manufacturers maximum tow and weight rating regardless of the capacity of the hitch. **FAILURE TO FOLLOW THESE GUIDELINES WILL VOID THE WESTIN WARRANTY AND MAY RESULT IN PERSONAL INJURY AND/OR INJURY TO OTHERS AS WELL AS VEHICLE DAMAGE.**