

# INSTALLATION INSTRUCTIONS



**GASOLINE TRUCKS ONLY  
R7 STEP BOARD**

**APPLICATION:**

**2007-2017 Chevy Silverado/GMC Sierra 1500/2500/3500  
Ext. / Double / Crew Cab**

**PART NUMBER:**

**28-71020, 28-71025, 28-71030, 28-71035**

ITEM	QUANTITY	DESCRIPTION	TOOLS NEEDED
1	2	STEP BAR ASSEMBLY	RATCHET
2	4	MOUNTING BRACKET A	TORQUE WRENCH
3	6	PLASTIC BRACKET COVER	10MM SOCKET
4	24	M8 HEX HEAD BOLT (BLACK ZINC) <b>COMBO HARDWARE</b>	13MM SOCKET
5	24	M8 FLAT WASHER (BLACK ZINC) <b>COMBO HARDWARE</b>	
6	24	M8 LOCK WASHER (BLACK ZINC) <b>COMBO HARDWARE</b>	
7	12	M8 U-NUT CLIP (YELLOW ZINC)	
8	10	M6 HEX HEAD BOLT (YELLOW ZINC)	
9	20	M6 FLAT WASHER (YELLOW ZINC)	
10	10	M6 NYLOCK NUT (YELLOW ZINC)	
11	1	MOUNTING BRACKET B	
12	1	MOUNTING BRACKET C	

**ANTI-SEIZE LUBRICANT MUST BE USED ON ALL STAINLESS STEEL FASTENERS TO PREVENT THREAD DAMAGE AND GALLING**

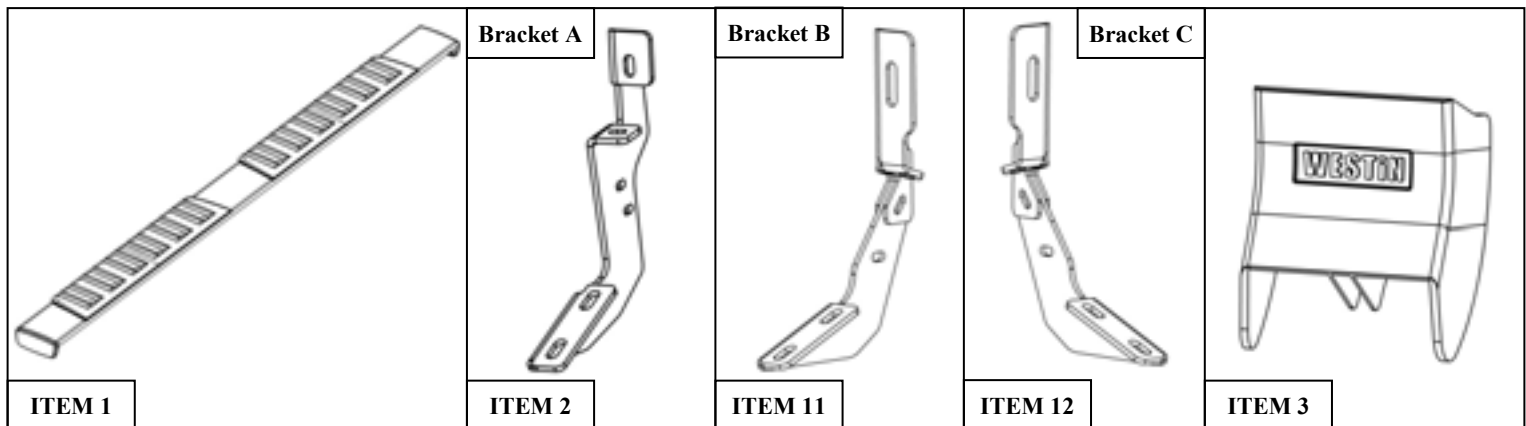

## PROCEDURE

1. Remove contents from box, verify if all parts listed are present and free from damage.  
Carefully read and understand all instructions before attempting installation.  
**Failure to identify damage before installation could lead to a rejection of any claim.**
2. Starting on the driver side, remove the rubber plugs located on the rocker panel at each mounting location. See **Figure 1**.
3. **For 1500 Crew Cab models with welded nut:** At each bracket mounting location on the pinch weld there should either be a welded factory nut or a hole. If there is a factory welded nut present then the M8 U-Nut Clip (Item 7) will not be used at that location. See **Figure 2** for the factory welded nut.

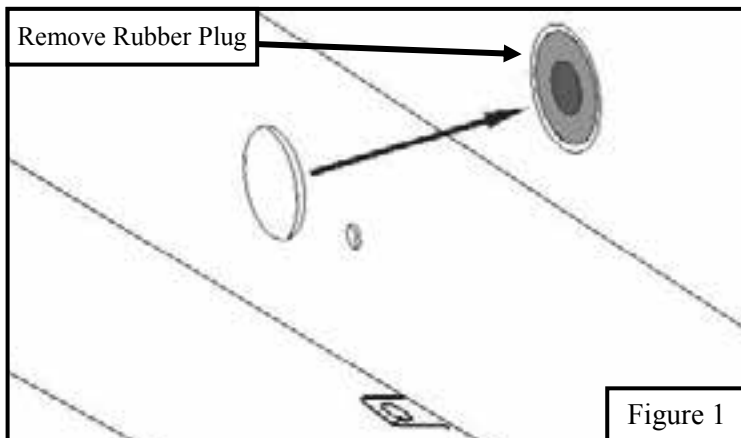

Figure 1

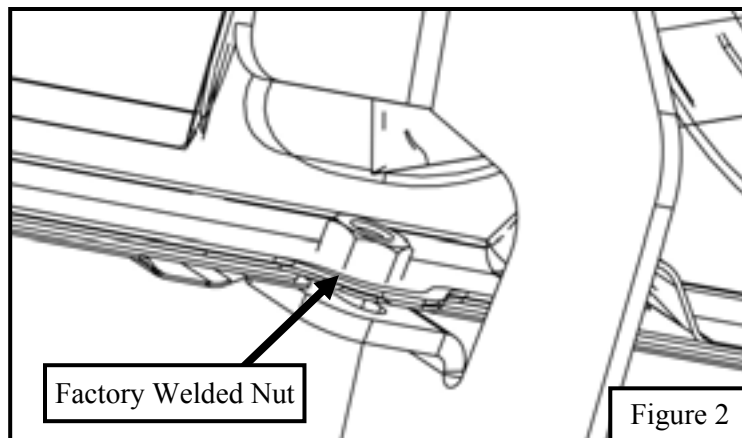

Figure 2

**See Page 5 for bracket orientation for 1500 Crew Cab models and Page 3 for the other models.**

4. Insert (1) M8 U-Nut Clip (Item 7) into the hole where the rubber plug was removed. Clip (1) M8 U-Nut Clip onto pinch weld if no factory welded nut is present. Locate (1) Mounting Bracket A (Item 2) and loosely secure it to the rocker panel using the provided hardware: (2) M8 hex head bolt, (2) M8 flat washer, and (2) M8 lock washer. See **Figure 3**.
5. Repeat **Step 4** for every other bracket mounting A location. Refer to **Page 3 or 4** for bracket mount location.
6. Locate (1) Mounting Bracket B (Item 11) and go to the front passenger side mounting location or driver/passenger rear for 1500 crew cab models. Loosely secure Mounting Bracket B to the rocker panel using (2) M8 hex head bolt, (2) M8 flat washer, (2) M8 lock washer, and (2) M8 U-Nut Clip. Repeat step for Mounting Bracket C (Item 12). See **Figure 4**.

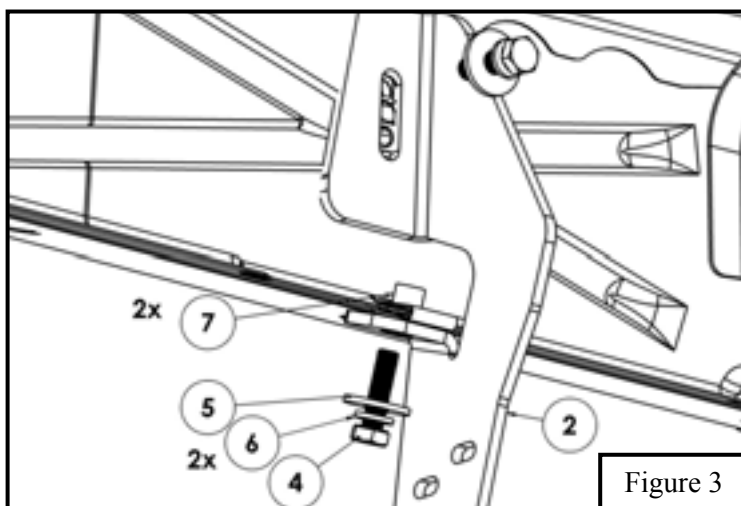
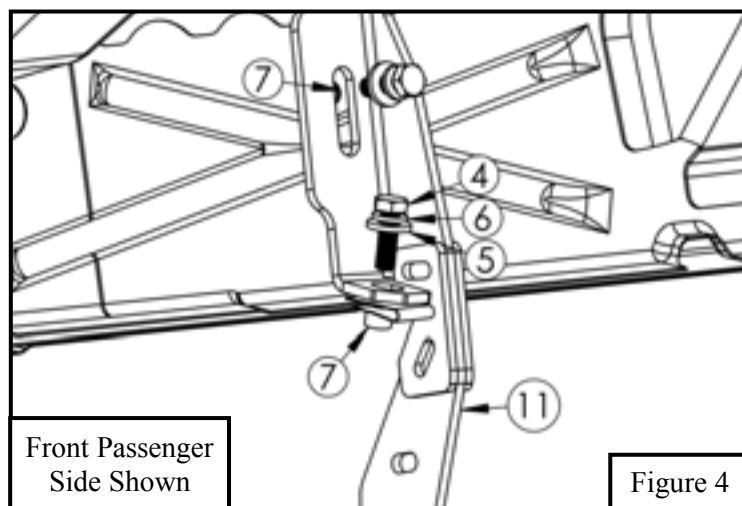

Figure 3



Front Passenger  
Side Shown

Figure 4

7. Locate (1) Plastic Bracket Cover (Item 3) and loosely secure it to the (6) brackets using the provided hardware: (2) M6 hex head bolt, (4) M6 flat washer, and (2) M6 nylon lock nut. Repeat for every bracket. See **Figure 5**.
8. Loosely install the Step Bar Assembly (Item 1) to the previously install mounting brackets with the supplied M8 hardware. See **Figure 6**.
9. Align and adjust the step bars and brackets as needed, then fully tighten all hardware: M8 to 15-18 ft-lbs, M10 30-35 ft-lbs, and M6 to 5-7 ft-lbs.

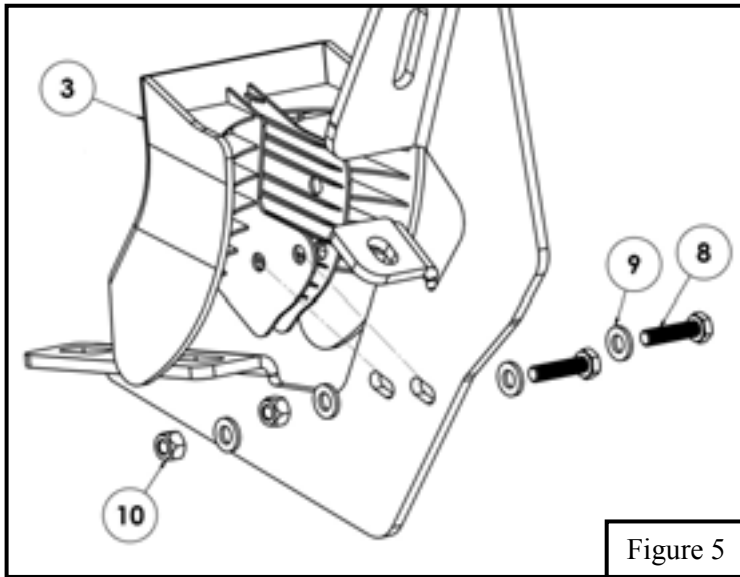

Figure 5

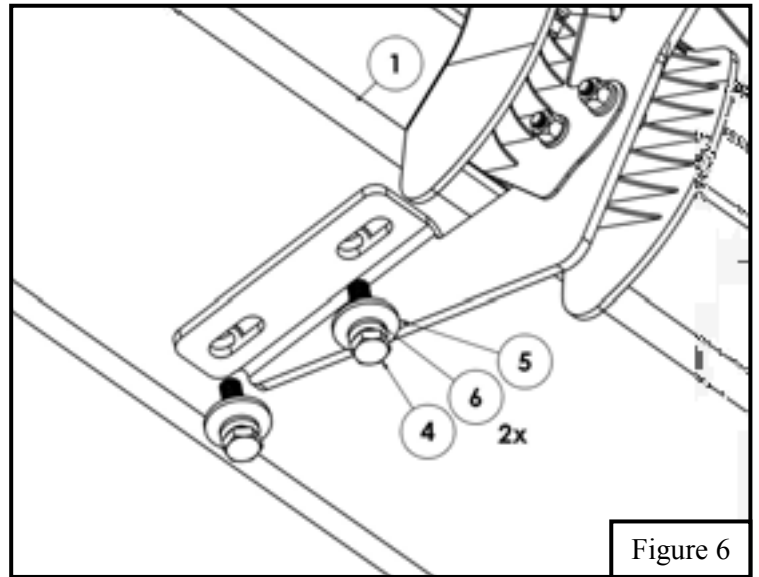
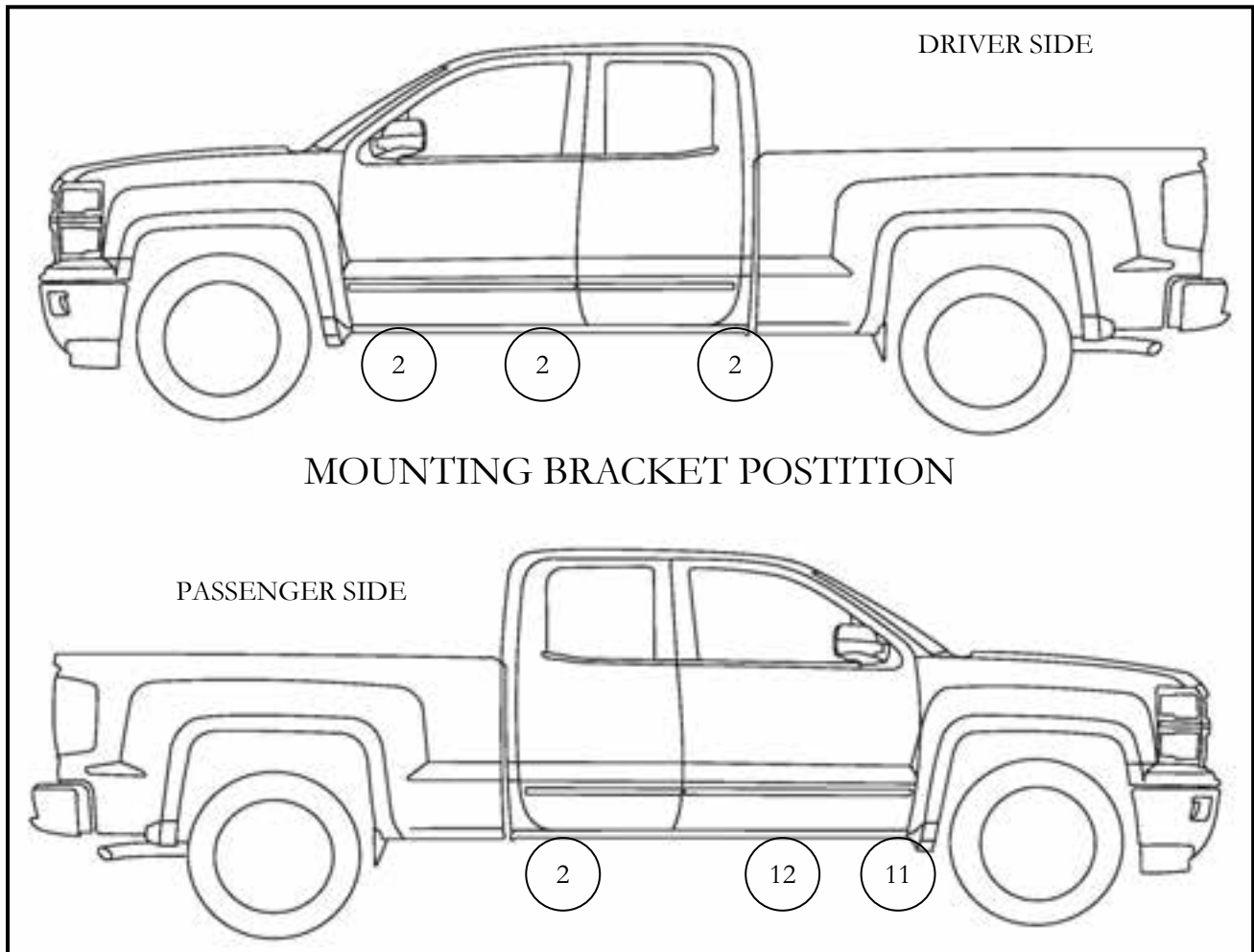
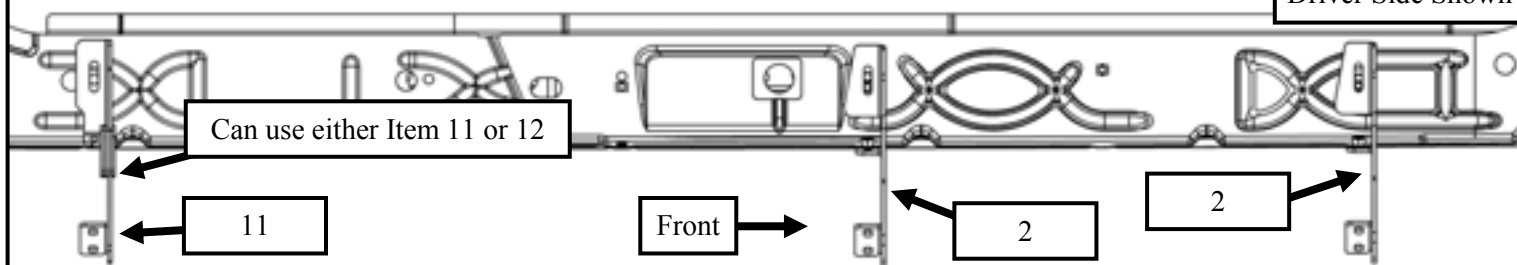

Figure 6



### Bracket Orientation for 1500 Crew Cab with welded nut

Driver Side Shown



Passenger Side Shown

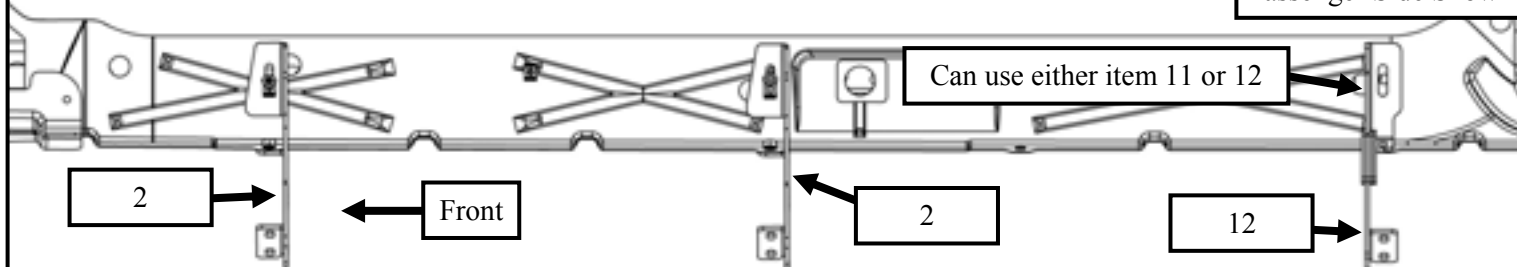

### INSTALLATION COMPLETED



#### Care Instructions

- REGULAR WAXING IS RECOMMENDED. DO NOT USE ANY TYPE OF POLISH OR WAX THAT MAY CONTAIN ABRASIVES.
- STAINLESS STEEL PRODUCTS CAN BE CLEANED WITH MILD SOAP AND WATER. STAINLESS STEEL POLISH SHOULD BE USED TO POLISH SMALL SCRATCHES.
- GLOSS BLACK FINISHES SHOULD BE CLEANED WITH MILD SOAP AND WATER.

**WESTIN**

Westin Automotive Products, Inc.  
320 W. Covina Blvd  
San Dimas, Ca. 91773

Thank you for choosing Westin products  
for additional installation assistance please call  
Customer Service (800) 793-7846  
[www.westinautomotive.com](http://www.westinautomotive.com)



## WARNING



Failure to follow these instructions could lead to death, personal injury, and / or property damage.

**FASTENERS:**

All Westin supplied fasteners must be utilized and installed in accordance with the installation instructions and apply torque to the specifications as defined. **DOUBLE CHECK ALL FASTENERS BEFORE INITIAL USE, AND PERIODICALLY IN THE FUTURE TO ENSURE PROPER FUNCTION AND SAFETY.**

**DRILLING:**

Most Westin products do not require drilling for installation. If drilling is defined as required, use caution when drilling a vehicle. **FAILURE TO REVIEW AN AREA TO BE DRILLED MAY RESULT IN PERSONAL INJURY AND/OR INJURY TO OTHERS AS WELL AS VEHICLE DAMAGE.**

**EYE PROTECTION:**

**ALWAYS WEAR SAFETY GLASSES OR GOGGLES DURING THE INSTALLATION PROCESS TO AVOID PERSONAL INJURY.**

**MAXIMUM TOWING/CARRYING CAPACITY:**

The Westin Receiver Hitches will have a visible tow rating label affixed directly on the product. User should never exceed the vehicle manufacturers maximum tow and weight rating regardless of the capacity of the hitch. **FAILURE TO FOLLOW THESE GUIDELINES WILL VOID THE WESTIN WARRANTY AND MAY RESULT IN PERSONAL INJURY AND/OR INJURY TO OTHERS AS WELL AS VEHICLE DAMAGE.**