

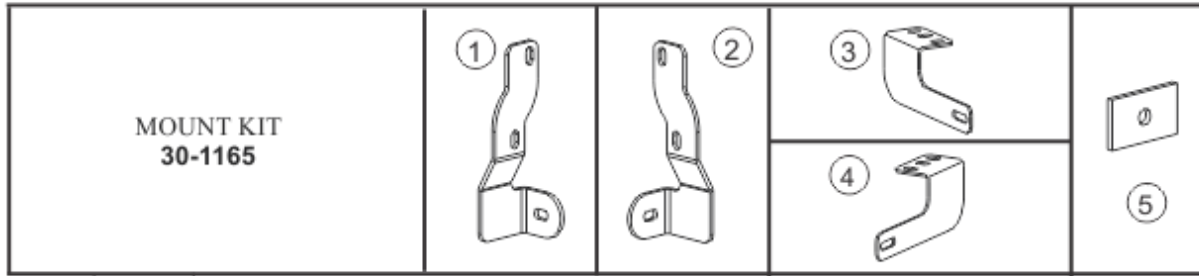

INSTRUCTIONS

APPLICATION: 2001-08 FORD RANGER/RANGER "EDGE" (EXCL. STX)
2001-12 MAZDA B-SERIES



ITEM	QTY	CONTENTS	TOOLS
1,2	2	BRACKET, PASSENGER (1) AND DRIVER (2)	3/4" SOCKET 3/4" WRENCH 9/16" SOCKET 9/16" WRENCH 1/2" SOCKET 10MM SOCKET RATCHET RATCHET EXTENSION TORQUE WRENCH
3,4	2	SUPPORT BRACE, PASSENGER (3) AND DRIVER (4)	
5	2	BACKING PLATE	
6	2	1/2-13 X 4.00" HEX HEAD BOLT	
7	2	1/2-13 X 2.00" HEX HEAD BOLT	
8	6	1/2" FLAT WASHER	
9	4	1/2" LOCK WASHER	
10	2	1/2-13 HEX NUT	
11	2	3/8-16 X 1.50" HEX HEAD BOLT	
12	4	3/8" FLAT WASHER	
13	2	3/8" LOCK WASHER	
14	2	3/8-16 HEX NUT	
15	4	5/16-18 X 1.00" SELF TAPPING SCREW	

- STEP 1.** Remove the contents from box and check for damage. Verify all parts are present. Read instructions completely before beginning.
- STEP 2.** Attach brackets to outside face of frame members with 1/2" fasteners and backing plate as shown. Leave loose. SEE FIGURES 1 AND 2.
- STEP 4.** Attach support brace using holes in bottom face of vehicle frame. SEE FIGURE 1. NOTE: If vehicle has a plastic shroud mounted to bottom of frame, remove bolts with 10mm socket and remove "push type" fasteners from shroud. Place support brace against bottom of frame, reinstall plastic shroud with factory bolts and replace "push type" fasteners with 5/16" self tapping screw. Leave loose.
- STEP 5.** Attach support bracket to mount bracket using 3/8" fasteners. SEE FIGURE 1.
- STEP 6.** Attach safari bar using 1/2" fasteners. SEE FIGURE 1-3.
- STEP 7.** Level and adjust Safari Bar as desired and tighten all fasteners. Recommended torque values are 64 Ft. Lbs. for 1/2" fasteners, 26 Ft. Lbs. for 3/8" fasteners, 10 Ft. Lbs. for 6mm fasteners, and 15 Ft. Lbs. for 5/16"

FINISH PROTECTION

Westin products have a high quality finish that must be cared for like any other exposed finish on the vehicle. Protect the finish with a non-abrasive automotive wax, (e.g. Pure Carnauba) on a regular basis. The use of any soap, polish or wax that contains an abrasive is detrimental, as the compounds scratch the finish and open it to corrosion.

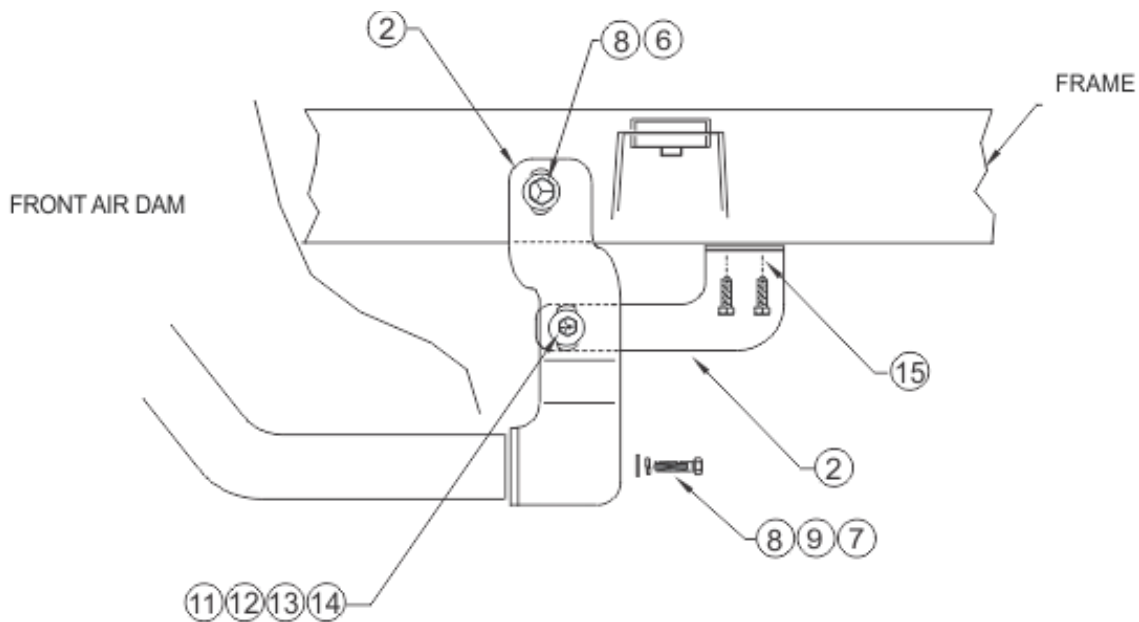

FIGURE 1 INSTALLATION VIEW OF DRIVER SIDE SHOWN

FIGURE 2 INSTALLATION VIEW OF DRIVER SIDE SHOWN

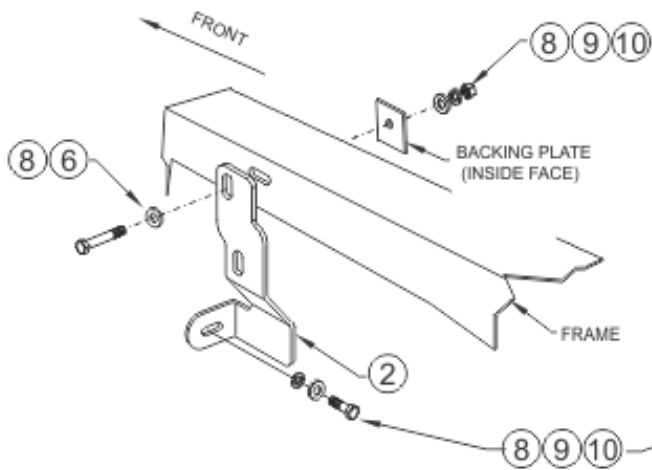
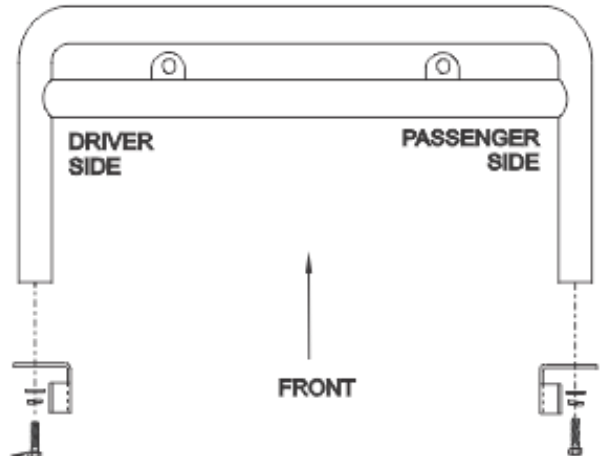

FIGURE 3 TOP VIEW



CARE INSTRUCTIONS

- REGULAR WAXING IS RECOMMENDED. DO NOT USE ANY TYPE OF POLISH OR WAX THAT MAY CONTAIN ABRASIVES.
- STAINLESS STEEL PRODUCTS CAN BE CLEANED WITH MILD SOAP AND WATER. STAINLESS STEEL POLISH SHOULD BE USED TO POLISH SMALL SCRATCHES.
- GLOSS BLACK FINISHES SHOULD BE CLEANED WITH MILD SOAP AND WATER.



Westin Automotive Products, Inc.
320 W. Covina Blvd
San Dimas, Ca. 91773

Thank you for choosing Westin products
for additional installation assistance please call
Customer Service (800) 793-7846
www.westinautomotive.com



WARNING



Failure to follow these instructions could lead to death, personal injury, and / or property damage.

Failure to follow these instructions could lead to death, personal injury, and / or property damage.

FASTENERS:

All Westin supplied fasteners must be utilized and installed in accordance with the installation instructions and apply torque to the specifications as defined. **DOUBLE CHECK ALL FASTENERS BEFORE INITIAL USE, AND PERIODICALLY IN THE FUTURE TO ENSURE PROPER FUNCTION AND SAFETY.**

DRILLING:

Most Westin products do not require drilling for installation. If drilling is defined as required, use caution when drilling a vehicle. **FAILURE TO REVIEW AN AREA TO BE DRILLED MAY RESULT IN PERSONAL INJURY AND/OR INJURY TO OTHERS AS WELL AS VEHICLE DAMAGE.**

EYE PROTECTION:

ALWAYS WEAR SAFETY GLASSES OR GOGGLES DURING THE INSTALLATION PROCESS TO AVOID PERSONAL INJURY.

MAXIMUM TOWING/CARRYING CAPACITY: (if applicable)

The Westin Receiver Hitches will have a visible tow rating label affixed directly on the product. User should never exceed the vehicle manufacturers maximum tow and weight rating regardless of the capacity of the hitch. **FAILURE TO FOLLOW THESE GUIDELINES WILL VOID THE WESTIN WARRANTY AND MAY RESULT IN PERSONAL INJURY AND/OR INJURY TO OTHERS AS WELL AS VEHICLE DAMAGE.**

FOR CALIFORNIA RESIDENTS ONLY-PROP 65 WARNING:

Some products may contain chemicals such as DEHP, which can cause cancer, birth defects or other reproductive harm. For more info go to www.p65warnings.ca.gov



Westin Automotive Products, Inc.
320 W. Covina Blvd
San Dimas, Ca. 91773