



INSTALLATION INSTRUCTIONS

APPLICATION: 1998-2000 CHEVROLET S10\BLAZER
 1998-2000 GMC SONOMA\JIMMY\ENVOY
 1998-2000 OLDSMOBILE BRAVADA

AUTOMOTIVE PRODUCTS, INC.

SPORTSMAN
ASSEMBLIES

40-0365
40-0665

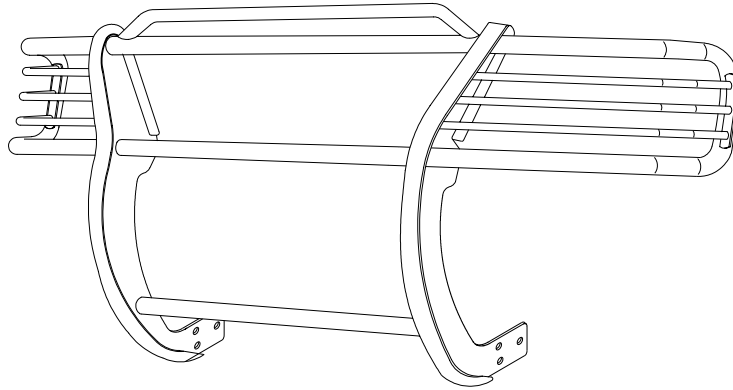

| QTY | PARTS KIT CONTENTS | | TOOLS REQUIRED |
|-----|-----------------------------------|--|------------------|
| | DESCRIPTION | | |
| 1 | SPORTSMAN ASSEMBLY W/LIGHT GUARDS | | 3/4" SOCKET |
| 1 | MOUNT BRACKET - DRIVER | | 3/4" WRENCH |
| 1 | MOUNT BRACKET - PASSENGER | | 15MM SOCKET |
| 2 | TOP BRACKET | | 17 MM SOCKET |
| 2 | SPACER TUBE | | 9/16" WRENCH |
| 6 | 1/2-13 X 1.50" HEX HEAD BOLT | | 9/16" SOCKET |
| 14 | 1/2" FLAT WASHER | | RATCHET |
| 6 | 1/2" LOCK WASHER | | TORQUE WRENCH |
| 6 | 1/2-13 HEX NUT | | SOCKET EXTENSION |
| 2 | 3/8-16 X 1.00" HEX HEAD BOLT | | |
| 4 | 3/8" FLAT WASHER | | |
| 2 | 3/8" LOCK WASHER | | |
| 2 | 3/8-16 HEX NUT | | |
| 2 | M10- 1.5 X 50MM HEX HEAD BOLT | | |
| 4 | M10- 1.5 X 30MM HEX HEAD BOLT | | |
| 6 | 10MM FLAT WASHER | | |
| 6 | 10MM LOCK WASHER | | |

- STEP 1. Remove the contents from the box and check for any damage. Verify all parts against the parts list.
- STEP 2. Read and understand instructions completely before beginning installation.
- STEP 3. Remove 10mm bolts from bumper brace located on back side of front body mount if present.
- STEP 4. For each side, place Mount Bracket up to the backside of the body mount and secure using existing 10mm bolts removed in step 3. (On trucks without existing bolts, use the 10mm hardware provided in the bolt kit). (Fig 1).
- STEP 5. Remove the front grille from the truck. On Chevy Blazer and S10 models, the grille is held in with (9) nine metal clips and the turn signals are attached to the grille. On GMC Sonoma and Jimmy and the Oldsmobile Bravada, the grille is retained with (7) seven metal clips, and only the center of the grille is removed. When removing the grille from the truck, pull firmly on the grille until the metal clips release. Work from the passen-

ger side, move to the center and finish with the driver side. (Fig 2).

- STEP 6. To install Top Brackets, remove the (2) two 10mm factory bumper bolts from the top of the frame, located behind the topside of bumper. Replace on each side with Spacer Tube, Top Mount Bracket, 10mm Flat Washer, 10mm Lock Washer, and M10- 1.5 X 50mm Hex Head Bolt. (See note below). On Chevrolet models except the ZR2, the short end of the Top Mount Bracket should be facing down, and on the Chevrolet ZR2, GMC and Oldsmobile models the short end of the Top Mount Bracket should be facing up. (Fig 3).
- Note:** On some models it is necessary to use a 1/2" flat washer for a spacer rather than the Spacer Tube supplied so that the bracket will just clear the top of the bumper. If this is applicable, use the factory bumper bolts.
- STEP 7. Place cardboard under front of vehicle. Lay Sportsman on the cardboard with front side down. Slide the Sportsman back until the rearmost holes align with the rearmost slot on each bracket. Attach Sportsman to the Mount Brackets at rear holes on each side with the 1/2" hardware provided.
- STEP 8. Carefully rotate Sportsman up toward vehicle until remaining slots are aligned. Insert remaining 1/2" fasteners in bottom brackets and tighten hand tight. Fasten Sportsman to Top Brackets using the 3/8" hardware provided and tighten hand tight.
- STEP 9. Level and adjust Sportsman on vehicle and then torque the 10mm fasteners (Mount Bracket to frame locations only) to 35 Ft. Lbs.
- STEP 10. Remove the Sportsman from the vehicle opposite Step 8. Replace vehicle grille in opposite order of removal and re-connect wire connectors and bulb housings if applicable.
- STEP 11. Re-attach Sportsman to vehicle and torque fasteners to:
1/2" fasteners. 60 Ft. Lbs.

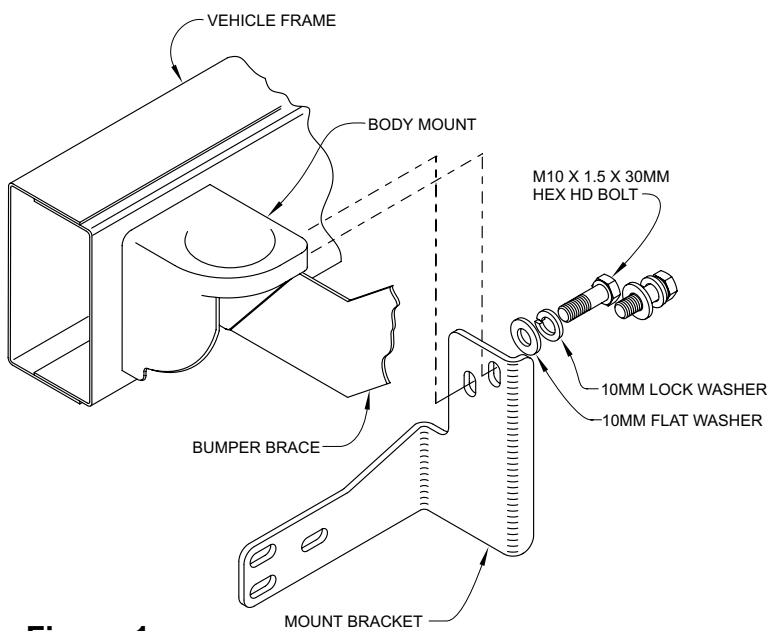

Figure 1
MOUNT BRACKET INSTALLATION
DRIVER SIDE SHOWN - PASSENGER OPPOSITE

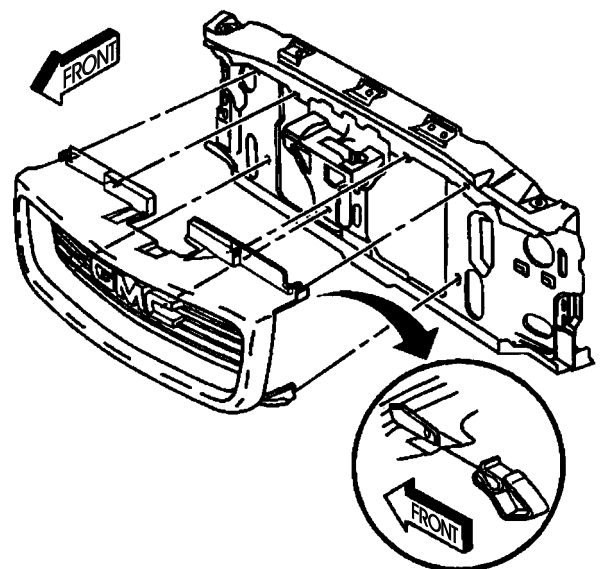

Figure 2
GRILLE REMOVAL

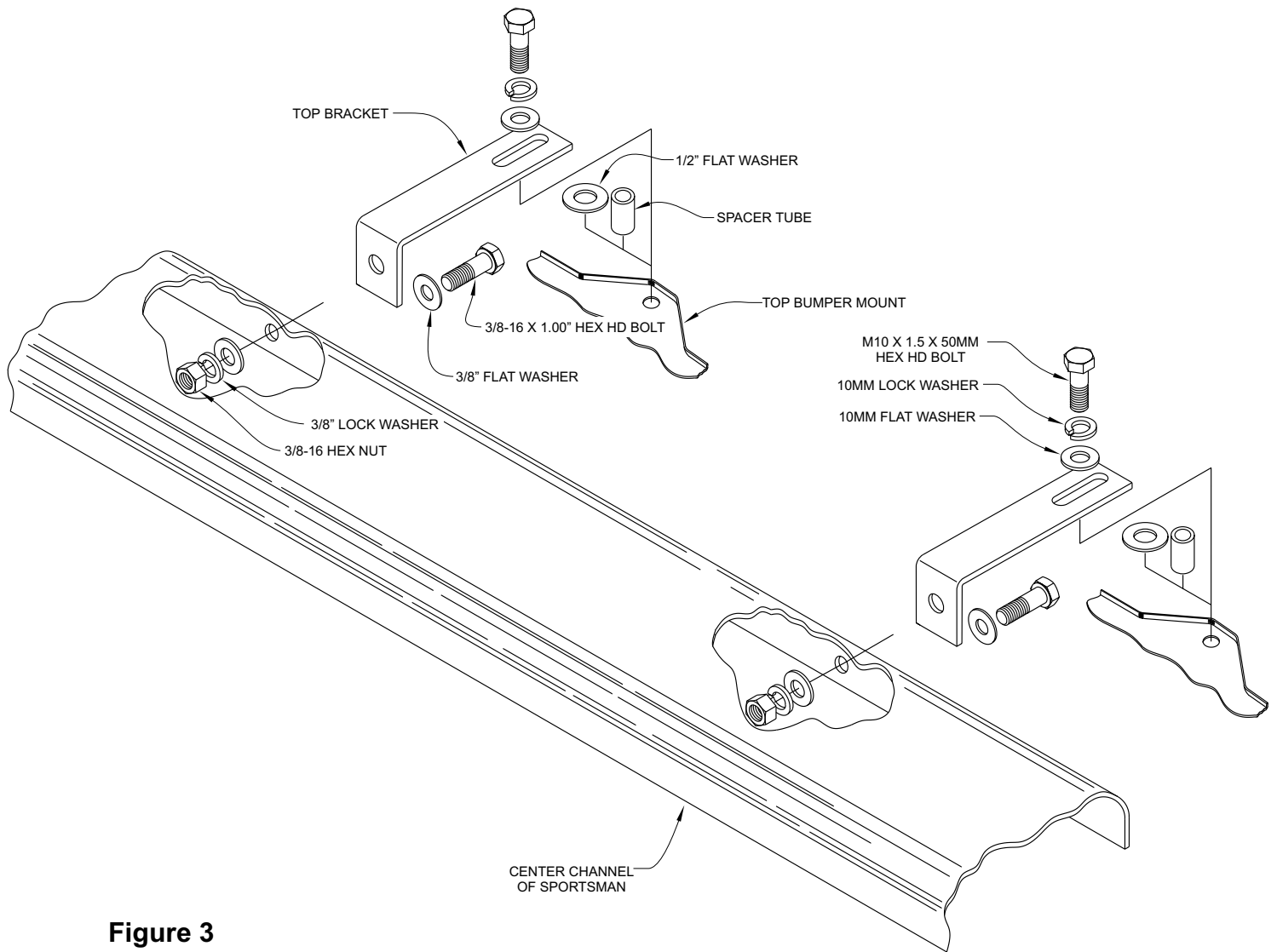

Figure 3
TOP BRACKET INSTALLATION

Finish protection - Westin products have a high quality finish that must be cared for like any other exposed finish on the vehicle. Protect the finish with a non-abrasive automotive wax (pure carnauba, for example) on a regular basis. The use of cleaner wax or any compound which contains an abrasive is detrimental, as the compound scratches the finish and opens it to corrosion.