



INSTALLATION INSTRUCTIONS

APPLICATION: 1999-01 GMC SIERRA 2500 SERIES
2/4 WHEEL DRIVE

AUTOMOTIVE PRODUCTS, INC.

SPORTSMAN
ASSEMBLY
40-0465

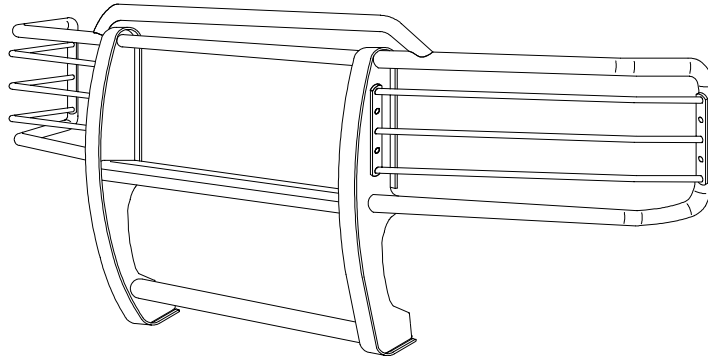

QTY	PARTS KIT CONTENTS DESCRIPTION	TOOLS REQUIRED
1	SPORTSMAN ASSEMBLY WITH LIGHT GUARDS	9/16" WRENCH
2	TOP BRACKET	9/16" SOCKET
2	BOTTOM BRACKET	3/4" SOCKET
8	1/2 -13 X 1.50" HEX HEAD BOLT, GRADE 5	18MM SOCKET
4	3/8 -16 X 1.25" HEX HEAD BOLT	10MM SOCKET
8	3/8" FLAT WASHER, ZINC PLATED	RATCHET
4	3/8" LOCK WASHER, ZINC PLATED	TORQUE WRENCH
4	3/8 -16 HEX NUT, ZINC PLATED	PHILLIPS SCREWDRIVER
2	M12-1.75 X 90 MM FULLY THREADED HEX HEAD BOLTS	SMALL FLAT SCREWDRIVER
12	1/2" FLAT WASHERS	19MM SOCKET
4	1/2" LOCK WASHERS	SOCKET EXTENSION
2	SPACER TUBE	UTILITY KNIFE
2	1/2 -13 HEX NUT	
2	SPACER PLATE	

- STEP 1. Remove the contents from the box and check for any damage. Verify all parts against the parts list.
Note: Some fasteners will be left over after installation.
- STEP 2. Read and understand instructions completely before beginning installation.
- STEP 3. Remove plastic shroud above grille by removing the seven pin retainers. Pull center pin up with small flat screwdriver. **See Figure 1.**
- STEP 4. Remove grille from truck by removing 6mm bolt from top of grille. Turn the four retainers 1/4 turn counter-clockwise with Phillips screwdriver. Pull on outer edge of grille by applying firm pressure away from the fender, repeat on the opposite side. Carefully remove grille from vehicle. **See Figures 1.**
- STEP 5. To install top brackets, remove both 12mm factory bumper bolts from top of frame (located behind the top side of bumper). On each side, replace with spacer tube, top mount bracket, 1/2" flat washer, 1/2" lock washer, and 12mm x 1.75 x 90mm bolt, finger tighten 12mm and 6mm bolts. **See Figure 3.**
- STEP 6. To install bottom brackets, remove 12mm tow hook bolts and tow hooks. Switch tow hooks by placing the driver side tow hook on the passenger side. Reinstall bolts and tighten. **Note:** Tow hooks should face inside of vehicle. **See Figure 3.**
- STEP 7. Models with driving lights or tow hooks, slide bottom bracket into frame and attach using 1/2-13 bolt, 1/2" lock washer, 1/2" flat washer, and spacer plate.

Note: On models without tow hooks or driving lights, an opening must be cut out in the two inside indents of the air dam using a utility knife. **See Figure 2.**

- STEP 8. Raise the Sportsman up to the brackets and attach using the 3/8" hardware and hand tighten. Adjust Sportsman to center of truck and torque all fasteners at the frame locations only to: 1/2" fasteners = 65 FT. LBS; 12mm fasteners = 60 FT. LBS; 6mm fasteners = 10 FT. LBS.
- STEP 9. Remove Sportsman from brackets and reinstall vehicle grille and plastic shroud in the opposite order of removal.
- STEP 10. Re-attach Sportsman to brackets and tighten the 3/8" bolts to 30 FT. LBS.

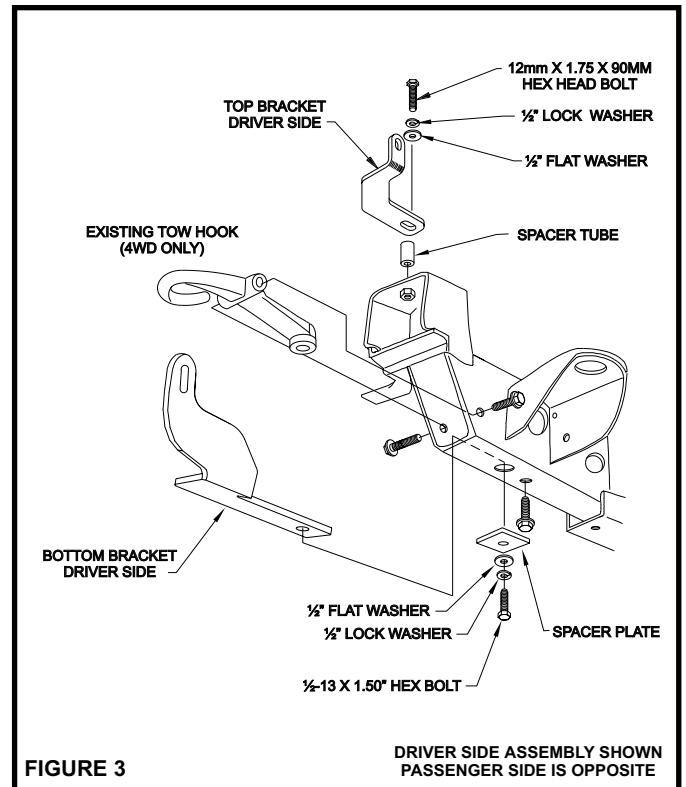
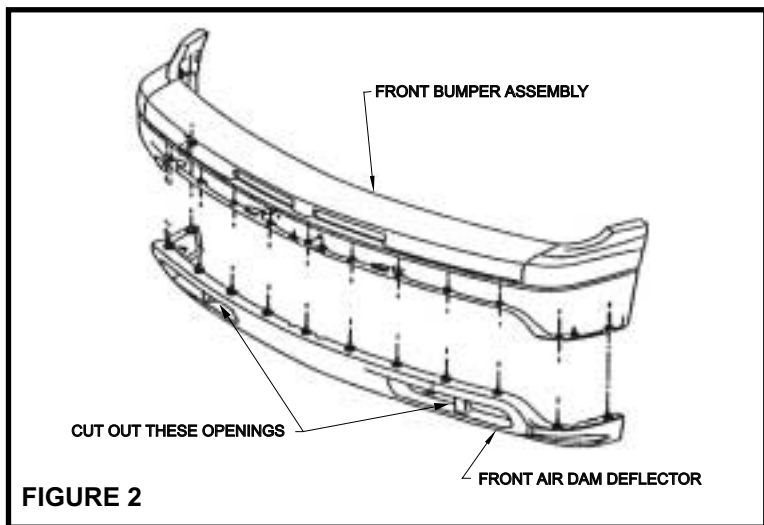
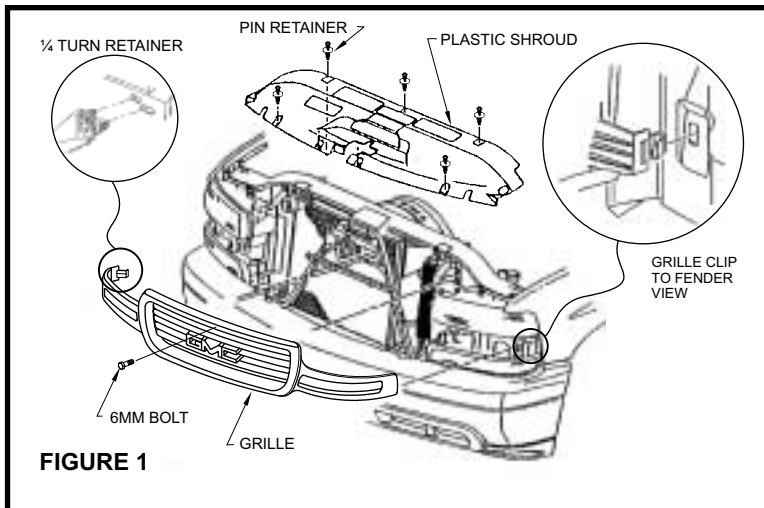

Finish protection - Westin products have a high quality finish that must be cared for like any other exposed finish on the vehicle. Protect the finish with a non-abrasive automotive wax (pure carnauba, for example) on a regular basis. The use of cleaner wax or any compound which contains an abrasive is detrimental, as the compound will scratch the finish and open it to corrosion.