

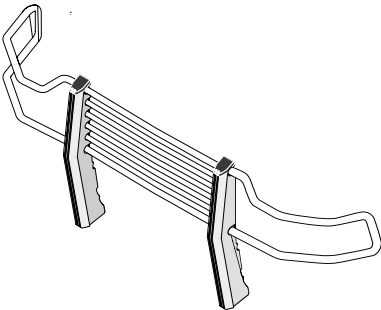

# INSTALLATION INSTRUCTIONS

APPLICATION: 1994-2000 DODGE RAM

## AUTOMOTIVE PRODUCTS, INC.

| <p>CLASSIC<br/>GRILLE GUARD<br/>ASSEMBLY</p> <p><b>35-1100</b><br/><b>35-1105</b><br/><b>35-1110</b></p>               |    |  |
|--|--|--|
| QTY  | PARTS KIT CONTENTS<br>DESCRIPTION  | TOOLS REQUIRED   |
| <p>1</p> <p>1</p> <p>1</p> <p>1</p> <p>1</p> <p>2</p> <p>2</p> <p>1</p> <p>2</p> <p>10</p> <p>4</p> <p>20</p> <p>6</p> | <p>UPRIGHT - PASSENGER SIDE</p> <p>UPRIGHT - DRIVER SIDE</p> <p>WING - PASSENGER SIDE</p> <p>WING - DRIVER SIDE</p> <p>CENTER SECTION</p> <p>TOP BUMPER CLAMP</p> <p>TOP UPRIGHT CLAMP</p> <p>BOTTOM FRAME BRACKET</p> <p>BOTTOM UPRIGHT CLAMP</p> <p>1/2-13 X 1.25" HEX HEAD BOLT</p> <p>1/2-13 X 1.50" HEX HEAD BOLT</p> <p>1/2" SAE FLAT WASHER</p> <p>1/2-13 HEX LOCK NUTS</p> | <p>3/4" SOCKET</p> <p>3/4" WRENCH</p> <p>RATCHET</p> <p>TORQUE WRENCH</p> <p>T30 TORX WRENCH</p> |

- Step 1. Remove the contents from the box and check for any damage. Verify all parts against the parts list.
- Step 2. Read and understand instructions completely before beginning installation.
- Step 3. Insert wings into Center Section so that the wing slots line up with the center section holes. Attach Uprights to this Center Section assembly using (4) 1/2-13 X 1.25" Hex Head Bolts and Flat Washers. **Hand tighten.**
- Step 4. Attach Top Upright Clamps to uprights in location shown using 1/2-13 X 1.25" Hex Head Bolt and Flat Washers. Torque to 65 Ft. Lbs. Hook Top Bumper Clamps onto back edge of bumper.
- Step 5. Position Grille Guard up to bumper and bolt Top Upright Clamp to Top Bumper Clamp with (2) 1/2-13 X 1.50" Hex Head Bolts, (4) Flat washers and (2) 1/2-13 Hex Nuts. **Hand tighten.**
- Step 6 Bolt Bottom Frame Bracket to vehicle cross member as shown in Figure 1 with (2) 1/2-13 X 1.25" Hex Head Bolts; (4) Flat washers and (2) 1/2-13 Hex Nuts. Bolt Bottom Upright Clamp to upright using (2) 1/2-13 X 1.25" Hex Head Bolts and (2) Flat Washers. **Note:** On vehicles equipped with an air dam, insert the Bottom Upright Clamp between the air dam and bumper from the rear of bumper. Bolt Upright Clamp to Frame Bracket using (2) 1/2-13 X

1.

50" Hex Head Bolts, (4) Flat washers and (2) 1/2-13 Hex Nuts. Leave Loose.

Step 7. Adjust Grille Guard so it is centered and level and torque all hardware to 65 ft. Lbs.

**Note:** Due to variations of bumper locations, it is necessary to adjust bumper location up or down to allow

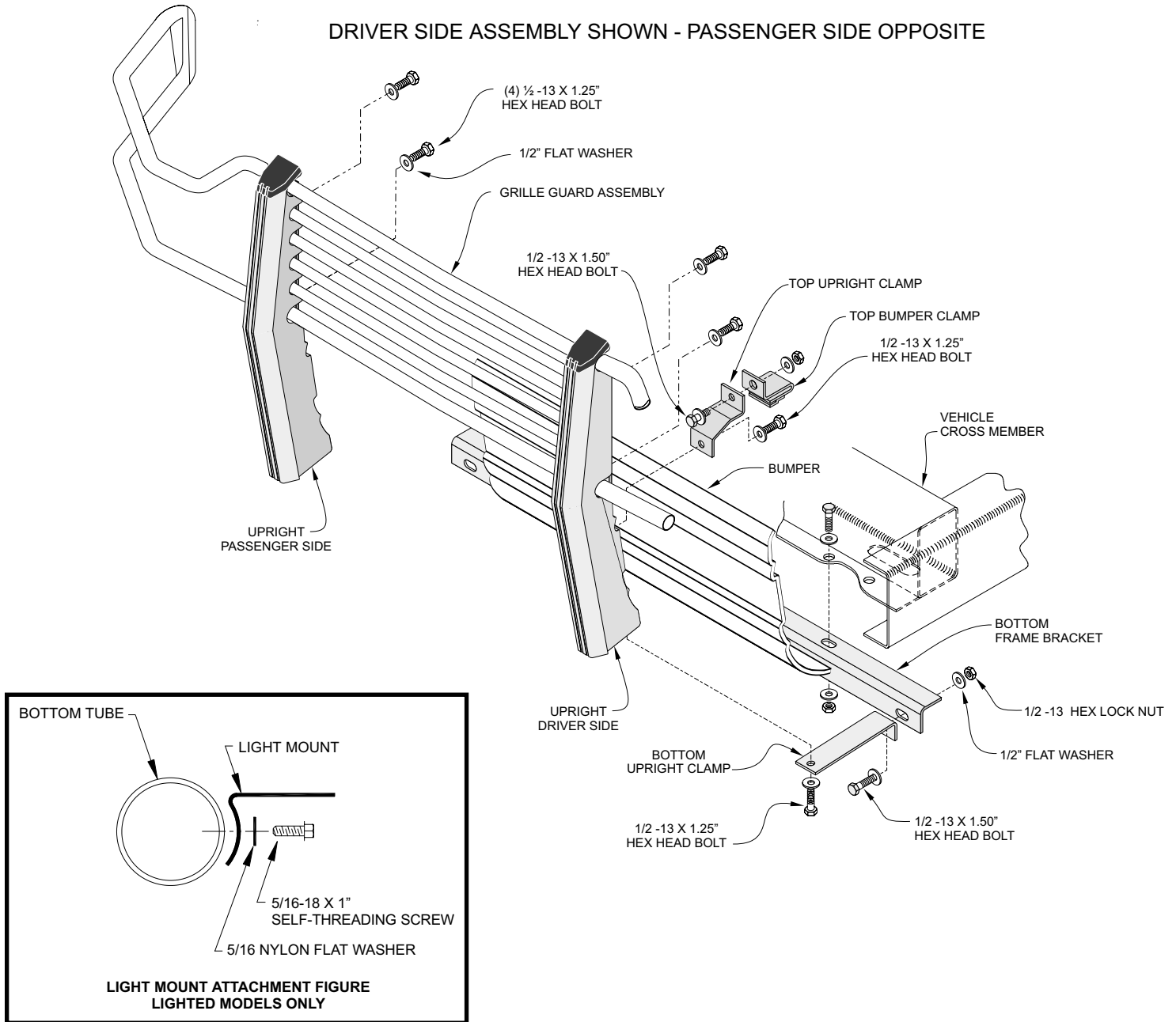

Finish protection - Westin products have a high quality finish that must be cared for like any other exposed finish on the vehicle. Protect the finish with a non-abrasive automotive wax (pure carnauba, for example) on a regular basis. The use of cleaner wax or any compound which contains an abrasive is detrimental, as the compounds scratch the finish and open it to corrosion.



Westin Automotive Products, Inc.  
5200 N. Irwindale Ave. Suite 220  
Irwindale, Ca. 91706

Thank You for choosing Westin products  
For additional installation assistance please call  
Customer service (800) 793-7846 or (507)-375-3559