



INSTALLATION INSTRUCTIONS

APPLICATION: 1998-UP NISSAN FRONTIER
2000-UP NISSAN XTERRA

AUTOMOTIVE PRODUCTS, INC.

<p>SAFARI BAR ASSEMBLY</p> <p>30-0010/30-0015 30-0020/30-0025</p> <p>MOUNT KIT:</p> <p>30-1285</p>	
---	--

QTY	PARTS KIT CONTENTS DESCRIPTION	TOOLS REQUIRED
1	SAFARI BAR ASSEMBLY (PURCHASED SEPARATELY)	3/4" SOCKET 17MM SOCKET RATCHET TORQUE WRENCH 17MM WRENCH
1	MOUNT BRACKET - DRIVER SIDE	
1	MOUNT BRACKET - PASSENGER SIDE	
2	1/2-13 X 2.00" HEX HEAD BOLT	
2	1/2" FLAT WASHER	
2	1/2" LOCK WASHER	

- STEP 1. Remove the contents from the box and check for any damage. Verify all parts against the parts list.
NOTE: 30-0020/30-0025 Safari Bar assembly used for 01-UP Nissan Frontier and 30-0010/30-0015 Safari Bar assembly used for 2000-UP Nissan Xterra and 1998-00 Nissan Frontier.
- STEP 2. Read and understand instructions completely before beginning installation.
- STEP 3. Determine Driver and Passenger Mount Brackets. (SEE FIGURE 1)
- STEP 4. Remove the (2) 10mm bolts from the outside of vehicle frame that attach the bumper to the frame.
NOTE: If vehicle is equipped with an optional tow hook, it must also be removed.
- STEP 5. Position appropriate Safari Bar Mount Bracket between the frame and the existing bumper bracket where bolts were removed and reinstall bolts. Tighten hand tight. Repeat for opposite side of vehicle. (SEE FIGURE 1)
- STEP 6. Attach Safari Bar to Mount Brackets using the 1/2" fasteners. Tighten hand tight.
- STEP 7. Center and level the Safari Bar. Tighten and torque fasteners to:
- 1/2" fasteners 65 Ft. Lbs.
 - 10mm fasteners 35 Ft. Lbs.

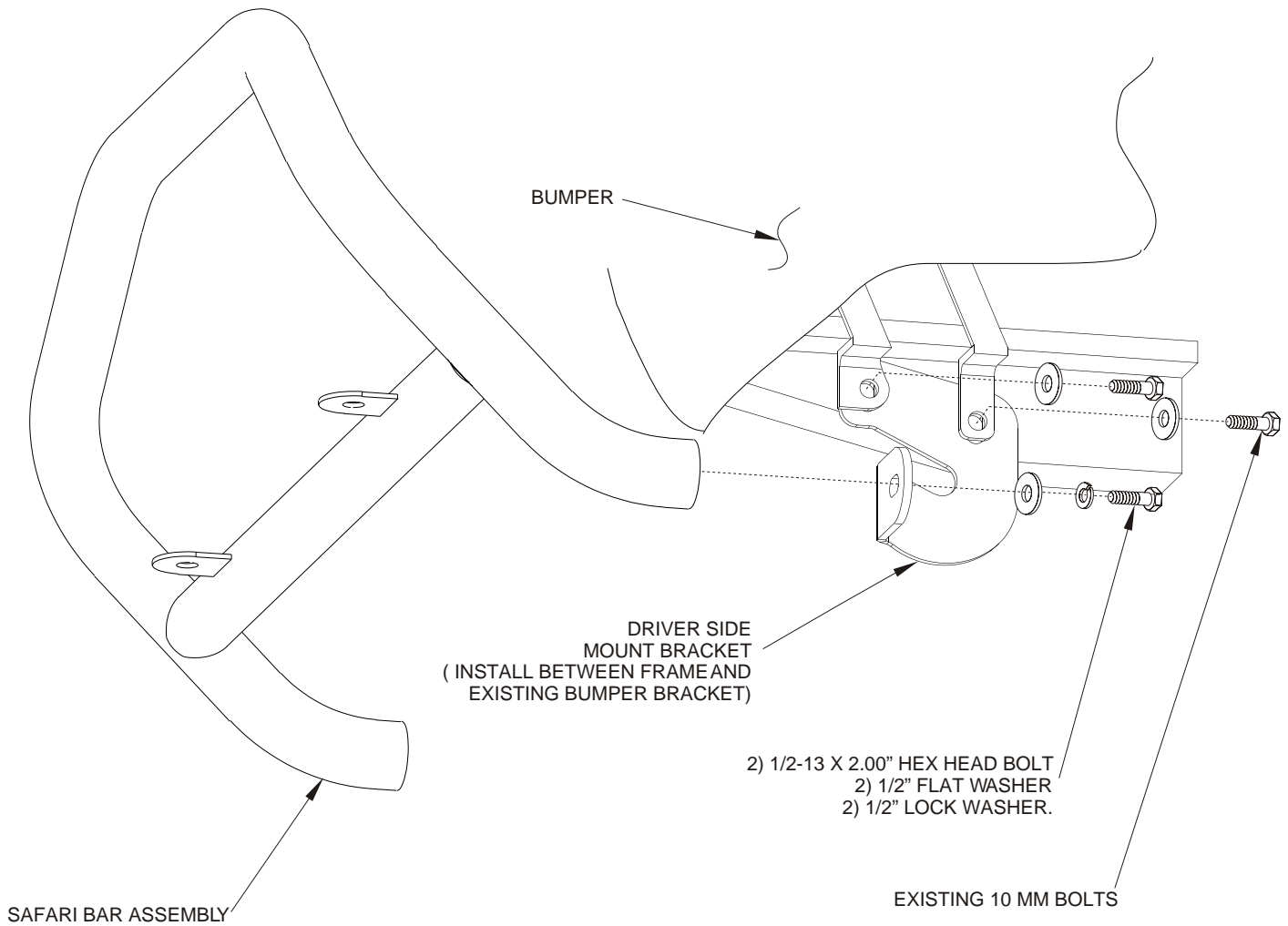

FIGURE 1
INSTALLATION OF DRIVER SIDE

Finish protection - Westin products have a high quality finish that must be cared for like any other exposed finish on the vehicle. Protect the finish with a non-abrasive automotive wax (pure carnauba, for example) on a regular basis. The use of cleaner wax or any compound which contains an abrasive is detrimental, as the compounds scratch the finish and open it to corrosion.



Westin Automotive Products, Inc.
5200 N. Irwindale Ave. Suite 220
Irwindale, Ca. 91706

Thank You for choosing Westin products
For additional installation assistance please call
Customer service (800) 793-7846 or (507) 375-3559