



INSTALLATION INSTRUCTIONS

APPLICATION: 2003-UP SILVERADO 1500/1500HD, 2500/2500 HD,
3500 HD 2/4 WHEEL DRIVE

AUTOMOTIVE PRODUCTS, INC.

SPORTSMAN
ASSEMBLY

41-1175
41-1245
44-1170
44-1240

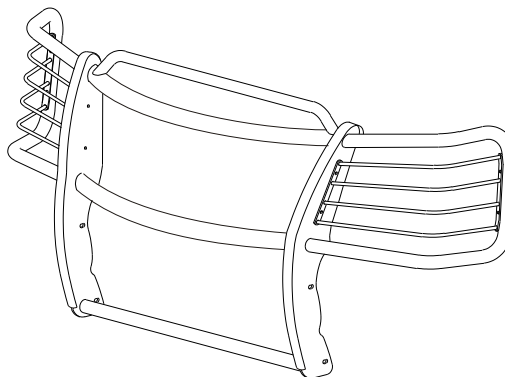

PARTS KIT CONTENTS

QTY	DESCRIPTION	QTY	DESCRIPTION
2	UPRIGHTS	24	3/8" FLAT WASHER, SS
2	WING ASSEMBLY W/ LIGHT GUARDS	4	3/8" LOCK WASHER, SS
1	TOP TUBE/ HOOD BAR ASSEMBLY	4	3/8-16" HEX NUT, SS
1	BOTTOM TUBE	4	3/8-16 X 1.25" HEX HEAD BOLT, SS
1	CENTER TUBE	8	3/8-16" NYLOCK NUT, SS
2	LIGHT MOUNTS	10	3/8-16 X 1.00" BUTTON HEAD CAP SCREW
2	TOP BRACKET	2	3/8-16 X 1.25" BUTTON HEAD CAP SCREW, SS
2	BOTTOM BRACKET 1500 NON HD	2	3/8" INTERNAL TOOTH LOCK WASHER
2	BOTTOM BRACKET 1500HD, 2500LD, 2500/3500HD	2	M12 X 40MM HEX BOLT
8	1/2" FLAT WASHER	2	M12 HEX NUT
2	1/2 -13 HEX NUT	2	BOLT PLATE
2	1/2 -13 X 2.00" HEX HEAD BOLT	4	2 3/4" OD PLASTIC WASHER
4	1/2 -13 X 1.50" FLAT HEAD BOLT, SS	2	1 5/8" OD PLASTIC WASHER
6	1/2" LOCK WASHER	8	1.00" OD PLASTIC WASHER

TOOLS REQUIRED

9/16" WRENCH
18MM SOCKET
SOCKET EXTENSION
7/32 ALLEN WRENCH

9/16" SOCKET
TORQUE WRENCH
RATCHET

15MM SOCKET
19MM SOCKET
5/16 ALLEN WRENCH

- STEP 1. Remove the contents from the box and check for any damage. Verify all parts against the parts list.
- STEP 2. Read and understand instructions completely before beginning installation.
- NOTE: This kit contains lower mounting brackets for both 1500, 1500 HD and 2500/3500 HD models. Make sure you identify and use the proper brackets for your installation. One set of lower brackets will not be used.
- STEP 3. FOR 1500 NON H.D.: From underneath the vehicle on the driver side, locate the tow hook mounting bolt on the bottom side of frame. Remove bolt and install bracket with factory bolt. SEE FIGURE 1. On vehicles without tow hooks, slide bolt plate in from the end of the frame rail and allow bolt to protrude through hole closest to end of frame. Install bracket. SEE FIGURE 1. Leave fasteners loose. Repeat for passenger side.
- STEP 4. FOR 1500HD/2500LD, 2500/3500 HD: From underneath the vehicle on the driver side, remove the tow hook bolt on the outside of the frame. Slide bolt plate in through the end of frame rail and allow bolt to drop through the large hole closest to the end of the frame. SEE FIGURE 2. Place bottom mount bracket up to bottom of frame and secure to bolt plate with flat washer, lock washer and hex nut. Replace factory tow hook bolt with

12mm bolt provided. If vehicle does not have tow hooks, use the 12mm x 40mm bolts and fasteners provided to secure mount bracket to the side of the frame. Leave loose. Repeat for passenger side.

- STEP 5. From the front of vehicle, locate the top bumper mounting bolt. This can be seen by looking through the bumper cut outs in the front of the bumper opening. Use factory bumper bolt to secure bracket. SEE FIGURE 1. Leave loose. Repeat for opposite side.
- STEP 6. Determine passenger and driver side uprights, hood bar/top tube assembly, center tube and bottom tube. (Uprights are positioned so raised side of bolt holes are facing each other.) SEE FIGURE 3.
- STEP 7. Fasten uprights to hood bar/top tube assembly, center tube and bottom tube using (4) 1/2-13 x 1.50" stainless steel flat head bolts, (4) 2.75" plastic washers, (2) 3/8-16 x 1.00" stainless steel button head cap screws, (2) 3/8" stainless steel internal tooth lock washer and (2) 1.625" plastic washers. Level tubes and torque 1/2" fasteners to 60 FT. LBS . and 3/8" fasteners to 30 FT. LBS.
- STEP 8. Determine passenger and driver wing assemblies. Install driver side wing assembly using (4) 3/8-16 x 1.00" stainless steel button head cap screws, (8) 3/8" stainless steel flat washers, (4) 3/8-16" stainless steel nylock nuts and 1.00" plastic washers. Tighten and torque to 35 FT. LBS. Repeat for opposite side.
- STEP 9. Place Sportsman up to vehicle and secure mount brackets to Sportsman uprights using the provided 3/8" fasteners. Level and adjust Sportsman, tighten and torque all fasteners as follows: 3/8" fasteners to 30 FT. LBS; 10mm fasteners (bumper mounting bolts) to 37 FT. LBS; 12mm fasteners (tow hook bolts)to 60 FT. LBS and 1/2" fasteners to 65 FT. LBS.

Finish protection - Westin products have a high quality finish that must be cared for like any other exposed finish on the vehicle. Protect the finish with a non-abrasive automotive wax (pure carnauba, for example) on a regular basis. The use of cleaner wax or any compound which contains an abrasive is detrimental, as the compounds scratch the finish and open it to corrosion.



Westin Automotive Products, Inc.
5200 N. Irwindale Ave. Suite 220
Irwindale, Ca. 91706

Thank You for choosing Westin products
For additional installation assistance please call
Customer service (800) 793-7846 or (507) 375-3559

**DRIVER SIDE SHOWN PASSENGER SIDE OPPOSITE.
INSTALLATION OF TOP BRACKET IS THE SAME FOR ALL MODELS.**

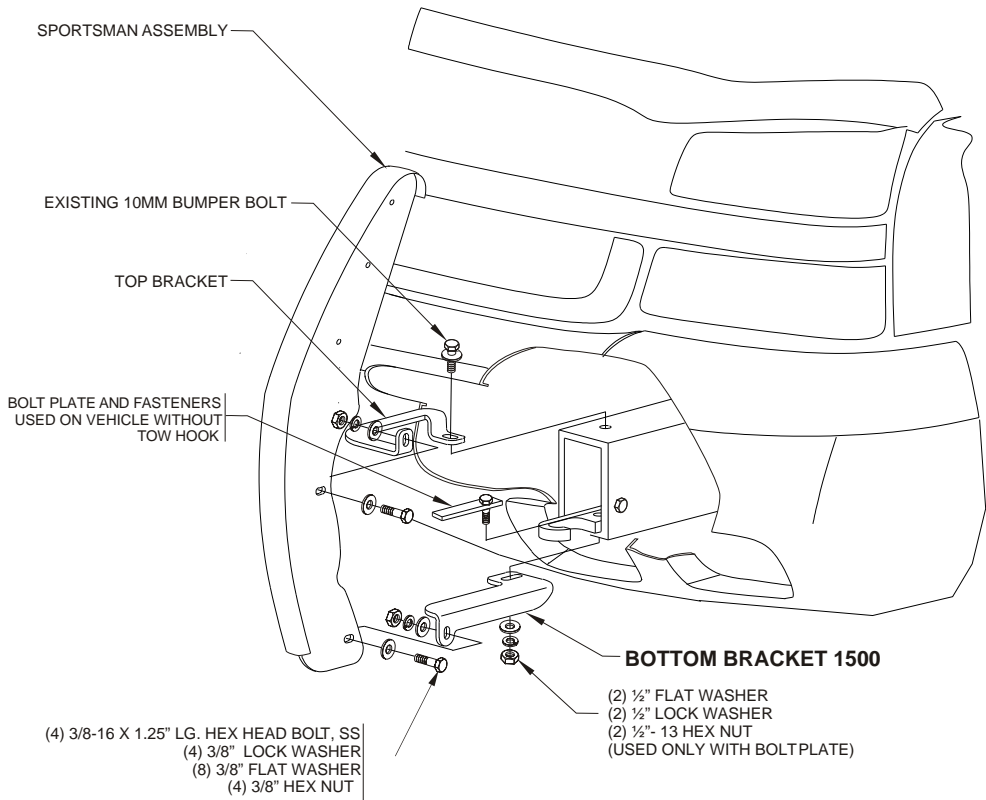

FIGURE 1

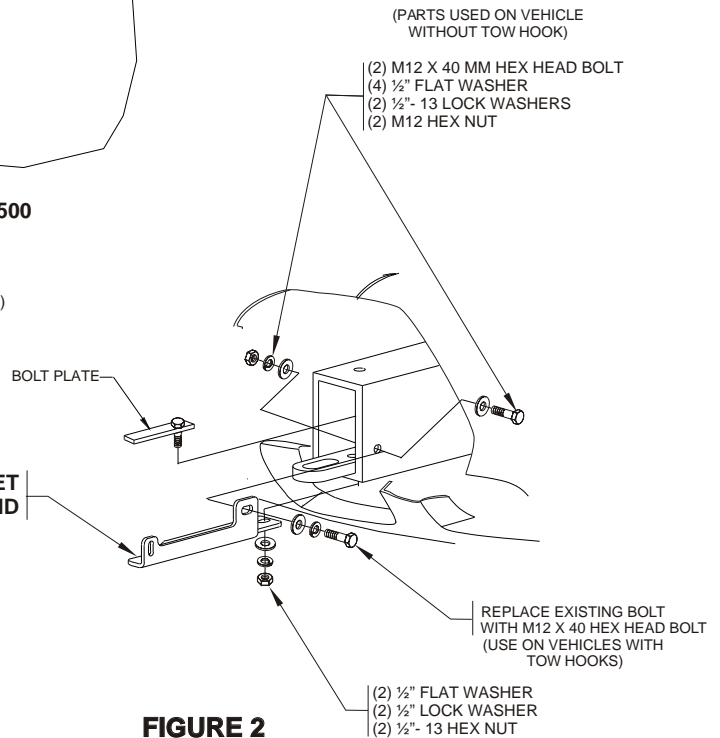

FIGURE 2

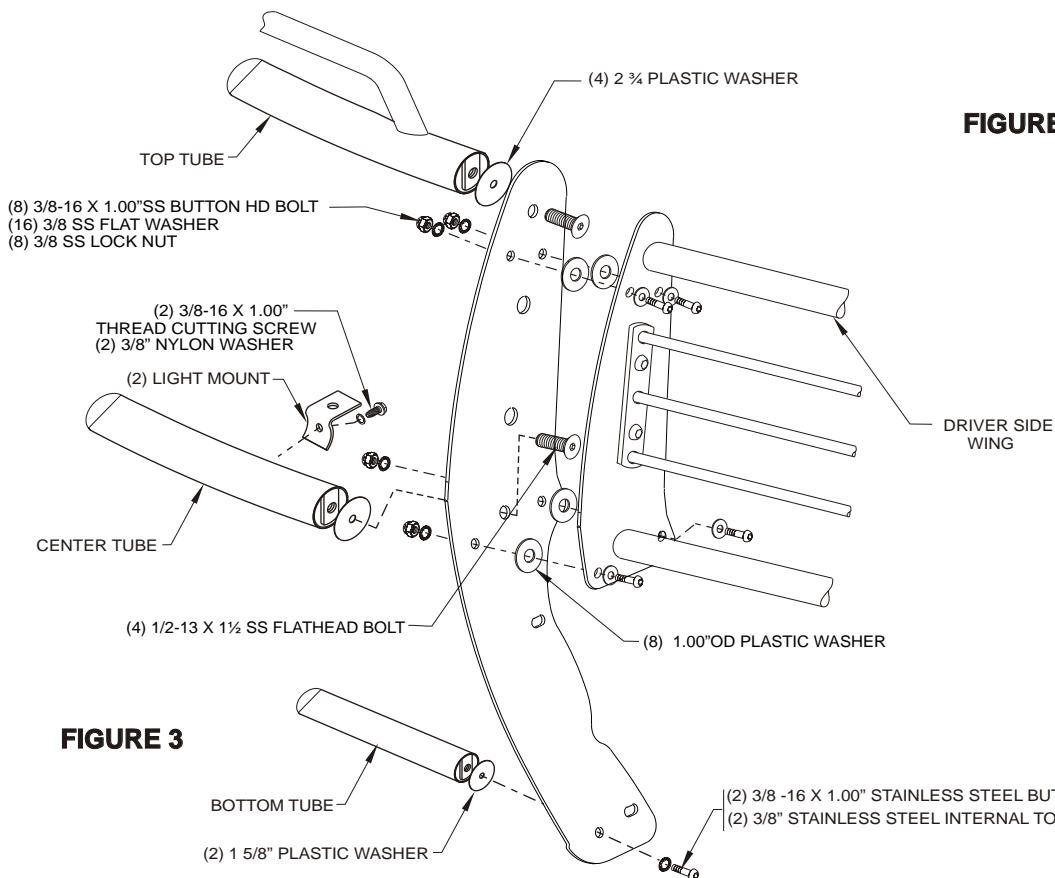

FIGURE 3