



# INSTALLATION INSTRUCTIONS

APPLICATION: 2002-UP HONDA CRV

## AUTOMOTIVE PRODUCTS, INC.

SAFARI BAR ASSEMBLY  <b>30-0020</b> <b>30-0025</b>  MOUNT KIT:  <b>30-1235</b>	
---	--

QTY	PARTS KIT CONTENTS DESCRIPTION	TOOLS REQUIRED
1	SAFARI BAR ASSEMBLY (PURCHASED SEPARATELY)	10MM SOCKET
1	MOUNT BRACKET, PASSENGER	17MM SOCKET
1	MOUNT BRACKET, DRIVER	1/2" SOCKET
1	MOUNT BRACE, PASSENGER	1/2" WRENCH
1	MOUNT BRACE, DRIVER	3/4" SOCKET
2	1/2-13 X 2.00" HEX HEAD BOLT	3/4" WRENCH
6	1/2" SPLIT LOCK WASHER	RATCHET
6	1/2" SAE FLAT WASHER	TORQUE WRENCH
4	1/2-13 X 1.00" HEX HEAD BOLT	SMALL FLAT TIP SCREWDRIVER
4	1/2-13 HEX NUT	UTILITY KNIFE
2	M14 FLAT WASHER	
2	M14 SPLIT LOCK WASHER	
2	M10 PUSH TYPE RETAINER	
4	1/2" EXTERNAL-INTERNAL TOOTH LOCK WASHER	
2	5/16-18 X 1.75" HEX HEAD BOLT	
2	5/16" SAE FLAT WASHER	
2	5/16" SPLIT LOCK WASHER	
2	5/16-18 FLANGE LOCK NUT	

NOTE: FASTENERS ARE CONTAINED IN BOLT KIT 60-1238.

- STEP 1. Remove the contents from the box and check for any damage. Verify all parts against the parts list.
- STEP 2. Read and understand instructions completely before beginning installation.
- STEP 3. Determine passenger and driver mount brackets from figure above.
- STEP 4. Remove the (16) push type retainers and (2) 6mm bolts from the lower splash shield. Remove plastic splash shield to gain access to mounting locations.
- STEP 5. Locate the (4) 14mm holes in the lower radiator support. Attach the mount brackets using the (4) 1/2-13 x 1.00" hex head bolts, (4) 1/2" external-internal tooth lock washer, (4) 1/2" flat washer, (4) 1/2" lock washer, (4) 1/2-14 hex nuts, (2) 5/16-18 x 1.75" hex head bolts, (2) 5/16" lock washer, (2) 5/16" flat washers and (2) 5/16-18 flange lock nuts. Leave loose.
- CAUTION: Wheels must be supported to support sub-frame to the unibody to avoid misalignment for re-attachment.
- STEP 6. Install mount braces one side at a time. Remove the 14mm under carriage bolt and attach the mount brace using the existing 14mm bolt and supplied (1) 14mm lock washer and (1) 14mm flat washer per side. SEE FIGURE 1.

- STEP 7. Repeat for opposite side.
- STEP 8. Temporarily attach Safari Bar using the supplied (2) 1/2-13 x 2.00" hex head bolts, (2) 1/2" lock washer and (2) 1/2" flat washer. Center and level. Hand tighten Safari Bar bolts. Tighten and torque mount brackets bolts only, leave 14mm mount brace bolts hand tight, and remove Safari Bar only.
- STEP 9. Cut the plastic splash shield to accommodate the mount brackets and attachment of the Safari Bar. See cutting instructions for guidelines on cutting.
- STEP 10. Re-install the splash shield, 6mm bolts and all push type retainers.
- STEP 11. Re-attach Safari Bar using 1/2" fasteners previously removed. Center, level and torque fasteners to specifications below.

### TORQUE SPECIFICATIONS

14mm fasteners to 136 FT. LBS

5/16" fasteners to 15 FT. LB

1/2" fasteners to 65 FT. LBS.

NOTE: 14mm fastener can be tightened through existing hole in splash shield.

### CUTTING INSTRUCTIONS - (Recommendation only, sizes are approximate)

The template works best if placed on the bottom side of the splash shield (the side away from the vehicle). Locate two oval slots that measure 3/8" x 1 1/16". Cut out templates and slot reference (leave slot reference attached to cut template) and place over the appropriate slots. Hold in place using masking tape. Position splash shield in place and verify templates are in correct location. Move if necessary. Drill 1/4" holes at the corners. Cut the splash shield from drilled hole to drilled hole. It may be necessary to use a straight edge to ensure a straight cut. Additional trimming may be required when splash shield is reinstalled.

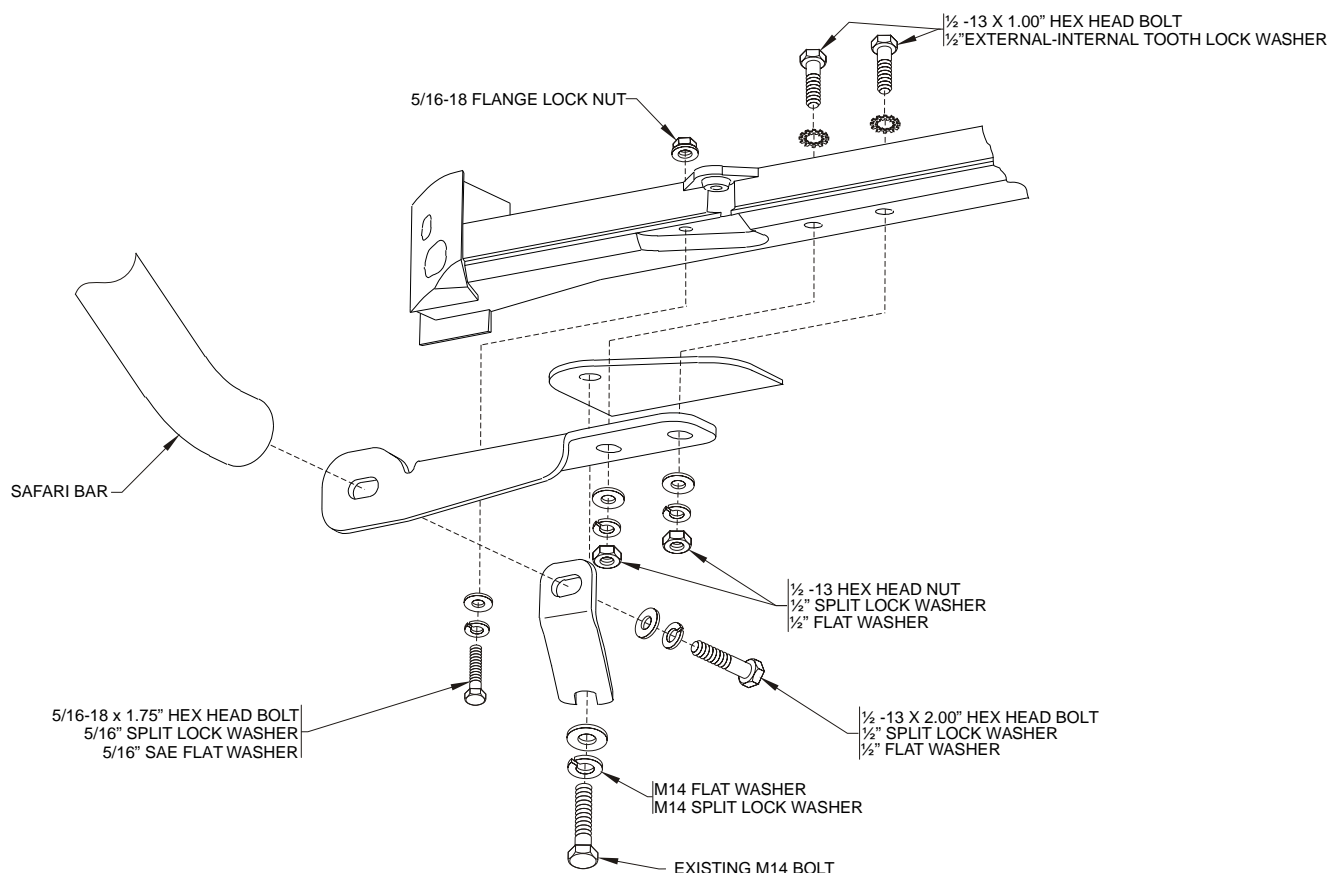

Finish protection - Westin products have a high quality finish that must be cared for like any other exposed finish on the vehicle. Protect the finish with a non-abrasive automotive wax (pure carnauba, for example) on a regular basis. The use of cleaner wax or any compound which contains an abrasive is detrimental, as the compounds scratch the finish and open it to corrosion.



Westin Automotive Products, Inc.  
5200 N. Irwindale Ave. Suite 220  
Irwindale, Ca. 91706

Thank You for choosing Westin products  
For additional installation assistance please call  
Customer service (800) 793-7846 or (507)-375-3559



Driver Side

← Front of vehicle

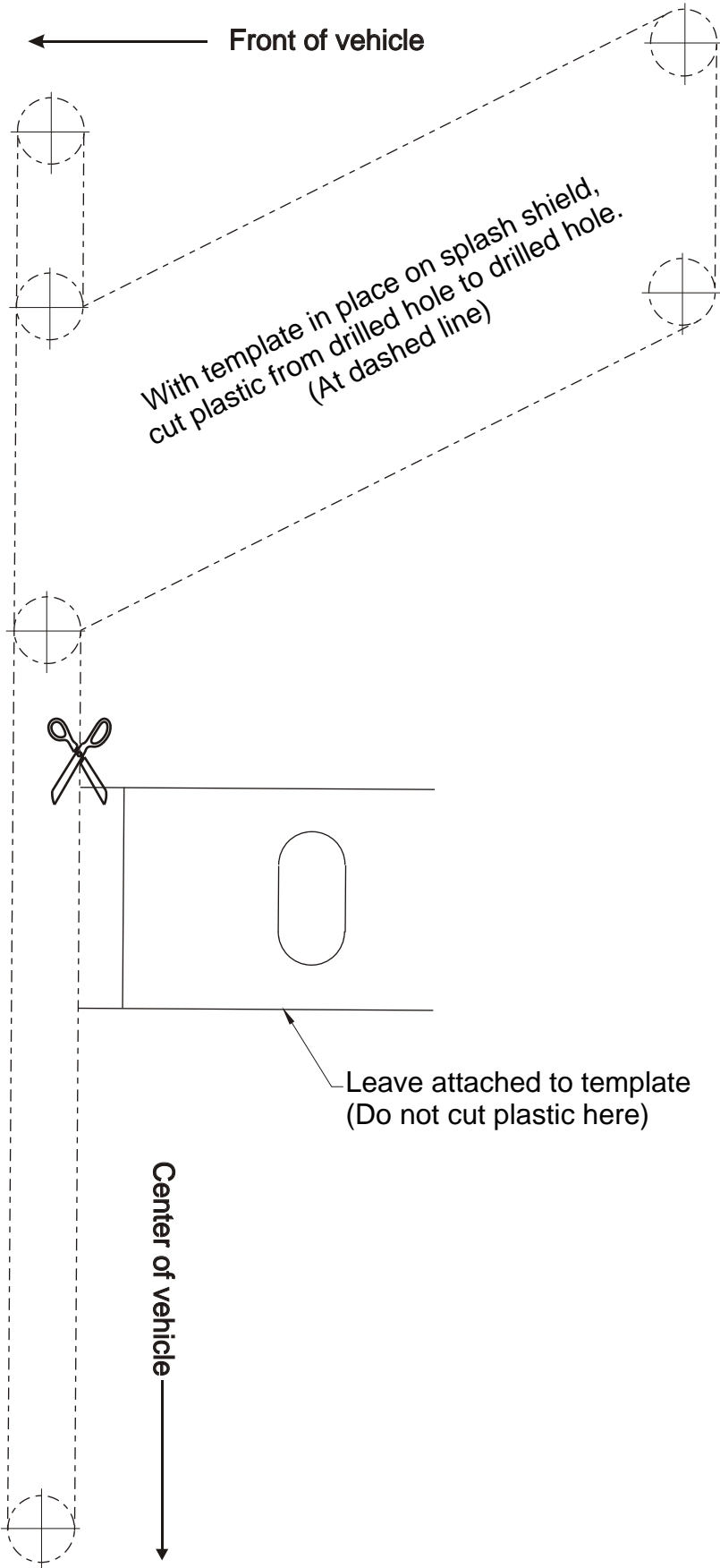

With template in place on splash shield,  
cut plastic from drilled hole.  
(At dashed line)

Leave attached to template  
(Do not cut plastic here)

Center of vehicle

