



INSTALLATION INSTRUCTIONS

APPLICATION: 1999-UP CHEVROLET SILVERADO 2500 LD 2/4 WD
 2000-UP CHEVROLET SUBURBAN 2500 2/4 WD
 2001-UP CHEVROLET SILVERADO 1500 HD CREW CAB 2/4 WD

AUTOMOTIVE PRODUCTS, INC.

SPORTSMAN
ASSEMBLY

41-0475
44-0470

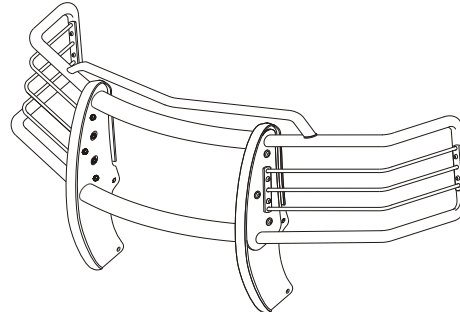

PARTS KIT CONTENTS

QTY	DESCRIPTION	QTY	DESCRIPTION
2	WING MOUNT ASSEMBLY	8	1/2-13 X 1.50" HEX HEAD BOLT
2	LIGHT GUARD ASSEMBLY	12	1/2" FLAT WASHER
1	HOOD BAR	2	M12-1.75 X 90MM HEX HEAD BOLT
1	TOP TUBE	4	3/8-16 X 1.25 HEX HEAD BOLT
1	CENTER TUBE	16	3/8" SS FLAT WASHER
2	UPRIGHT	4	3/8" SPLIT LOCK WASHER
2	TOP MOUNT BRACKET	4	1/2" SPLIT LOCK WASHER
2	BOTTOM MOUNT BRACKET	2	1/2-13 HEX NUT
2	SPACER TUBE	4	3/8-16 HEX NUT
2	HOOD BAR GROMMET	4	1/2-13 X 1.50" SS FLAT HEAD BOLT
2	HOOD BAR GASKET	4	2.72" OD PLASTIC WASHER
2	SPACER PLATE	8	3/8-16 SS NYLON INSERT LOCK NUT
10	3/8-16 X 1.00" SS BUTTON HEAD CAP SCREW	2	3/8" SS INTERNAL TOOTH LOCK WASHER
2	1.625" PLASTIC WASHER	8	1.00" PLASTIC WASHER
2	LIGHT MOUNT	2	3/8" NYLON WASHER
2	3/8-16 X 1.00 THREAD CUTTING SCREW	8	3/8" FLAT WASHER

FASTENERS ARE CONTAINED IN BOLT KITS
60-1132, 60-1158, 60-1223

NOTE: NOT ALL FASTENERS MAY BE USED.

TOOLS REQUIRED

9/16" WRENCH	9/16" SOCKET	3/4" SOCKET	5/16" HEX WRENCH
19MM SOCKET	10MM SOCKET	18MM SOCKET	RATCHET
7/32" HEX WRENCH	PHILLIPS SCREWDRIVER	UTILITY KNIFE	
SOCKET EXTENSION	TORQUE WRENCH	SMALL FLAT SCREWDRIVER	

- STEP 1. Remove the contents from the box and check for any damage. Verify all parts against parts list.
- STEP 2. Read and understand instructions completely before beginning installation.
- STEP 3. Determine passenger and driver uprights, top and center tubes. (Uprights are positioned so raised side of bolt holes are facing each other). SEE FIGURE 2.
- STEP 4. Fasten uprights to top and center tubes using (4) 1/2-13 x 1.50" SS flathead bolts and (2) 2.72" OD plastic washers. Level tubes and torque to 60 FT. LBS.
- STEP 5. Fasten light mounts to center tube using (2) 3/8-16 x 1.00" thread cutting screw and (2) 3/8" nylon washers. Tighten and torque to 20 FT. LBS. SEE FIGURE 2.

- STEP 6. Remove plastic shroud above grille by removing the seven pin retainers. Pull center pin up with small flat screwdriver. SEE FIGURE 1.
- STEP 7. Remove grille from truck by removing 6MM bolt from top of grille. Turn the four retainers 1/4 turn counter-clockwise with Phillips screwdriver. Pull on outer edge of grille by applying firm pressure away from the fender. Repeat on the opposite side. Carefully remove grille from vehicle. SEE FIGURE 1.
- STEP 8. To install top brackets, remove both 12MM factory bumper bolts from top of frame(located behind the top side of bumper). On each side, replace with spacer tube, top mount bracket, 1/2" flat washer, 1/2" lock washer and M12-1.75 x 90MM bolt. Finger tighten 12MM bolts. SEE FIGURE 3.
- STEP 9. To install bottom brackets, remove 12MM tow hook bolts and tow hooks. Switch tow hooks by placing the driver side tow hook on the passenger side. Reinstall bolts and tighten. NOTE: Tow hooks should face inside of vehicle. SEE FIGURE 3.
- STEP 10. Models with driving lights or tow hooks, slide bottom bracket into frame and attach using 1/2"-13 bolt, 1/2" lock washer, 1/2" flat washer and spacer plate. NOTE: On models without tow hooks or driving lights, an opening must be cut out in the two inside indents of the air dam using a utility knife. SEE FIGURE 4.
- STEP 11. Raise the Center Section up to the brackets and attach using 3/8-16 X 1.25" hex head bolts. Center and level center section and torque all brackets at the frame location only to: 1/2" fasteners = 65 FT. LBS. And 12MM fasteners = 60 FT. LBS.
- STEP 12. Remove center section from brackets and re-install vehicle grille and plastic shroud in the opposite order of removal.
- STEP 13. Re-attach center section to brackets and torque 3/8" fasteners to 30 FT. LBS.
- STEP 14. Install hood bar gasket and grommet on each wing assembly. Place gasket over the small tube and slide grommet until flush with gasket. SEE FIGURE 2.
- STEP 15. Determine passenger and driver side wing assembly. Install driver side wing assembly using (4) 3/8-16 x 1.00" SS button head cap screws, (8) 3/8" SS flat washers, (4) 3/8" SS lock nuts and (4) 1.00" OD plastic washers. Hand tighten. SEE FIGURE 2.
- STEP 16. Install hood bar over grommet on driver wing. SEE FIGURE 2. NOTE: Bend should face forward.
- STEP 17. Install passenger side wing assembly using the same fasteners as in step 15. Place passenger side wing into hood bar as wing assembly is brought towards the center section. Center and level wings. Tighten and torque ss 3/8" fasteners to 35 FT. LBS. NOTE: Hood bar will fit tight against gasket as wing assemblies

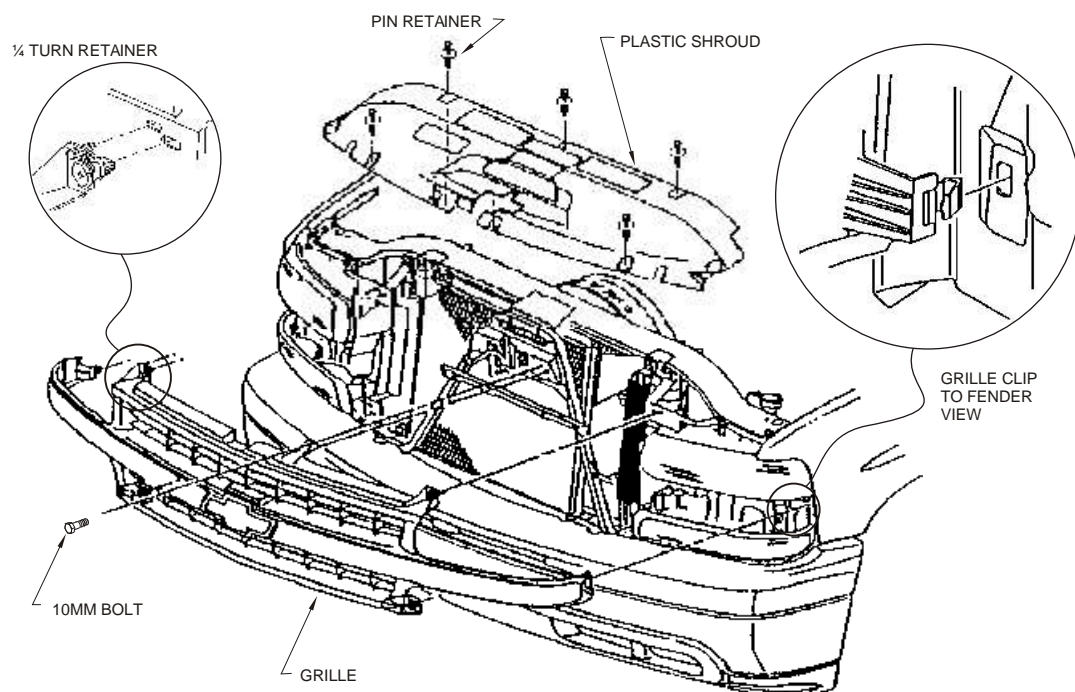

FIGURE 1

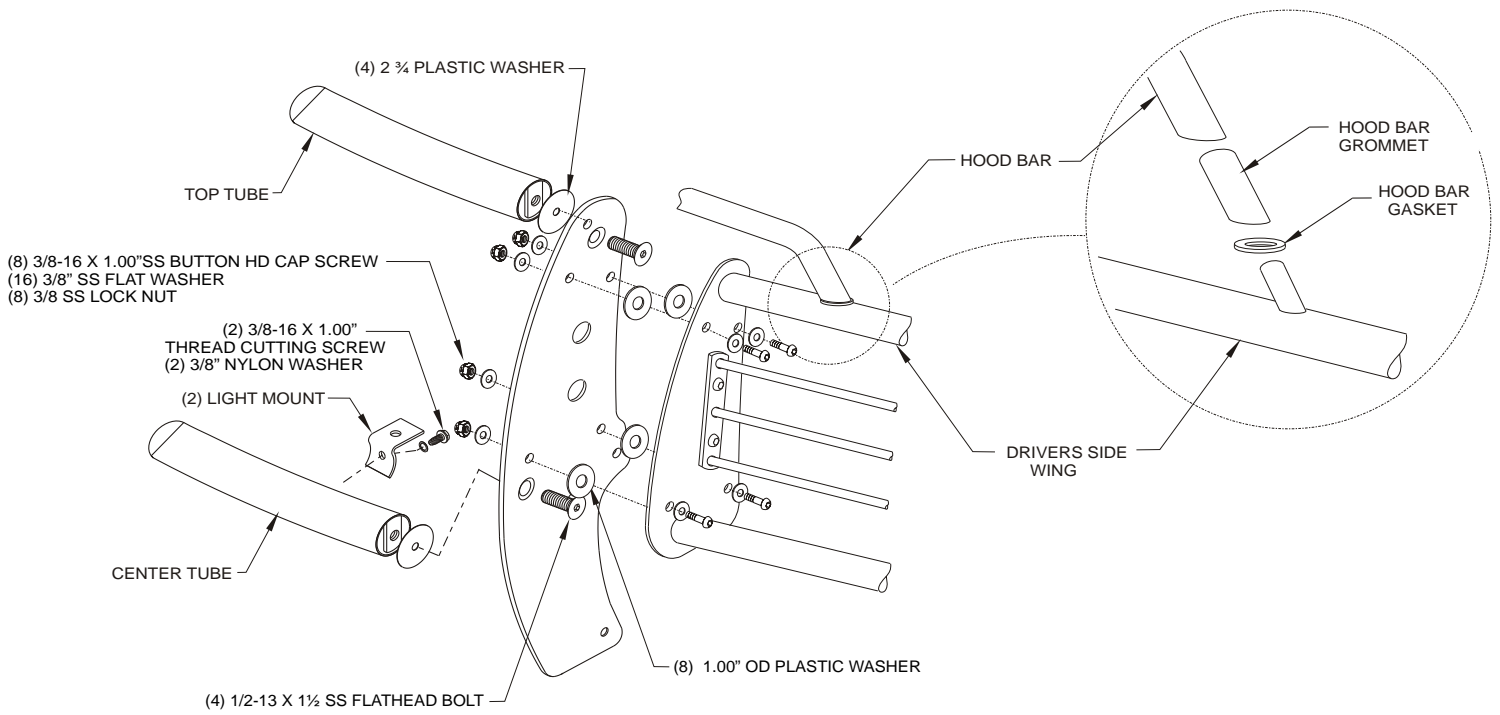

FIGURE 2

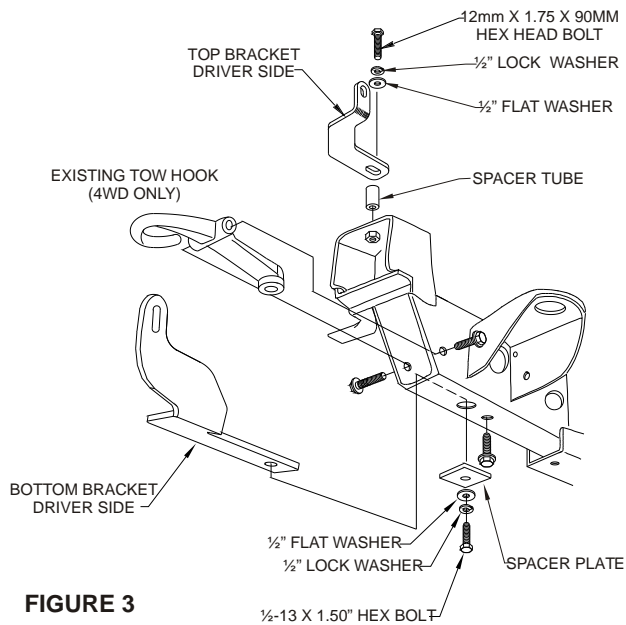

FIGURE 3

DRIVER SIDE SHOWN

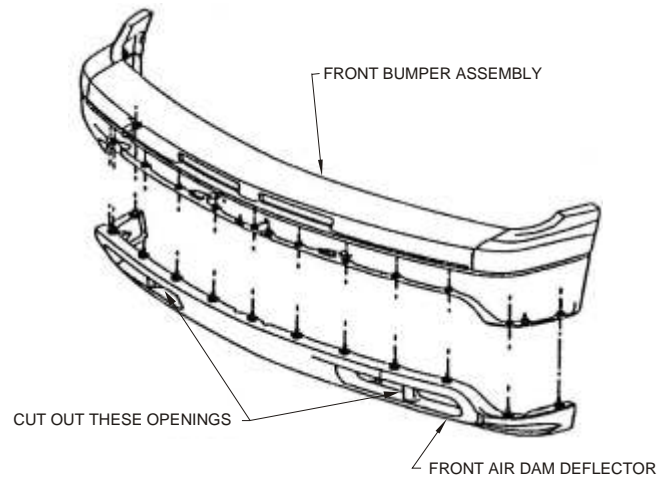

FIGURE 4

Finish protection - Westin products have a high quality finish that must be cared for like any other exposed finish on the vehicle. Protect the finish with a non-abrasive automotive wax (pure carnauba, for example) on a regular basis. The use of cleaner wax or any compound which contains an abrasive is detrimental, as the compounds scratch the finish and open it to corrosion.



Westin Automotive Products, Inc.
 5200 N. Irwindale Ave. Suite 220
 Irwindale, Ca. 91706

Thank You for choosing Westin products
 For additional installation assistance please call
 Customer service (800) 793-7846 or (507) 375-3559