



INSTALLATION INSTRUCTIONS

APPLICATION: 2002-UP CHEVROLET TRAILBLAZER/
TRAILBLAZER EXT

AUTOMOTIVE PRODUCTS, INC.

SPORTSMAN
ASSEMBLY

41-0945
44-0940

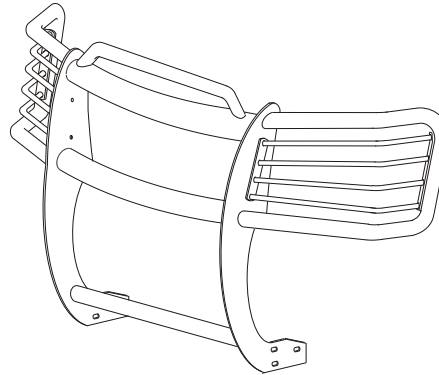

PARTS KIT CONTENTS

| QTY | DESCRIPTION | QTY | DESCRIPTION |
|-----------------------------------------------------------------------|---------------------------------|----------------------------------------------|-------------------------------------|
| 2 | UPRIGHT | 2 | 3/8-16 X 1.00" HEX HEAD BOLT |
| 2 | WING ASSEMBLY WITH LIGHT GUARDS | 6 | 3/8-16 X 1.25" HEX HEAD BOLT |
| 1 | BOTTOM TUBE | 16 | 3/8" FLAT WASHER |
| 1 | CENTER TUBE | 8 | 3/8" LOCK WASHER |
| 1 | HOOD BAR TOP TUBE ASSEMBLY | 8 | 3/8-16 HEX NUT |
| 2 | BOTTOM MOUNT BRACKET | 4 | 1/2" WILLIAMS WASHER |
| 2 | TOP MOUNT BRACE | 2 | 1/2" NYLON FLAT WASHER |
| 12 | 1/2" SS FLAT WASHER | 6 | 1/2" SS LOCK WASHERS |
| 6 | 1/2-13 SS HEX NUT | 6 | 1/2-13 X 1.25" SS HEX HEAD BOLT |
| 2 | M6-1.00 X 35MM HEX HEAD BOLT | 2 | 1/4" SAE FLAT WASHER |
| 2 | 1/4" SPLIT LOCK WASHER | 4 | 1/2-13 X 1.50" SS FLAT HEAD BOLT |
| 4 | 2 3/4" OD PLASTIC WASHER | 16 | 3/8" SS FLAT WASHER |
| 8 | 3/8-16" SS NYLOCK NUT | 10 | 3/8-16 X 1.00" BUTTON CAP SCREW |
| 2 | 3/8" INTERNAL TOOTH LOCK WASHER | 2 | 1 5/8" OD PLASTIC WASHER |
| 8 | 1.00" OD PLASTIC WASHER | 2 | 3/8-16 X 1.25" SS BUTTON HEAD SCREW |
| FASTENERS ARE CONTAINED IN BOLT KITS 60-1232, 60-1229 AND 60-1223. | | NOTE: NOT ALL FASTENERS WILL BE USED. | |

TOOLS REQUIRED

| | | | |
|------------------------|--------------------|-------------|-------------|
| 9/16" WRENCH | 9/16" SOCKET | 3/4" SOCKET | 10MM SOCKET |
| RATCHET | TORQUE WRENCH | 5/8" WRENCH | |
| 5/16" ALLEN WRENCH | 7/32" ALLEN WRENCH | 3/4" WRENCH | |
| SMALL FLAT SCREWDRIVER | | | |

- STEP 1. Remove the contents from the box and check for any damage. Verify all parts against the parts list.
- STEP 2. Read and understand instruction before beginning installation.
- STEP 3. Remove lower air dam from front bumper by removing the two push in fasteners from passenger and driver side of vehicle. Pull air dam forward to remove.
- STEP 4. Remove grille from vehicle. Locate the six clips that hold grille in place. SEE FIGURE 1. Gently pry clips with flat screw driver and lightly pull outward on grille. Do this at all six locations.
- STEP 5. From underneath the front of vehicle, locate the front body mount. Determine passenger and driver side bottom mount brackets. SEE FIGURE 2. Install brackets inside body mount channel with 3/8" bolts. Leave loose.

*NOTE If vehicle is equipped with underbody shield package it will be necessary to remove the front shield. If shield is to be reinstalled, both ends will need to be trimmed to fit around front mount brackets. Mounting hardware supplied with Sportsman will still be used.

- STEP 6. With grille removed, locate the two bumper cover 6MM bolts and remove. SEE FIGURE 1. Install mount brace using 6MM bolt, (2) 1/2" Williams Washers and nylon washer and (2) 1/2" nylon washer. Leave loose. Repeat for opposite side.
- STEP 7. Determine passenger and driver side uprights, hood bar top tube assembly and bottom tube. (Uprights are positioned so raised side of bolt holes are facing each other).
- STEP 8. Fasten uprights to hood bar top tube assembly, center tube and bottom tube using (4) 1/2-13 x 1.50" stainless steel flat head bolts, (4) 2 3/4" OD plastic washers, (2) 3/8-16 x 1.00" stainless steel button head cap screws, (2) 3/8" stainless steel internal tooth lock washers and (2) 1 5/8" OD plastic washers. Level tubes and torque 1/2" fasteners to 60 FT. LBS. And 3/8" fasteners to 30 FT. LBS.
- STEP 9. Determine passenger and driver side wing assemblies. Install driver side wing assembly using (3) 3/8-16 x 1.00" stainless steel button head cap screws, (6) 3/8" stainless steel flat washers, (3) 3/8-16" stainless steel nylock nuts and (8) 1.00" plastic washers. Leave out bolt on bottom rear of wing mount plate. (1) 3/8-16 x 1.25 button head screw, (2) 3/8" stainless steel flat washer, (2) stainless steel lock nuts, will be installed later to secure top mount brace.
- STEP 10. Lay Sportsman face down in front of vehicle and attach to bottom mount bracket using (1) 1/2" fasteners on each side. Leave loose.
- STEP 11. Rotate Sportsman up and install remaining bolts. Level Sportsman and torque 3/8" bottom mount bracket fasteners to 30 FT. LBS.
- STEP 12. Fasten top mount braces to Sportsman on each side using 3/8-16 x 1.25" button head cap screws. Torque only 6MM bolts on bumper to 8 FT. LBS.
- STEP 13. Remove 3/8" bolt from top mount braces and two of the 1/2" bolts from each side of bottom mount brackets to allow Sportsman to rotate forward and reinstall grille.
- STEP 14. Rotate Sportsman up and re-attach Sportsman to top mount braces and tighten the 3/8" fasteners to 30 FT. LBS. Reinstall all 1/2" fasteners and torque to 65 FT. LBS.

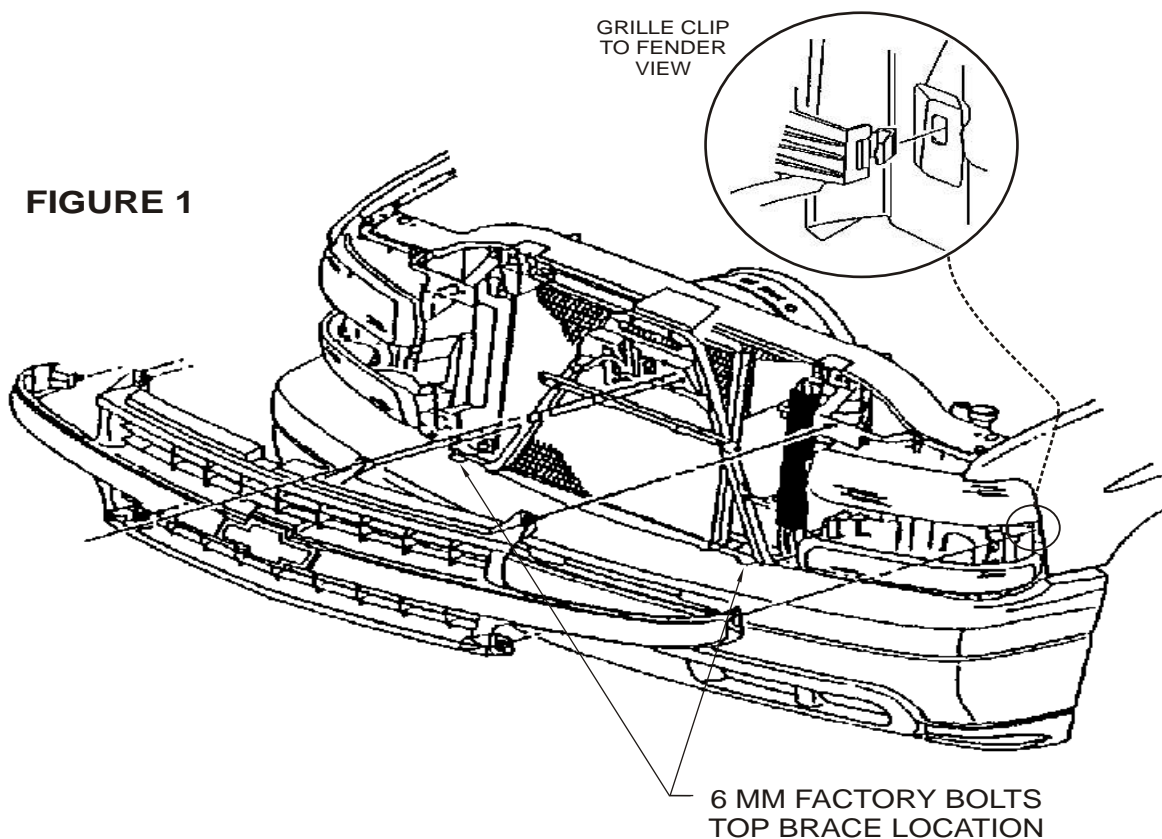

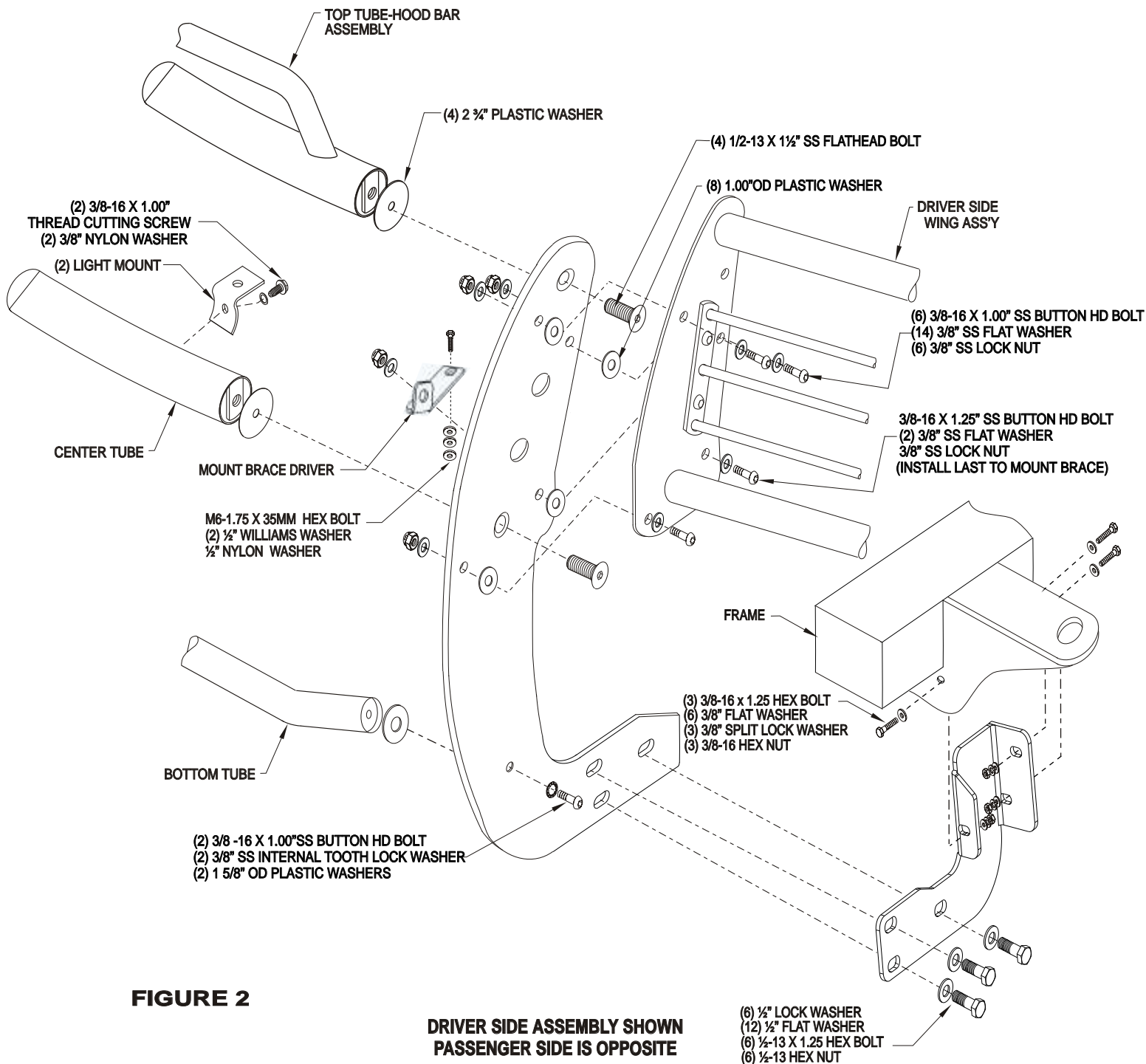

FIGURE 2

**DRIVER SIDE ASSEMBLY SHOWN
PASSENGER SIDE IS OPPOSITE**

Finish protection - Westin products have a high quality finish that must be cared for like any other exposed finish on the vehicle. Protect the finish with a non-abrasive automotive wax (pure carnauba, for example) on a regular basis. The use of cleaner wax or any compound which contains an abrasive is detrimental, as the compounds scratch the finish and open it to corrosion.