



INSTALLATION INSTRUCTIONS

APPLICATION: 2002-UP FORD EXPLORER
4 DOOR 2/4 WHEEL DRIVE

AUTOMOTIVE PRODUCTS, INC.

SPORTSMAN
ASSEMBLY

41-0975
44-0970

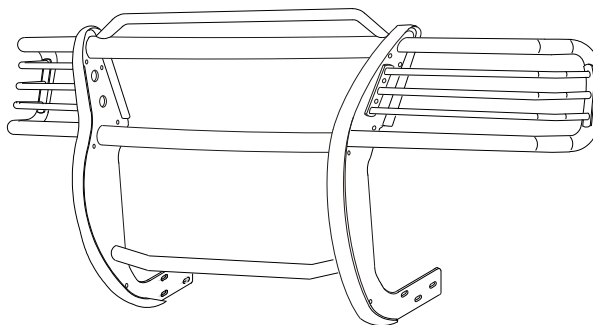

PARTS KIT CONTENTS

QTY	DESCRIPTION	QTY	DESCRIPTION	QTY	DESCRIPTION
2	UPRIGHT	4	2 3/4" OD PLASTIC WASHER	6	1/2 -13 X 1.25" HEX HD BOLT
2	WING ASSY & LIGHT GUARDS	2	1 5/8" OD PLASTIC WASHER	5	3/8-16 X 1.25 HEX HD BOLT
1	BOTTOM TUBE	2	3/8" NYLON WASHER	6	1/2-13 HEX NUT
1	CENTER TUBE	10	3/8-16 x 1.00" BUTTON CAP SCREW	1	3/8-16 HEX NUT
1	TOP TUBE/HOOD BAR ASSY	16	3/8" SS FLAT WASHER	12	1/2" FLAT WASHER
1	MOUNT BRACKET, PASSENGER	2	3/8-16 x 1.00" THREAD CUTTING SCREW	6	1/2" SPLIT LOCK WASHER
1	MOUNT BRACKET, DRIVER	8	3/8-16" SS NYLOCK NUT	6	3/8" FLAT WASHER
1	TOP BRACE	2	3/8" INTERNAL TOOTH LOCK WASHER	5	3/8" SPLIT LOCK WASHER
2	LIGHT MOUNT	4	1/2-13 x 1.50" SS FLATHEAD BOLT	4	3/8" NUT PLATE
		8	1.00" PLASTIC WASHER	1	5/16" U-NUT
				1	5/16-18 X 1.00 HEX HD BOLT
				1	5/16" FLAT WASHER
				1	5/16" SPLIT LOCK WASHER

TOOLS REQUIRED

3/4" WRENCH	9/16" SOCKET	SMALL FLAT SCREWDRIVER
9/16" WRENCH	3/4" SOCKET	PHILLIPS SCREWDRIVER
5/8" WRENCH	1/2" SOCKET	5/16" ALLEN WRENCH
TORQUE WRENCH	10MM SOCKET	7/32" ALLEN WRENCH
RATCHET	SOCKET EXTENSION	

- STEP 1. Remove the contents from the box and check for any damage. Verify all parts against the parts list.
- STEP 2. Read and understand instructions before beginning installation.
- STEP 3. Open hood to remove vehicle grille. Remove (4) Phillips push pins on top of grille. Pull upward on grille to release
- STEP 4. Insert 5/16" U-Nut in square hole to the right of hood latch on radiator support frame. Push down on plastic radiator surround and insert Top Brace between plastic radiator surround and grille support frame. Fasten Top Brace with (1) 5/16-18 x 1.00" Hex Head Bolt, (1) 5/16" Lock Washer, (1) 5/16" Flat Washer. Torque to 17 Ft. Lbs.
- STEP 5. Reinstall grille and plastic pins.
- STEP 6. Determine passenger and driver side uprights, hood bar/top tube assembly and bottom tube. (Uprights are positioned so raised side of bolt holes are facing each other.)
- STEP 7. Fasten uprights to hood bar/top tube assembly, center tube and bottom tube using (4) 1/2-13x1.50" stainless steel flat head bolts, (4) 2.75" plastic washers, (2) 3/8-16 x 1.00" stainless steel button head cap screw, (2) 3/8" stainless steel internal tooth lock washers and (2) 1.625" plastic washer. Level tubes and torque 1/2" fasteners to 60 FT. LBS. And 3/8" fasteners to 30 FT. LBS.
- STEP 8. Determine passenger and driver wing assemblies. Install driver side wing assembly using (4) 3/8-16 X 1.00" stainless steel button head cap screw, (8) 3/8" stainless steel flat washers, (4) 3/8-16 stainless steel nylock nuts and

1.00" plastic washers Tighten and torque to 35 FT. LBS. Repeat for opposite side.

- STEP 9. Remove two 10MM bolts and plastic Rivets that hold lower air dam to front bumper. Save fasteners, lower dam will be reinstalled.
- STEP 10. Determine driver and passenger side brackets. Locate the oblong and two round holes on bottom side of frame just below body mounts.
- STEP 11. Insert one bolt plate through the oblong hole on bottom of frame. Position it over one of the round holes. Start the 3/8" bolt, flat and lock washer into bolt plate. Repeat for the remaining round hole.
- STEP 12. Slide bracket onto the 3/8" bolts. Make sure the washers are on the outside of brackets and not against the frame. Lightly snug up 3/8" bolts.
- STEP 13. Repeat Step 10 through 12 for other side of vehicle.
- STEP 14. With Sportsman front side down in front of vehicle, fasten rear slot of Sportsman to the rear slot of mount bracket on bottom of frame, using (1) 1/2-13 x 1.25 Hex Head bolt, (1) 1/2" Lock washer, (2) 1/2" Flat washer and (1) 1/2-13 Hex Nut on each side. Rotate Sportsman up to vehicle and fasten to mount bracket using remaining 1/2" fasteners. Fasten Top Brace to Sportsman Assembly using (1) 3/8-16 x 1.00 Hex Head Bolt, (1) 3/8" Lock washer, (2) 3/8" Flat Washer and (1) 3/8-16 Hex Nut. Leave loose.
- STEP 15. Center and level sportsman as desired and torque all fasteners: 1/2" to 65ft. Lbs: 3/8" to 35 FT. LBS.

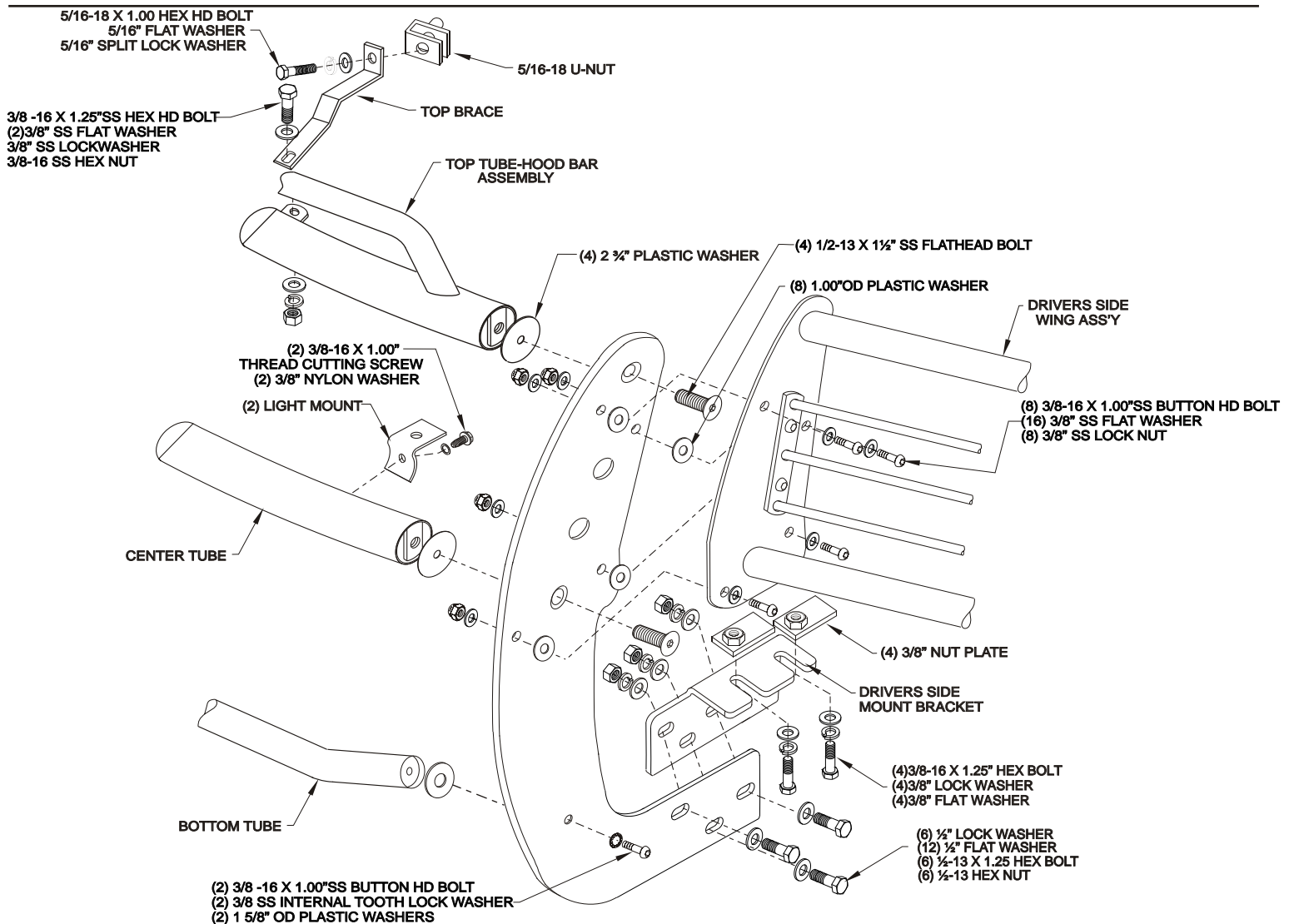

Finish protection - Westin products have a high quality finish that must be cared for like any other exposed finish on the vehicle. Protect the finish with a non-abrasive automotive wax (pure carnauba, for example) on a regular basis. The use of cleaner wax or any compound which contains an abrasive is detrimental, as the compounds scratch the finish and open it to corrosion.



Westin Automotive Products, Inc.
5200 N. Irwindale Ave. Suite 220
Irwindale, Ca. 91706

Thank You for choosing Westin products
For additional installation assistance please call
Customer service (800) 793-7846 or (507) 375-3559