



INSTALLATION INSTRUCTIONS

APPLICATION: 1988 - 00 CHEVROLET/GMC C/K SERIES PICK-UP AND SPORT UTILITY

AUTOMOTIVE PRODUCTS, INC.

SPORTSMAN
ASSEMBLY

44-0080
41-0085

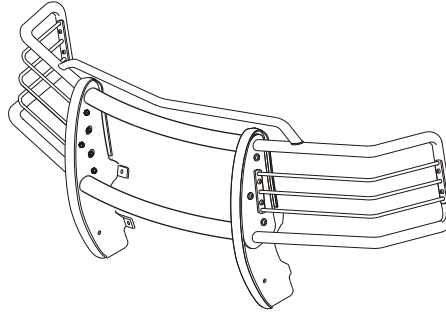

PARTS KIT CONTENTS

QTY	DESCRIPTION	QTY	DESCRIPTION
2	UPRIGHT	4	2 3/4" OD PLASTIC WASHER
2	WING ASSY., W/ LIGHT GUARDS	2	1 5/8" OD PLASTIC WASHER
1	TOP TUBE	2	3/8" NYLON WASHER
1	CENTER TUBE	8	1.00" OD PLASTIC WASHER
1	BOTTOM TUBE	16	3/8" FLAT WASHER
1	HOOD BAR	2	3/8-16 X 1.00" THREAD CUTTING SCREW
2	HOOD BAR GASKET	10	3/8-16 X 1.00" BUTTON HEAD CAP SCREW
2	HOOD BAR GROMMET	2	3/8" INTERNAL TOOTH LOCK WASHER
2	LIGHT MOUNT	4	3/8-16 X 1.00" HEX HEAD BOLT
2	TOP CLAMP	4	3/8" LOCK WASHER
2	BOTTOM CLAMP	4	1/2-13 X 1.50" SS FLAT HEAD BOLT
4	3/8" FLAT WASHER	8	3/8-16 LOCKNUT
2	PROTECTIVE RUBBER STRIP	2	3/8-16 HEX NUT

Fasteners are contained in bolt kits: **44-0080:** 60-1223, 60-1035 / **41-0085:** 60-1216, 60-1241

TOOLS REQUIRED

9/16" WRENCH
7/32" HEX WRENCH

9/16" SOCKET
RATCHET

5/16" HEX WRENCH
TORQUE WRENCH

5/8" WRENCH

- STEP 1. Remove the contents from the box and check for any damage. Verify all parts against the parts list.
- STEP 2. Read and understand instructions completely before beginning installation.
- STEP 3. Determine Driver and Passenger Uprights and Top and Center Tubes. (Uprights are positioned so raised side of bolt holes are facing each other).
- STEP 4. Fasten Uprights to Top and Center Tubes using (4) 1/2-13 x 1.50" Stainless Steel Flat Head Bolts and (4) 2 3/4" OD Plastic Washers. Fasten Bottom Tube using (2) 3/8-16 x 1.00" Stainless Steel Button Head Cap Screws, (2) 3/8" SS Internal Tooth Lock Washers, and (2) 1 5/8" OD Plastic Washers. Level tubes and torque 1/2" Bolts to 60 FT. LBS and 3/8" Bolts to 30 FT. LBS. Place Protective Rubber Strips on Uprights where contact with bumper is made.
- STEP 5. Fasten Light Mounts to Center Tube using (2) 3/8-16 x 1.00" Thread Cutting Screws and (2) 3/8" Nylon Washers. Tighten and torque to 20 FT. LBS. See Figure 2.

- STEP 6. Stand the Center Section up against the bumper to help determine the general location of the Top Clamps. Hook the Top Clamps over the Bumper. See Figure 1.
- STEP 7. Raise the Center Section up to the clamps and secure to the Top Clamps with (2) 3/8-16 x 1.00" Hex Bolts, (2) 3/8" Flat Washers and (2) 3/8" Lock Washers. Hand tighten.
- STEP 8. Re-adjust the Center Section to center it on the vehicle. Slide the Bottom Clamps between the air dam and bumper. Attach with (2) 3/8-16 x 1.00" Hex Bolts, (2) 1/2" Flat Washers, (2) 1/2" Lock Washers and (2) 3/8-16 Hex Nuts.
- STEP 9. Realign the Center Section and tighten until tight to the bumper and feels secure.
- STEP 10. Install Hood Bar Gasket and Grommet on each Wing Assembly. Place Gasket Over the small tube and slide Grommet until flush with Gasket. See Figure 2.
- STEP 11. Determine Passenger and Driver Side Wing Assemblies. See Figure 2. Install Driver Side Wing Assembly using (4) 3/8-16 x 1.00" Stainless Steel Button Head Cap Screws, (8) 3/8" SS Flat Washers, (4) 3/8" SS Lock Nuts and (4) 1.00" OD Plastic Washers. Tighten and torque Stainless Steel fasteners to 35 FT. LBS. See Figure 2.
- STEP 12. Install Hood Bar over Grommet on Driver Wing. See Figure 2. NOTE: Bend should face forward.
- STEP 13. Install Passenger Side Wing Assembly using the same fasteners as in Step 14. Place Passenger Side Wing into Hood Bar as Wing Assembly is brought towards the Center Section. Tighten and torque 3/8" Stainless Steel Fasteners to 35 FT LBS. NOTE: Hood Bar will fit tight against Gasket as Wing Assemblies are tightened.

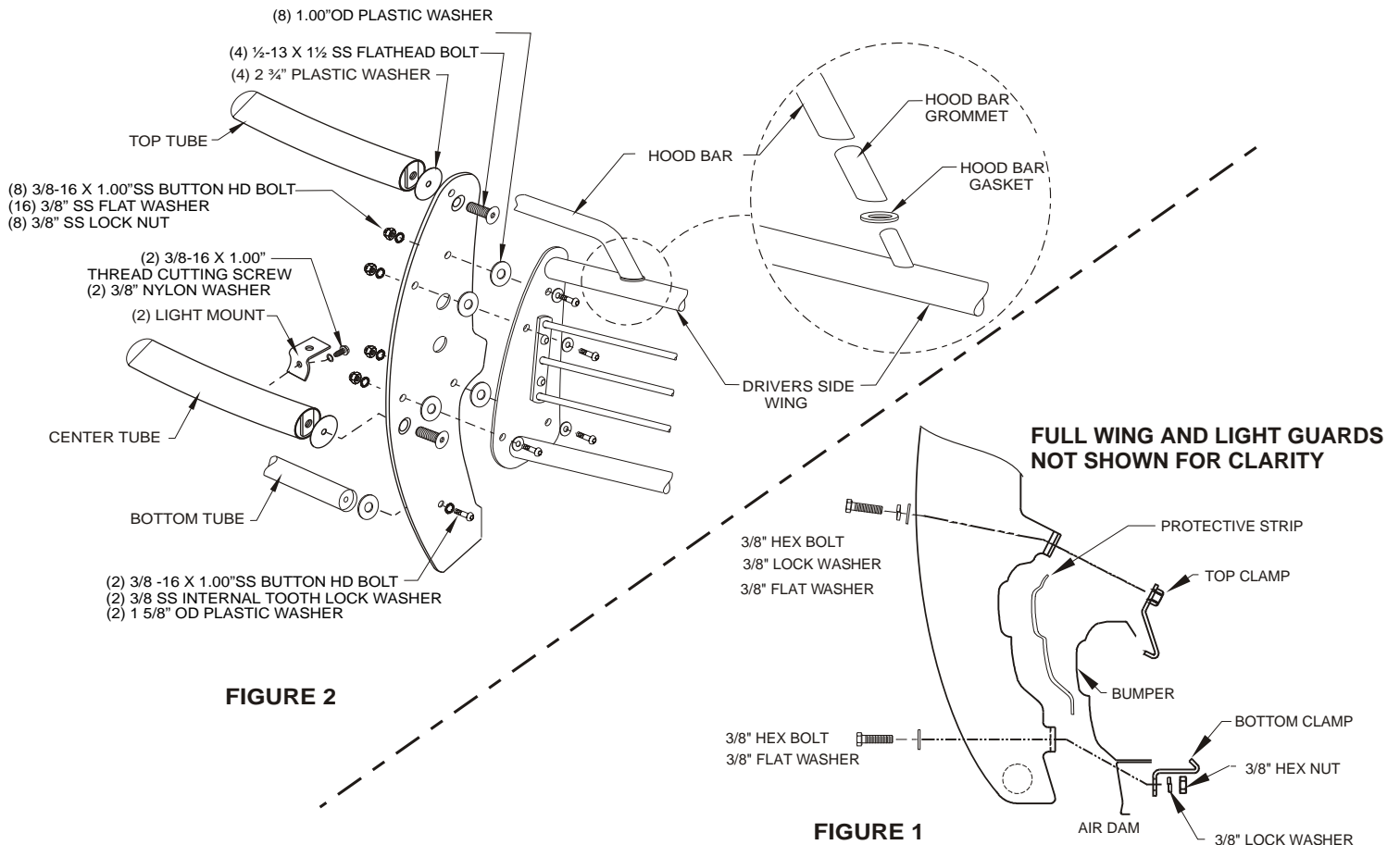

Finish protection - Westin products have a high quality finish that must be cared for like any other exposed finish on the vehicle. Protect the finish with a non-abrasive automotive wax (pure carnauba, for example) on a regular basis. The use of cleaner wax or any compound which contains an abrasive is detrimental, as the compounds scratch the finish and open it to corrosion.



Westin Automotive Products, Inc.
5200 N. Irwindale Ave., Suite 220
Irwindale, Ca. 91706

Thank You for choosing Westin products
For additional installation assistance please call
Customer service (800) 793-7846 or (507) 375-3559