



INSTALLATION INSTRUCTIONS

APPLICATION: 1991-94 FORD EXPLORER

AUTOMOTIVE PRODUCTS, INC.

STEP BAR
ASSEMBLIES

25-0550
25-0555

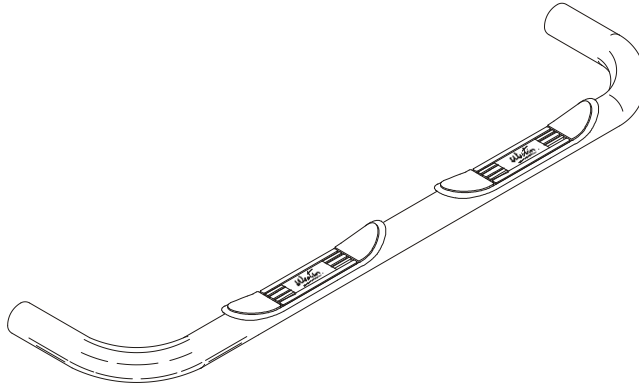

QTY	PARTS KIT CONTENTS DESCRIPTION	TOOLS REQUIRED
1	STEP BAR ASSEMBLY, PASSENGER	RATCHET 19MM SOCKET 3/4" SOCKET 21MM SOCKET
1	STEP BAR ASSEMBLY, DRIVER	
2	FRONT MOUNT BRACKET	
1	REAR MOUNT PLATE ASSEMBLY, PASSENGER	
1	REAR MOUNT PLATE ASSEMBLY, DRIVER	
2	SPACER TUBE	
4	M12-1.75 HEX NUT	
6	1/2" LOCK WASHER	
8	1/2" FLAT WASHER	
4	1/2-13 X 2.00" HEX HEAD BOLT	
2	1/2-13 X 1.50" HEX HEAD BOLT	
2	1/2-13 HEX NUT	
4	1/2" EXTERNAL TOOTH LOCK WASHER	

- STEP 1. Remove the contents from the box and check for any damage. Verify all parts against the parts list.
- STEP 2. Read and understand instructions completely before beginning installation.
- STEP 3. Screw Spacer Tube onto front Body Mount and torque to 75 FT. LBS. Mount Front Bracket to Body Mount using (1) 1/2" Flat Washer, (1) 1/2" Lock Washer and (1) M12-1.75 Hex Nut.
- STEP 4. Loosen the existing bolt on the Rear Shackle that faces toward the outside of the vehicle, then remove the other Rear Shackle Bolt. Slide the Rear Mounting Plate over loose Shackle Bolt and reinstall the other bolt through the mounting tab into the Shackle as shown.
- STEP 5. Bolt Step Bar Tube up to Mounting Brackets using (2) 1/2-13 x 2.00" Hex Bolts, (2) 1/2" Lock Washers and (2) 1/2" Flat Washers as shown.
- STEP 6. Tighten and torque to all fasteners to 75 FT. LBS.

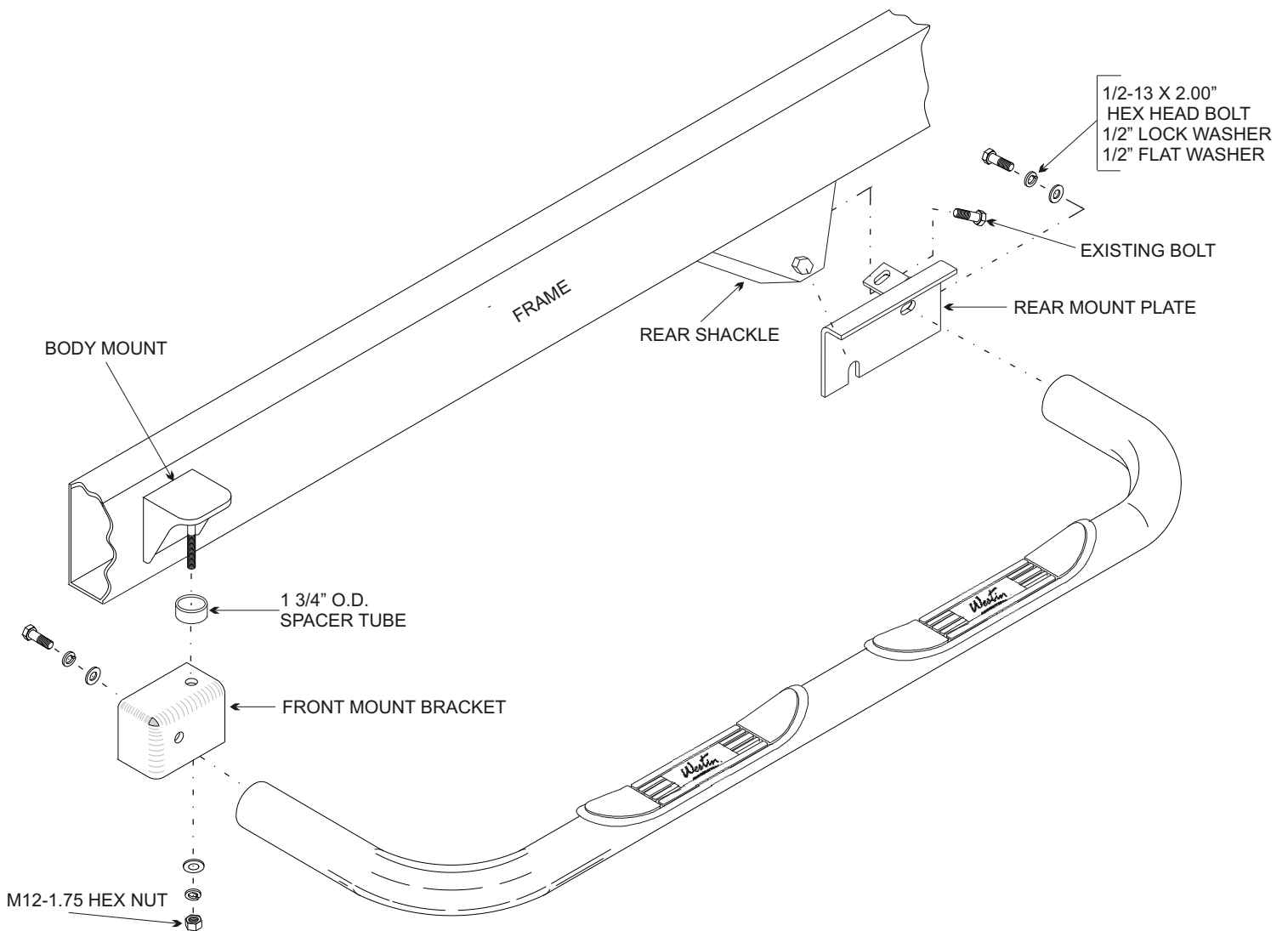

ASSEMBLY AND INSTALLATION VIEW OF DRIVER SIDE - PASSENGER SIDE OPPOSITE

Finish protection - Westin products have a high quality finish that must be cared for like any other exposed finish on the vehicle. Protect the finish with a non-abrasive automotive wax (pure carnauba, for example) on a regular basis. The use of cleaner wax or any compound which contains an abrasive is detrimental, as the compounds scratch the finish and open it to corrosion.



A subsidiary of Wedgestone Corporation
 15854 Ornelas Street
 Irwindale, Ca. 91706

Thank You for choosing Westin products
 For additional installation assistance please call
 Customer service (800) 793-7846 or (507) 375-3559