



INSTALLATION INSTRUCTIONS

APPLICATION: 1992-96 FORD PICKUP AND BRONCO

AUTOMOTIVE PRODUCTS, INC.

PUSH BAR
ASSEMBLY

36-1400
36-1405

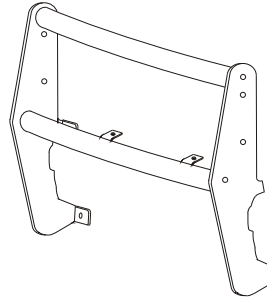

QTY	PARTS KIT CONTENTS DESCRIPTION	TOOLS REQUIRED
2	UPRIGHT	1/2" SOCKET
1	TOP TUBE ASSEMBLY	1/2" WRENCH
1	BOTTOM TUBE ASSEMBLY	9/16" SOCKET
2	LIGHT MOUNT	9/16" WRENCH
2	TOP CLAMP	5/16" HEX WRENCH
2	FRAME CLAMP (1/2TON)	RATCHET
2	FRAME CLAMP (3/4TON & BRONCO)	TORQUE WRENCH
2	BOTTOM CLAMP	
4	1/2-13 X 1.50" FLAT HEAD BOLT	
2	3/8-16 X 1.00" THREAD CUTTING SCREW	
8	3/8-16 X 1.00" HEX HEAD BOLT	
8	3/8" FLAT WASHER	
8	3/8" LOCK WASHER	
8	3/8-16 HEX NUT	
2	7/16" NYLON WASHER	
2	PUSH BAR GASKET	

- STEP 1. Remove the contents from the box and check for any damage. Verify all parts against parts list.
- STEP 2. Read and understand instructions completely before beginning installation.
- STEP 3. Determine passenger and driver uprights and top and bottom tubes. **NOTE:** Uprights are positioned so raised side of bolt holes are facing each other and the tube with the two pierced holes is the bottom tube assembly. Attach uprights to top and bottom tube assemblies using 1/2-13 x 1.50" flat head bolts and 3.00" push bar gaskets. Torque to 60 FT.LBS.
- STEP 4. Fasten light mounts to bottom tube assembly as shown and torque to 20 FT.LBS.
- STEP 5. Slide top clamps onto bumper. Attach push bar assembly to top clamps as shown.
- STEP 6. Center push bar on vehicle. Hold bottom tab on upright tight against air dam and drill a 13/32" hole through the air dam at bottom tab hole location. Attach bottom clamp to upright through drilled hole as shown. Hand tighten.
- STEP 7. Determine correct frame clamps for your vehicle. Attach frame clamps to bottom clamps as shown. Hand tighten. Adjust frame clamps until the hole aligns with existing hole in vehicle frame. **NOTE:** Vehicle where

there is a cross member mounted at this location, remove only that bolt and attach frame clamp with existing bolt, If no bolt is present, attach frame clamps using 3/8" fasteners as shown. Torque to 30 FT.LBS.

STEP 8. Make sure push bar is centered and level. **NOTE:** Due to variations of bumper locations, it may be necessary to adjust the bumper location to allow clearance and proper alignment of mount clamps.

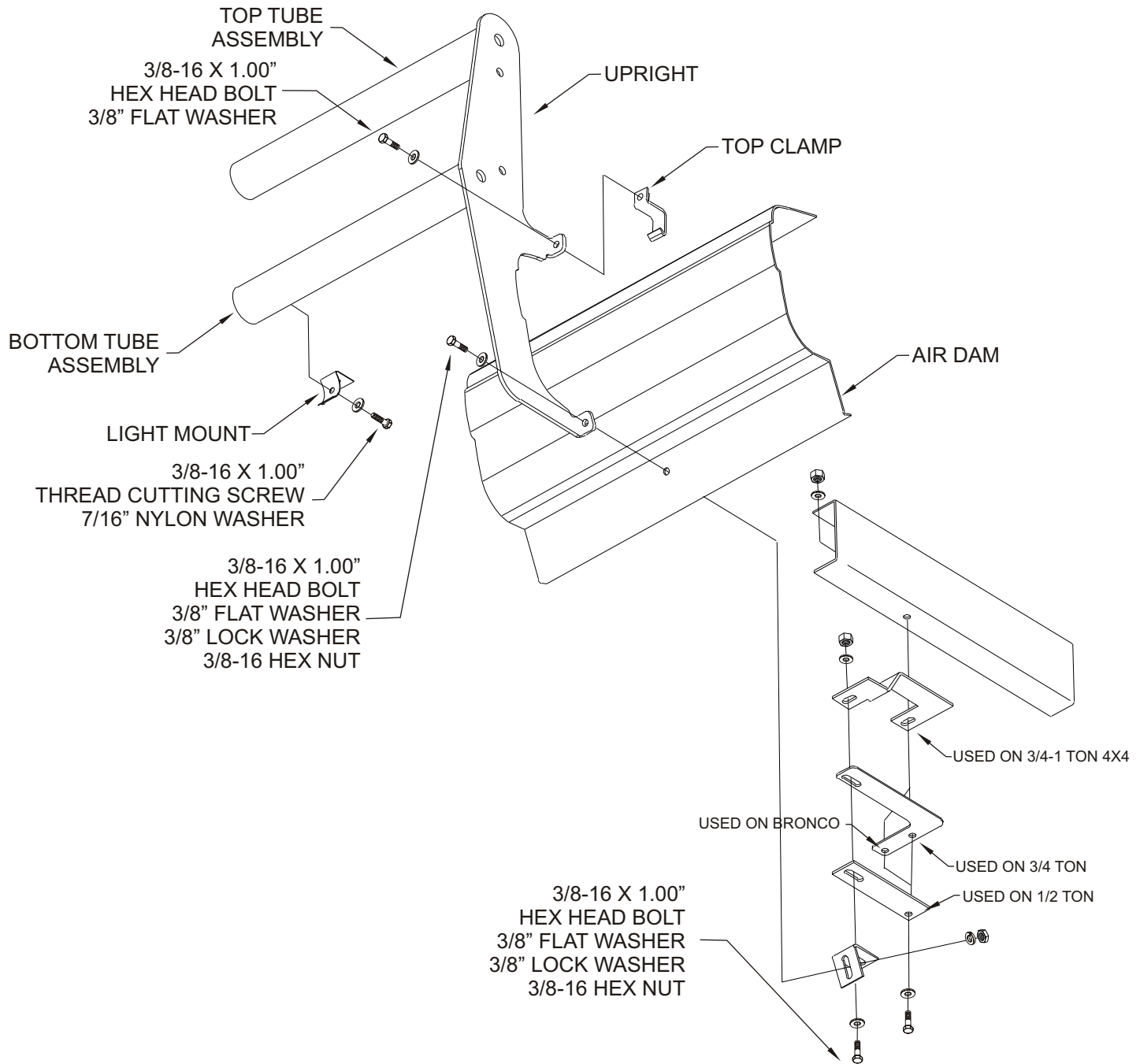

Finish protection - Westin products have a high quality finish that must be cared for like any other exposed finish on the vehicle. Protect the finish with a non-abrasive automotive wax (pure carnauba, for example) on a regular basis. The use of cleaner wax or any compound which contains an abrasive is detrimental, as the compounds scratch the finish and open it to corrosion.



Westin Automotive Products, Inc.
5200 N. Irwindale Ave. Suite 220
Irwindale, Ca. 91706

Thank You for choosing Westin products
For additional installation assistance please call
Customer service (800) 793-7846 or (507) 375-3559