



SIGNATURE OF QUALITY

AUTOMOTIVE PRODUCTS, INC.

# INSTALLATION INSTRUCTIONS

APPLICATION: FORD INTERCEPTOR UTILITY WING WRAP (2012 & UP)  
FORD INTERCEPTOR SEDAN WING WRAP (2013 & UP)  
APPLICATION PART #'S 36-2005W, 36-2015W, 36-2055W

ITEM	QUANTITY	DESCRIPTION	TOOLS NEEDED
1,2	2	WING WRAP ASSEMBLIES (DRV & PASS)	RATCHET
3	2	M12 BUTTON HEAD SCREW (BLACK PLATED S/S)	18MM SOCKET
4	2	M12 CUPPED WASHER (BLACK PLATED S/S)	16MM SOCKET
5	2	M12 FLANGE NUT (BLACK PLATED S/S)	10MM SOCKET
6	4	M10 BUTTON HEAD SCREW (BLACK PLATED S/S)	ALLEN WRENCH
7	4	M10 CUPPED WASHER (BLACK PLATED S/S)	TORQUE WRENCH
8	4	M10 FLANGE NUT (BLACK PLATED S/S)	
9	4	M6 BUTTON HEAD SCREW (BLACK PLATED S/S)	
10	4	M6 FLAT WASHER (BLACK PLATED S/S)	
11	4	M6 FLANGE NUT (BLACK PLATED S/S)	

### ANTI-SEIZE LUBRICANT MUST BE USED ON ALL STAINLESS STEEL FASTENERS TO PREVENT THREAD DAMAGE AND GALLING

1. Remove contents from box, verify if all parts listed are present and free from damage. Carefully read and understand all instructions before attempting installation.
2. Install the Police Push Bar (36-2005/2015/2055) and Pit Bar Set (36-2005PB/2015PB/2055PB) to the front of the vehicle. Refer to I/S 75-36200 & 75-3049 for Utility and 75-36201 & 75-3061 for Sedan. *Note: The Pit Bar Set is necessary to properly install the Wing Wraps.*
3. One side at a time loosely install each Wing Wrap to the Push Bar uprights using the supplied M12 and M6 hardware.
4. Loosely attach the foot of each wing to each Pit Bar upper rail using the supplied M10 hardware.
5. Align and adjust the Wing Wraps as necessary then tighten and torque all fasteners as follows: M6 to 7 - 9 ft-lbs, M10 to 30 - 35 ft-lbs, M12 to 50 - 55 ft-lbs.

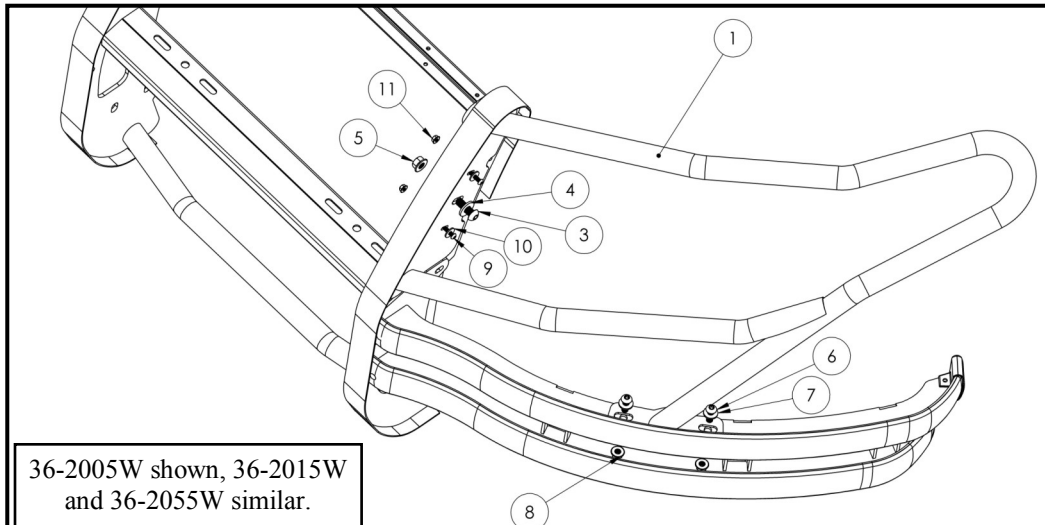

### CARE INSTRUCTIONS:

- REGULAR WAXING IS RECOMMENDED. DO NOT USE ANY TYPE OF POLISH OR WAX THAT MAY CONTAIN ABRASIVES.
- STAINLESS STEEL PRODUCTS CAN BE CLEANED WITH MILD SOAP AND WATER. STAINLESS STEEL POLISH SHOULD BE USED TO POLISH SMALL SCRATCHES.
- GLOSS BLACK FINISHES SHOULD BE CLEANED WITH MILD SOAP AND WATER.



Westin Automotive Products, Inc.  
320 Covina Blvd  
San Dimas, Ca. 91773

Thank you for choosing Westin products  
for additional installation assistance please call  
Customer Service (800) 793-7846  
www.westinautomotive.com