

# INSTALLATION INSTRUCTIONS



**ULTIMATE BULL BAR**  
**APPLICATION:**  
**2006-14 TOYOTA FJ CRUISER**  
**PART NUMBER:**  
**32-2215**

CONTENT			
ITEM	QUANTITY	DESCRIPTION	TOOLS NEEDED
1	1	<b>ULTIMATE BULL BAR</b>	9/16" SOCKET
2, 3	2	BRACKET, PASSENGER (2) AND DRIVER (3)	9/16" WRENCH
4	2	SUPPORT BRACE	3/4" SOCKET
5	2	PLASTIC PLUG	3/4" WRENCH
6	4	RUBBER BUMPER	14MM SOCKET
7	4	3/8-16 X 1.25" HEX HEAD BOLT, STAINLESS STEEL	14MM WRENCH
8	8	3/8" FLAT WASHER, STAINLESS STEEL	19MM SOCKET
9	4	3/8" LOCK WASHER, STAINLESS STEEL	RATCHET
10	4	3/8-16 HEX NUT, STAINLESS STEEL	TORQUE WRENCH
11	4	3/8-16 X 5.00" HEX HEAD BOLT, YELLOW ZINC	
12	8	3/8" FLAT WASHER, YELLOW ZINC	
13	4	3/8" LOCK WASHER, YELLOW ZINC	
14	4	3/8-16 HEX NUT, YELLOW ZINC	
15	4	1/2-13 X 1.25" HEX HEAD BOLT, STAINLESS STEEL	
16	10	1/2" FLAT WASHER, STAINLESS STEEL	
17	6	1/2" LOCK WASHER, STAINLESS STEEL	
18	4	1/2-13 HEX NUT, STAINLESS STEEL	
19	2	M12-1.25 X 30MM HEX HEAD BOLT	
20	2	SPACER PLATES( 2010-UP MODEL YEARS ONLY)	

**ANTI-SEIZE LUBRICANT MUST BE USED ON ALL STAINLESS STEEL FASTENERS TO PREVENT THREAD DAMAGE AND GALLING**

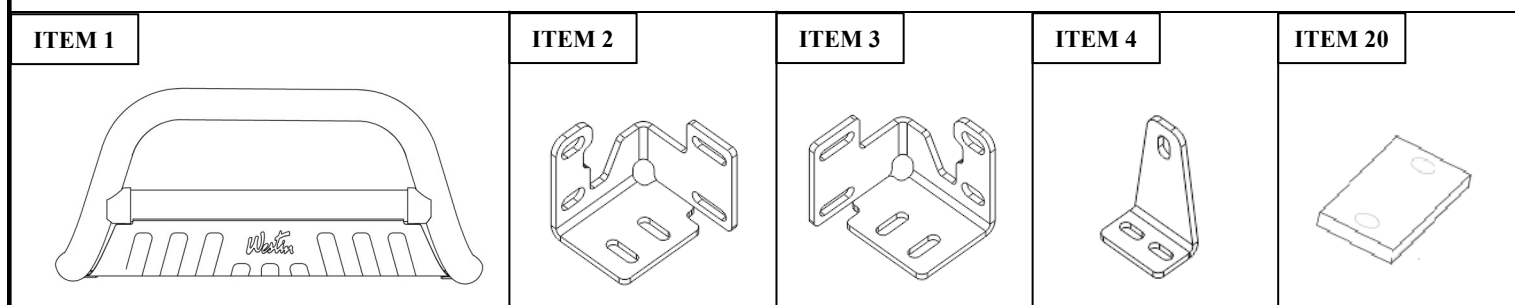

## PROCEDURE

1. Remove contents from box, verify if all parts listed are present and free from damage.  
Carefully read and understand all instructions before attempting installation.  
**Failure to identify damage before installation could lead to a rejection of any claim.**
2. NOTE: It will be necessary to remove the front license plate and bracket. If local/state laws requires a license plate, license plate relocation kit 32-0055 is available.
3. Position brackets onto bottom surface of frame using 3/8" yellow zinc fasteners. Leave loose. SEE FIGURES 2 AND 3.
4. Attach support brace to brackets using 3/8" stainless steel fasteners. Attach support brace to frame using M12 fasteners. Leave loose. SEE FIGURE 3.
5. Attach Bull Bar to mount brackets using 1/2" fasteners. Level and adjust Bull Bar as desired and tighten all fasteners. SEE FIGURE 4. Recommended torque values are 37 Ft. Lbs. for 1/2" fasteners, 17 Ft. Lbs. for 3/8" stainless steel fasteners, 26 Ft.Lbs. for 3/8" yellow zinc fasteners and 55 Ft. Lbs. for M12 fasteners.
6. LIGHT INSTALLATION: Insert threaded stud on base of the light through hole in cross tube. Using a ratchet, extension and socket for correct size of nut supplied, insert through large clearance hole in bottom of cross tube. Thread nut and washers on stud and tighten. SEE FIGURE 1. NOTE: A short socket, not a deep well works best to get the nut started.
7. NOTE: Fits most 6" round or rectangle lights. Some lights may require replacing included mount/isolator with rubber.

FIGURE 2 DRIVER SIDE SHOWN, PASSENGER SIDE OPPOSITE

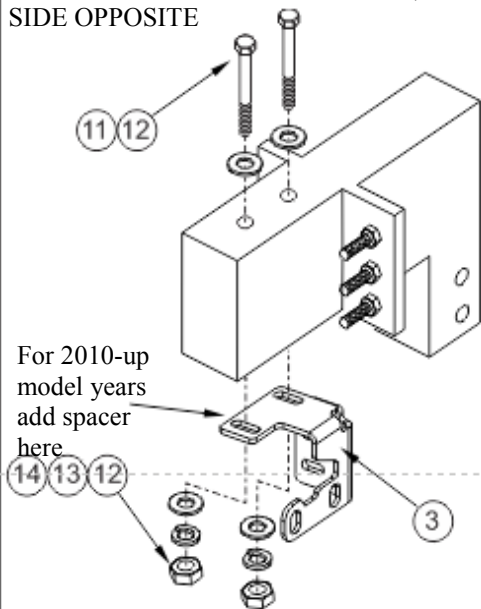

FIGURE 3 DRIVER SIDE SHOWN, PASSENGER SIDE OPPOSITE

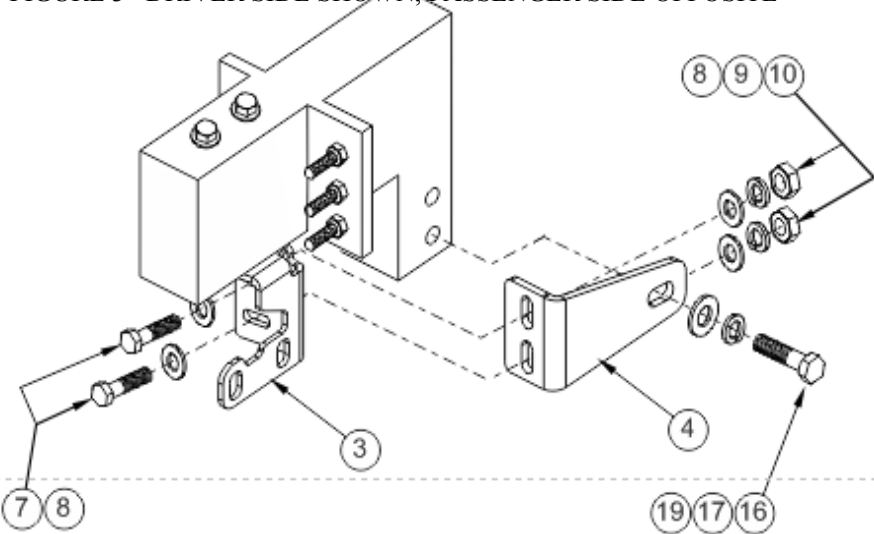
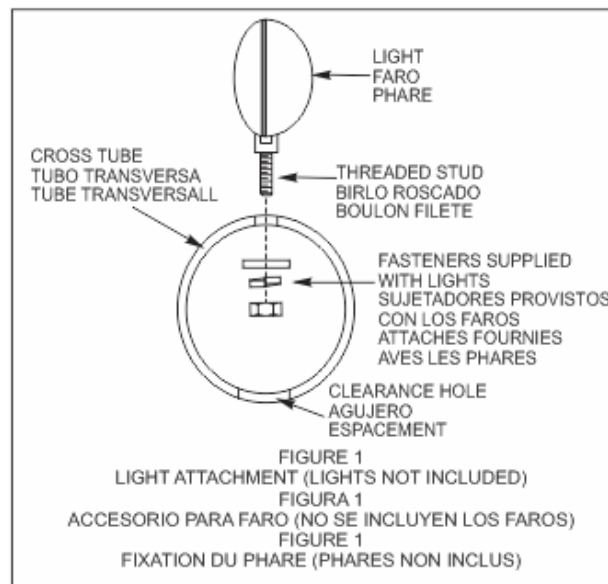
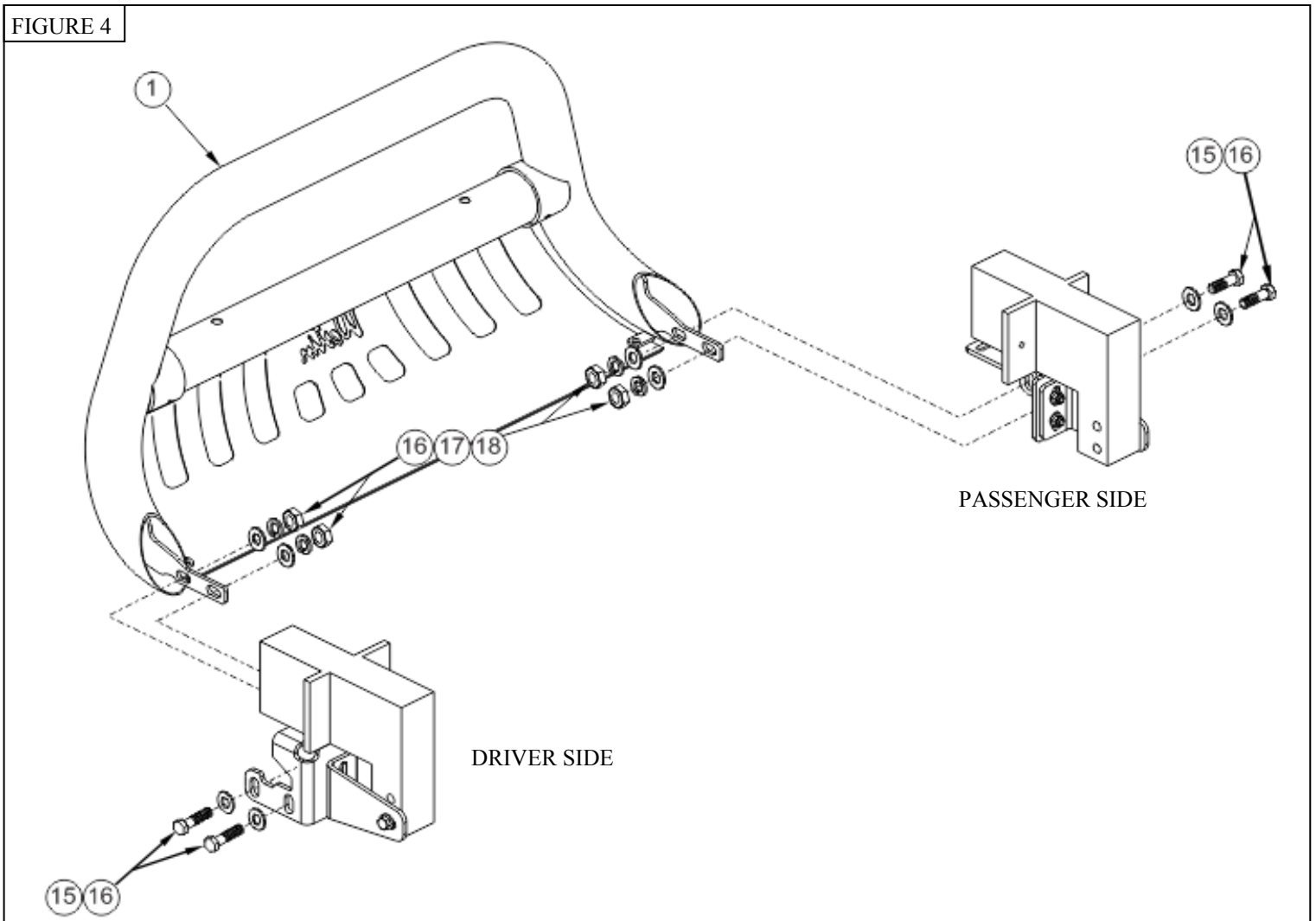

FIGURE 4



**CARE INSTRUCTIONS**

- REGULAR WAXING IS RECOMMENDED. DO NOT USE ANY TYPE OF POLISH OR WAX THAT MAY CONTAIN ABRASIVES
- STAINLESS STEEL PRODUCTS CAN BE CLEANED WITH MILD SOAP AND WATER. STAINLESS STEEL POLISH SHOULD BE USED TO POLISH SMALL SCRATCHES.
- GLOSS BLACK FINISHES SHOULD BE CLEANED WITH MILD SOAP AND WATER

**WESTIN** Westin Automotive Products, Inc.  
320 W. Covina Blvd  
San Dimas, Ca. 91773

Thank you for choosing Westin products  
for additional installation assistance please call  
Customer Service (800) 793-7846



SIGNATURE OF QUALITY

AUTOMOTIVE PRODUCTS, INC.

## WARNINGS & NOTICES FOR THE INSTALLATION OF WESTIN TOWING PRODUCTS - CLASS III RECEIVER HITCH

### NOTICE

Westin Receiver Hitches are designed to accommodate a 2"- square receiver draw bar rated for class III/IV towing. Closely follow all Westin Installation Instructions for the proper installation of product. Improper installation can result in death, serious injury, and/or product and vehicle damage. In the operation of these products, it is imperative to observe precautions for your personal safety and the safety of others.



### WARNING



Failure to follow these instructions could lead to death, personal injury, and / or property damage.

#### FASTENERS:

All Westin supplied fasteners must be utilized and installed in accordance with the installation instructions and apply torque to the specifications as defined. **DOUBLE CHECK ALL FASTENERS BEFORE INITIAL USE, AND PERIODICALLY IN THE FUTURE TO ENSURE PROPER FUNCTION AND SAFETY.**

#### DRILLING:

Most Westin products do not require drilling for installation. If drilling is defined as required, use caution when drilling a vehicle. **FAILURE TO REVIEW AN AREA TO BE DRILLED MAY RESULT IN PERSONAL INJURY AND/OR INJURY TO OTHERS AS WELL AS VEHICLE DAMAGE.**

#### EYE PROTECTION:

**ALWAYS WEAR SAFETY GLASSES OR GOGGLES DURING THE INSTALLATION PROCESS TO AVOID PERSONAL INJURY.**

#### MAXIMUM TOWING/CARRYING CAPACITY:

The Westin Receiver Hitches will have a visible tow rating label affixed directly on the product. User should never exceed the vehicle manufacturers maximum tow and weight rating regardless of the capacity of the hitch. **FAILURE TO FOLLOW THESE GUIDELINES WILL VOID THE WESTIN WARRANTY AND MAY RESULT IN PERSONAL INJURY AND/OR INJURY TO OTHERS AS WELL AS VEHICLE DAMAGE.**

**WESTIN**

Westin Automotive Products, Inc.  
320 W. Covina Blvd  
San Dimas, Ca. 91773

Thank you for choosing Westin products  
for additional installation assistance please call  
Customer Service (800) 793-7846

[www.westinautomotive.com](http://www.westinautomotive.com)